

20,070 SF

Industrial Space For Lease



Prologis Park 13

5227 NE 152nd Place
Portland, Oregon 97230



LOCATION

- 2.5 miles east of I-205
- 4.8 miles east of Portland International Airport
- Signalized access to NE Airport Way

FACILITY

- 20,070 SF available
- 2,135 SF office
- 26' clear height
- 5 dock high doors
- 3 grade level doors
- 3-phase, 277/480 volt, up to 225 amps (to be verified)
- ESFR sprinkler system
- End cap unit
- Available April 1, 2026

ADVANTAGES AND AMENITIES

- Located with close proximity to PDX Airport, supporting services, and regional distribution transportation routes
- Efficient cross-dock loading with ideal building depth for a multitude of layout potentials
- Surplus land area that can be utilized for trailer parking or laydown yard area
- Hard to find size and functionality for the Airport Way submarket

20,070 SF

Industrial Space For Lease

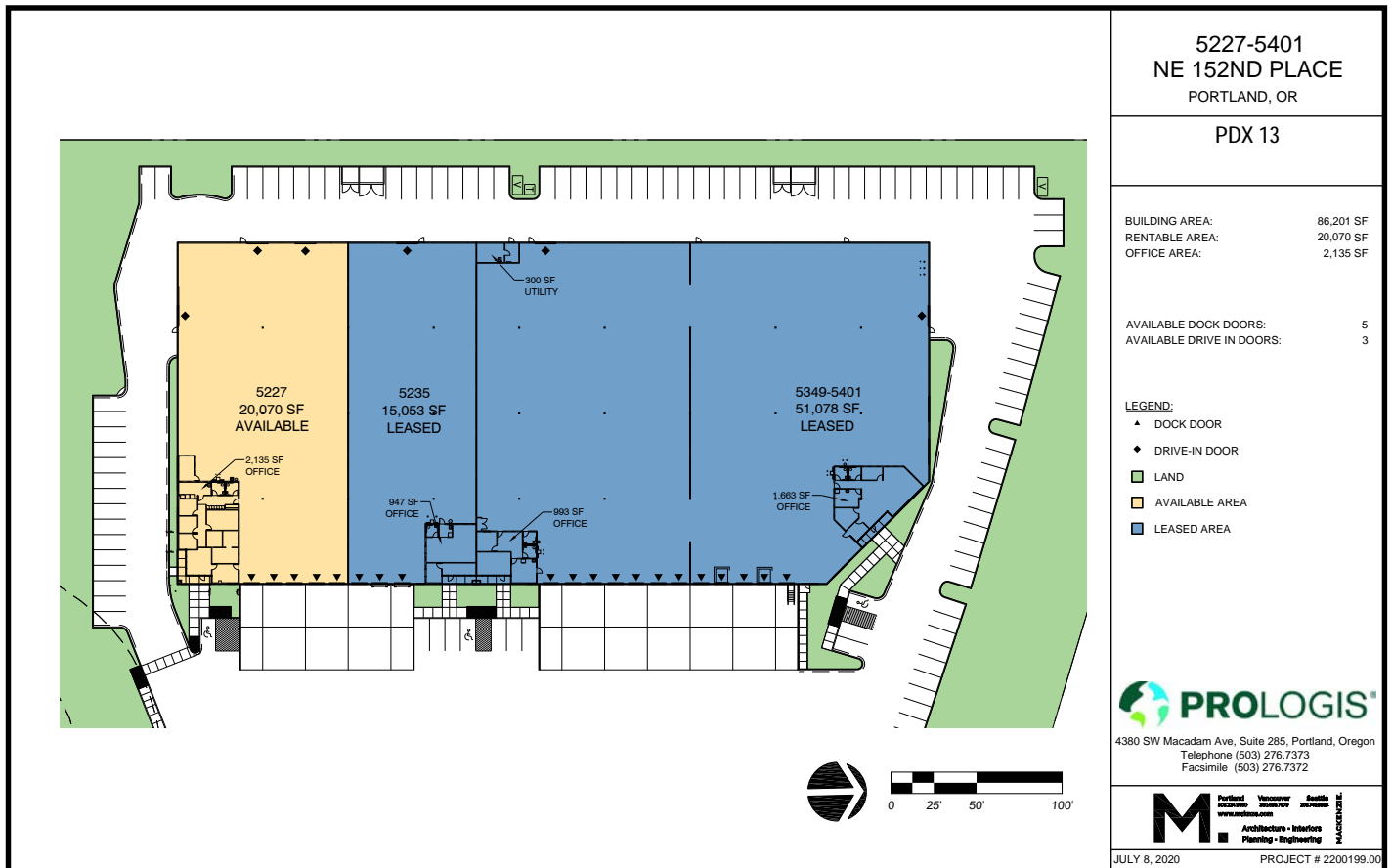

KIDDER MATHEWS

Tom Talbot, SIOR
tom.talbot@kidder.com
ph +1 503 221 2270
101 SW Main Street
Suite 1200
Portland, OR 97204

KIDDER MATHEWS

Scott Murphy, SIOR
scott.murphy@kidder.com
ph +1 503 221 2287
101 SW Main Street
Suite 1200
Portland, OR 97204

PROLOGIS

Kurt Nelson
knelson@prologis.com
ph +1 503 276-7361
4380 SW Macadam Ave
Suite 440
Portland, OR 97239