

KENT CORPORATE PARK

FOR LEASE: 3 UNITS AVAILABLE

22412-22426 72ND AVE S | KENT, WA

KENT VALLEY WAREHOUSE SPACE AVAILABLE



GREAT ACCESS TO SR-167 AND MAIN THOROUGHFARES IN KENT

LEASE INFORMATION

Bldg-Suite	Available Size	Office Size	Loading	Clear	Power	Available	Shell Rate	Office Rate
B-22442	11,871 SF	1,348 SF	5 DH; 1 GL	26'	200A	1/1/27	\$1.10/SF, NNN	\$1.35/SF, NNN
B-22440	8,744 SF	606 SF	4 DH	26'	200A	10/1/26	\$1.10/SF, NNN	\$1.35/SF, NNN
C-22418	6,545 SF	1,031 SF	3 DH; 1 GL	18'	400A; 120/208V; 3P	9/1/26	\$1.10/SF, NNN	\$1.35/SF, NNN

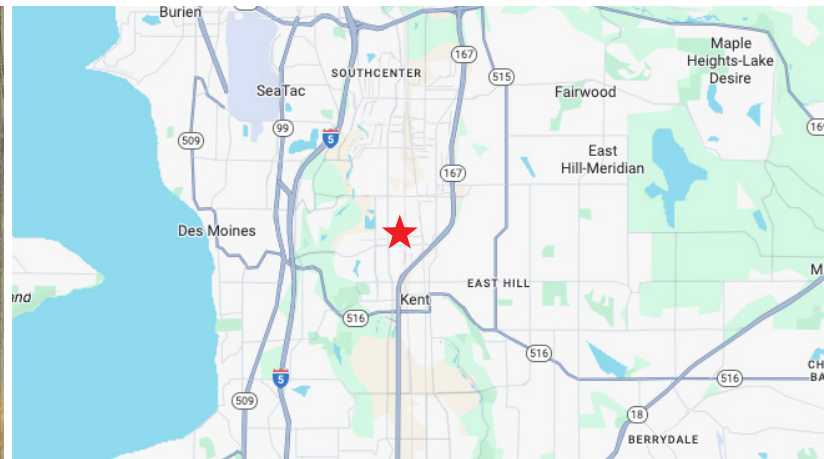

JOEL JONES
253.219.9914
jjones@neilwalter.com

JACOB HANIGAN
253.389.0234
jhanigan@neilwalter.com

1940 East D St #100
Tacoma, WA 98421
253.779.8400
www.neilwalter.com



All information references in this document are approximate. The information contained herein is contained from sources deemed reliable. It is provided without representation, warranty, or guarantee, expressed or implied as to accuracy. Prospective buyer or tenant should conduct its own independent investigation relating to the property, government codes and regulations, allowed uses, and all other matters, regardless of whether they are referred to or contained in this document.

KENT CORPORATE PARK

22412-22426 72ND AVE S | KENT, WA

BUILDING B-22442 11,871 SF Total | 1,348 SF Office

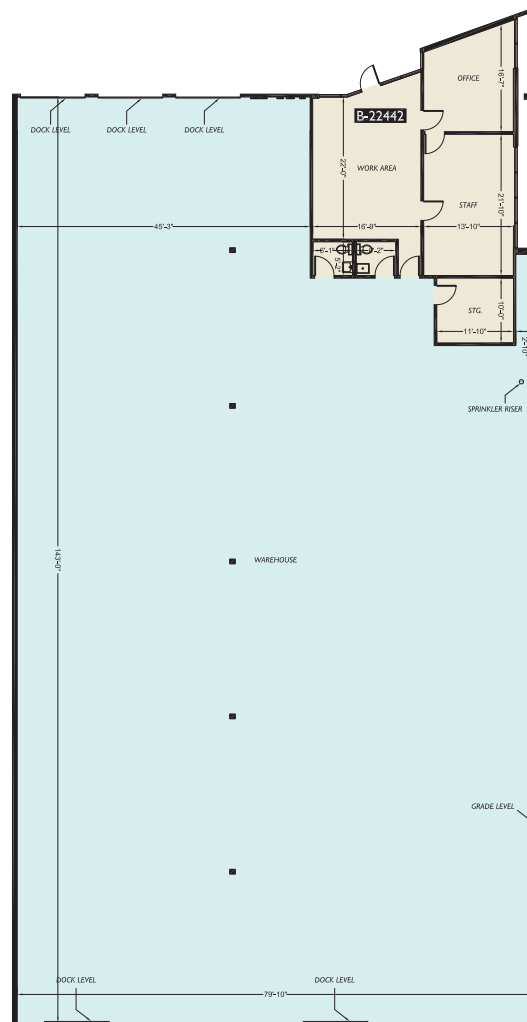

JOEL JONES
253.219.9914
jjones@neilwalter.com

JACOB HANIGAN
253.389.0234
jhanigan@neilwalter.com

1940 East D St #100
Tacoma, WA 98421
253.779.8400
www.neilwalter.com



All information references in this document are approximate. The information contained herein is contained from sources deemed reliable. It is provided without representation, warranty, or guarantee, expressed or implied as to accuracy. Prospective buyer or tenant should conduct its own independent investigation relating to the property, government codes and regulations, allowed uses, and all other matters, regardless of whether they are referred to or contained in this document.

KENT CORPORATE PARK

22412-22426 72ND AVE S | KENT, WA

BUILDING B-22440 8,744 SF Total | 606 SF Office



JOEL JONES
253.219.9914
jjones@neilwalter.com

JACOB HANIGAN
253.389.0234
jhanigan@neilwalter.com

1940 East D St #100
Tacoma, WA 98421
253.779.8400
www.neilwalter.com



All information references in this document are approximate. The information contained herein is contained from sources deemed reliable. It is provided without representation, warranty, or guarantee, expressed or implied as to accuracy. Prospective buyer or tenant should conduct its own independent investigation relating to the property, government codes and regulations, allowed uses, and all other matters, regardless of whether they are referred to or contained in this document.

KENT CORPORATE PARK

22412-22426 72ND AVE S | KENT, WA

BUILDING C-22418 6,545 SF Total | 1,031 SF Office

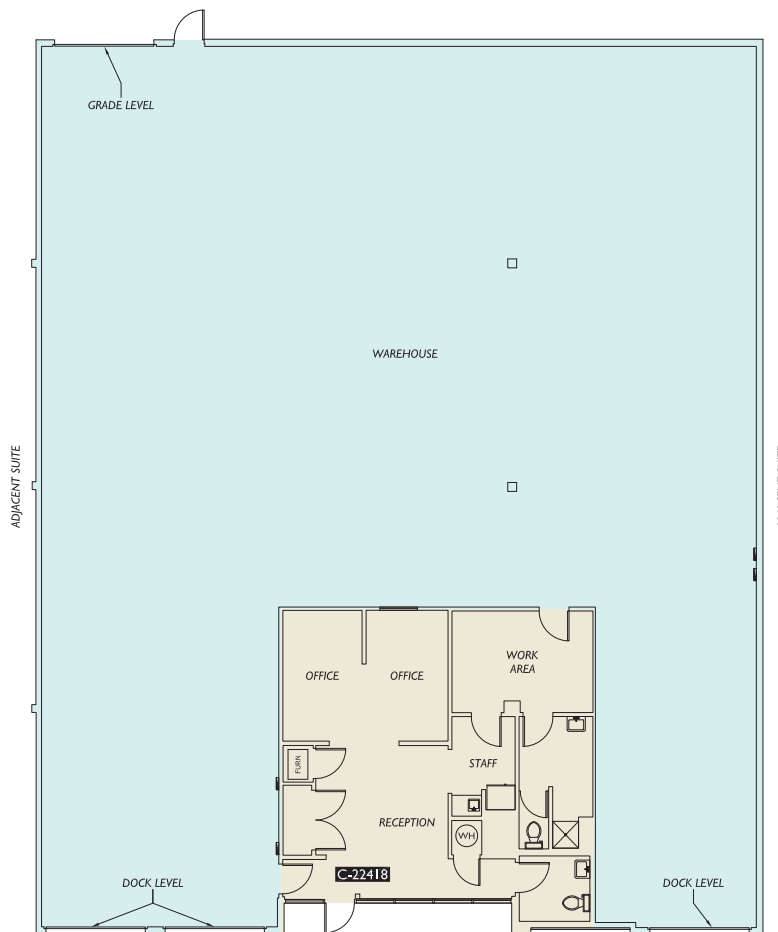

JOEL JONES
253.219.9914
jjones@neilwalter.com

JACOB HANIGAN
253.389.0234
jhanigan@neilwalter.com

1940 East D St #100
Tacoma, WA 98421
253.779.8400
www.neilwalter.com



All information references in this document are approximate. The information contained herein is contained from sources deemed reliable. It is provided without representation, warranty, or guarantee, expressed or implied as to accuracy. Prospective buyer or tenant should conduct its own independent investigation relating to the property, government codes and regulations, allowed uses, and all other matters, regardless of whether they are referred to or contained in this document.

KENT CORPORATE PARK

22412-22426 72ND AVE S | KENT, WA

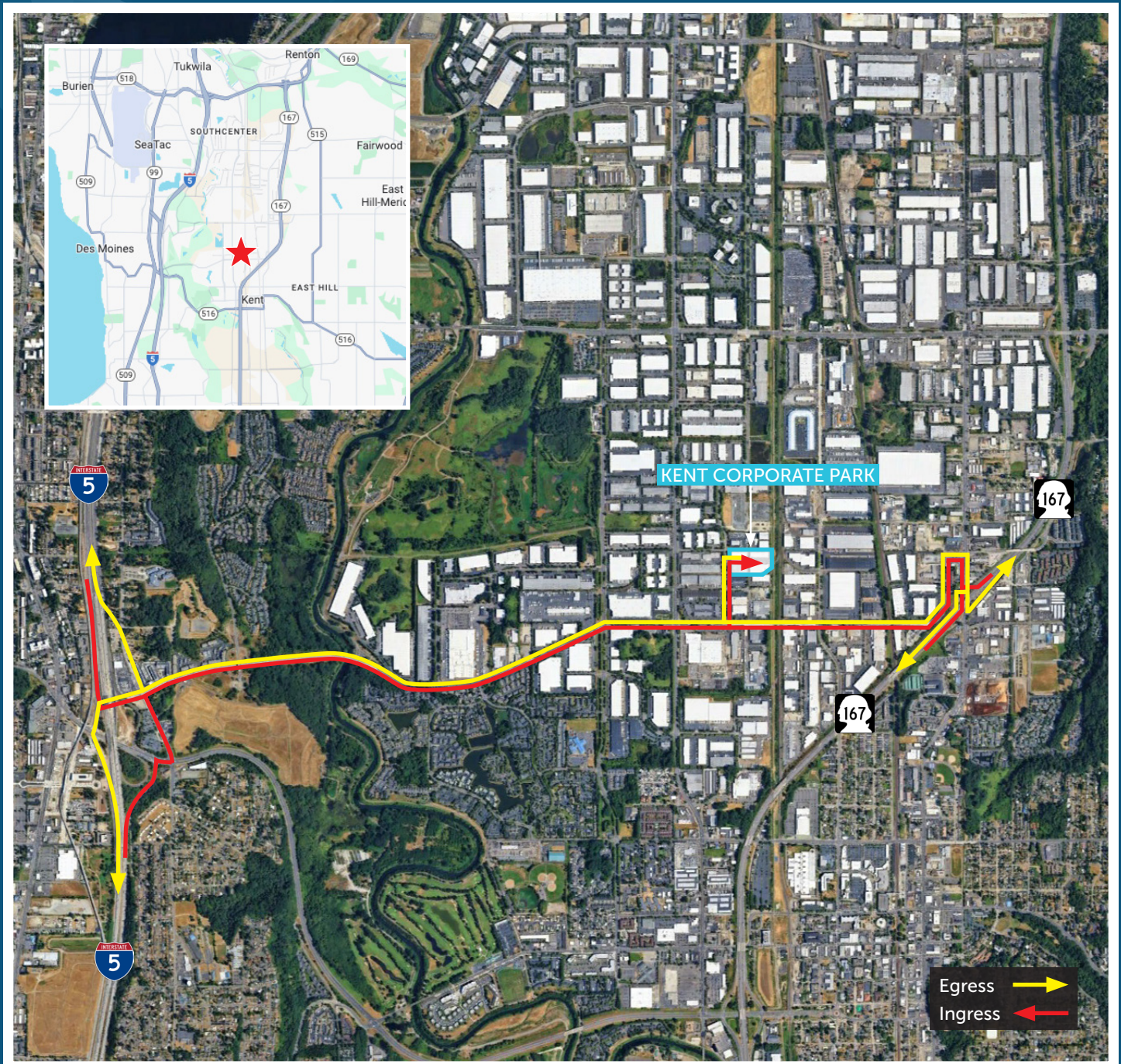

JOEL JONES
253.219.9914
jjones@neilwalter.com

JACOB HANIGAN
253.389.0234
jhanigan@neilwalter.com

1940 East D St #100
Tacoma, WA 98421
253.779.8400
www.neilwalter.com



All information references in this document are approximate. The information contained herein is contained from sources deemed reliable. It is provided without representation, warranty, or guarantee, expressed or implied as to accuracy. Prospective buyer or tenant should conduct its own independent investigation relating to the property, government codes and regulations, allowed uses, and all other matters, regardless of whether they are referred to or contained in this document.