

NOTES:

- 1) THIS IS NOT A VALID, TRUE COPY OF THIS DOCUMENT UNLESS IT BEARS THE ORIGINAL SIGNATURE, SIGNATURE DATE OF THE SURVEYOR NOTED HEREON.
- 2) ANYTHING SHOWN OUTSIDE THE DEFINED BOUNDARIES OF THIS PLAT IS FOR DESCRIPTIVE PURPOSES ONLY.
- 3) THIS SURVEY WAS PREPARED WITH THE BENEFIT OF TITLE OPINION. HOWEVER, THE PROPERTY MAY BE SUBJECT TO ADDITIONAL EASEMENTS OR RIGHT OF WAY OF RECORD.
- 4) SUBJECT TRACT DEED / PLAT REFERENCES: DB 6993 PG 0178 AND DB A611 PG 306 / PB R PG 200
- 5) SUBJECT ADDRESS: 114 MARSHALL ACRES DRIVE SUMMERVILLE, SOUTH CAROLINA 29483
- 6) ALL PLAT AND DEED REFERENCES ARE FROM THE BERKELEY COUNTY REGISTER OF DEEDS OFFICE.
- 7) AREA COMPUTED BY COORDINATE METHOD.
- 8) SUBJECT TRACT IS GRAPHICALLY LOCATED WITHIN A 100 YEAR FLOODPLAIN PER FEMA MAP 45015C0580E WITH AN EFFECTIVE DATE 12/7/2018.
- 9) HORIZONTAL AND VERTICAL CONTROL ESTABLISHED WITH GPS USING THE SCGS VRS SYSTEM. HORIZONTAL DATUM - SOUTH CAROLINA STATE PLANE COORDINATE SYSTEM (NAD83/2011) VERTICAL DATUM - NAVD 88. ALL DISTANCES ARE GROUND DISTANCES.
- 10) THERE WAS NO EVIDENCE OF EXISTING BUILDINGS, RECENT EARTH MOVING WORK, OR BUILDING CONSTRUCTION OBSERVED IN THE PROCESS OF CONDUCTING THE FIELD WORK.
- 11) NO ABOVE-GROUND ENCROACHMENTS OF BUILDINGS, STRUCTURES OR OTHER IMPROVEMENTS FROM THE SUBJECT PROPERTY ONTO ADJOINING PROPERTIES OR FROM ADJOINING PROPERTIES ONTO THE SUBJECT PROPERTY WERE OBSERVED AT THE TIME OF SURVEY OTHER THAN SHOWN HEREON.
- 12) ALL SUBJECT PARCELS ARE CONTIGUOUS WITH NO GAPS, GORES OR HIATUSES.
- 13) THE UNADJUSTED RATIO OF PRECISION: 1:43,209
- 14) NO EVIDENCE OF OBVIOUS OR APPARENT CEMETERIES OR BURIAL GROUNDS WERE OBSERVED BY THE SURVEYOR AT THE TIME OF THE SURVEY. INFORMATION OF THEIR EXISTENCE AND LOCATION WAS NOT FURNISHED TO THE SURVEYOR PRIOR TO OR DURING THE PERFORMANCE OF THE SURVEY.
- 15) THE GRAPHIC REPRESENTATION OF THE UNDERGROUND UTILITIES SHOWN HEREON WERE ESTABLISHED BY FIELD LOCATION OF PAINT MARKS AND/OR PIN FLAGS PLACED BY UTILITY LOCATION CONTRACTOR (SC811). NONE WERE DESIGNATED AT TIME OF SURVEY.
- 16) RIGHT OF WAY PLANS FOR S-736 (MARSHALL ACRES DRIVE) WERE OBTAINED FROM SCDOT PLANS FOR BERKELEY COUNTY PROJECT NUMBER C-440 (DOCKET NUMBER 8448)
- 17) RIGHT OF WAY PLANS FOR U S ROUTE 176 WERE OBTAINED FROM SCDOT PLANS FOR BERKELEY COUNTY PROJECT NUMBER 530-R.
- 18) FOR FURTHER RIGHT OF WAY ACQUISITION OF U S ROUTE 176, REFER TO DB 3633 PG 202 (BERKELEY COUNTY ROD)
- 19) SURVEY COMPLETED MAY 31, 2022.

CURVE TABLE					
CURVE #	LENGTH	RADIUS	DELTA	BEARING	CHORD
C1	54.12'	5800.00'	000°32'05"	N54°25'01"E	54.12'
C2	225.01'	5800.00'	002°13'22"	N53°02'18"E	225.00'

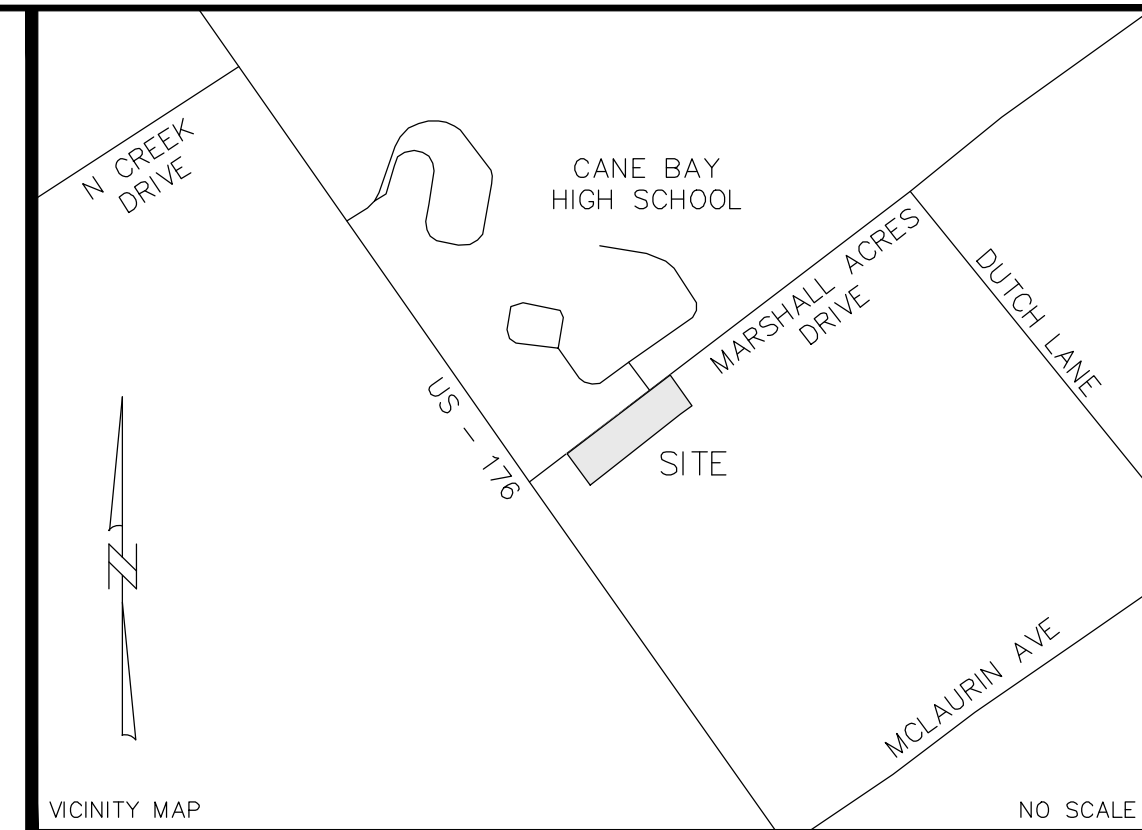

- ABBREVIATION LEGEND
- DB - DEED BOOK
 - PB - PLAT BOOK/PLAT CABINET
 - PG - PAGE
 - NAD - NORTH AMERICAN DATUM
 - NAVD - NORTH AMERICAN VERTICAL DATUM
 - GIS - GEOGRAPHICAL INFORMATION SYSTEM
 - R/W - RIGHT-OF-WAY
 - IPF - IRON PIPE FOUND
 - OT - OPEN TOP PIPE
 - PT - PINCH TOP PIPE
 - IRF - IRON ROD FOUND
 - IRF - SET #5 REBAR WITH CAP
 - NLF - NAIL FOUND
 - RB - REBAR
 - P.O.B - POINT ON BEGINNING
 - P.O.C - POINT OF COMMENCEMENT
 - NTS - NOT TO SCALE
 - (T) - TOTAL

- SYMBOL LEGEND
- - CONCRETE MONUMENT FOUND
 - - BOUNDARY CORNER SET
 - - BOUNDARY CORNER FOUND
 - △ - CALCULATED POINT
 - ◆ - BENCHMARK SET (#5 REBAR WITH CAP)
 - ⊕ - WATER VALVE
 - ⊞ - TELEPHONE PEDESTAL
 - ☆ - LIGHT POLE
 - ⊚ - POWER POLE
 - - SIGN
 - - AC UNIT
 - ⊞ - ELECTRIC BOX
 - ⊙ - STORM DRAIN MANHOLE
 - - POST
 - - CATCH BASIN
 - - CLEAN OUT
 - GM - GAS METER
- LINE LEGEND
- - PROPERTY BOUNDARY
 - - - - ADJOINING PROPERTY
 - - - - ROAD RIGHT-OF-WAY
 - - - - ROAD CENTERLINE
 - - - - EDGE OF PAVEMENT
 - - - - EDGE OF CONCRETE
 - - - - FENCE
 - - - - DIRT ROAD
 - - - - STORM DRAIN
 - - - - COMMUNICATION LINE
 - - - - WATER LINE
 - - - - CURB AND GUTTER
 - - - - OVERHEAD POWER
 - - - - BUILDING OUTLINE
 - - - - BUILDING OVERHANG

- CONCRETE
- BRICK

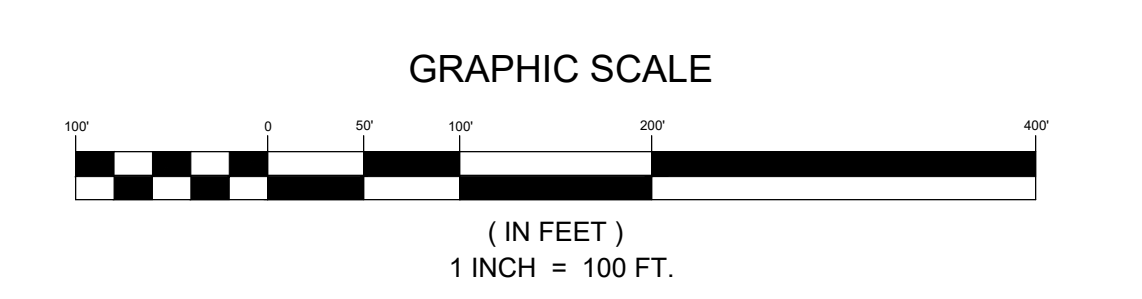

NO.	DATE	REVISION	BY

PROJECT NO: K028.800.00
 SCALE: 1"=100'
 DATE SURVEYED: JULY 7, 2023
 DRAWN BY: CMH
 CHECKED BY: RG
 DATE SURVEYED: DEC 15, 2022
 DRAWING NO: #028 MARSHALL ACRES BASELINE

LOCATED ALONG HWY 176 AND MARSHALL ACRES DRIVE BERKELEY COUNTY, SOUTH CAROLINA

CUSTOMER:
GARY L. MULLINS
NANCY L. MULLINS
 114 MARSHALL ACRES DRIVE
 SUMMERVILLE, SC 29486

1.0

SHEET 1 OF 1

© 2021, ESP ASSOCIATES, INC. ALL RIGHTS RESERVED. COPIES OF THE ORIGINAL OF THIS DOCUMENT DISTRIBUTED BY THE SURVEYOR BEAR THE ORIGINAL SIGNATURE AND EMBOSSED SEAL OF THE SURVEYOR.

ESP Associates, Inc.
 2154 N. Center Street
 Suite E-503
 North Charleston, SC 29406
 843-714-2040
 www.espassociates.com

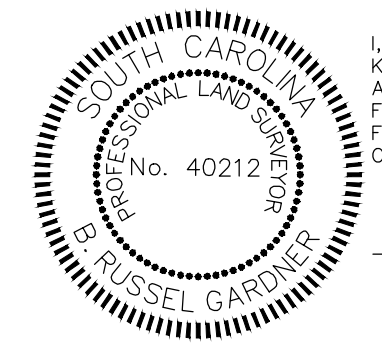

I, B. RUSSEL GARDNER, HEREBY STATE TO THE BEST OF MY PROFESSIONAL KNOWLEDGE, INFORMATION AND BELIEF, THE SURVEY SHOWN HEREON WAS MADE IN ACCORDANCE WITH THE REQUIREMENTS OF THE STANDARDS OF PRACTICE MANUAL FOR SURVEYING IN SOUTH CAROLINA, AND MEETS OR EXCEEDS THE REQUIREMENTS FOR A CLASS B SURVEY AS SPECIFIED WITHIN. ALSO THERE ARE NO ENCROACHMENTS OR PROJECTIONS AFFECTING THE PROPERTY OTHER THAN THOSE SHOWN.



JULY 7, 2023
 B. RUSSEL GARDNER SCPLS NO. 40212 DATE

RESERVED FOR STAMPS
 COUNTY OF BERKELEY