

**UNIT #CO3 | 2,498 SF**

**Turn-key restaurant space with existing kitchen infrastructure**



**Extra space for storage**



**Working hood and grease interceptor  
Includes walk-in cooler/freezer**



**Separate loading area behind the unit**



**Facing entrance along  
Leowahine St.**



**UNIT #CO3 | 2,498 SF**



**PROPERTY DETAILS**

Unit CO3	2,498 SF
Base Rent	\$2.50-\$3.50/SF/MO
CAM	\$1.21/SF/MO
Building Area	107,030 SF (retail)
Zoning	BMX-3
Parking	439 Stalls

**SITE PLAN**

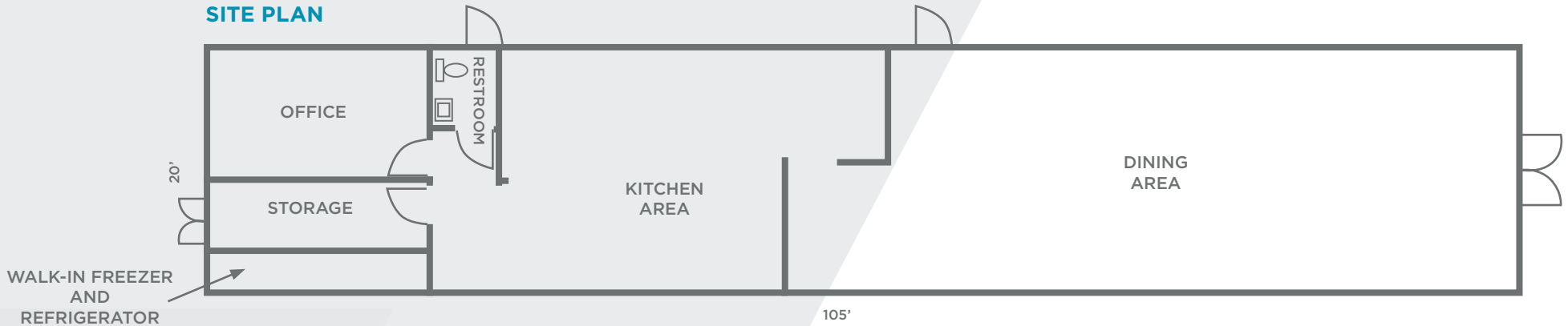

\*Drawing not to scale

**EXCLUSIVE LISTING AGENTS**

**ROCK S. TANG, (S) JD**

+1 808 321 0029

rtang@chaneybrooks.com  
RS-64894

**JOHN T. RANKIN, (S)**

+1 808 265 8715

jrankin@chaneybrooks.com  
RS-72384

1440 Kapiolani Blvd., Suite 1010, Honolulu, HI 96814

Main +1 808 544 1600 | Fax +1 808 544 9574  
RB-17805

[chaneybrooks.com](http://chaneybrooks.com) | [cushmanwakefield.com](http://cushmanwakefield.com)

©2026 CUSHMAN & WAKEFIELD CHANEYBROOKS.

NO WARRANTY OR REPRESENTATION, EXPRESS OR IMPLIED, IS MADE TO THE ACCURACY OR COMPLETENESS OF THE INFORMATION CONTAINED HEREIN, AND SAME IS SUBMITTED SUBJECT TO ERRORS, OMISSIONS, CHANGE OF PRICE, RENTAL OR OTHER CONDITIONS, WITHDRAWAL WITHOUT NOTICE, AND TO ANY SPECIAL LISTING CONDITIONS IMPOSED BY THE PROPERTY OWNER(S). AS APPLICABLE, WE MAKE NO REPRESENTATION AS TO THE CONDITION OF THE PROPERTY (OR PROPERTIES) IN QUESTION.