

St. Joseph Medical Mall

**1004 Carondelet Drive
Kansas City, MO 64114**

For Lease

**446 - 7,404 SF
Medical Office
Space Available**

Joseph Lampe, Director - Healthcare
314-728-6007 / jlampe@ccr-stl.com

Jared Stone, Associate
314-604-8466 / jstone@ccr-stl.com

Leased By:



8000 Maryland Avenue, Suite 1120
St. Louis, MO 63105
www.ccr-stl.com

Owned and Managed by:



Building Highlights:

- ◆ Connected to the renowned St. Joseph Hospital, a 2024 Patient Safety Excellence Award Recipient
- ◆ Quick and easy access to I-435, with 120,000+ VPD
- ◆ Offering flexible floor plans that can be tailored to meet the specific needs of your practice
- ◆ Be part of a prestigious medical community that offers numerous networking and professional development opportunities
- ◆ Ample parking with covered patient drop-offs, as well as an on-site bus station
- ◆ High-quality finishes and contemporary design elements ensure a comfortable and professional setting for patients and staff
- ◆ Competitive lease rates and tenant improvement allowance to provide stability and peace of mind

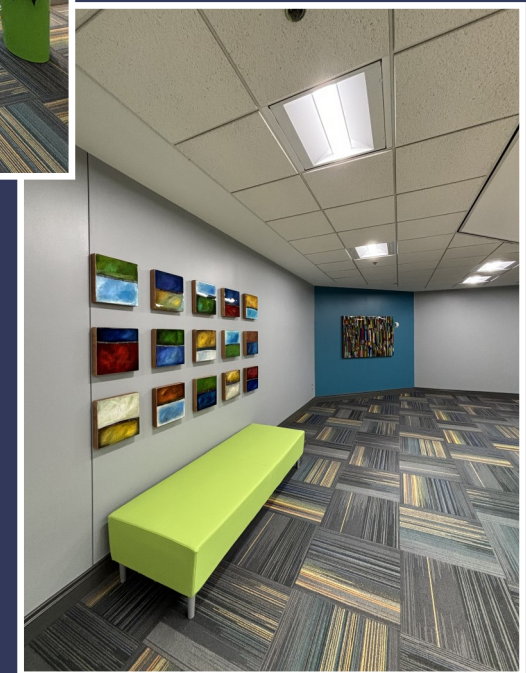

FOR ADDITIONAL INFO, CONTACT:

Joseph Lampe, Director—Healthcare
314-728-6007 / jlampe@ccr-stl.com

Jared Stone, Associate
314-604-8466 / jstone@ccr-stl.com

Leased By:



8000 Maryland Avenue, Suite 1120
St. Louis, MO 63105
www.ccr-stl.com

Owned and Managed by:





St. Joseph Medical Center

1010
Carondelet

930
Carondelet

1004
Carondelet



State Line Road

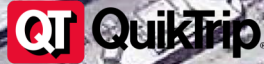

Carondelet Drive

Joseph Lampe, Director—Healthcare
314-728-6007 / jlampe@ccr-stl.com

Jared Stone, Associate
314-604-8466 / jstone@ccr-stl.com

Leased By:



8000 Maryland Avenue, Suite 1120
St. Louis, MO 63105
www.ccr-stl.com

Owned and Managed by:

