

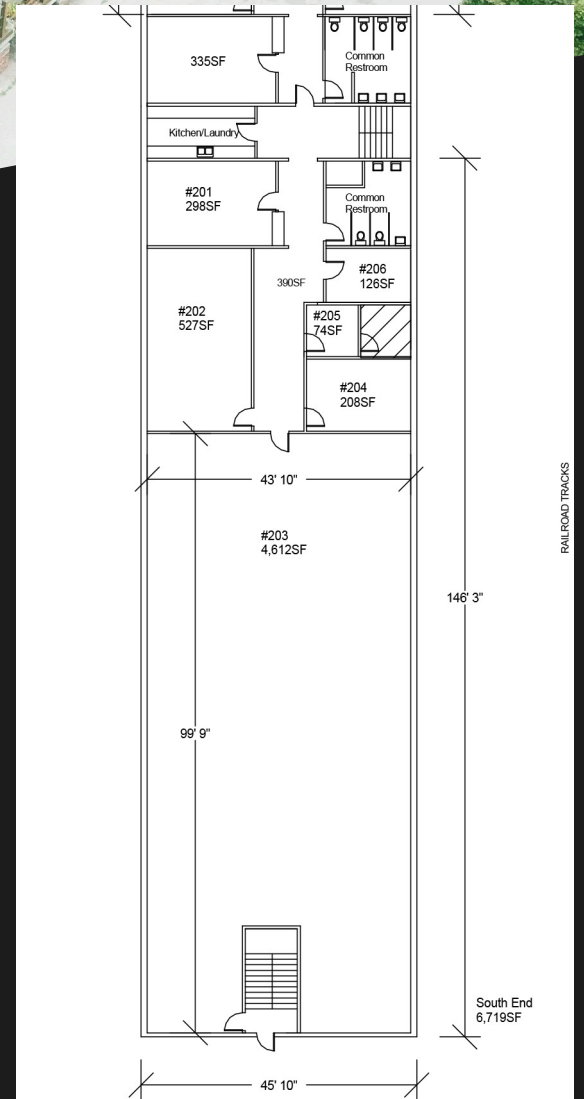

# Private Office For Lease

- Near Downtown Omaha
- Flexible Terms
- All-in Pricing
- On-site Parking

- #201 | 298sf - \$550/mo
- #202 | 527sf - \$850/mo
- #203 | 4,612sf - \$4,500/mo
- #204 | 208sf - \$400/mo
- #205 | 74sf - \$150/mo
- #206 | 126sf - \$230/mo



SCHEDULE A TOUR TODAY!

OMAHAQUARTERMASTERDEPOT.COM