



Unit E - 165 Eagle Drive, Winnipeg, Manitoba

Omands Creek Industrial Space

For Lease 



Property Details

+/- 2,045 sq. ft.

UNIT SIZE

\$10.50/sq. ft.

NET LEASE RATE

\$4.68/sq. ft.

ADDITIONAL RENT (PLUS MANAGEMENT)

M1 - Manufacturing Light

ZONING

Grade level

LOADING

Features

- Prime location within Omands Creek Industrial Park, offering convenient access to major transportation routes, including Oak Point Highway
- Close to Winnipeg James Armstrong Richardson International Airport and CentrePort Canada
- On-site parking available
- Features 1 grade level door
- Ceiling height of approximately +/- 16 feet
- Ideal for manufacturing and warehousing operations



Highlights



SITUATED IN
Omands Creek
Industrial Park



Easy Access
to a variety of
amenities in the
immediate area



Ideally Suited For
Manufacturing &
Warehousing

Site Plan

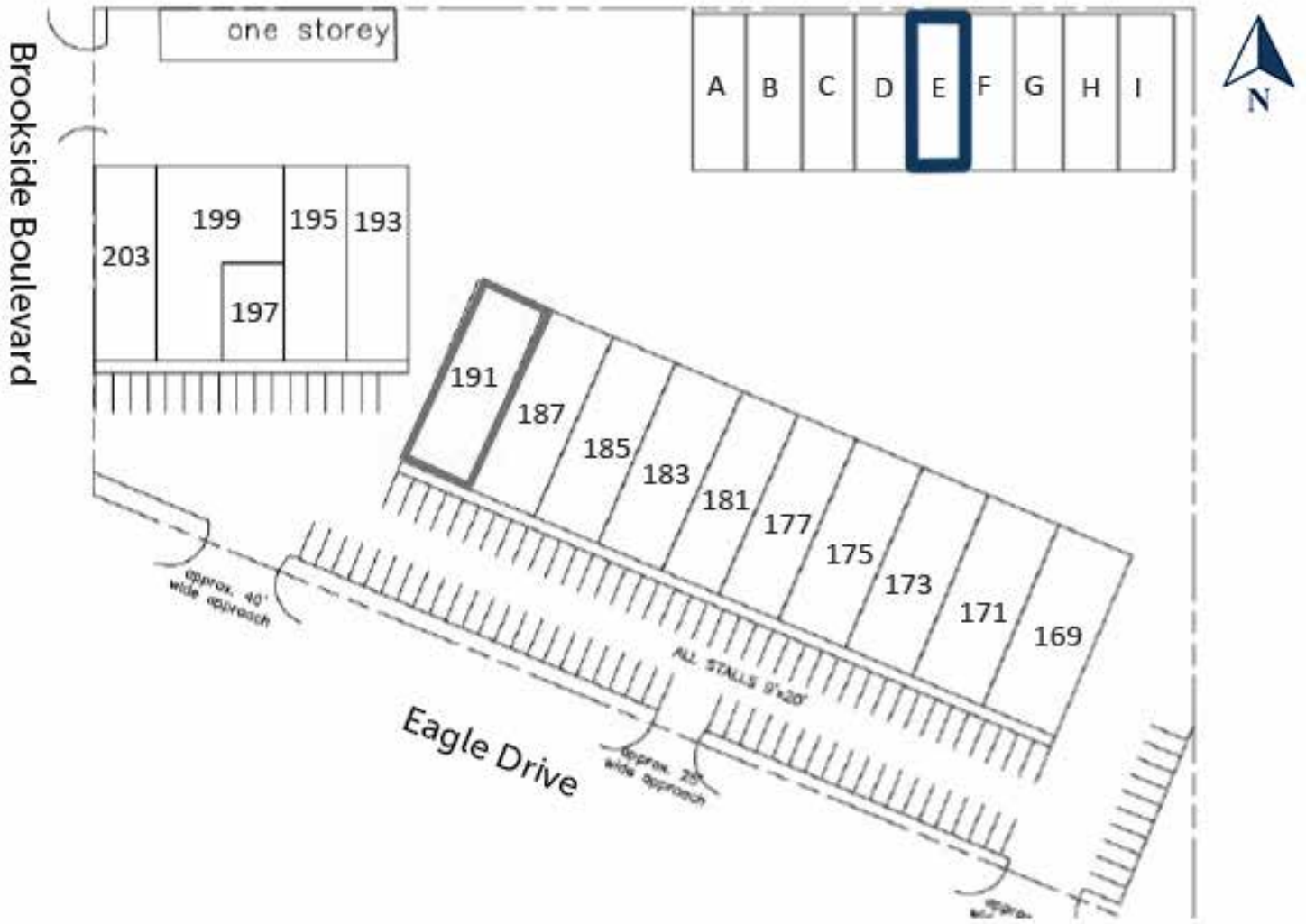



LEGEND

- | | |
|-------------------------------|---|
| 1. Ocean Trailer | 13. Winnipeg Moving & Storage |
| 2. West End Tire | 14. Winnipeg Stonetops |
| 3. Kal Tire | 15. Willim's Craning |
| 4. Parts for Trucks | 16. Gardewine |
| 5. Flying J | 17. KAG Canada |
| 6. Oak Point Restaurant | 18. Kings Transfer
Planned Perfectly |
| 7. Thermo King | 19. Prairie West Ice Cream |
| 8. MoveMobility Inc. | 20. Traction Winnipeg |
| 9. The Erb Group | 21. Proposed Transit Garage |
| 10. Westrans | 22. Ride Time |
| 11. Sun Valley Restaurant | 23. Tyndall Park School |
| 12. Petro Pass
Burger King | 24. Garden Grove School |

Connect with us today!

iciproperties.com

Tyson Preisentanz*
SENIOR VICE PRESIDENT

tpreisentanz@iciproperties.com
204-782-6183

Jared Kushner*
VICE PRESIDENT

jkushner@iciproperties.com
204-294-1087

DISCLAIMER Information herein has been obtained from sources deemed reliable; however, neither the Vendor/Landlord nor ICI Properties guarantees, warrants, or represents, expressly or impliedly, its completeness or accuracy. Projections, opinions, assumptions, or estimates, if any, are provided as examples only and may differ materially from actual results. Purchasers and tenants are responsible for conducting their own due diligence. The property may be withdrawn without notice. Neither the Vendor/Landlord nor ICI Properties assumes liability for any loss or damage arising from reliance on this information. If the recipient has executed a confidentiality agreement related to this matter, such information is subject to its terms. ©2025 ICI Properties. All rights reserved.

**Services provided by 2023 Tyson Preisentanz Personal Real Estate Corporation*

**Services provided by Jared Kushner Personal Real Estate Corporation*

For Lease ➤

Unit E - 165 Eagle Drive, Winnipeg, Manitoba
iciproperties.com