

# Warehouse/Distribution Facility

±39,447 AVAILABLE SF

PRICED TO LEASE - BEST RATE ON THE CENTRAL COAST!



FOR LEASE

417-B SALINAS ROAD

ROYAL OAKS, CA 95076



# 417-B SALINAS ROAD

## ROYAL OAKS, CA 95076

### Property Features

- Three (3) Dock High & One (1) Grade Level Roll Up Door
- Ample Power (400A 3ph 208V)
- 12 On-Site Parking Spaces & 7 across the Street - Totaling 19 Parking Spaces
- 417-B Premises floorplate is ABOVE floodplain - stayed dry during the 2023 Pajaro River levee break

### Space/Pricing Details

- Total Building Size: ±88,721 SF
- Total SF Available: ±39,447 SF (44.46% of Building)
- **\$0.45/SF/Month** Base Rent + NNN @ **±\$0.15**
- **\$23,668.20** per month (Base Rent + NNN)



# 417-B SALINAS ROAD

ROYAL OAKS, CA 95076

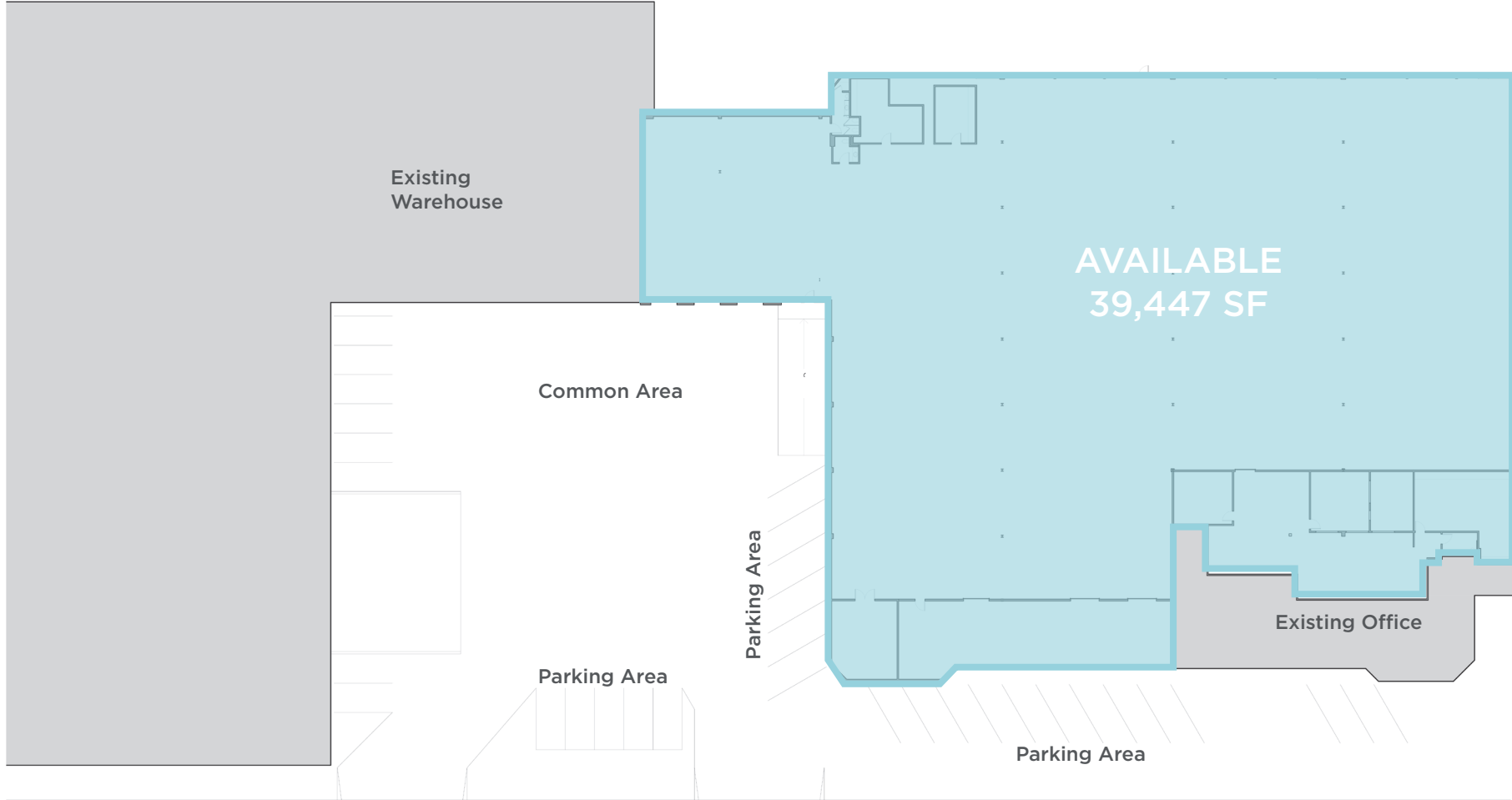

SALINAS ROAD

**417-B SALINAS ROAD**  
**ROYAL OAKS, CA 95076**

Interior Photos



# 417-B SALINAS ROAD

ROYAL OAKS, CA 95076

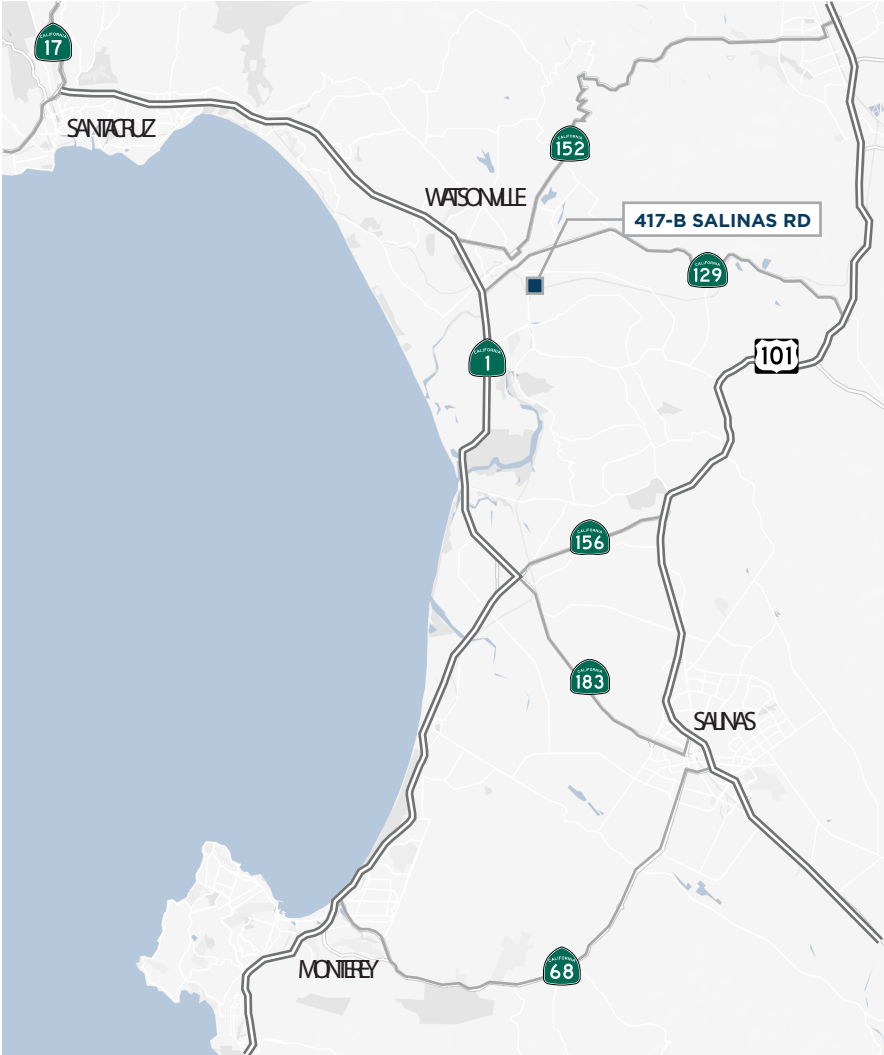

# FOR LEASE

# 417-B SALINAS ROAD

ROYAL OAKS, CA 95076

FOR MORE INFORMATION, CONTACT:

**REUBEN HELICK**  
Managing Director  
+1 831 647 2109  
reuben.helick@cushwake.com  
LIC #01171272

Doud Arcade Building | Suite 202  
Ocean Avenue South  
PO Box 999  
Carmel-by-the-Sea, CA 93921 | USA  
main +1 831 375 8000  
[cushmanwakefield.com](http://cushmanwakefield.com)

©2026 Cushman & Wakefield. All rights reserved. The information contained in this communication is strictly confidential. This information has been obtained from sources believed to be reliable but has not been verified. NO WARRANTY OR REPRESENTATION, EXPRESS OR IMPLIED, IS MADE AS TO THE CONDITION OF THE PROPERTY (OR PROPERTIES) REFERENCED HEREIN OR AS TO THE ACCURACY OR COMPLETENESS OF THE INFORMATION CONTAINED HEREIN, AND SAME IS SUBMITTED SUBJECT TO ERRORS, OMISSIONS, CHANGE OF PRICE, RENTAL OR OTHER CONDITIONS, WITHDRAWAL WITHOUT NOTICE, AND TO ANY SPECIAL LISTING CONDITIONS IMPOSED BY THE PROPERTY OWNER(S). ANY PROJECTIONS, OPINIONS OR ESTIMATES ARE SUBJECT TO UNCERTAINTY AND DO NOT SIGNIFY CURRENT OR FUTURE PROPERTY PERFORMANCE.

