

COMMERCIAL LAND FOR SALE

19095 W. 151ST Terrace, Olathe, Kansas



For Sale - \$1,199,000

- 1.25 Acres of prime commercial land
- CP-3 Zoning allowing a wide range of commercial uses
- Ideal for Retail, Office, Medical, Restaurant or Mixed-Use Commercial Development
- Excellent visibility and easy accessibility with convenient access to major highways
- Strategically positioned in one of Olathe's fastest-growing areas

Ryan Holcomb

c: 816.526.2904 | o: 913.747.3321
e: rholcomb@fishmancommercial.com

Lynn Holcomb

c: 816.289.1526 | o: 913.747.3301
e: lholcomb@fishmancommercial.com

Elliott Basler

c: 913.909.6968 | o: 913.708.8146
e: elliott@fishmancommercial.com

Site Plan

- for demonstration purposes only

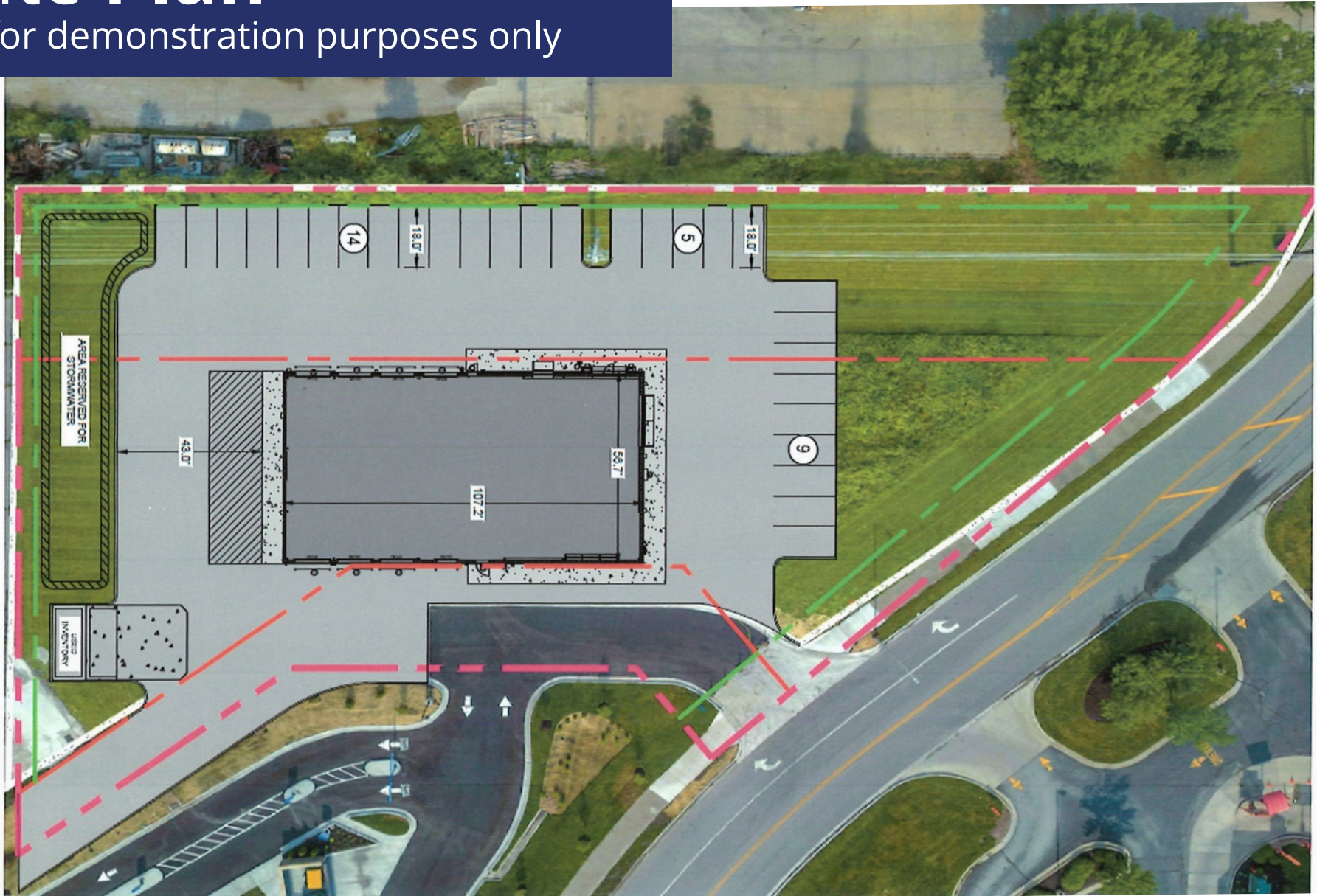

Aerial



| AREA DEMOGRAPHICS | 1 mile | 3 mile | 5 mile |
|----------------------|-----------|-----------|-----------|
| Avg Household Income | \$123,957 | \$142,323 | \$148,316 |
| 2025 Population | 71,018 | 152,068 | 420,851 |
| Daytime Employees | 74,297 | 140,257 | 453,323 |

COMMERCIAL LAND FOR SALE

19095 W. 151ST Terrace, Olathe, Kansas

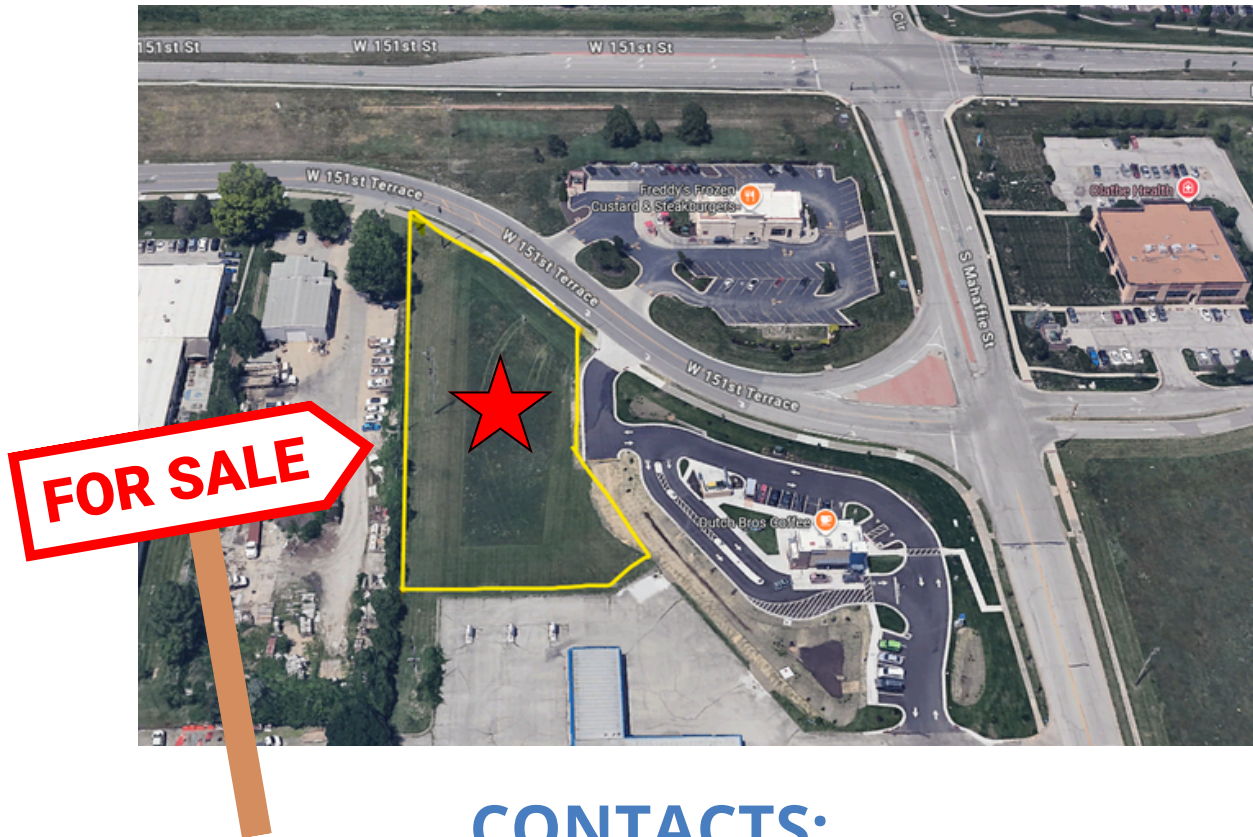

CONTACTS:

Ryan Holcomb

c: 913.526.2904 | o: 913.747.3321
e: rholcomb@fishmancommercial.com

Lynn Holcomb

c: 816.289.1526 | o: 913.747.3301
e: lholcomb@fishmancommercial.com

Elliott Basler

c: 816.909.6968 | o: 913.708.8146
e: elliott@fishmancommercial.com

Information furnished regarding property is from sources deemed reliable but no warranty or representation is made as to the accuracy thereof and same is submitted subject to errors, omissions, prior sale of lease or withdrawal without notice.