GARFIELD BUSINESS CENTER

3422
Garfield
Avenue

FOR LEASE:
49,365 SF

NEWMARK

AVAILABLE FOR LEASE

3422 S Garfield Avenue Commerce, CA 90040



For Lease: ±49,365 SF

COVERED, SPRINKLERED & SECURED
RAIL DOCK INCLUDED IN AVAILABLE SF.



**Professionally Managed
Business Park**



**3 Dock High Positions
1 Ground Level Via Ramp**



20' - 22' Clearance



±4,916 Office

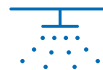

.45/3000 Sprinklers



400 Amps



**Immediate (5) Freeway
Access**

NEWMARK

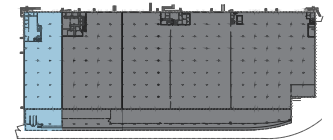
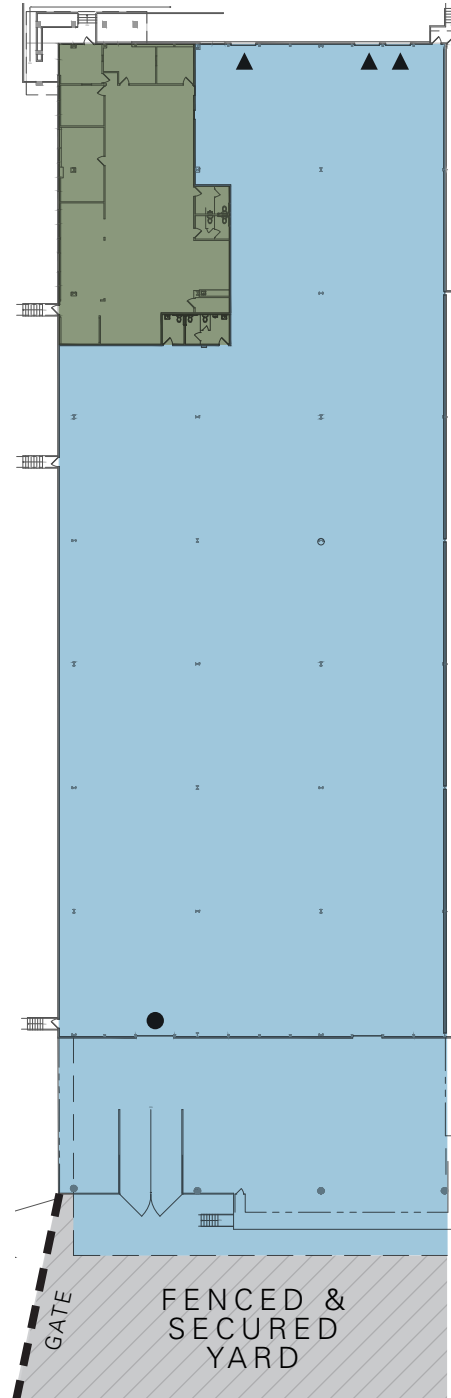

NOT TO SCALE

- AVAILABLE (Blue square)
- NOT A PART (Grey square)
- OFFICE (Green square)
- YARD (Hatched square)
- ▲ DOCK HIGH POSITION
- GROUND LEVEL DOOR

3422 GARFIELD AVENUE



3422 GARFIELD AVENUE

9 Miles

DOWNTOWN LOS ANGELES

17 Miles

PORT OF LONG BEACH

19 Miles

PORT OF LOS ANGELES

20 Miles

LOS ANGELES INTERNATIONAL AIRPORT

CONTACT

Jeff Sanita

Executive Managing Director

t 310-491-2003

jeff.sanita@nrmk.com

CA RE Lic. #01242202

John McMillan

Vice Chairman

t 310-491-2048

john.mcmillan@nrmk.com

CA RE Lic. #01103292

Joey Farney

Associate

t 310-491-2007

joey.farney@nrmk.com

CA RE Lic. #02218932

Andrew Conroy

Transaction Manager

t 310-491-2085

andrew.conroy@nrmk.com

CA RE Lic. #02143325



Corporate License #01355491

The information contained herein has been obtained from sources deemed reliable but has not been verified and no guarantee, warranty or representation, either express or implied, is made with respect to such information. Terms of sale or lease and availability are subject to change or withdrawal without notice.

NEWMARK