

FOR LEASE

1135 Lady Street

Columbia, South Carolina



Property Features

- Excellent retail space located on the bottom floor of the Palms in downtown Columbia at the corner of Lady Street and Main Street.
- The building is surrounded by numerous restaurants, retail stores, entertainment venues, and offices. It is in the Central Business District and within walking distance to the State Capitol and USC Campus. In addition to all the amenities within walking distance, its close proximity to I-126, I-26, Elmwood, and Huger give this location easy accessibility from all the main areas of Columbia.
- ±777 SF Available
- Lease Rate: \$30.00 NNN

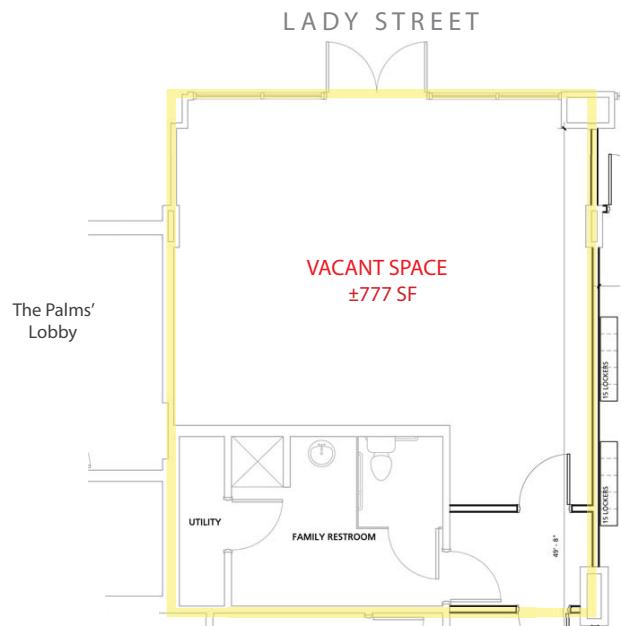

FOR LEASE

1135 Lady Street

Columbia, South Carolina

