

AVAILABLE FOR LEASE



750 Great Southwest Parkway SW

ATLANTA, GEORGIA 30336

STREAM[®]



TAURUS



750 Great Southwest Parkway SW

ATLANTA, GEORGIA 30336



750 Great Southwest is a 38,620 SF, standalone facility situated in the heart of the Fulton Industrial Submarket. The property offers two-turn, direct access back to I-20 with under 10 minute drive-time. The facility is a highly functional distribution facility with rear load configuration and ample loading.

■ PROPERTY HIGHLIGHTS

Building Size 38,620 SF

Office Size 3,662 SF

Year Built 1970

Loading 8 Dock High w/ 4 Levelers
1 Drive-In

Column Spacing 44' W x 33' D

Clear Height 14'





750 Great Southwest Parkway SW

ATLANTA, GEORGIA 30336

Warehouse 34,958 SF

Office 3,662 SF

Dock Count 8 Dock-High; 1 Drive-In

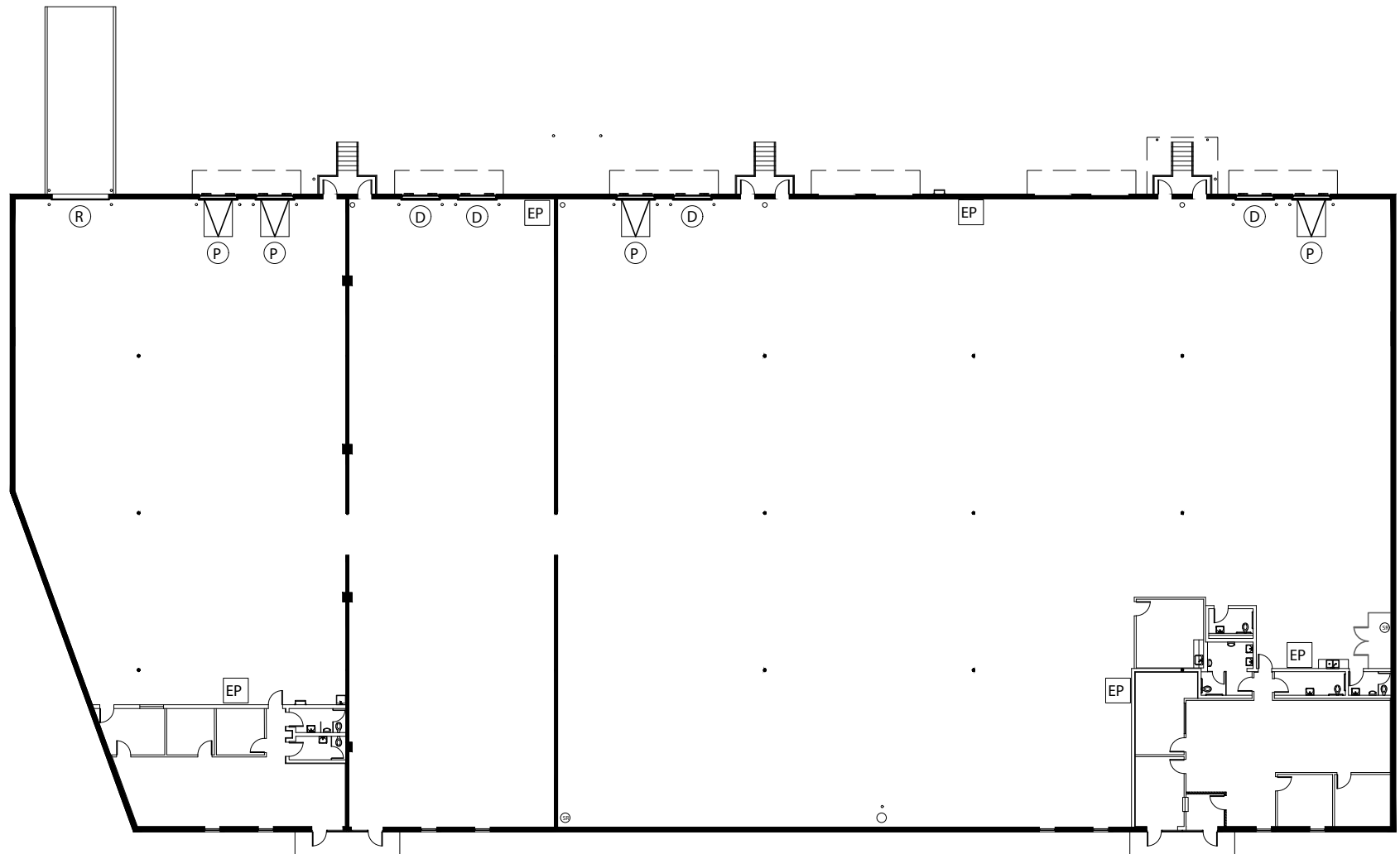



750 Great Southwest Parkway SW

ATLANTA, GEORGIA 30336

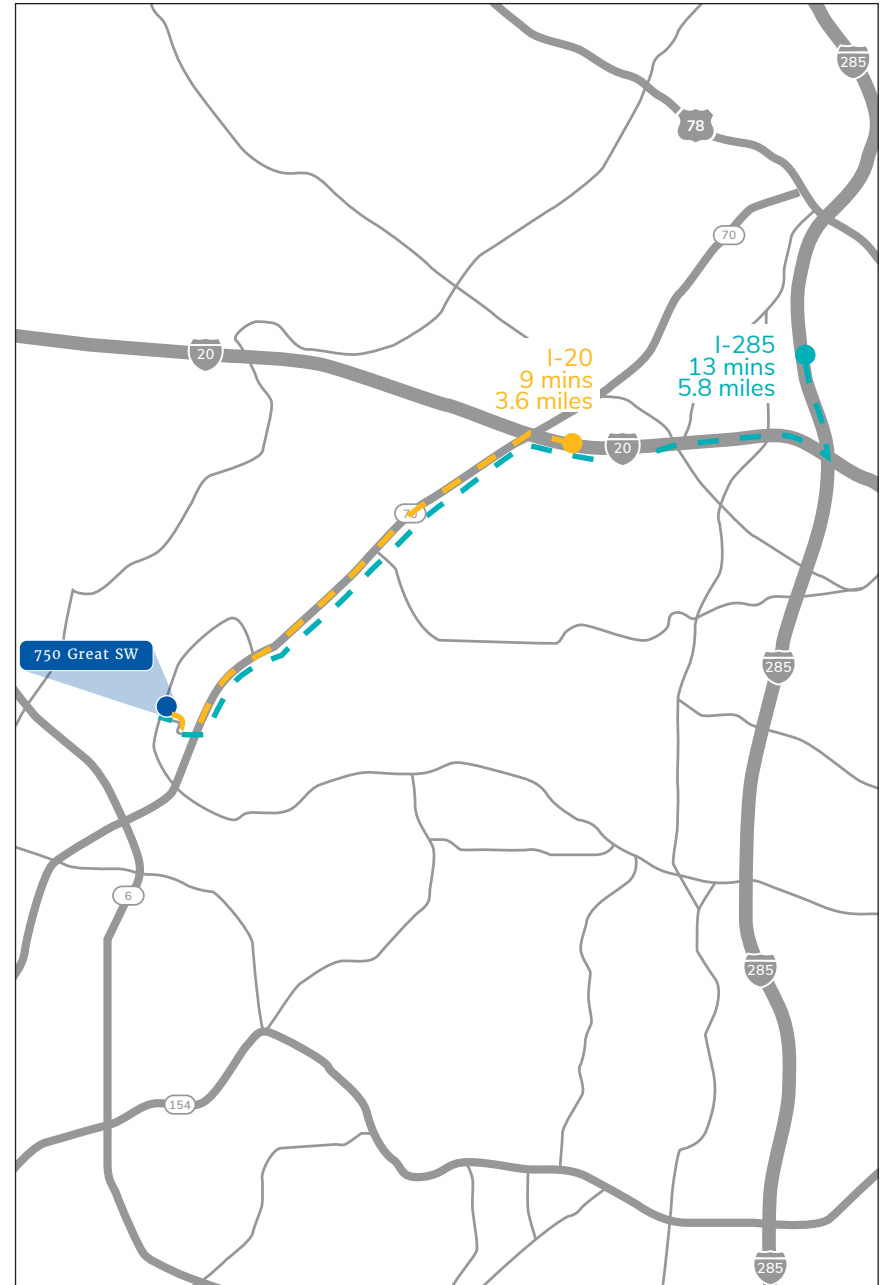

STREAM[®]



TAURUS



NICK PEACHER, SIOR

Managing Director

nicholas.peacher@streamrealty.com

404.416.2328

CATHERINE GIEL, SIOR

Vice President

catherine.giel@streamrealty.com

404.962.8653