



# 515

## South Flower Street

Downtown Los Angeles

### Trophy Sublease Opportunity

For Further Information, Contact:

**Clay Hammerstein**

Vice Chairman

[Clay.Hammerstein@cbre.com](mailto:Clay.Hammerstein@cbre.com)

213.613.3055

Lic. 00980828

**Sarah Phillips**

Vice President

[Sarah.Phillips@cbre.com](mailto:Sarah.Phillips@cbre.com)

213.613.3664

Lic. 02248393

**CBRE**



## Space Highlights

**Premises:** Floors 22, 25-26 & Partial 23rd

**Availability:** Immediate

**Total Size:**  
Floors 26: 25,531 RSF  
Floors 25: 25,531 RSF  
Partial 23rd Floor: 13,236 RSF  
Floors 22: 25,531 RSF

**Asking Rate:** Negotiable

**Available Size:** 13,236 - 89,829 RSF

**Furniture:** Negotiable

**Parking:** 1/1,000

**Sublease Term:** Through August 31, 2032

### Space Features:

- Fully built-out, move-in ready space
- Collaboration rooms on multiple floors
- Dedicated client-facing floor (25th) featuring client lounge, board room, multiple conference rooms, executive zoom room, and catering pantry
- Dedicated back-of-house floor (22nd) with server room, IT shipping, NOC storage, records room, reprographics, and Williams Lea service center
- Perimeter private offices throughout
- 3 reception areas
- Robust conferencing infrastructure across all floors including training/presentation room
- Upper block (Floors 25 & 26) connected via internal staircase



## Building Highlights

- On-site conferencing facility
- Drago restaurant on-site
- Outdoor Tenant Plaza featuring Nice Coffee Bar
- 505 Flower retail plaza (subterranean; 15 eateries and service providers)
- Efficient floor plate

# Floor Plan

## 26th Floor – 25,531 RSF

- Multiple conference rooms
- Large training/presentation room
- Collaboration room
- Perimeter private offices

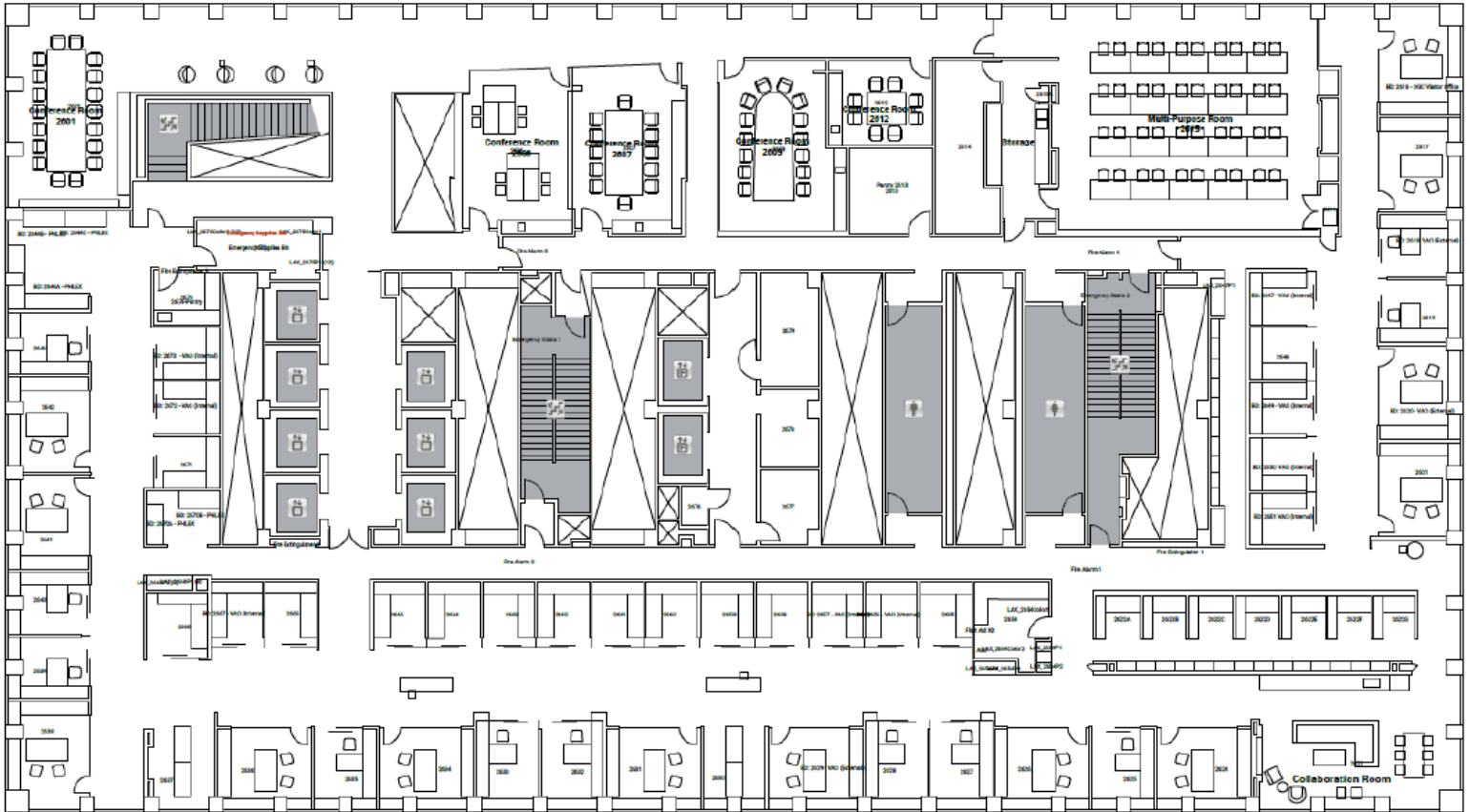

# Floor Plan

## 25th Floor – 25,531 RSF

- Client lounge & board room
- Multiple conference rooms & executive zoom room
- Catering office & pantry
- Collaboration room
- Perimeter private offices

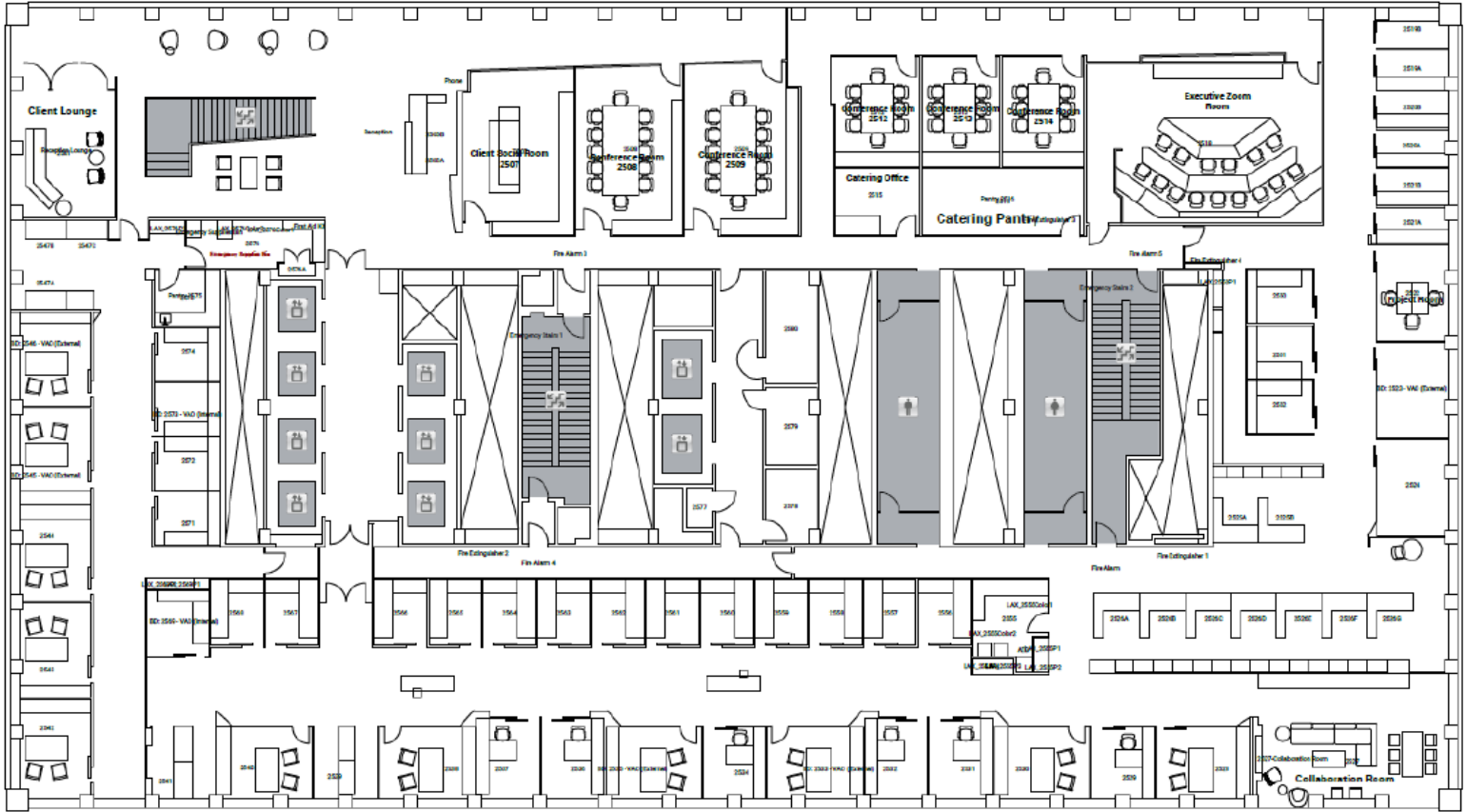

# Floor Plan

## Partial 23rd Floor – 13,236 RSF

- Collaboration room
- Perimeter private offices
- Open workstation areas



# Floor Plan

## 22nd Floor – 25,531 RSF

- 3 reception areas
- Conference room & meeting room
- Server room, IT shipping & NOC storage
- Records room & reprographics service center







# 515 South Flower Street

For Further Information, Contact:

**Clay Hammerstein**

Vice Chairman

[Clay.Hammerstein@cbre.com](mailto:Clay.Hammerstein@cbre.com)

213.613.3055

Lic. 00980828

**Sarah Phillips**

Vice President

[Sarah.Phillips@cbre.com](mailto:Sarah.Phillips@cbre.com)

213.613.3664

Lic. 02248393

© 2026 CBRE, Inc. All rights reserved. This information has been obtained from sources believed reliable, but has not been verified for accuracy or completeness. You should conduct a careful, independent investigation of the property and verify all information. Any reliance on this information is solely at your own risk. CBRE and the CBRE logo are service marks of CBRE, Inc. All other marks displayed on this document are the property of their respective owners, and the use of such logos does not imply any affiliation with or endorsement of CBRE. Photos herein are the property of their respective owners. Use of these images without the express written consent of the owner is prohibited.

**CBRE**

[www.cbre.com](http://www.cbre.com)