



# FOR SUBLEASE

11502 SOUTH MAIN STREET,  
SUITE 204 HOUSTON,  
TX 77025



## PROPERTY FEATURES

- 18,900 SF
- 865 SF Office
- (5) Dock High Loading Doors
- (1) Drive In Ramp
- 22' Clear Height
- 100% Sprinklered
- Direct Access to Main Street / Hwy 90 / 610 Loop
- Available: April 1, 2026
- Sublease Expiration: 10/31/2028
- Sublease Rate: \$0.73 PSF/ Mo NNN + \$0.22 Opex

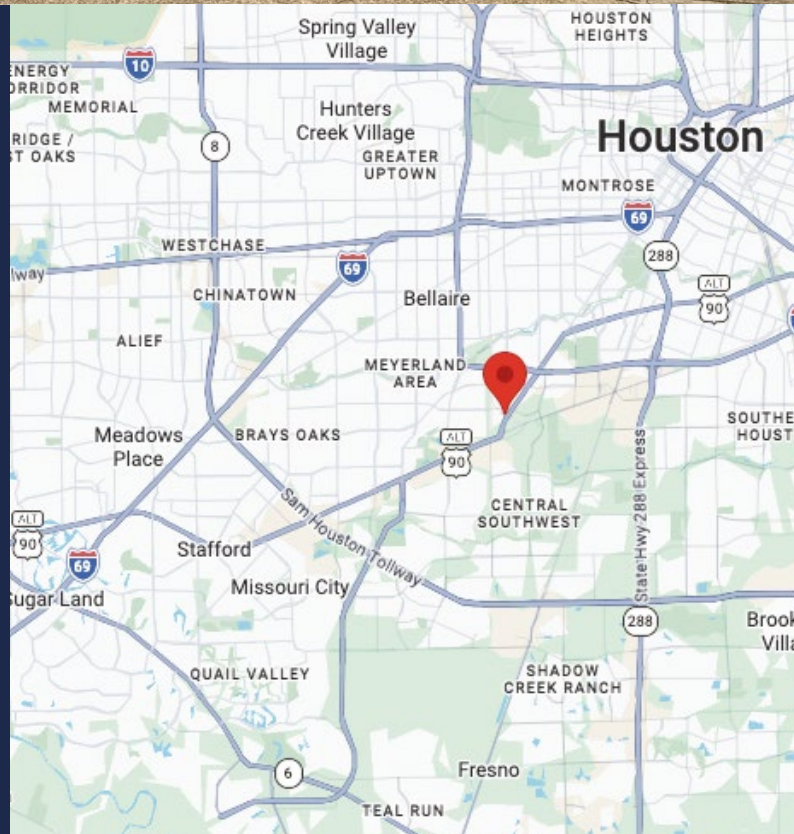

FOR MORE INFORMATION PLEASE CONTACT

Dylan Stiteler • [dylan@bridge-cre.com](mailto:dylan@bridge-cre.com) • 281 394 3880

The information contained here in has been given to us by the owner of the property or other sources we deem reliable, we have no reason to doubt the accuracy, but we do not guarantee it. All information should be verified prior to purchase or lease.

# FLOOR PLAN

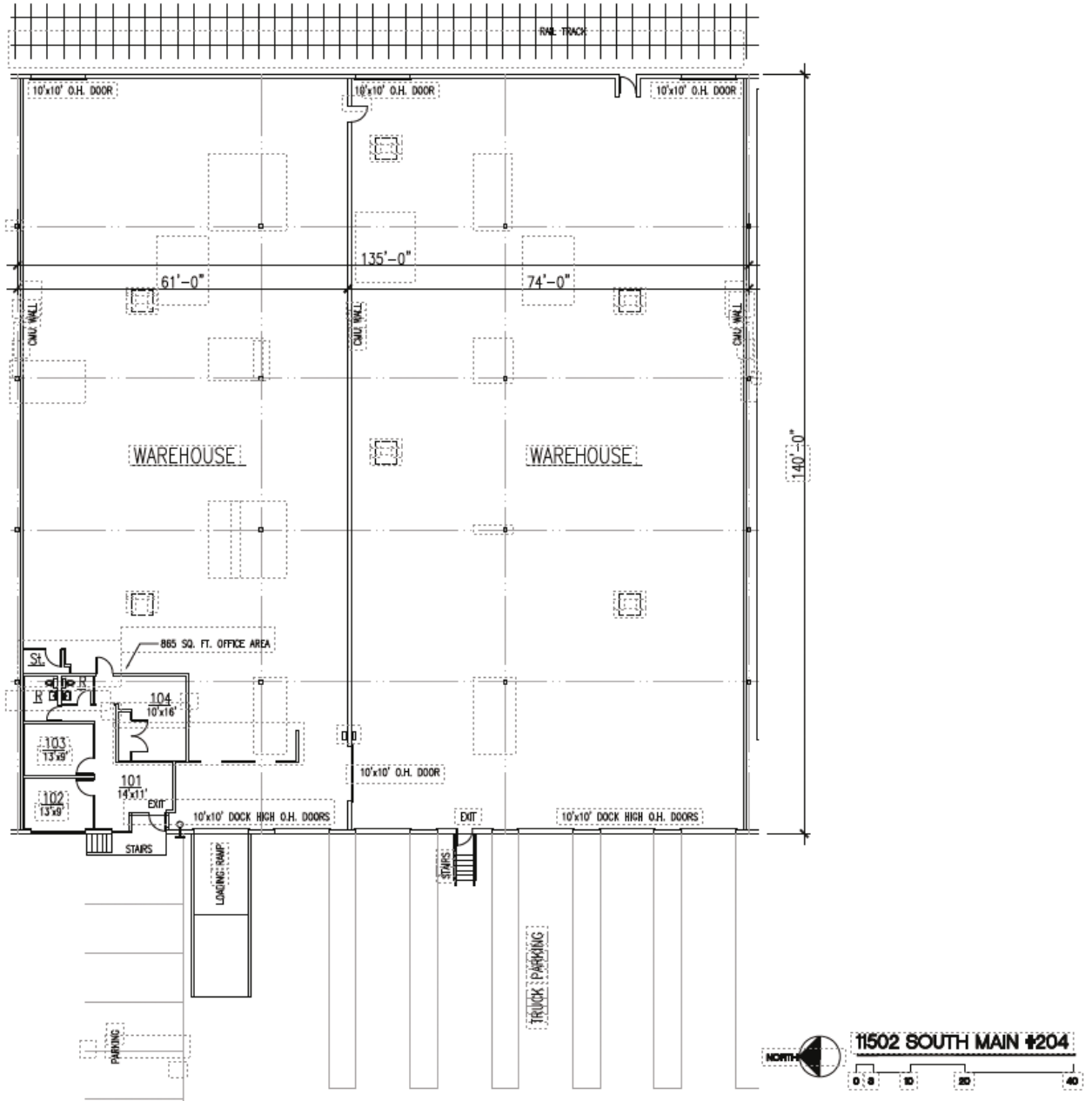

FOR MORE INFORMATION PLEASE CONTACT  
Dylan Stiteler • [dylan@bridge-cre.com](mailto:dylan@bridge-cre.com) • 281 394 3880

The information contained here in has been given to us by the owner of the property or other sources we deem reliable, we have no reason to doubt the accuracy, but we do not guarantee it. All information should be verified prior to purchase or lease.