

FOR SALE



RARELY AVAILABLE SEVEN FREEHOLD
WAREHOUSING WITH FULL VACANT POSSESSION
ON ESTABLISHED INDUSTRIAL ESTATE
7,438 - 88,781 SQ FT (691 - 8,248 SQ M)

UNITS 1-5

UNITS 8-9

Masterlord Industrial Estate, Leiston, IP16 4JD



Located in Leiston, a town powered by the Sizewell C project – a transformative development creating 70,000 UK jobs, engaging 2,000 suppliers, and driving significant economic and infrastructural investment, with completion expected within 9–12 years.

Key Features

- Close to Sizewell C site
- Office space
- Well maintained
- Eaves height approx 9 metres

Location

Leiston is in the East Suffolk district of Suffolk, close to Saxmundham and Aldeburgh. It sits 25.7 miles north-east of Ipswich and 90 miles north-east of London. Woodbridge is 29 minutes distant and close to the main A12 dual carriageway to Lowestoft and Ipswich.

The Sizewell C project, to construct a 3,200 MWe EPR nuclear power station just outside Leiston. It will create some 70,000 jobs across the UK, and will rely on over 2,000 UK-based suppliers. The project has commenced, with construction taking place over the next 9 to 12 years.

Description

There are 7 units on the site, comprising warehouse units and offices. The units are traditional in style with asbestos roofs and have been well maintained. Eaves height is approx. 9 metres to the haunch.

Energy Efficiency

	EPC
Units 1 - 5*	C
Units 8 - 9**	B

*Valid until 31st August 2034 ** Valid until 30th August 2034

Freehold Accommodation

	Sq m	Sq ft
Unit 1	691.0	7,437.9
Units 2 & 3 + Canteen	2,291.6	24,666.6
Unit 4 + Office	1,238.9	13,335.4
Unit 5	1,123.0	12,087.9
Unit 8	1,458.0	15,693.8
Unit 9	1,445.5	15,559.2
Total	8,248.0	88,780.6

All dimensions approximate

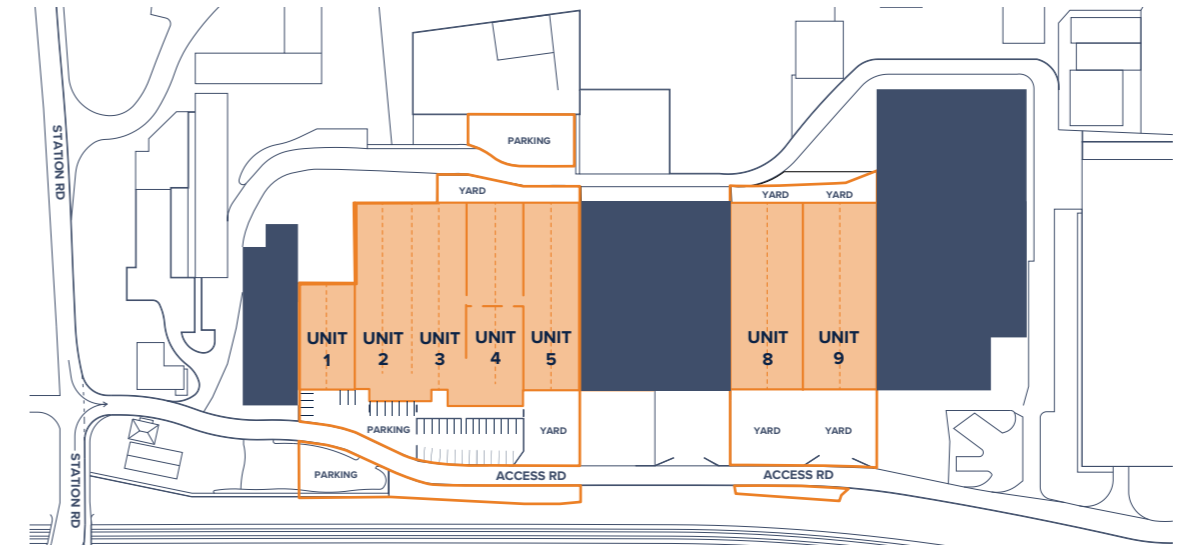

Legal

Rates

We understand that Units 1-6A currently have a combined assessment of £161,000. Units 8-9 have a combined assessment of £70,500.

Planning

All enquiries should be directed to East Suffolk Council, East Suffolk House, Melton, Woodbridge, IP12 1RT.

Price

Price on application

Legal Costs

Each party to bear their own legal costs.

Viewing

Strictly by prior appointment with the joint sole agents:

Penn Commercial

Contact:

07721 922946

vanessa@penncommercial.co.uk

www.penncommercial.co.uk

JLL

Contact:

07801 667692

james.saxby@jll.com

www.jll.co.uk



penncommercial.co.uk



Notices relating to Property Misrepresentation, Property Misdescriptions & Financial Services Acts: Penn Commercial as agents for vendors/lessors of this property gives notices that: 1. The information contained within these particulars has been checked and is understood to be materially correct at the date of publication. 2. All descriptions, statements, dimensions, references to availabilities, conditions and permissions for use, and occupations of other details are given in good faith. However, they are made without responsibility, and should not be relied upon as representations of fact. Intending purchasers or tenants should by enquiry to this office satisfy themselves as to the correctness and availability in each case before arrangements are made to travel and view. 3. Unless otherwise stated, all prices, rents and other charges are quoted exclusive of value added tax (VAT). Any intending purchasers or tenants must satisfy themselves independently as to the incidence of VAT in respect to any transaction. 4. All plant machinery, equipment, services and fixtures and fittings referred to in these particulars were present at the date of publication. They have not however, been tested and, nor any person in their employment have any authority to make or give, any representation or warranty whatsoever in relation to this property. 7. Penn Commercial does not hold itself out as providing any legal financial or other advice. These particulars do not constitute advice and you should not rely on this material in making (or refraining from making) any decision to take (or refrain from taking) any action. 8. The information contained in these particulars is of a general nature and may not be applicable to your own specific circumstances. If you are in any doubt, please seek professional advice.