

WATERLOO COMMONS

150 Waterloo Commons Dr - Waterloo, IL 62298



PROPERTY HIGHLIGHTS

- Anchored by **Schnucks**, the Midwest's premier grocery retailer
- Excellent mix of national and regional businesses which drive consumer traffic
- Located at the busy intersection of IL Hwy - 3 (15,000 vpd) and N Market St (12,000 vpd)

PROPERTY DETAILS

- Center Size: 67,163 sf
- Available Suites: 156 - 1,200 SF 180 - 4,156 sf

Demographics	1 mile	3 mile	5 mile
Population	2,274	10,876	15,011
Avg HH Income	\$75,937	\$87,037	\$94,409



Charlie Faron 314.994.2348 cfaron@descogroup.com

25 N Brentwood Blvd
 St. Louis, MO 63105
 314.994.4444
 descogroup.com

The
DESCO
 Group

WATERLOO COMMONS

150 Waterloo Commons Dr - Waterloo, IL 62298

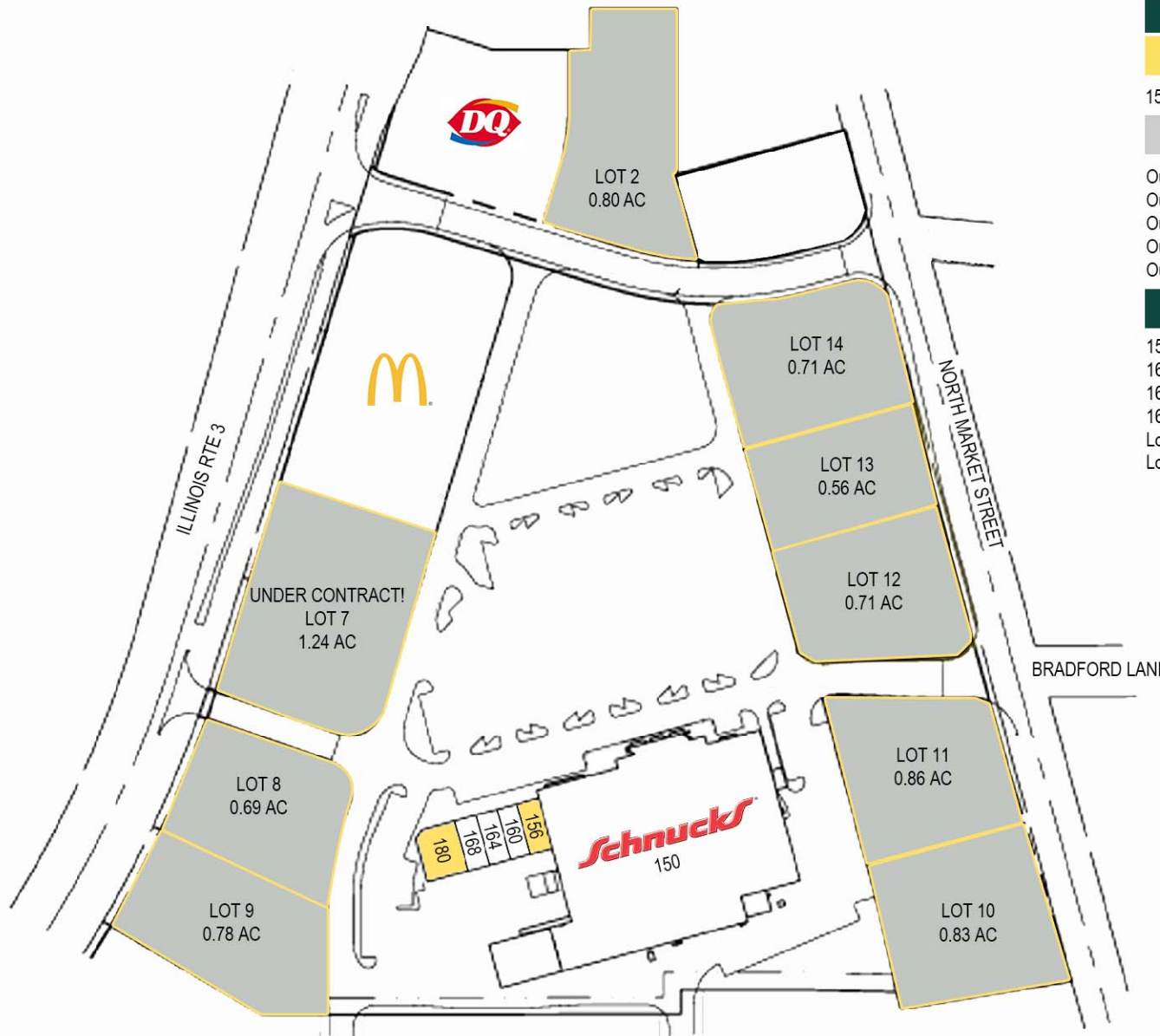

CENTER SIZE 67,163 SF

AVAILABLE SPACE

156	1,200 sf	180	4,156 sf
-----	----------	-----	----------

AVAILABLE OUTLOTS

Outlot 2	0.80 ac	Outlot 7	1.24 ac
Outlot 8	0.69 ac	Outlot 9	0.78 ac
Outlot 10	0.83 ac	Outlot 11	0.86 ac
Outlot 12	0.71 ac	Outlot 13	0.56 ac
Outlot 14	0.71 ac	Outlot 15	0.58 ac

CURRENT RETAILERS

150	Schnucks	58,207 sf
160	Lily's Nails & Spa	1,200 sf
164	Look After Hair Co.	1,200 sf
168	Edward Jones	1,200 sf
Lot 3	Dairy Queen	0 sf
Lot 4	McDonalds	0 sf

Charlie Faron 314.994.2348 cfaron@descogroup.com

25 N Brentwood Blvd
 St. Louis, MO 63105
 314.994.4444
 descogroup.com

