

## Lake Eola

Portfolio of 5 Properties for Sale

**Joann C. Eldred**  
joannce10@gmail.com  
(407) 862-1200

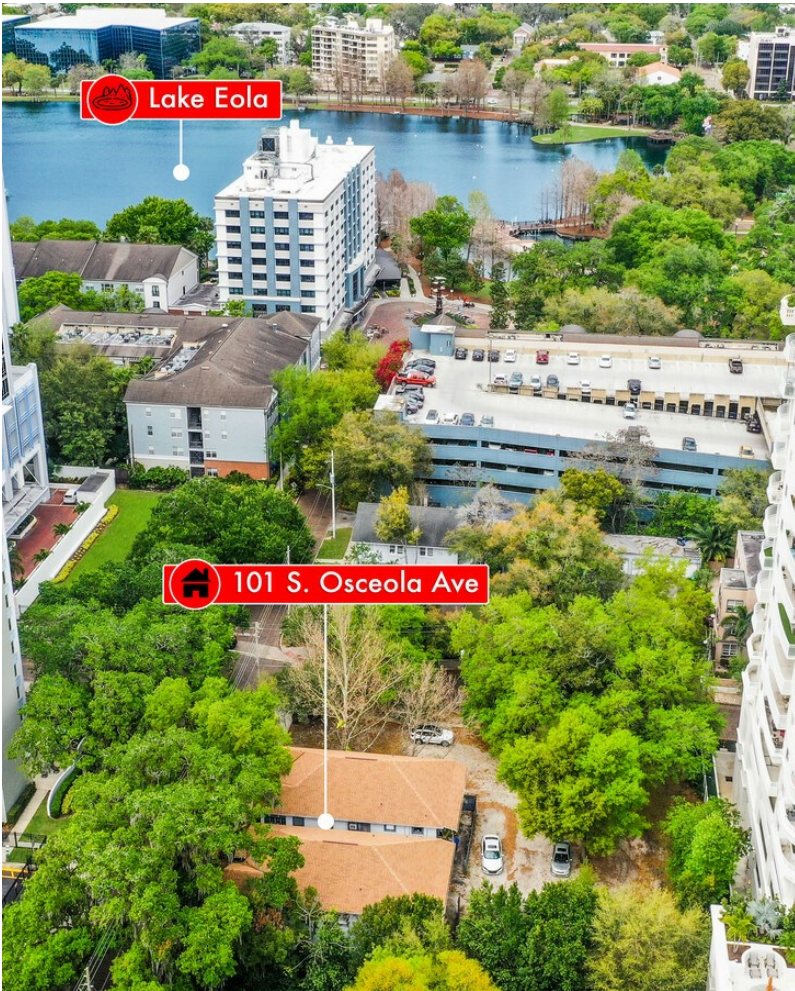

# Lake Eola

\$7,999,999

Located in the heart of downtown Orlando one block from Lake Eola. Here is your opportunity to buy a prime location for future development. A PORTFOLIO OF 5 ADJACENT LOTS ZONED MXD-2/T, SUITABLE FOR MIXED-USE DEVELOPMENT POSSIBLY OVER TWENTY STORIES HIGH AND SURROUNDED BY HIGHRISES. The total site measures 0.59 acres with total of 25,804.11 square feet of land. The site is immediately adjacent to The Sanctuary multifamily development, one block South of Lake Eola and benefits from numerous walkable amenities including dining, shopping, and recreation.

The South Eola neighborhood is the most walkable neighborhood in Orlando featuring brick paved streets shaded by oak trees within a short walking distance to Lake Eola Park, a hub for restaurants, shopping, dining, and special events. This distinctive area combine the best of Orlando, natural beauty, history, fun events and the Orlando Farmers Market.

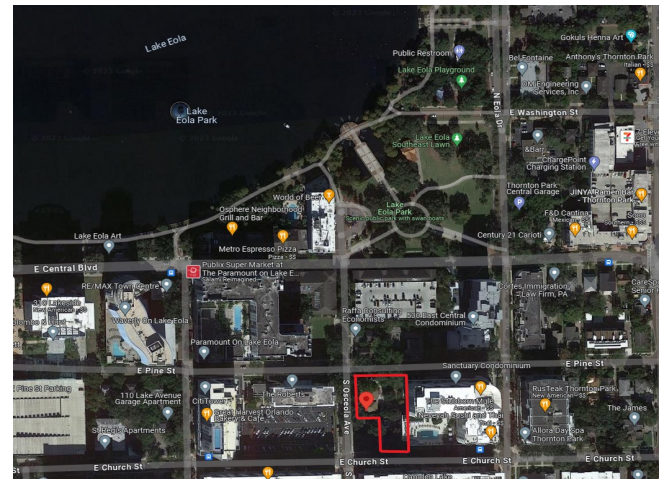

- A+ Location Opportunity Lake Eola Downtown
- Orlando Area, Prime For Development
- Zoned Mixed Use MXD-2/T

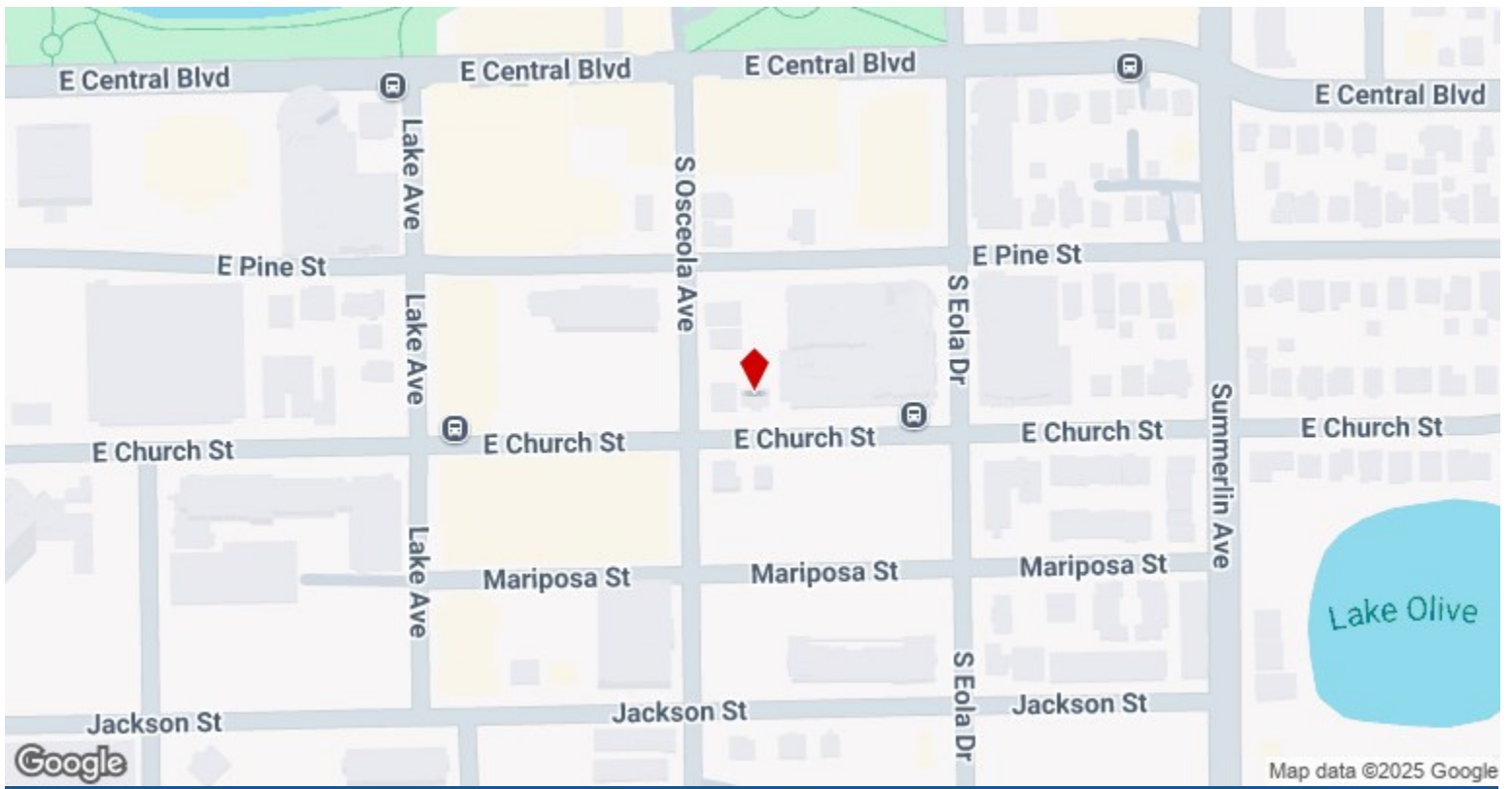

Price:	\$7,999,999
Price / SF:	\$311.28 / SF
Sale Type:	Investment
Status:	Active
Number of Properties:	5
Total Building Size:	0.00 SF
Total Land Area:	0.59 AC



### Lake Eola

Property Name/Address, City, State	Property Type	Size	Year Built	Individual Price
 509 E Church St Bldg 1, Orlando, FL	Land	0.18		
 101 S Osceola Ave Bldg 1, Orlando, FL	Land	0.11		
 103 S Osceola Ave Bldg 1, Orlando, FL	Land	0.09		
 109 S Osceola Ave, Orlando, FL	Land	0.09		
 510 E Pine St Bldg 1, Orlando, FL	Land	0.12		

# Property Photos

