

AVISON
YOUNG



Flex/Industrial space for lease

1010 E Pettigrew Street, Durham, NC 27701

±2,734 - 12,500 SF available for lease

PROPERTY OVERVIEW

FLEX/INDUSTRIAL SPACE FOR LEASE

Property highlights

- Flex/Industrial for lease in Durham
- ±2,734 - ±12,500 SF available
- Outdoor storage with gated access available
- Loading dock access
- Drive-in access
- Common area restrooms and break space
- Separately metered 3-phase, 400 amp per unit

Property details

Address:	1010 E Pettigrew Street
City, State, Zip:	Durham, NC 27701
Available SF:	±2,734 - ±12,500 SF
Building SF:	±12,500 SF
Year Built / Renovated:	1953 / 2025
Ceiling Height:	12' - 16'
Power:	3 Phase, 400-amp per unit
Market:	Raleigh/Durham
Submarket:	South Durham
Lease Rate:	Contact Broker

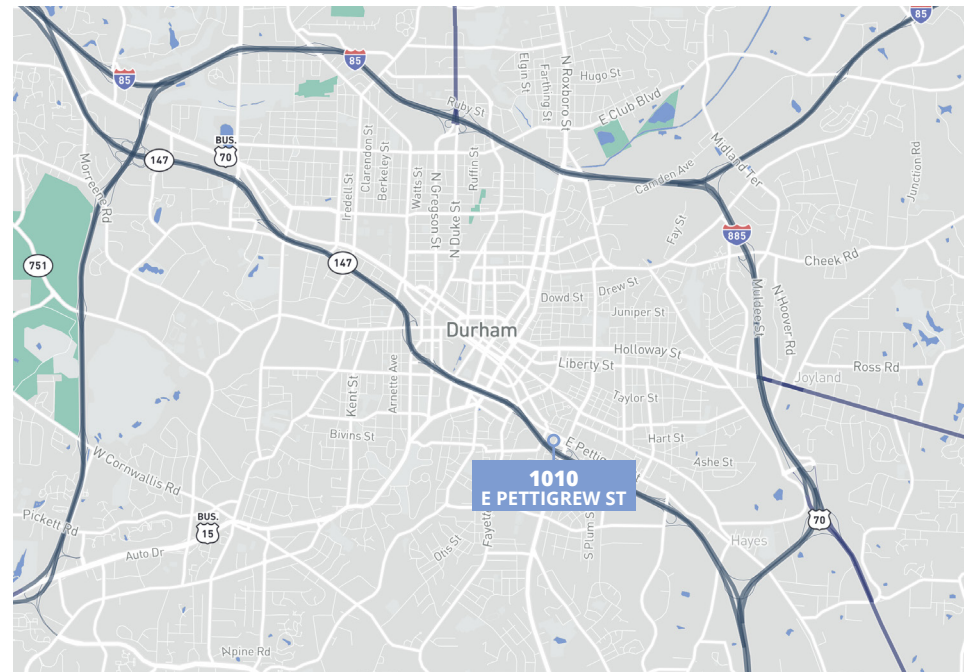

ADDITIONAL PHOTOS

FLEX/INDUSTRIAL SPACE FOR LEASE



FLOOR PLAN

FLEX/INDUSTRIAL SPACE FOR LEASE

PROPOSED SUITE CONFIGURATIONS

- Unit A ±3,128 SF
- Unit B ±2,734 SF
- Unit C ±3,161 SF

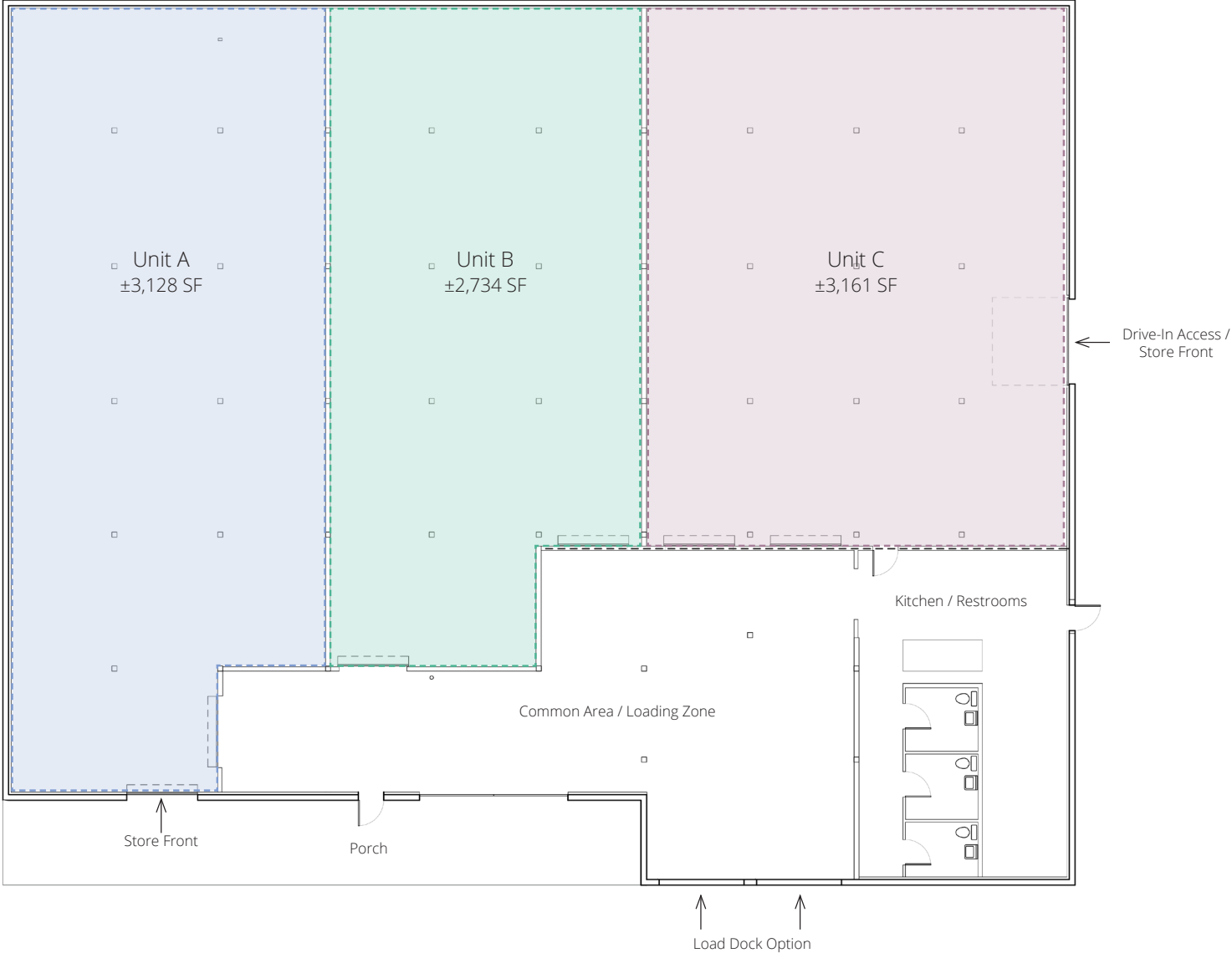

AREA OVERVIEW

FLEX/INDUSTRIAL SPACE FOR LEASE

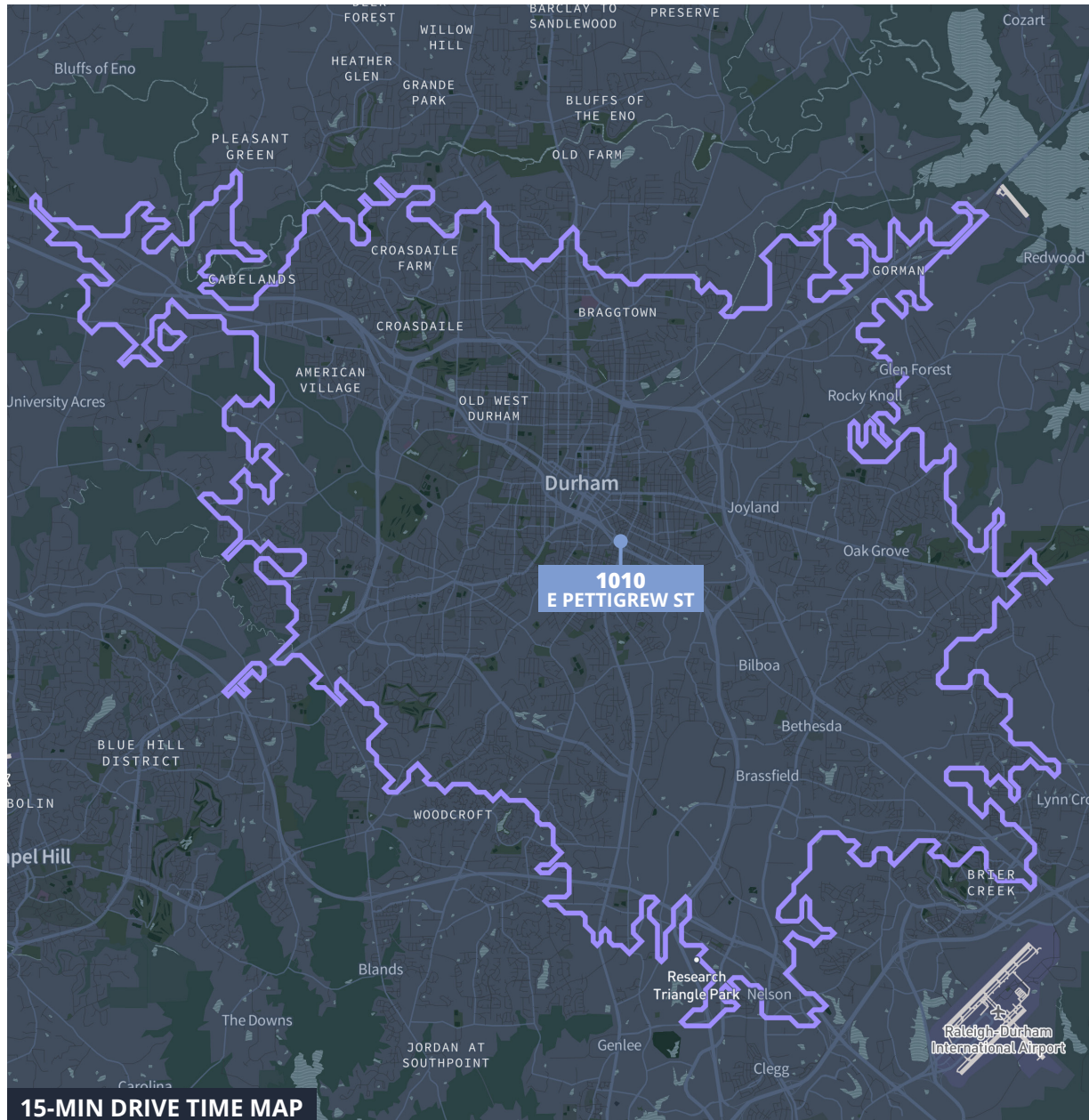

Key demographics



218,257
population



\$111,853
average hh income



\$391,669
median house value



9,515
surrounding businesses

Get in touch.

John Gainey

Senior Vice President

+1 919 622 9600

john.gainey@avisonyoung.com

James Eagle

Senior Associate

+1 919 622 1637

james.eagle@avisonyoung.com

Visit us online
avisonyoung.com

©2026 Avison Young Commercial Real Estate Services, LP, Commercial Real Estate Agency. All rights reserved.

E. & O.E.: The information contained herein was obtained from sources which we deem reliable and, while thought to be correct, is not guaranteed by Avison Young.

**AVISON
YOUNG**