

FOR SALE OR LEASE

1815 WEST 500 SOUTH
SALT LAKE CITY, UT



FEATURES

- Acres: 2.0 (Approx. 150'x180')
- Yard: 68,000 SF of gravel surface
- Parameter: Full fenced
- Building: 8,500 SF
- Office/Assembly: 3,800 SF
- Overhead Doors: 1 - 20'x20'
1 - 18'x20'
- Zoning: MU-6 with M-1 like overlay
- Parking Stalls: 23 (on asphalt)
- 4-Connex with roof



Contact

KYLE MCMULLIN

Senior Director
801 303 5480
kyle.mcmullin@cushwake.com

Cushman & Wakefield
170 South Main Street, Suite 1600
Salt Lake City, UT 84101
+1 801.322.2000
cushmanwakefield.com

FOR SALE OR LEASE

1815 WEST 500 SOUTH
SALT LAKE CITY, UT

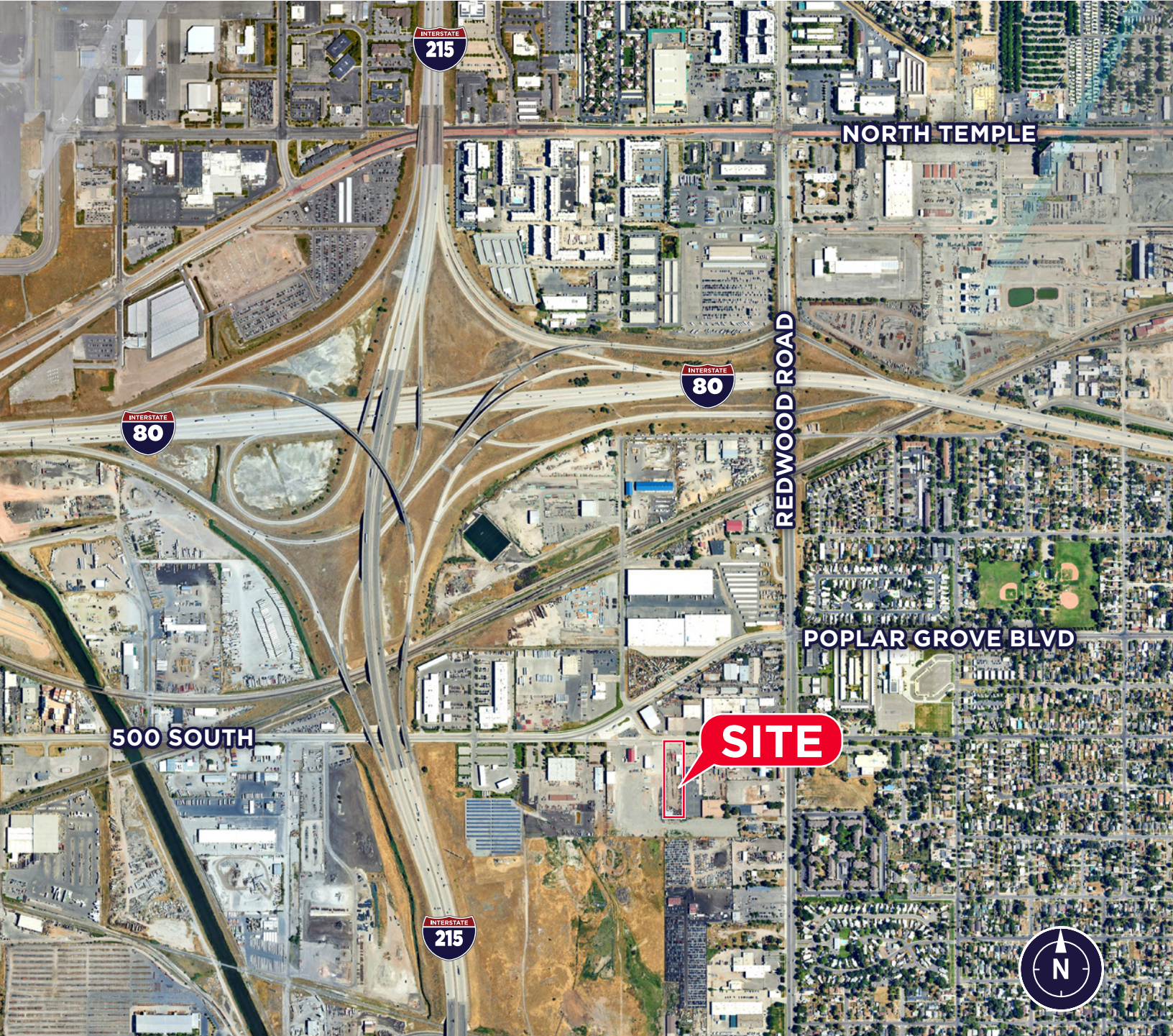

Contact

KYLE MCMULLIN

Senior Director
801 303 5480

kyle.mcmullin@cushwake.com

Cushman & Wakefield
170 South Main Street, Suite 1600
Salt Lake City, UT 84101
+1 801.322.2000
cushmanwakefield.com

Cushman & Wakefield Copyright 2026. No warranty or representation, express or implied, is made to the accuracy or completeness of the information contained herein, and same is submitted subject to errors, omissions, change of price, rental or other conditions, withdrawal without notice, and to any special listing conditions imposed by the property owner(s). As applicable, we make no representation as to the condition of the property (or properties) in question. (path: G:\Shared\Apps\Gigas\1 - Projects\McMullin, K\1 - Flyers\1815West500South)