



For Lease | 1000 Station Drive

Dupont, WA

Well-maintained office space within walking distance to local amenities and offering immediate access to the highway.

PROPERTY HIGHLIGHTS

- + Well-maintained building on attractive, landscaped grounds
- + Monument and building signage
- + Free on-site parking; ratio approx. 4.3/1,000 RSF
- + Visibility and close access to I-5 via Exit 119
- + Adjacent to Joint Base Lewis-McChord, Hampton Inn, Home2Suites by Hilton and walking distance to Starbucks, restaurants and other services
- + Building available to purchase - Contact Brokers

OFFICE SF AVAILABLE

953 - 5,379 SF

PRICE/SF

**\$16.00 - \$20.00
PSF/YR**

TYPE

NNN



THE INFORMATION CONTAINED HEREIN HAS BEEN GIVEN TO US BY THE OWNER OF THE PROPERTY OR OTHER SOURCES WE DEEM RELIABLE. WE HAVE NO REASON TO DOUBT ITS ACCURACY, BUT WE DO NOT GUARANTEE IT. ALL INFORMATION SHOULD BE VERIFIED PRIOR TO PURCHASE OR LEASE.

STEVE BALKMAN, CCIM

Principal
+1 425 586 5606
sbalkman@nai-pp.com

GREG GADDIS, CCIM, SIOR

Partner | Tenant Realty Advisors
+1 208 333 7052
greg@tenantrealtyadvisors.com

Floor Plan

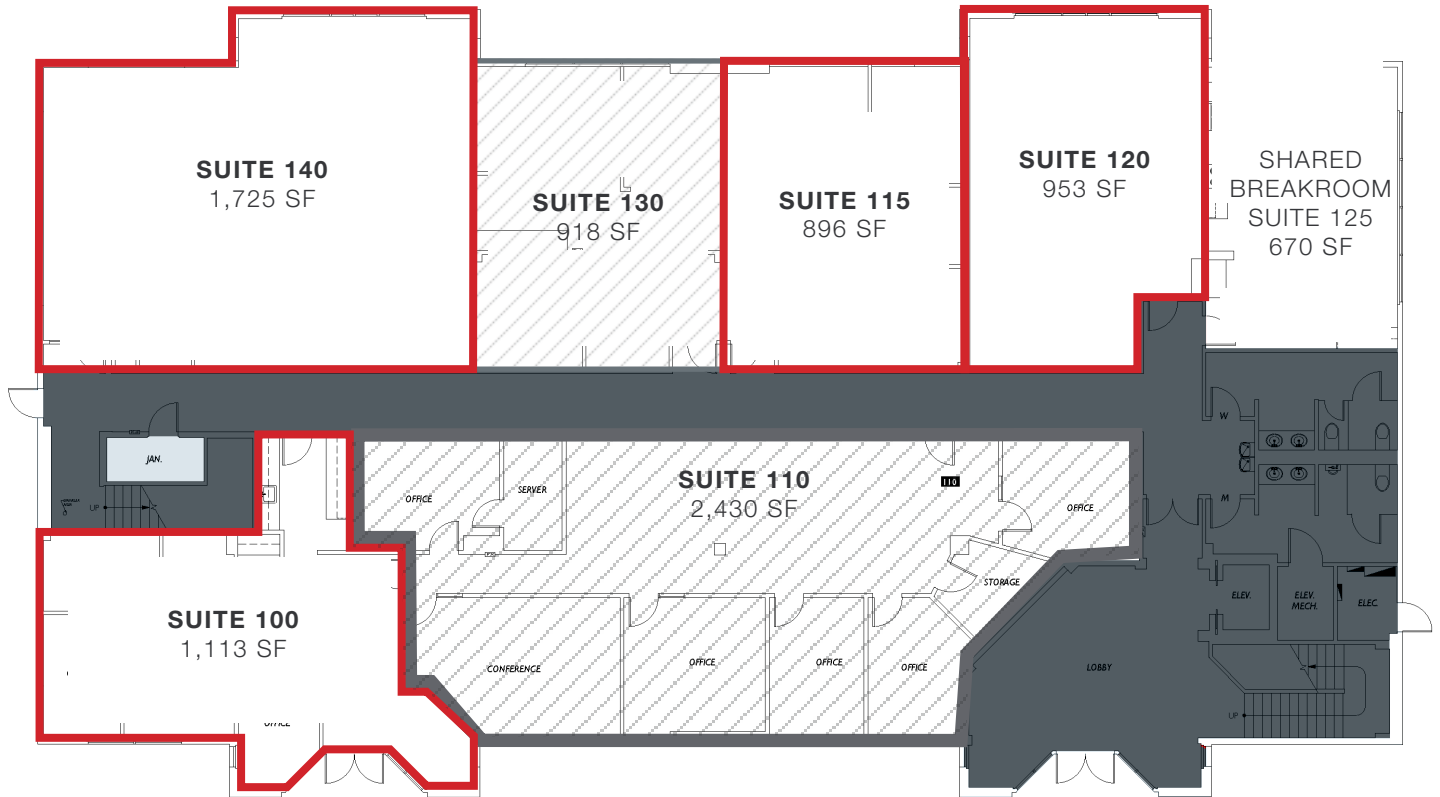

Available Spaces

SUITE 100	1,113 SF	\$16.00 PSF/YR	Exterior Entry
SUITE 115	896 SF	\$16.00 PSF/YR	Can be combined with Suite 120
SUITE 120	953 SF	\$16.00 PSF/YR	Can be combined with Suite 115, TI allowance provided
SUITE 140	1,725 SF	\$20.00 PSF/YR	Exterior Entry, TI allowance provided

STEVE BALKMAN, CCIM
Principal
+1 425 586 5606
sbalkman@nai-ppsp.com

GREG GADDIS, CCIM, SIOR
Partner | Tenant Realty Advisors
+1 208 333 7052
greg@tenantrealtyadvisors.com



*Office space for lease
in Dupont near I-5*



STEVE BALKMAN, CCIM
Principal
+1 425 586 5606
sbalkman@nai-ppsp.com

GREG GADDIS, CCIM, SIOR
Partner | Tenant Realty Advisors
+1 208 333 7052
greg@tenantrealtyadvisors.com





Main building entrance



Proximity to I-5

STEVE BALKMAN, CCIM
Principal
+1 425 586 5606
sbalkman@nai-psp.com

GREG GADDIS, CCIM, SIOR
Partner | Tenant Realty Advisors
+1 208 333 7052
greg@tenantrealtyadvisors.com

