

FOR LEASE

The Dimeo Building Redmond Industrial Space

494 SW Veterans Way, Unit 6, Redmond, OR 97756

9,000 SF | ~~\$0.95/SF/MO. NNN~~

RATE REDUCED
Was \$0.95/SF/Mo. NNN

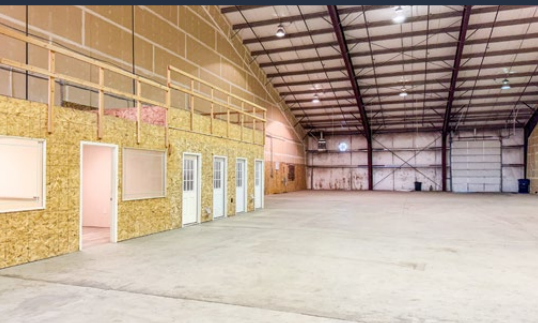

PROPERTY DETAILS

Suite 6:	9,000 SF
Lease Rate:	\$0.95/SF/Mo. NNN \$0.85/SF/Mo. NNN
CAMs:	Est. at \$0.20/SF/Mo.
Bldg. Size:	69,103 SF
Zoning:	Light Industrial (M2)

HIGHLIGHTS

- Large open warehouse with two grade level 14' roll up doors
- Four private offices, breakroom, two restrooms, and four storage closets plus mezzanine above offices
- 22' eve – 32' at center (clear span)
- 3-phase power
- Ample on-site parking

Dan Kemp, CCIM | Emilio Tiscareno, Broker

600 SW Columbia St., Ste. 6100 | Bend, OR 97702

541.383.2444 | www.CompassCommercial.com

COMPASS
COMMERCIAL

REAL ESTATE SERVICES

FOR LEASE

9,000 SF | ~~\$0.95/SF/MO. NNN~~

The Dimeo Building Redmond Industrial Space

494 SW Veterans Way, Unit 6, Redmond, OR 97756

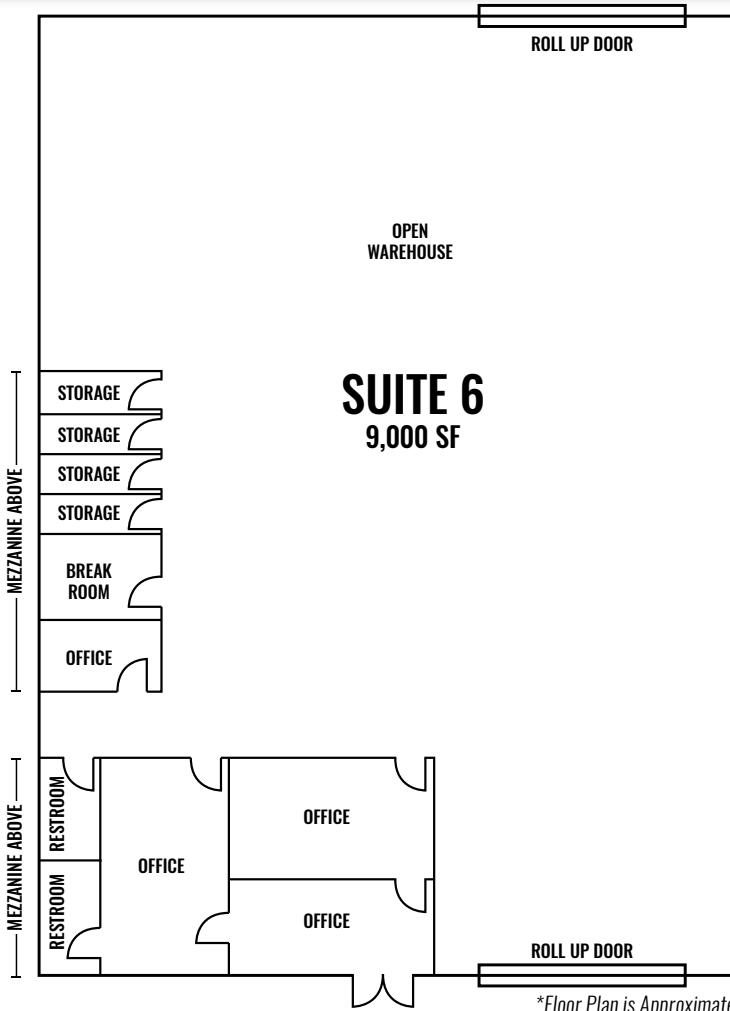

Brokers are licensed in the state of Oregon. This information has been furnished from sources we deem reliable, but for which we assume no liability. This is an exclusive listing. The information contained herein is given in confidence with the understanding that all negotiations pertaining to this property be handled through Compass Commercial Real Estate Services. All measurements are approximate.



Dan Kemp, CCIM
Partner, Principal Broker
Cell 541.550.8413
dkemp@compasscommercial.com



Emilio Tiscareno
Broker
Cell 541.213.9640
etiscareno@compasscommercial.com

COMPASS
COMMERCIAL

REAL ESTATE SERVICES