



SHEA

MEDICAL PLAZA
7425 E Shea, Scottsdale, AZ

Medical Spec Suite Available with First Floor Lobby Exposure in Scottsdale

REPRESENTED BY

RACHAEL THOMPSON
602.513.5122
rachael.thompson@kidder.com

PERRY GABUZZI, CCIM
602.513.5116
perry.gabuzzi@kidder.com

kidder.com



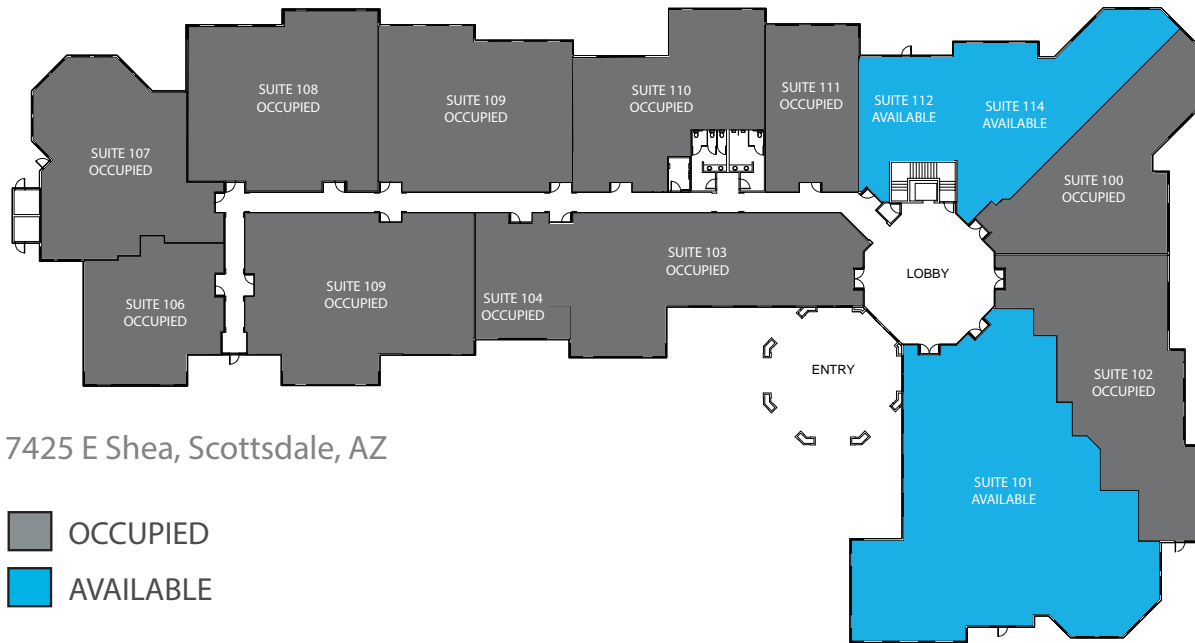

AVAILABLE SPACES

Suite 114 2,729 SF - Spec Suite

Suite 112 1,193 SF

Suite 101 8,174 SF

FEATURES

- Premier Scottsdale off-campus location for healthcare providers
- Brand new spec suite available for immediate occupancy
- 4.5/1,000 parking ratio
- Underground parking garage offers free covered parking for visitors and tenants with internal elevator access
- Prominent building signage available
- No use restrictions



STRATEGIC LOCATION

- Prominent location on heavily traveled Shea Boulevard
- Near Honor Health, Shea and Osborn Campuses
- Highly desirable market demographics
- Superior access on a signalized intersection

Drive Times

1 min	Scottsdale Rd & Shea Blvd
2 min	to Loop 101
5 min	Honor Health



64,284
Population



\$137,169
HH Income



47,434
Traffic count



LOOP 101

HONORHEALTH™

LOOP 101

Starfire Golf Club

N Hayden Rd

E Shea Blvd

SHEA MEDICAL PLAZA

Gainey Ranch Golf Club

N Scottsdale Rd



FOR LEASING INFORMATION CONTACT

RACHAEL THOMPSON
602.513.5122 | rachael.thompson@kidder.com

PERRY GABUZZI, CCIM
602.513.5123 | perry.gabuzzi@kidder.com

kidder.com

This information supplied herein is from sources we deem reliable. It is provided without any representation, warranty or guarantee, expressed or implied as to its accuracy. Prospective Buyer or Tenant should conduct an independent investigation and verification of all matters deemed to be material, including, but not limited to, statements of income and expenses. Consult your attorney, accountant, or other professional advisor.

