

EQUIPMENT SCHEDULE					
TAG NO.	QUANTITY	FIXTURE/ EQUIPMENT TYPE	DESCRIPTION	MANUFACTURER/MODEL NO.	COMMENTS
L-1	5	LAVATORY	HOT AND COLD WATER SINK FAUCET	CHICAGO FAUCETS, #772-GN8AE35ABCP	MEN'S RESTROOM(2), WOMEN'S RESTROOM (2)
S-1	5	SINK	CAXTON RECTANGLE SINK	KOHLER, K-20000-0, WHITE	MEN'S RESTROOM(2), WOMEN'S RESTROOM (3)
WC-1	4	ELONGATED TOILET SEAT	HIGHLINE	KOHLER, K-4405-0, WHITE	MEN'S RESTROOM(2), WOMEN'S RESTROOM (3)
WC-2	4	ELONGATED TOILET SEAT	STRONGHOLD	KOHLER, K-4731-C-0	MEN'S RESTROOM(2), WOMEN'S RESTROOM (3)
WC-3	4	FLUSH VALVE	1/8 GPF FLUSH VALVE	KOHLER, K-13516-CP	MEN'S RESTROOM(2), WOMEN'S RESTROOM (3)
DW-1	1	DISHWASHER	24IN STAINLESS BUILT-IN DISHWASHER	FRIGIDAIRE, FGCD2444SA	BREAKROOM KITCHEN(1)
RF-1	1	REFRIGERATOR	SIDE BY SIDE FRIDGE W/ WATER DISPENSER	FRIGIDAIRE, FFSC2323TS	BREAKROOM KITCHEN(1)
SH-1	1	SHOWER HEAD/VALVE	SHOWER HEAD/VALVE	CHICAGO FAUCETS, #SH-PB1-01-000	SHOWER ROOM(1)
L-2	1	LAVATORY	HOT AND COLD WATER SINK FAUCET	CHICAGO FAUCETS, #1100-G2E3-317AB	BREAKROOM KITCHEN(1)
S-1	1	SINK	VERSE	KOHLER, K-20060-3-NA	BREAKROOM KITCHEN(1)
SH-2	1	SHOWER STALL	FREEWILL - 45" X 37-1/4" SHOWER STALL	KOHLER, K-12101-C	SHOWER ROOM(1)
M-1	2	MIRROR	B-SERIES - CHANNEL-FRAME MIRROR	BOBRICK, B-165 3696	MEN'S RESTROOM(1), WOMEN'S RESTROOM(1)

FLOOR PLAN GENERAL NOTES

- ALL DIMENSIONS ARE TO THE FACE OF STUD, STRUCTURAL CENTER LINES, TO FACE OF MASONRY OR CONCRETE.
- SEE INTERIOR ELEVATIONS, WALL SECTIONS, AND DETAILS FOR HEIGHTS OF OPENINGS, COUNTERS, SHELVING, ETC.
- DO NOT SCALE THE DRAWINGS, IF THERE ARE ANY COORDINATION QUESTIONS OR DIMENSIONAL DISCREPANCIES THE CONTRACTOR IS RESPONSIBLE FOR OBTAINING A CLARIFICATION FROM THE ARCHITECT PRIOR TO PROCEEDING WITH WORK IN QUESTION OR RELATED WORK.
- ARCHITECTURAL DIMENSIONS TAKE PRECEDENCE OVER ENGINEERING DRAWINGS FOR ELECTRICAL DEVICE LOCATION.
- SEE WALL SECTIONS AND PARTITION DETAILS FOR WALL AND FURRING THICKNESS.
- ALL WALLS AND DOOR FRAMES SHALL BE INSTALLED TO ALLOW 18" ADA CLEARANCE TO PERPENDICULAR WALL FROM LATCH JAMB OF DOOR. UNO. CONSULT ARCHITECT WITH ANY CONFLICT ON DRAWING DIMENSIONS BEFORE PROCEEDING. DOOR FRAMES SHALL BE INSTALLED 4" TO PERPENDICULAR WALL FROM HINGE JAMB OF DOOR. UNO.
- STUDS AROUND MECHANICAL SHAFTS SHALL BE INSTALLED AS TIGHTLY AS POSSIBLE AROUND DUCTS AND PIPES TO MINIMIZE SHAFT DIMENSIONS.
- THICKEN OR FURR AND DRYWALL ALL PARTITIONS AS REQUIRED FOR ELECTRICAL PANELS, ROOF DRAIN LEADERS, ALL PLUMBING SOIL STACKS, AND OTHER RECESSED ITEMS. SEE ALSO ENGINEERING DRAWINGS FOR INFORMATION. WALLS CONTAINING PLUMBING AND POWER PANELS SHALL BE CONSTRUCTED WITH 4" METAL STUDS. UNO. REFER TO PLUMBING AND ELECTRICAL POWER PLANS.
- REFER TO PARTITION DETAILS ON SHEET G002 FOR MORE INFORMATION.

FLOOR PLAN SYMBOLS LEGEND

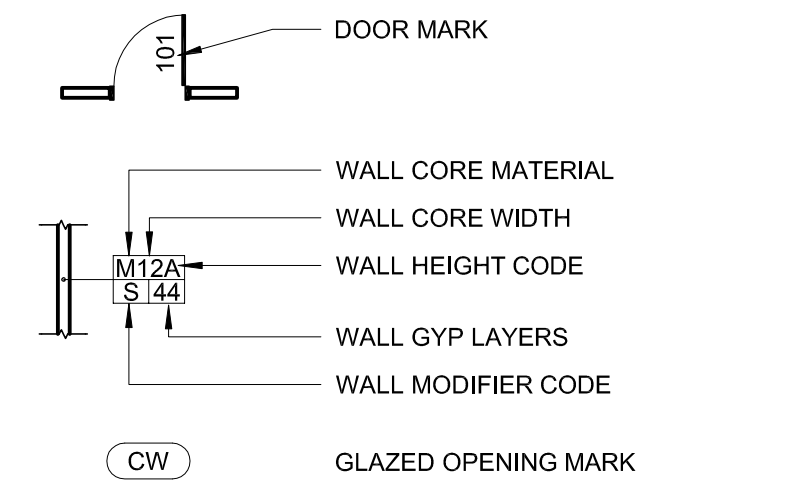

KEYNOTE LEGEND

KEY	NOTE
A08.01	INSTALL NEW ACCESS DOOR AT EXISTING OPENING IN MEN'S RESTROOM BELOW RESTROOM SINK AS INDICATED. COORDINATE WITH OWNER.
A09.01	PATCH AND PAINT EXISTING GYPSUM BOARD. SIZE OF OPENINGS IN EXISTING GYPSUM BOARD RANGE FROM PEN HOLE SIZE TO ELECTRICAL OUTLET SIZE. FOR BIDDING PURPOSES, ASSUME 20 SQUARE FEET OF PATCHING WORK.
A09.03	PROVIDE WALL TYPE S3A-01 TO APPROXIMATELY 13'-9 1/4" ABOVE FINISHED FLOOR TO UNDERSIDE OF DECK (V.I.F.). NEW STUDS TO BE SECURED TO EXISTING WALL STRUCTURE AS REQUIRED. GYPSUM BOARD FROM EXISTING WALL TO NEW WALL SHALL ALIGN.
A12.01	WALL-MOUNTED TELEVISION FOIC. PROVIDE IN WALL BLOCKING. PNERDATA AND CONTROLS REQUIRED FOR A COMPLETE INSTALLATION. COORDINATE LOCATION WITH OWNER PRIOR TO INSTALLATION. REFER TO ELECTRICAL DRAWINGS FOR POWER/DATA AND CONTROL INFORMATION.
A12.03	VERSTEEL PARSONS TABLE INSTALLED PER MANUFACTURERS REQUIREMENTS IN LOCATION SHOWN IN PLAN. FINISH: WILSONART - STANDARD LAMINATE. DESIGNER WHITE, MATTE FINISH
A22.03	INSTALL COAT HOOKS AT INSIDE FACE OF RESTROOM STALL PER ADA CODE STANDARDS. COORDINATE W/ OWNER AND STALL MANUFACTURER FOR PROPER INSTALLATION
A22.04	COFFEE MACHINE FURNISHED BY OWNER AND INSTALLED BY CONTRACTOR. PROVIDE WATERLINE AS REQUIRED. COORDINATE WITH OWNER.
A22.05	REFRIGERATOR FURNISHED BY OWNER AND INSTALLED BY CONTRACTOR. PROVIDE WATERLINE AS REQUIRED. COORDINATE WITH OWNER.
A22.06	DISHWASHER FURNISHED BY OWNER AND INSTALLED BY CONTRACTOR. PROVIDE WATERLINE AS REQUIRED. COORDINATE WITH OWNER.

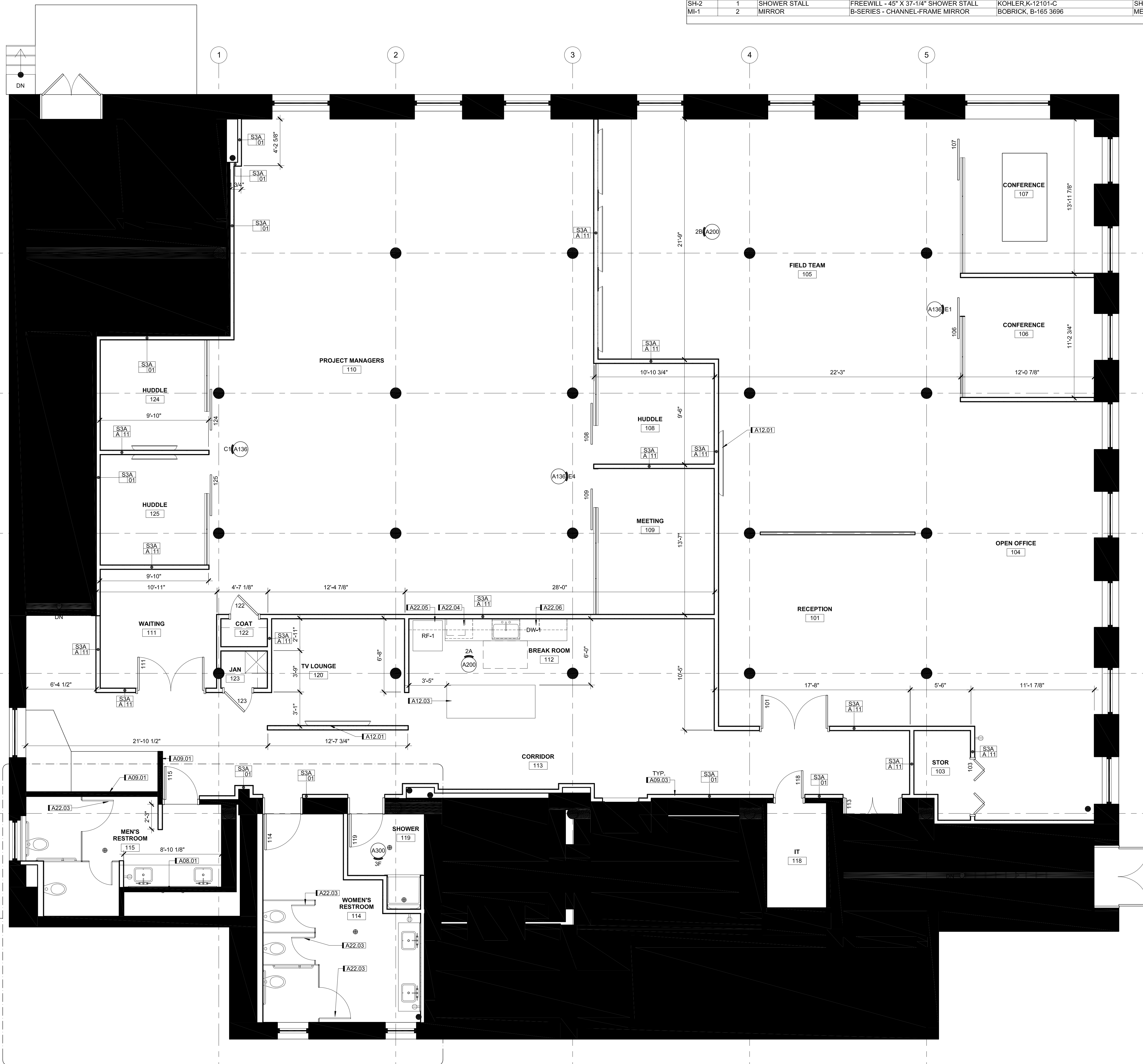

PLAN NORTH  
**6A** FIRST FLOOR - FLOOR PLAN  
 1/4" = 1'-0"  
 0' 6"

440 North Wells Street, Suite 320 | Chicago, Illinois 60654  
 312.324.5500 | FAX: 312.324.5501 | www.ahtje-halbany.com  
 Iowa | Illinois | Indiana  
 Illinois Firm Number: 194-000214

REDMOND CONSTRUCTION OFFICE  
 REDMOND CONSTRUCTION  
 319 W. ONTARIO - 1ST FLOOR

DRAWING: GWP  
 APPROVED: NRH  
 ISSUED FOR: PERMIT  
 DATE: Issm Dtlg  
 PROJECT: N07171490  
 FIELD BOOK:

FLOOR PLAN  
**A131**