

2301 W DR MARTIN LUTHER KING JR BLVD



Tampa, FL 33607

Medical Office For Lease



PROPERTY HIGHLIGHTS

3,200 SF Available

- Parking Ratio: 6.0/1,000 SF
- Prominent Signage Opportunity along MLK (16,224 AADT)
- Shell space with Tenant Improvement Allowance available
- Located less than a mile from St Joseph's Hospital, named one of America's best for five years in a row
- Easy access to I-275, Dale Mabry Hwy, Hillsborough Ave, and Nebraska Ave
- 13 minutes (4.8 miles) from Tampa International Airport
- 12 minutes (3.8 miles) to Downtown Tampa

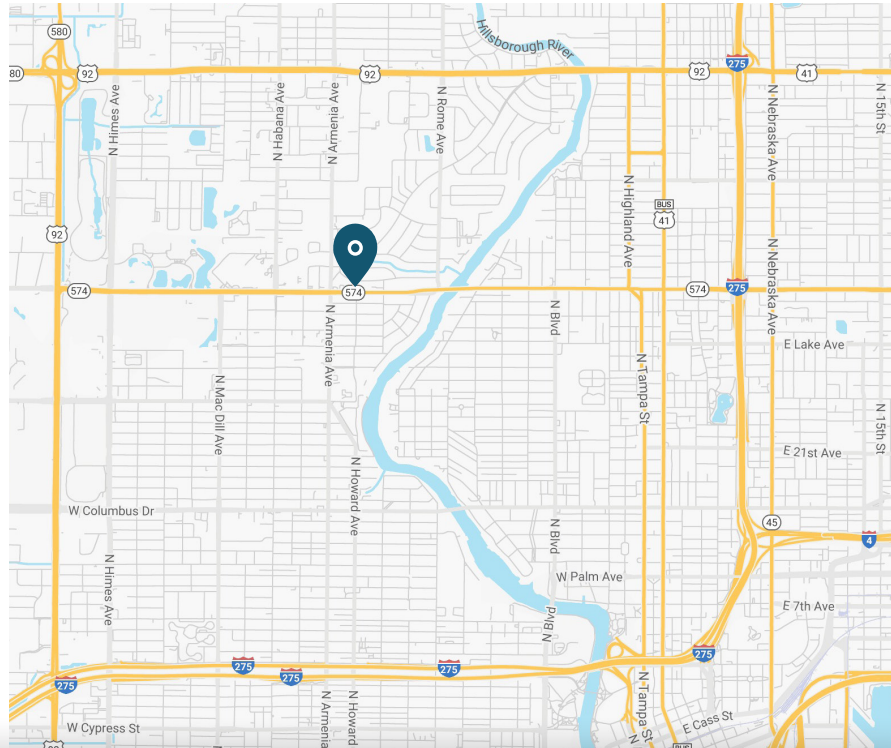

LICENSED REAL ESTATE BROKER | FranklinSt.com

MATT ALEXANDER

Director

813.559.2006

Matthew.Alexander@FranklinSt.com

FLOOR PLAN

3,200 SF Available

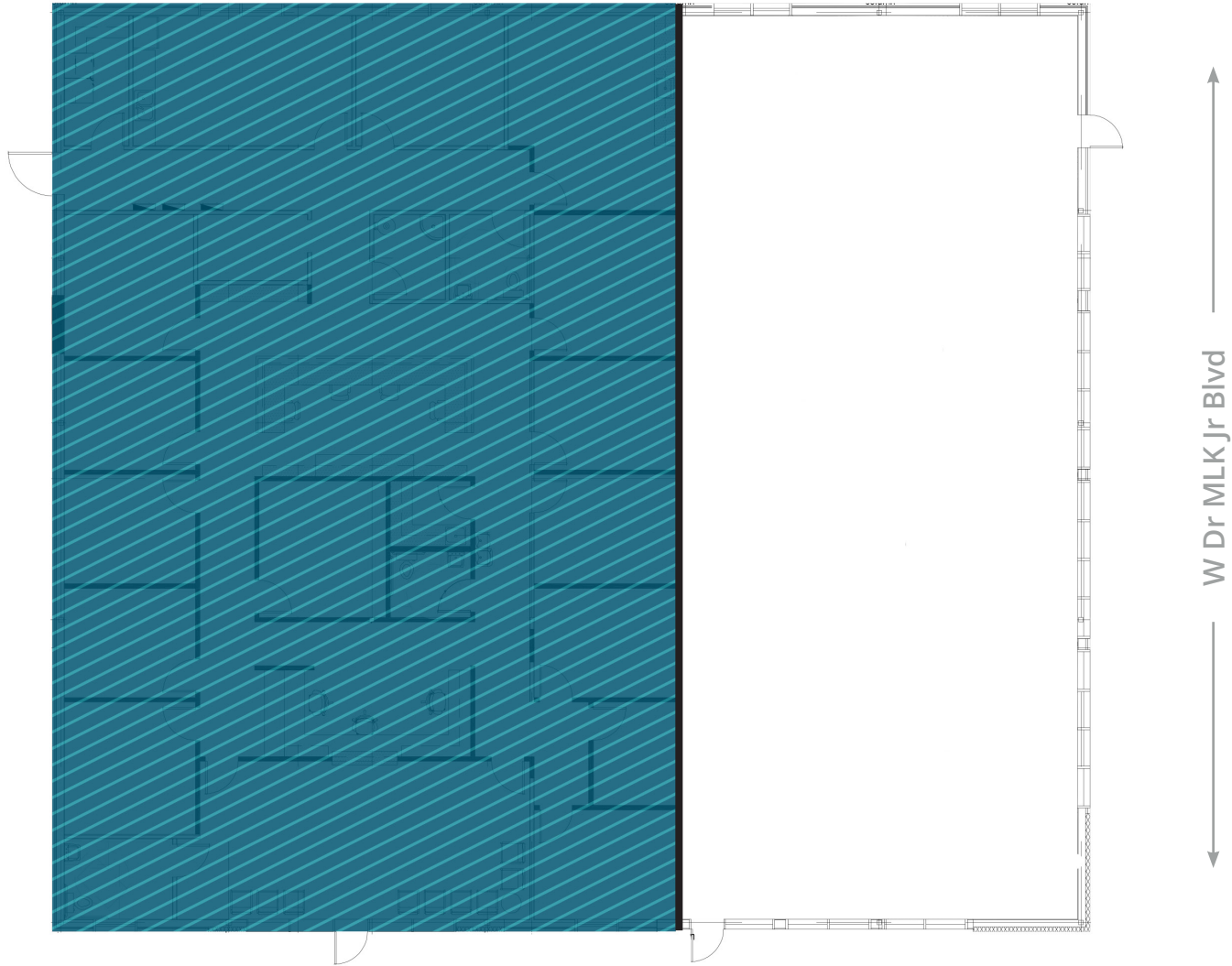

SITE PLAN



 Not Available

