

SPACE FOR LEASE

766 INDUSTRIAL DRIVE
CARY, IL

Features:

- High image; high quality building
- Available: Unit A and B: 1,750 sq. ft. each, or 3,500 sq. ft. combined
- Office space, approximately 300 sq. ft.
- (1) exclusive DID per unit (10' x 12')
- 14.5' clear warehouse
- 125 car parking (entire buildings)
- 200 amps; 3 phase
- Lease rate \$1800.00 modified gross Per Month

For more information or to
arrange for an inspection
please contact:

Daniel Tobin
847-867-2739 (direct)
dtobin@ctkcp.com

1111 E. Touhy, Suite 230
Des Plaines, IL 60018



*Submitted subject to error,
change in status
or withdrawal without notice*



SPACE FOR LEASE

766 INDUSTRIAL DRIVE, CARY, IL

766 INDUSTRIAL DRIVE CARY, ILLINOIS

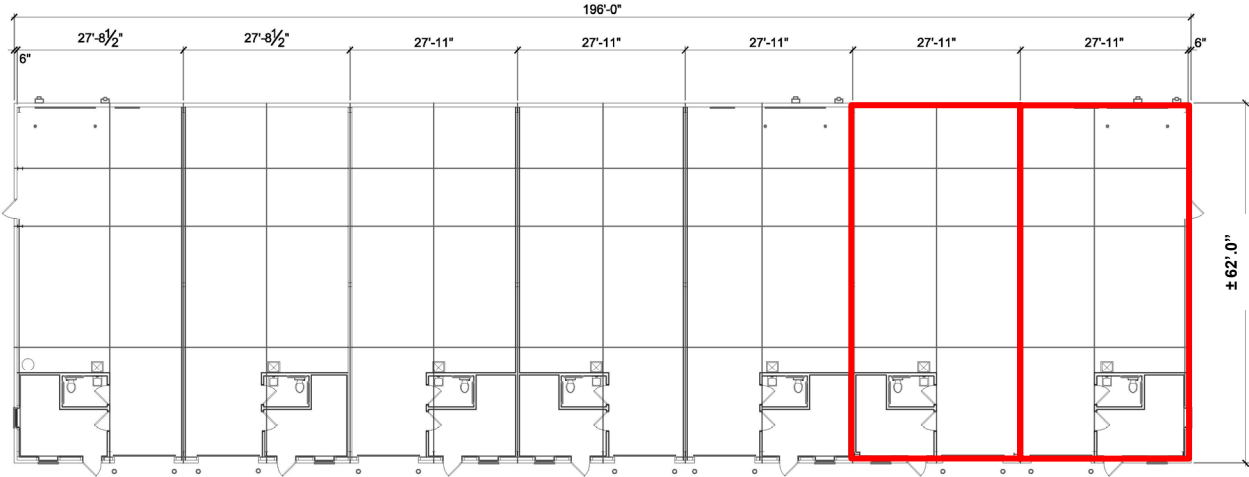

EXIST OVERALL BUILDING PLAN ±11,760 SF

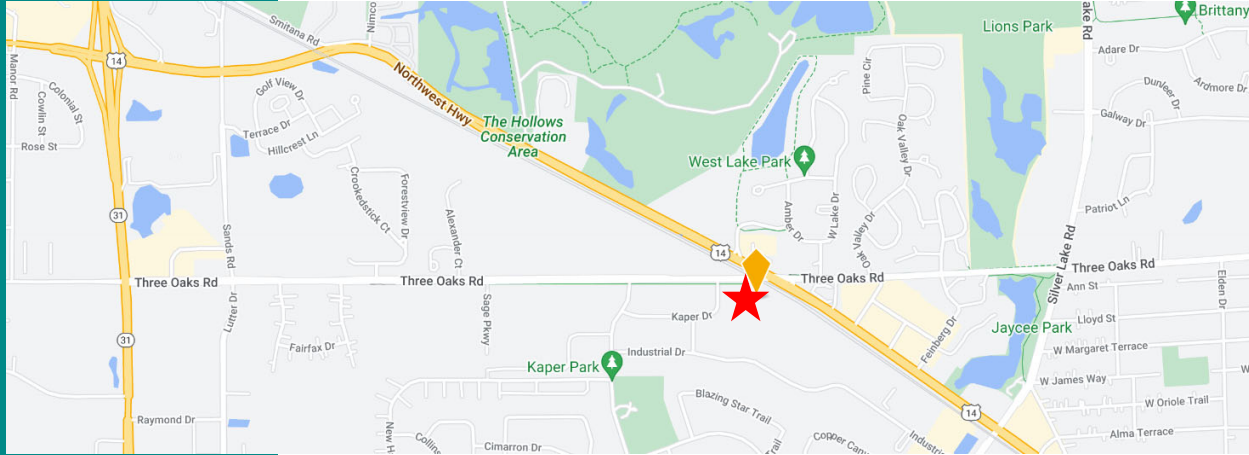

For more information or to
arrange for an inspection
please contact:

Daniel Tobin
847-867-2739 (direct)
dtobin@ctkcp.com

Submitted subject to error,
change in status
or withdrawal without notice

