

LIFE SAFETY NOTES:

LIFE SAFETY PLAN NOTES:

1. SEE SHEET A001 FOR PROJECT GENERAL NOTES.
2. VERIFY COMPLIANCE OF FIRE RATING WITH CODES AND INSURANCE REQUIREMENTS.
3. ALL RATED ASSEMBLIES TO COMPLY WITH TESTED ASSEMBLY STANDARDS. (I.E. UL - UNDERWRITER LABORATORIES, INC.)
4. PROVIDE FIRE-RETARDANT TREATED WOOD FOR CONCEALED BLOCKING AND FOR EXPOSED LUMBER AND PLYWOOD IN HABITABLE SPACE. • LUMBER: AWPA C20093 • PLYWOOD: AWPA C27-93
5. PROVIDE "PANIC HARDWARE" AT ALL EXTERIOR EXITS, AND INTERIOR DOORS AS INDICATED. SEE ARCHITECTURAL HARDWARE SCHEDULE FOR ADDITIONAL INFORMATION.
6. ALL DOORS IN EGRESS PATH INCLUDING EXTERIOR EXITS TO COMPLY WITH ADA REQUIREMENTS TO INCLUDE BUT NOT BE LIMITED TO:
 - DOOR SIZE
 - THRESHOLD HEIGHTS
 - DOOR HARDWARE DESIGN
 - DOOR HARDWARE LOCATIONS
 - HARDWARE ADJUSTMENTS
 - WHEELCHAIR MANEUVERABILITY ACCESS AREAS.
7. PROVIDE "PORTABLE FIRE EXTINGUISHERS" AS DEFINED AND REQUIRED IN FIRE CODE [906].
 - CONFIRM QUANTITY, TYPE, AND LOCATIONS WITH OFFICIALS HAVING JURISDICTION AND LOCAL FIRE MARSHAL PRIOR TO INSTALLATION.
 - FIRE EXTINGUISHERS SHALL BE PROVIDED IN ACCORDANCE WITH INSTALLATION REQUIREMENTS OF NFPA 10, STANDARD FOR PORTABLE FIRE EXTINGUISHERS.
 - INDICATE THE RATING(S) OF THE FIRE EXTINGUISHERS AND THE QUANTITY BASED UPON THE INSTALLATION REQUIREMENTS OF A ORDINARY (MODERATE) HAZARD [IBC 906 AND OCCUPANCY, NFPA 10-9.7.4.1]
 - WHEN ADJACENT TO DOOR MAINTAIN ADA REQUIRED CLEARANCES.
8. PROVIDE AND COORDINATE FIRE DEPARTMENT ACCESS BOX (I.E. KNOX BOX). PROVIDE ONE BOX PER STRUCTURE. [NFPA-1.18.2.2 AND MCER 10-21AM SEC. 80]
 - CONFIRM QUANTITY, TYPE, AND LOCATIONS WITH OFFICIALS HAVING JURISDICTION AND LOCAL FIRE MARSHAL PRIOR TO INSTALLATION.

PORTABLE FIRE EXTINGUISHER LEGEND

- F.E. ABC = 10 LB FIRE EXTINGUISHER
- F.H. = FIRE HOSE SHALL BE PROVIDED AS REQUIRED BY CODE AND AUTHORITIES HAVING JURISDICTION.
- NOTE:
- FINAL LOCATIONS OF PORTABLE FIRE EXTINGUISHERS AND KNOX BOX TO BE CONFIRMED WITH FIRE MARSHAL/ AUTHORITY HAVING JURISDICTION

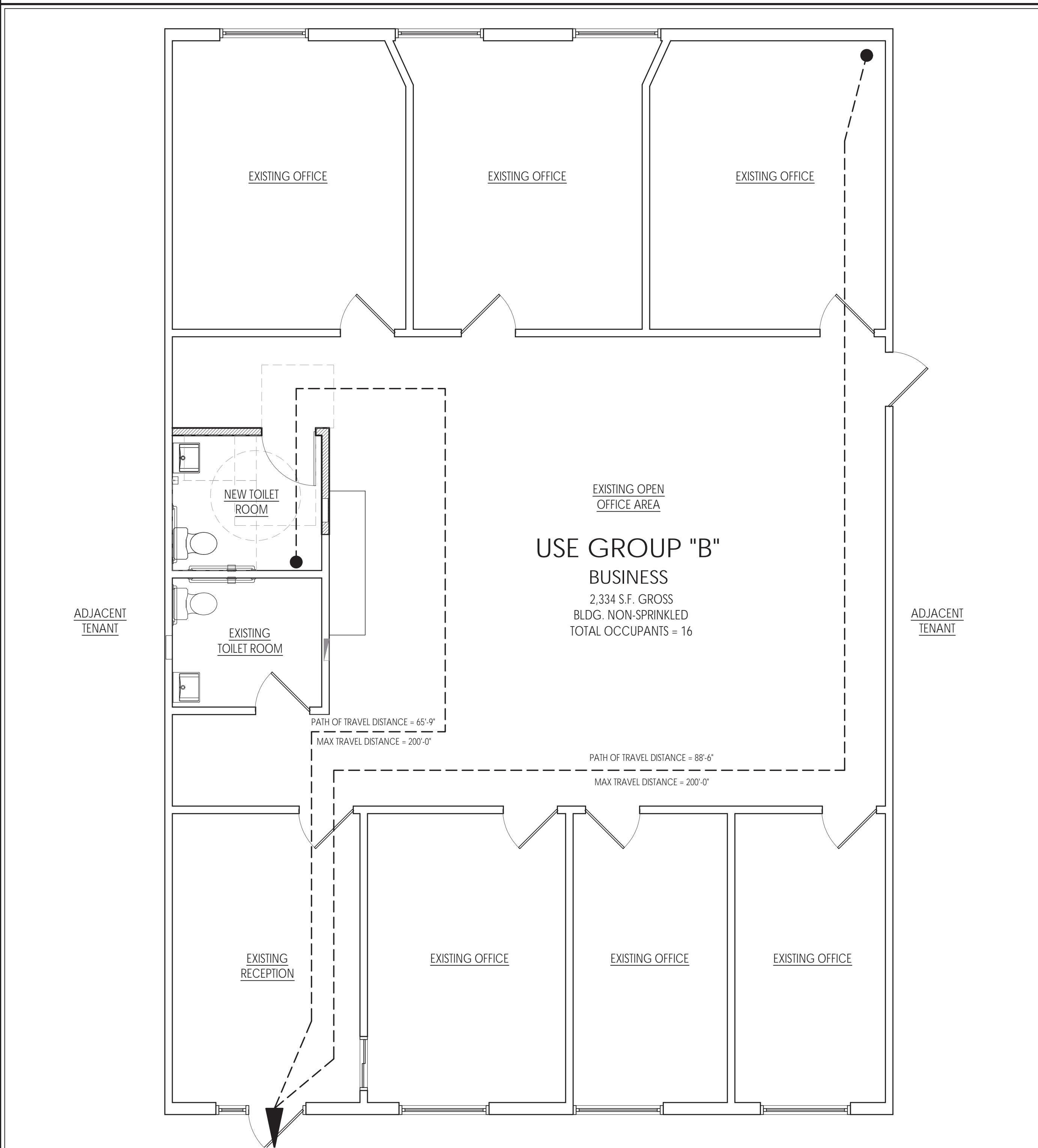

1
1/4" = 1'-0"

LIFE SAFETY PLAN



tk studio llc
262 Mullica Hill Road
Mullica Hill NJ 08062
856 845 0132

KIMBERLY DECHEN, RA
PA REGISTERED ARCHITECT No. RA-06246
NJ REGISTERED ARCHITECT No. 19467
DE REGISTERED ARCHITECT No. 55-007983

ALL DIMENSIONS MUST BE VERIFIED BY CONTRACTOR AND OWNER MUST BE NOTIFIED OF ANY DISCREPANCIES BEFORE PROCEEDING WITH THE WORK.

CLIENT:

EMORY HILL
10 CORPORATE CIRCLE SUITE 100
NEW CASTLE, DE 19720

THE WORK:

INTERIOR RENOVATION

545 BECKETT ROAD SUITE 204
SWEDESBORO, NJ 08085

ALL DOCUMENTS PREPARED BY tk studio, llc ARE INSTRUMENTS OF SERVICE IN RESPECT TO THE PROJECT. THEY ARE NOT INTENDED OR REPRESENTED TO BE SUBJECT MATTER FOR REUSE BY OWNER OR OTHERS OR EXTENSIONS OF THE PROJECT OR ANY OTHER PROJECT. ANY REUSE WITHOUT WRITTEN PERMISSION BY tk studio, llc FOR THE SPECIFIC PURPOSE INTENDED WILL BE AT THE OWNERS SOLE RISK AND WITHOUT LIABILITY OR LEGAL EXPOSURE TO tk studio, llc AND OWNER SHALL INDEMNIFY AND HOLD HARMLESS tk studio, llc FROM CLAIMS, DAMAGES, LOSSES AND EXPENSES ARISING OUT OF OR RESULTING THEREFROM.

REVISIONS		
NO.	DESCRIPTION	DATE

SHEET TITLE:

LIFE SAFETY PLAN

JOB NO:	DESIGNED BY:
1975-01	TCP
DATE:	DRAWN BY:
11.30.23	MG
SCALE:	CHECKED BY:
AS SHOWN	TCP

DRAWING NUMBER:

A002