



AVAILABLE

**FOR LEASE**  
±8,815 SF WAREHOUSE

**453 54<sup>TH</sup> STREET**  
SAN DIEGO, CA 92114

**REX A. HUFFMAN**  
Senior Vice President/Partner | 619.840.2943  
rhuffman@voitco.com | Lic. #00658675

**MICHAEL MOSSMER**  
Senior Vice President/Partner | 858.405.4284  
mmossmer@voitco.com | Lic #00998326

**Voit**  
REAL ESTATE SERVICES



<b>TOTAL BUILDING SIZE</b>	±17,629 SF
<b>AVAILABLE SIZE/SUITE</b>	±8,815 SF / Suite 101
<b>LOT SIZE</b>	±1.00 Acres
<b>CLEAR HEIGHT</b>	22' - 24'
<b>POWER</b>	400 amps; 3 phase (Tenant to verify)
<b>PARKING RATIO</b>	2.5/1,000 SF
<b>GRADE LEVEL DOOR</b>	One (12' x 14')
<b>ZONING</b>	IL-3-1 ( <a href="#">View Zoning</a> )
<b>SECURED PARKING</b>	Fenced Yard
<b>FREEWAY ACCESS</b>	Hwy 94 & I-5 & I-805
<b>ENTERPRISE ZONE</b>	Yes
<b>AVAILABLE</b>	July 2026
<b>LEASE RATE</b>	\$1.30 + (+/- \$0.18 CAM)

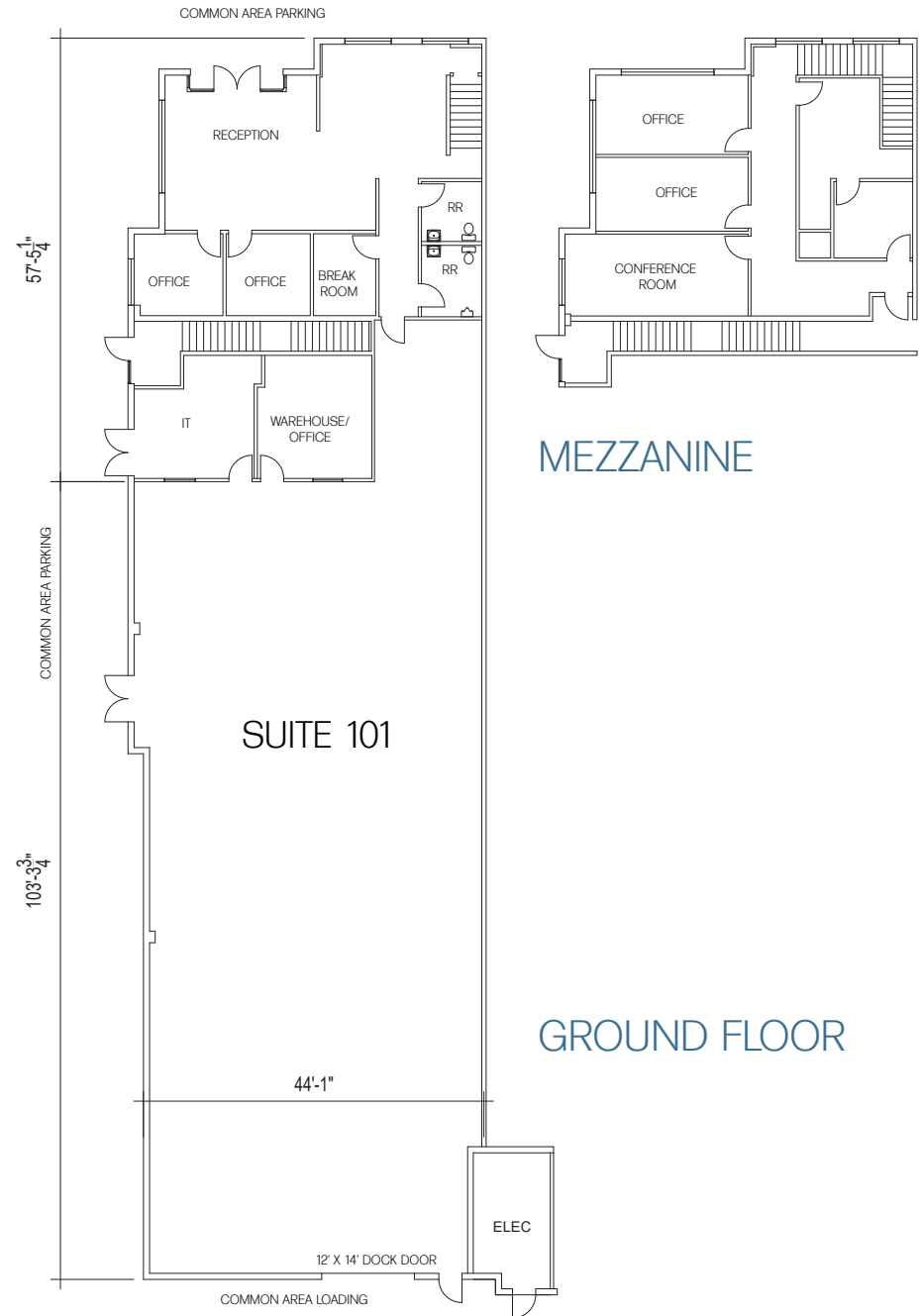

Not To Scale

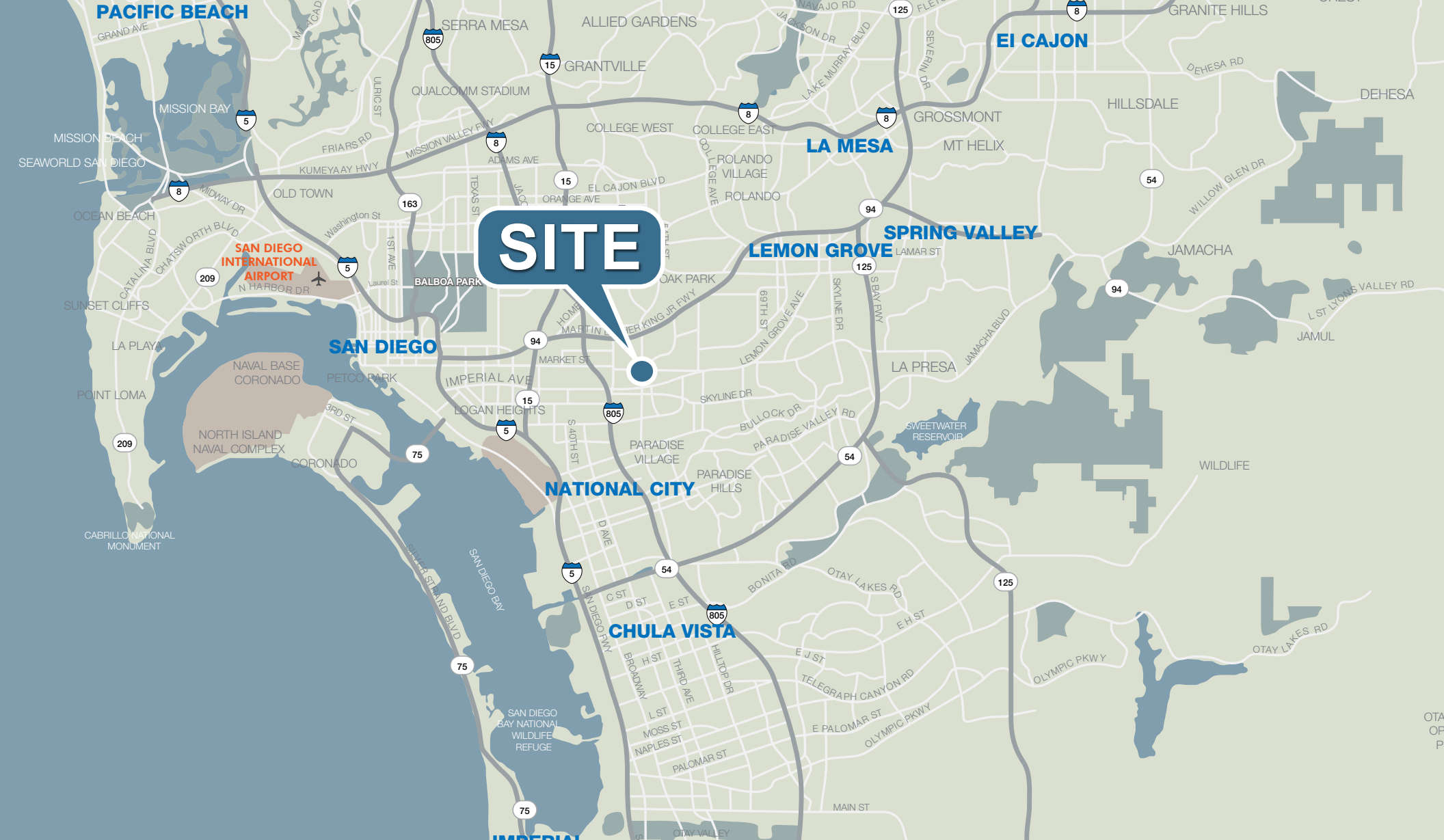

**REX A. HUFFMAN**

Senior Vice President/Partner

619.840.2943 | rhuffman@voitco.com | Lic. #00658675

**MICHAEL MOSSMER**

Senior Vice President/Partner

858.458.3347 | mmossmer@voitco.com | Lic #00998326

9530 Towne Centre Drive, Suite 100, San Diego, CA 92121 • 858.453.0505 • 858.408.3976 Fax • Lic #01991785 • [www.VoitCo.com](http://www.VoitCo.com)

Licensed as Real Estate Salespersons by the DRE. The information contained herein has been obtained from sources we deem reliable. While we have no reason to doubt its accuracy, we do not guarantee it. ©2026 Voit Real Estate Services, Inc. All Rights Reserved.

