

POMONA RD

PR

±7,076 SF
Available for Sale

 CORONA HARDWOOD
FLOORING

2451

NEWMARK

2451 Pomona Road | Corona, CA 92878

Property Overview



±7,076 SF
**FREESTANDING
INDUSTRIAL BUILDING**



±1,280 SF
OFFICE SPACE

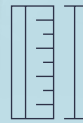

16'
CLEAR HEIGHT



400 Amp,
120/208 Volt
POWER SERVICE

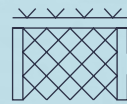

Fenced
Area
YARD



Prime West
Corona
LOCATION



Two Ground-
Level Loading
DOORS

POMONA RD

PRR

Floor Plan



POMONA RD

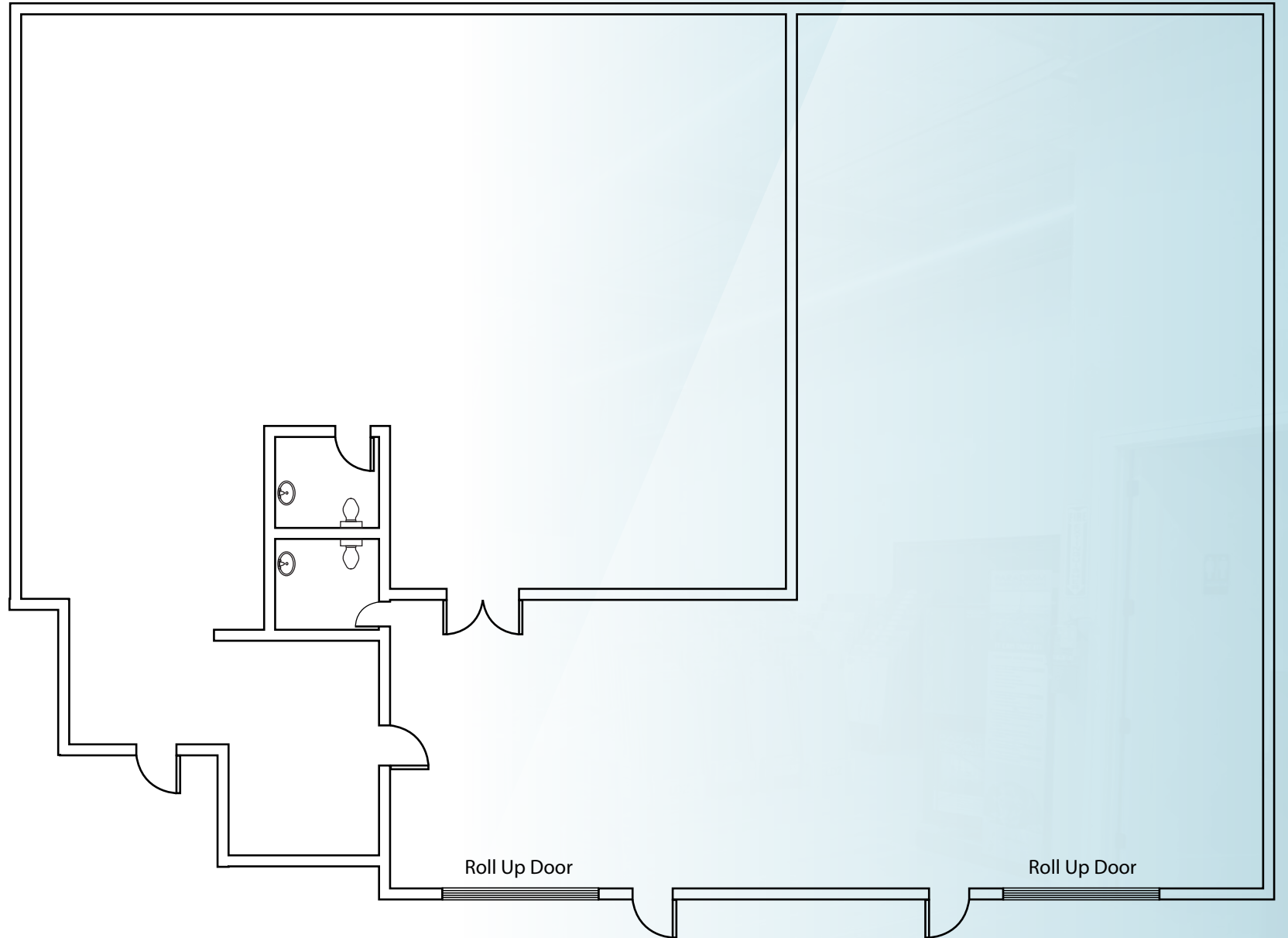

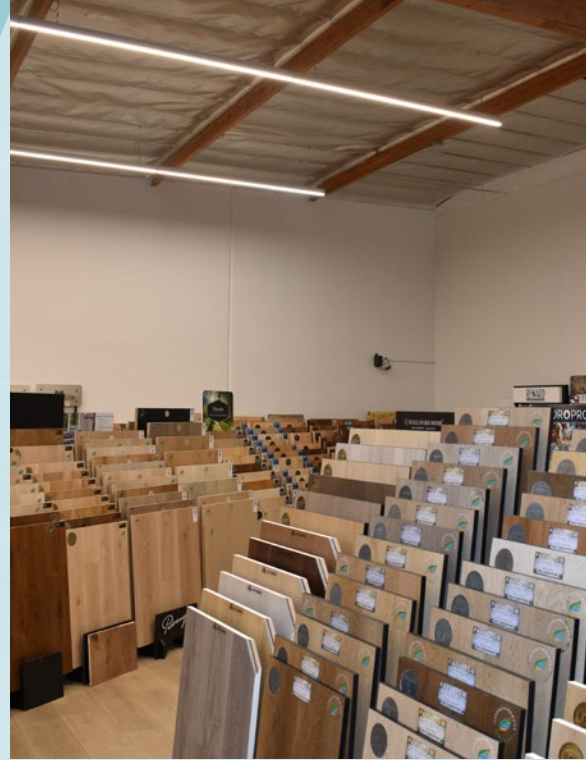



91

2451 POMONA ROAD



POMONA RD



NEWMARK

DAVID NOBLITT
Senior Managing Director
t 909-974-4023
m 310-259-8654
david.noblitt@nmrk.com
CA RE Lic. #01961575

JOSH HAYES
Senior Managing Director
t 909-974-4043
m 949-378-5766
josh.hayes@nmrk.com
CA RE Lic. #01300731

JACK CHAMBERS
Associate
t 909-974-4031
m 817-933-6242
jack.chambers@nmrk.com
CA RE Lic. #02328974

HILDA MUÑOZ
Brokerage Services
Specialist
t 909-974-4049
hilda.munoz@nmrk.com
CA RE Lic. #01388515

Corporate License #01355491

The information contained herein has been obtained from sources deemed reliable but has not been verified and no guarantee, warranty or representation, either express or implied, is made with respect to such information. Terms of sale or lease and availability are subject to change or withdrawal without notice.