



CARY FOUNDED

167 E. Chatham Street
Cary, NC 27511



CARY FOUNDED

Located in the heart of historic downtown Cary, the Rogers building sits within walking distance of numerous amenities such as local restaurants La Farm Bakery, Bond Brothers Beer Company, Brew Coffee, Sidebar, art venues, The Town of Cary's approved 7-acre park, and the new Cary Regional Library. Just minutes from Raleigh, Durham, Research Triangle Park, and Raleigh-Durham International Airport.

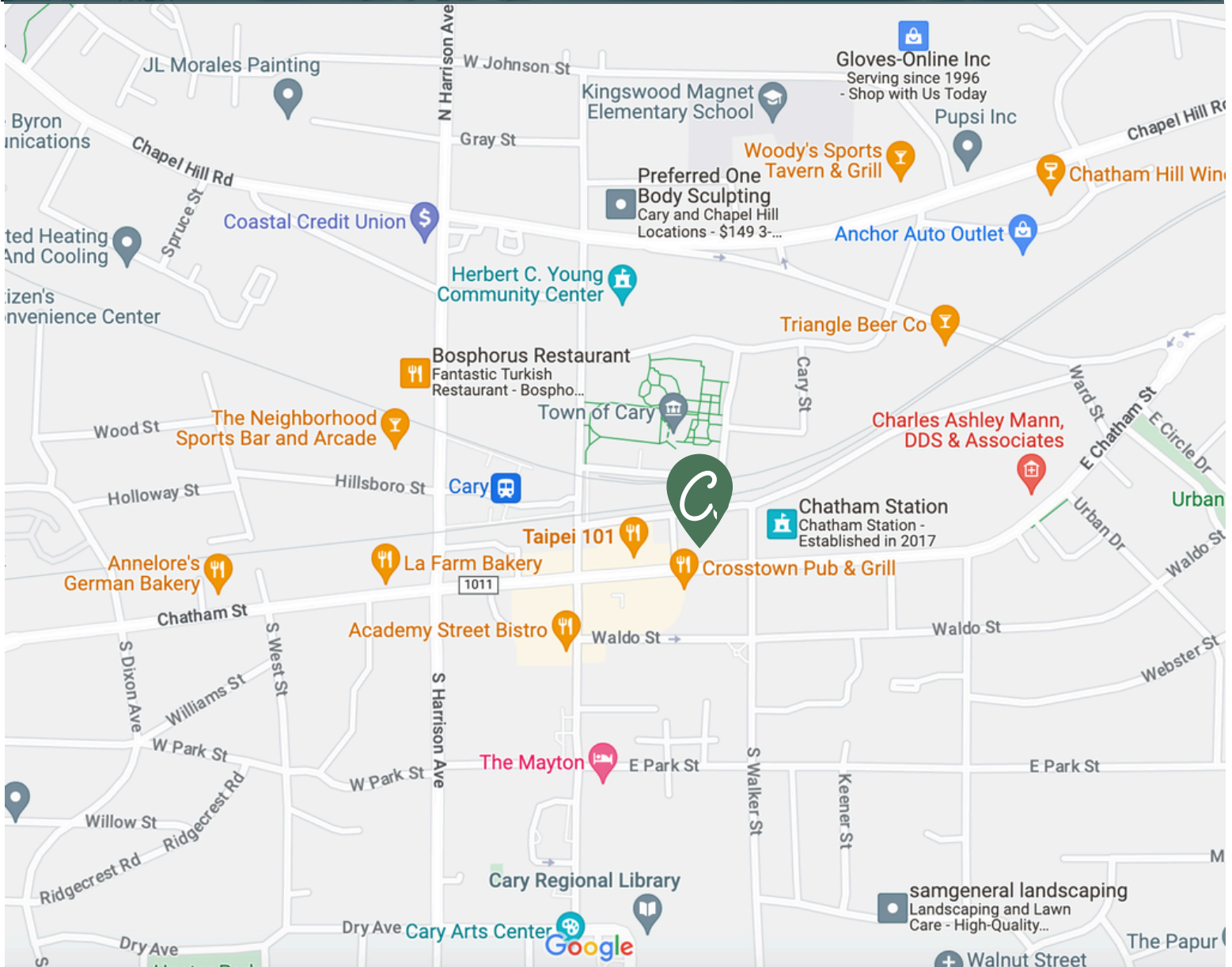

CARY FOUNDED FEATURES

- 21,000 SQFT BUILDING
- 1-25 PERSON FURNISHED SUITES
- 6 MEETING ROOMS & MULTI-FLEX CLASSROOM
- FLEXIBLE LEASE TERMS
- CENTRALLY LOCATED IN DOWNTOWN CARY
- COMMUNAL CO-WORKING SPACE





**SUITE
2, 22, OR 23**

**SQ FOOTAGE
993 SQ. FT.**

**OCCUPANCY
10-20 Person
Suite**



SPECIFICATIONS

- A mixed-use, three-story, Class A development
- Parking includes a combination of onsite surface, off-site surface, and public street parking
- Ground Floor Retail Space
- Full-Service Lease with Flexible Terms
- Fully Furnished Office Suites
- 3% Annual Escalations
- All Raleigh Founded Membership Amenities

AMENITIES

- Highspeed WiFi
- Mailbox
- Printing Capabilities
- Local Coffee
- Local Beer
- Access to Meeting Rooms
- Business Resources
- Community Events
- Access to Experts
- Local Discounts
- Startup Jobs Board
- Raleigh Founded Resource Hub
- Online network of 1000+ members



FLOORPLANS

FLOOR 3

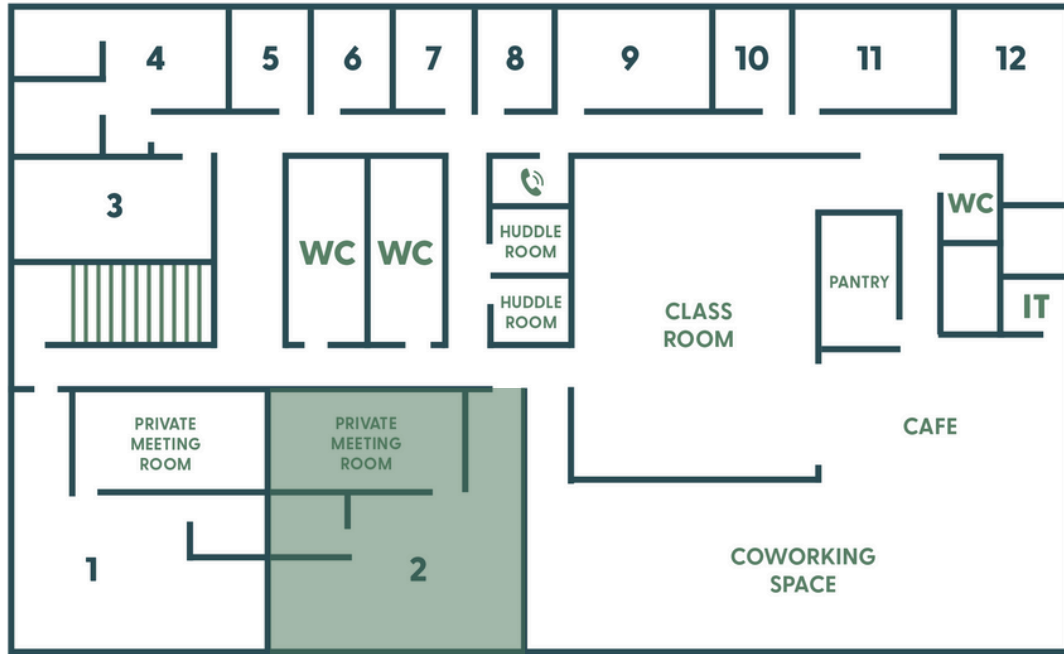

FLOOR 2

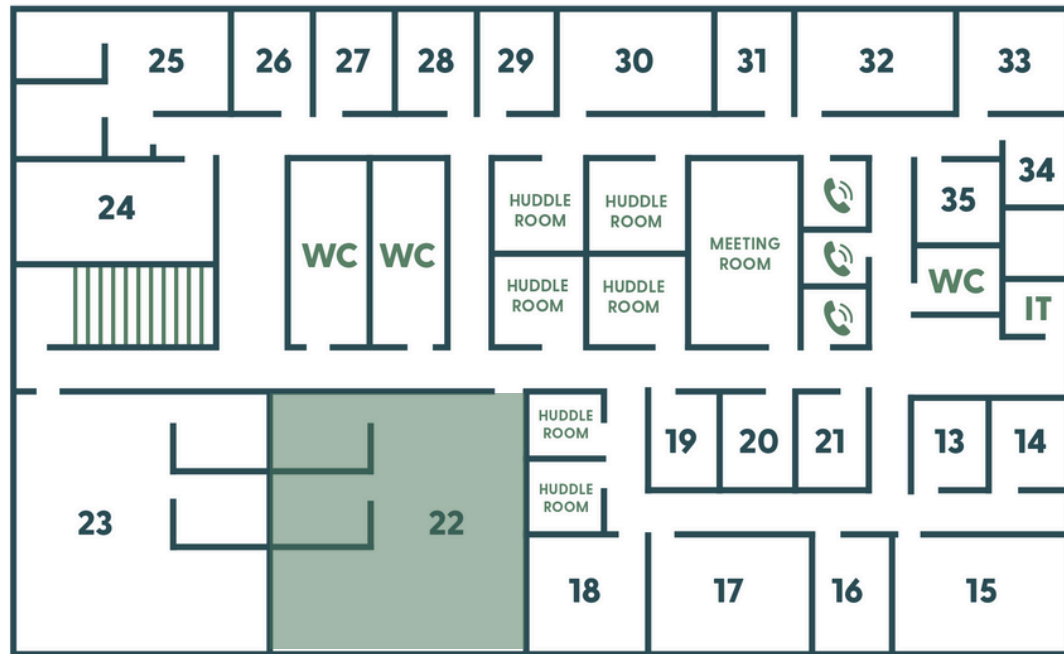

WHAT'S NEARBY?

RESTAURANTS

- Taipei
- Crosstown Pub
- Academy Street Bistro
- The Walkup
- La Farm Bakery
- Kababish Café
- The Neighborhood Sports Bar and Café

SHOPS

- Moon Shadow Medical Massage
- The Perfect Piece

ACTIVITIES

- Downtown Cary Park
- Herbert C. Young community center
- Cary Downtown Farmers Market



