



KATY BUILDING

701 COMMERCE STREET
DALLAS, TX



EXPANSIVE[®]

workspace

TEAM SUITE 400B

\$4999/MONTH

AVERAGE \$151/PERSON
ACCOMODATES HEADCOUNT OF UP TO 33

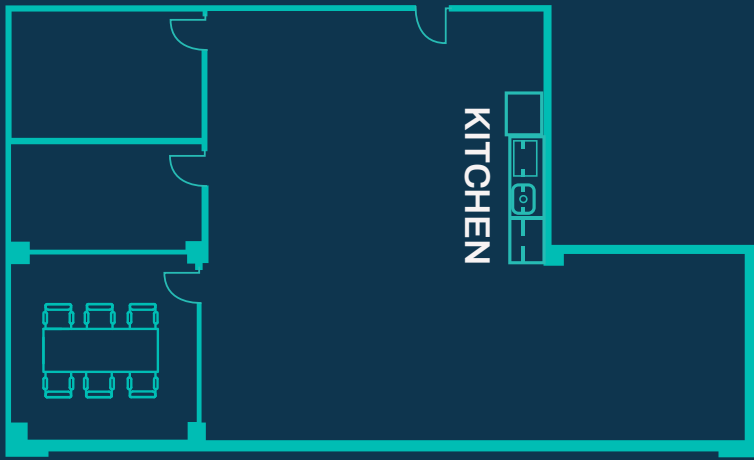

2319 SQUARE FEET OF PRIVATE SPACE PLUS 3000+SF OF SHARED WORKSPACE, COWORKING LOUNGE, KITCHEN, PHONE BOOTHS & MORE

SOLUTION INCLUDES:



FULLY FURNISHED



DIRECT FIBER INTERNET & WIFI ACCESS



EXPANSIVE LOUNGE



COFFEE & TEA



24/7 ACCESS



ON-SITE MGMT



HIGH SPEED PRINTERS



UTILITIES



MOTHERS' ROOM



COMMUNITY APP



BIKE ROOM



NETWORK ACCESS

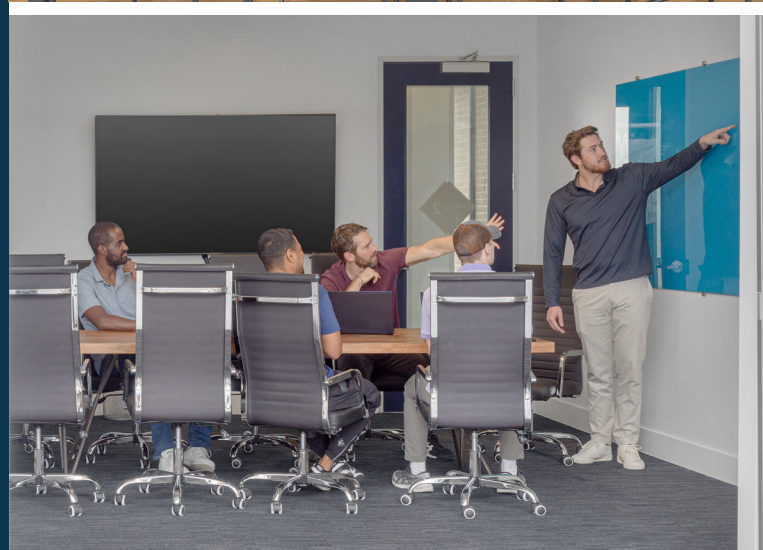

EXPLORE OUR AVAILABLE TEAM SUITE OPTIONS TODAY!

CONTACT BRENNAN WALKER

469.461.4196 | brennan.walker@expansive.com