

# FRANKLIN INDUSTRIAL PARK

2,400-4,800 SF INDUSTRIAL WAREHOUSE & OFFICE OPPORTUNITIES



# FOR LEASE

Bays 15 & 26 | 920 30 Street NE  
Calgary, AB

**CBRE**



**BAY 26**  
2,400 SF

**BAY 15**  
4,800 SF

BARLOW TRAIL NE

FRANKLIN INDUSTRIAL PARK

# THE OPPORTUNITY

Franklin Industrial Park is well suited to small to mid size bay users seeking a functional, central base with strong logistics connectivity.

Combined with practical industrial configurations and flexible bay sizes, the cluster presents a compelling opportunity for businesses looking to scale and establish themselves within one of Calgary's most accessible industrial nodes.



**AVAILABILITY**  
Bay 26 - 2,400 SF  
Bay 15 - 4,800 SF



**ZONING**  
IG – Industrial General



# 2,400 SF SHOP FOR LEASE

## BAY 26

### RENTABLE AREA

Office: 457 SF  
 Warehouse: 1,943 SF  
 Total: 2,400 SF

### POWER

200 Amp (TBV)

### AVAILABILITY

April 1, 2026

### ZONING

IG – Industrial General

### OPERATING COSTS

\$6.35 PSF (2026 estimate)

### LOADING

1x Drive-in

### LEASE RATE

Market

### CEILING HEIGHT

20' clear

### PROPERTY HIGHLIGHTS

- Make-up air included (TBV)
- Shop with built-out reception area, front desk, and two washrooms
- Central location with immediate access to Barlow Trail, Memorial Trail, Deerfoot Trail, and Trans-Canada Highway
- Easily accessible by public transportation and located 10-minutes outside of Downtown
- Direct exposure to 30 Street SE

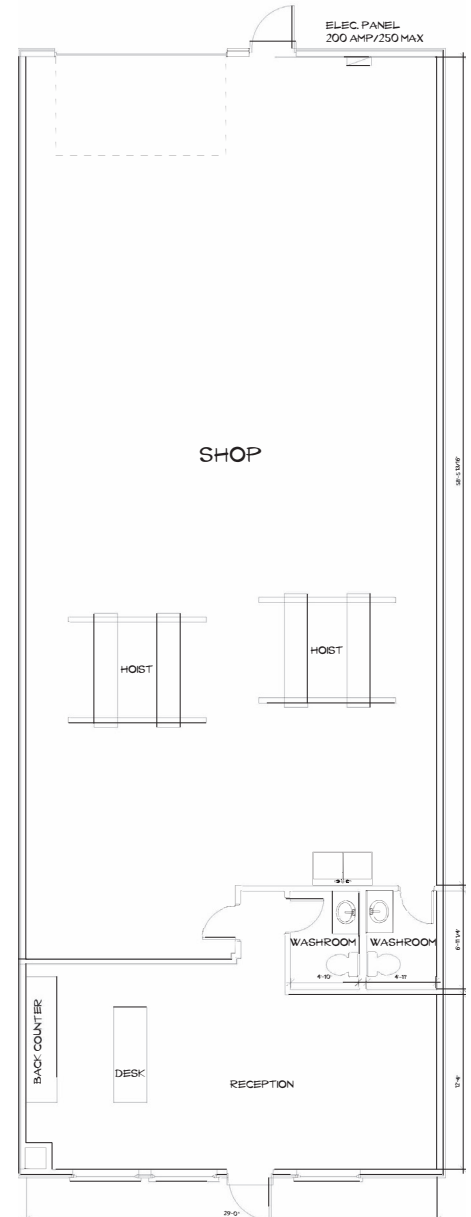

Aerial View – End-cap Unit



Rear Facing View – Loading

# 4,800 SF WAREHOUSE FOR LEASE

## BAY 15

### RENTABLE AREA

Office: 914 SF  
Warehouse: 3,886 SF  
Total: 4,800 SF

### ZONING

IG – Industrial General

### LOADING

2 x Drive-in door (12' x 14')

### CEILING HEIGHT

20' Clear

### POWER

200 Amp (TBV)

### AVAILABILITY

May 1, 2026

### OPERATING COSTS

\$6.11 PSF (2026)

### LEASE RATE

Market

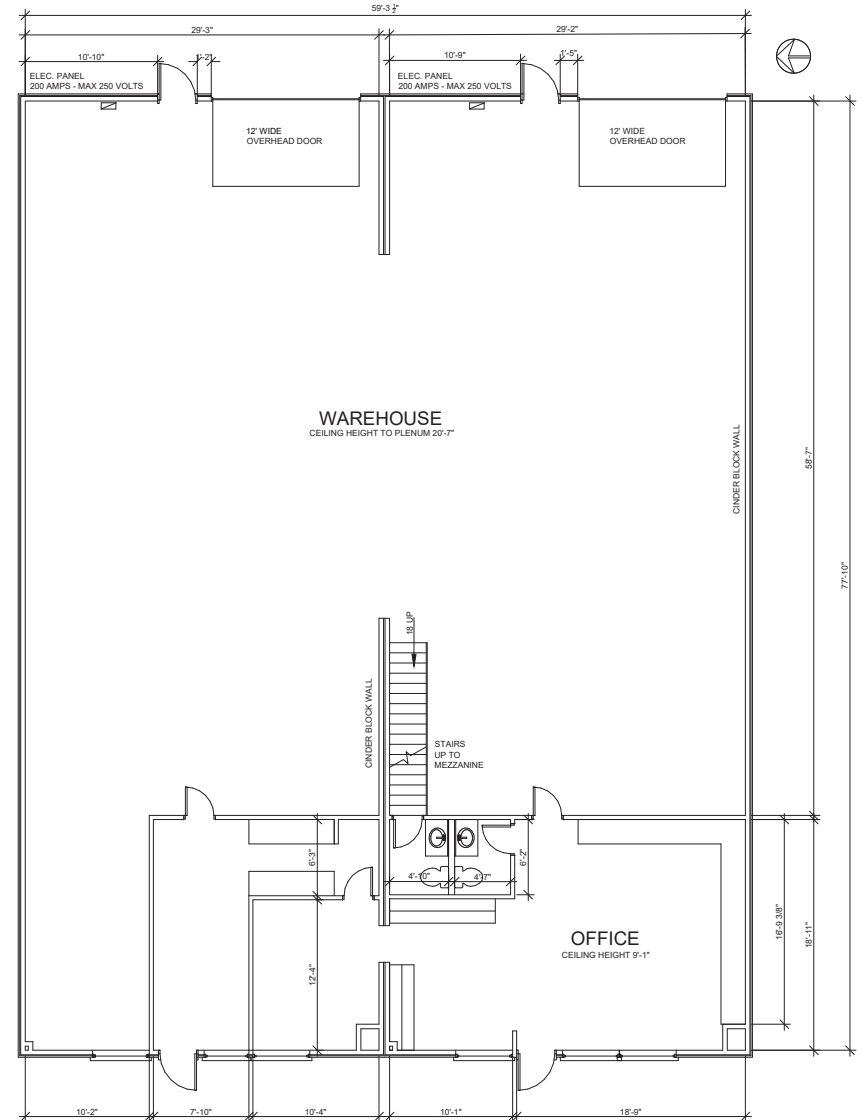

### PROPERTY HIGHLIGHTS

- Central location with immediate access to Barlow Trail, Memorial Trail, Deerfoot Trail, and Trans-Canada Highway.
- Easily accessible by public transportation and located 10-minutes outside of Downtown.
- Mix of dock and drive-in loading offering greater flexibility to tenants.
- Efficient office layout with 1 private office, open area, kitchenette, and washroom.
- Ample double row parking.

# LOCATION

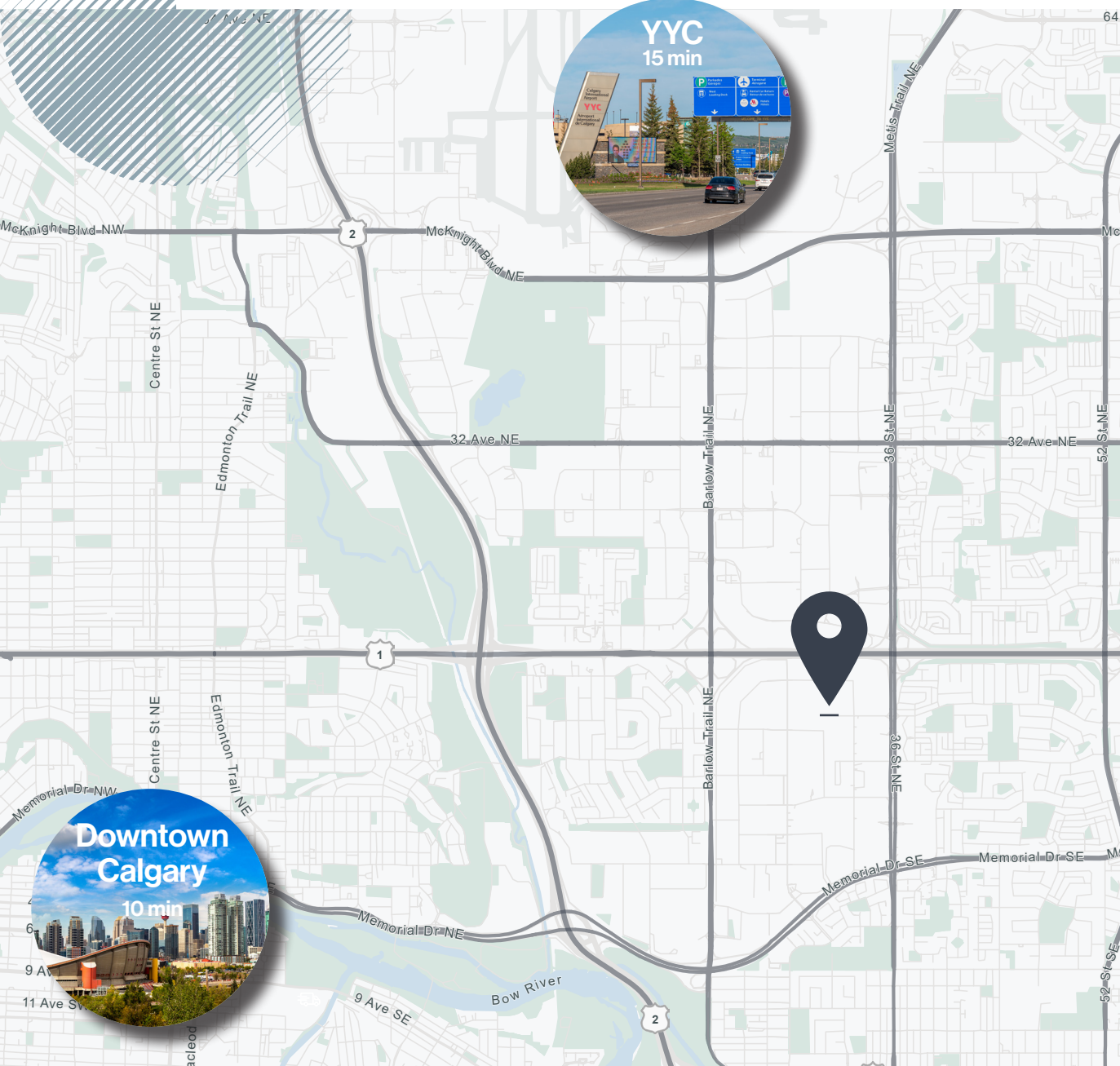

The Franklin Industrial Park in northeast Calgary offers centrally located industrial property with immediate access to major transportation corridors, including Deerfoot Trail SE, 16 Avenue NE, Stoney Trail SE, and the Trans Canada Highway. This strategic positioning provides seamless connectivity across Calgary and Western Canada, supporting efficient distribution, commuter flow, and regional connectivity for a wide range of industrial users.

Situated in the established community of Franklin and adjacent to Marlborough, the portfolio benefits from proximity to significant retail amenities such as Marlborough Mall, offering convenient access to food, services, and consistent surrounding customer traffic.

Located approximately 15 minutes from Calgary International Airport, and 10 minutes from Downtown Calgary, the portfolio is especially well suited to small to mid size bay users seeking a functional, central base with strong logistics connectivity.



**193,491**  
Population within 5 KM  
(2025 Est.)



**159,561**  
Labour Force within 5 KM  
(2025 Est.)

# FRANKLIN INDUSTRIAL PARK

2,400-4,800 SF INDUSTRIAL WAREHOUSE & OFFICE OPPORTUNITIES



[www.cbre.ca/calgary](http://www.cbre.ca/calgary)

CBRE Limited | 3200, 525 8 Avenue SW Calgary, AB T2P 1G1

## CONTACT

**Evan Renwick**

Vice President  
+1 403 750 0807  
evan.renwick@cbre.com

\*Lead Broker

**Kai Ravensbergen**

Associate  
+1 403 750 0525  
kai.ravensbergen@cbre.com

\*Lead Broker

**Iain Ferguson**

Vice Chairman  
+1 403 750 0803  
iain.ferguson@cbre.com

**Luke Hamill**

Executive Vice President  
+1 403 294 5707  
luke.hamill@cbre.com

**Cameron Woods**

Vice President  
+1 403 303 4562  
cameron.woods@cbre.com

**Blake Ellis**

Vice President  
+1 403 750 0519  
blake.ellis@cbre.com

This disclaimer shall apply to CBRE Limited, and to all divisions of the Corporation ("CBRE"). The information set out herein (the "Information") has not been verified by CBRE, and CBRE does not represent, warrant or guarantee the accuracy, correctness and completeness of the Information. CBRE does not accept or assume any responsibility or liability, direct or consequential, for the Information or the recipient's reliance upon the Information. The recipient of the Information should take such steps as the recipient may deem necessary to verify the Information prior to placing any reliance upon the Information. The Information may change and any property described in the Information may be withdrawn from the market at any time without notice or obligation to the recipient from CBRE.

Mapping Sources: Canadian Mapping Services [canadamapping@cbre.com](mailto:canadamapping@cbre.com); DMTI Spatial, Environics Analytics, Microsoft Bing, Google Earth.

**CBRE**