



Owner / User Industrial Condo For Sale

1717 SOLANO WAY, SUITE 38, CONCORD CA

SIZE

±2,000 SF

SALE PRICE

\$725,000.00

HOA DUES

±\$3,500 per year / \$291.00 per month

PROPERTY HIGHLIGHTS

- One (1) Grade Level Door (12' x 14')
- ±14' Minimum Ceiling Clearance
- Three (3) Designated Parking Stalls in front
- Close Proximity to Hwy 4 & I-680
- Reception Area, Private Office and Restroom
- 225 Amps, 120/208v, 3 Phase Electrical Service

COMMENTS

One of North Concord's few industrial condos for sale. It is ideal for sales service, assembly, warehousing & light industrial type uses. Available now

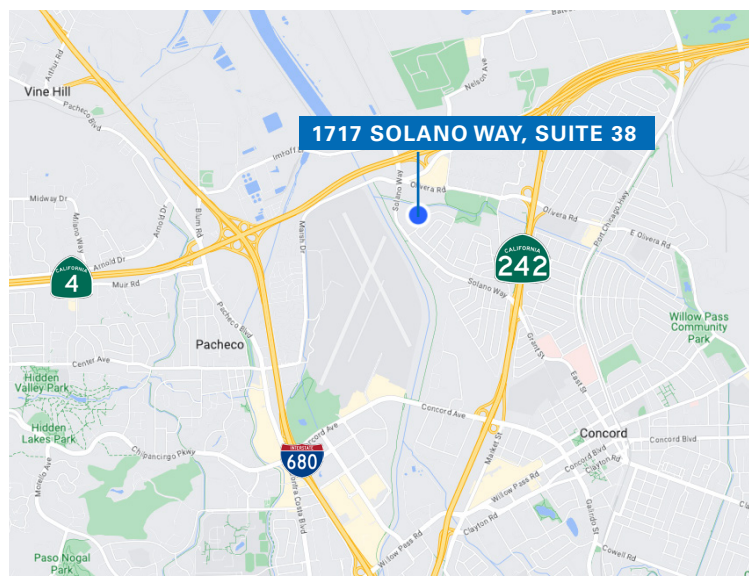

For information, please contact:

Graden Travis

Senior Managing Director

t 925-787-3530

Graden.Travis@nmrk.com

CA RE #0871716

Nelson Roberts

Associate

t 925-210-8741

Nelson.Roberts@nmrk.com

CA RE# 02109703

nmrk.com

NEWMARK

FLOOR PLAN - SUITE 38

±2,000 SF

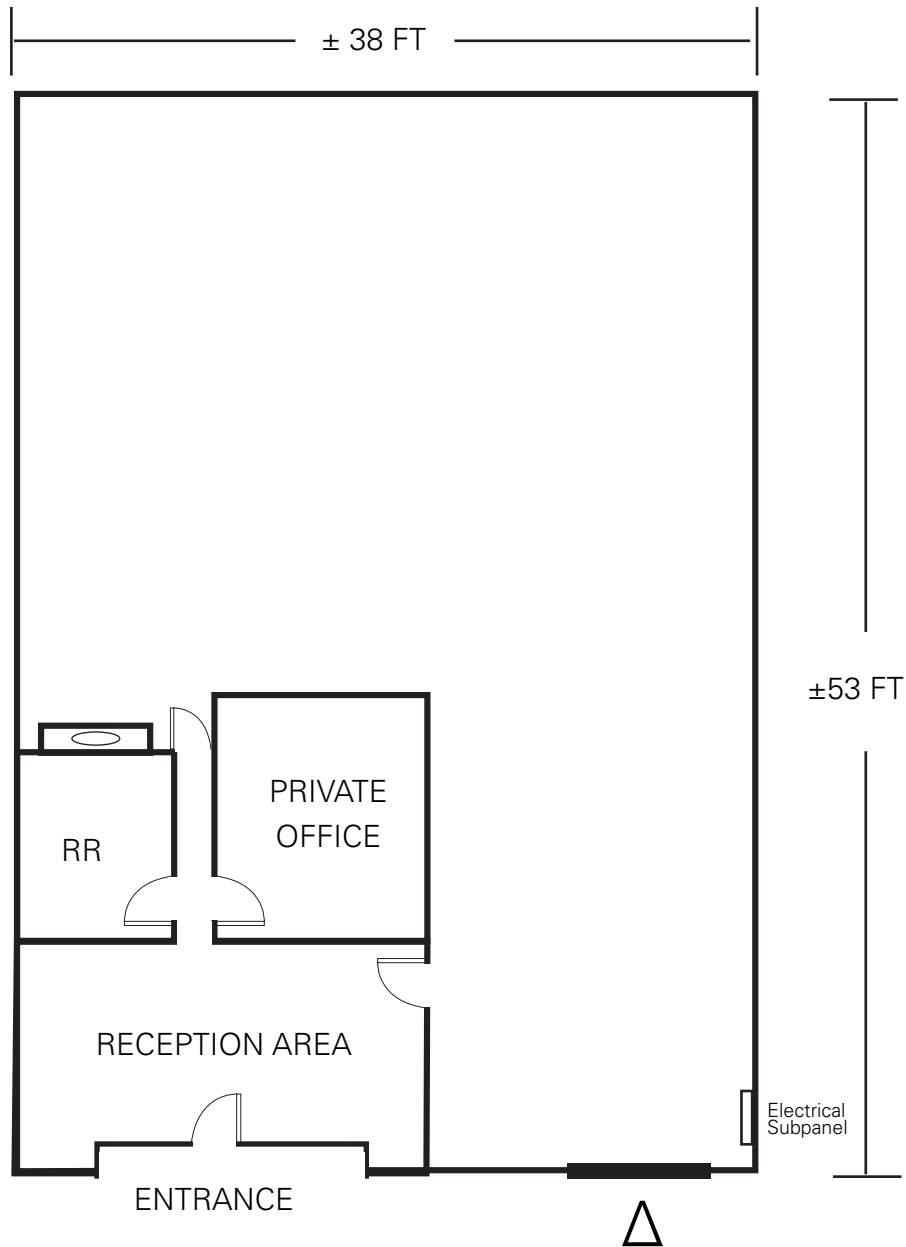

Δ = 12'x14' GRADE LEVEL DOOR

For information, please contact:

Graden Travis

Senior Managing Director

t 925-787-3530

Graden.Travis@nrmk.com

CA RE #0871716

Nelson Roberts

Associate

t 925-210-8741

Nelson.Roberts@nrmk.com

CA RE# 02109703

nrmk.com

NEWMARK

AERIAL



For information, please contact:

Graden Travis

Senior Managing Director

t 925-787-3530

Graden.Travis@nmrk.com

CA RE #0871716

Nelson Roberts

Associate

t 925-210-8741

Nelson.Roberts@nmrk.com

CA RE# 02109703

nmrk.com

NEWMARK