



TEMPLE

CONSTRUCTION | DEVELOPMENT | BROKERAGE

U Ave & 250th St. Dallas County, IA

- Land (ac):
37.0
- Sales Price:
\$1,406,000(\$38,000/acre)
- Parcel ID:
1209100001
- Zoning:
Ag - Agriculture
- Located On Pavement
- School District:
Dallas Center Grimes
- Location:
SE Corner Of The
Intersection Of
U Ave & 250th St

Dillon Temple

(515) 669-1238

dillon@templeres.com

Colton Pfeifer

(515) 518-0493

colton@templeres.com



info@templeres.com | 1015 NW 10th St., Waukee, IA 50263 | www.templeres.com

The information contained herein, we believe, has been obtained from reasonably reliable sources, and we have no reason to doubt the accuracy of such information; however, no warranty or guarantee either expressed or implied, is made with respect to the accuracy thereof. All such information submitted is subject to error, omissions, or changes in conditions, prior to sale, lease, or withdrawal without notice. All information contained herein should be verified to the satisfaction of the persons relying thereon. Angle, LLC D/B/A Angle Realty is licensed to sell real estate in the State of Iowa.

Licensed to sell real estate in the State of Iowa

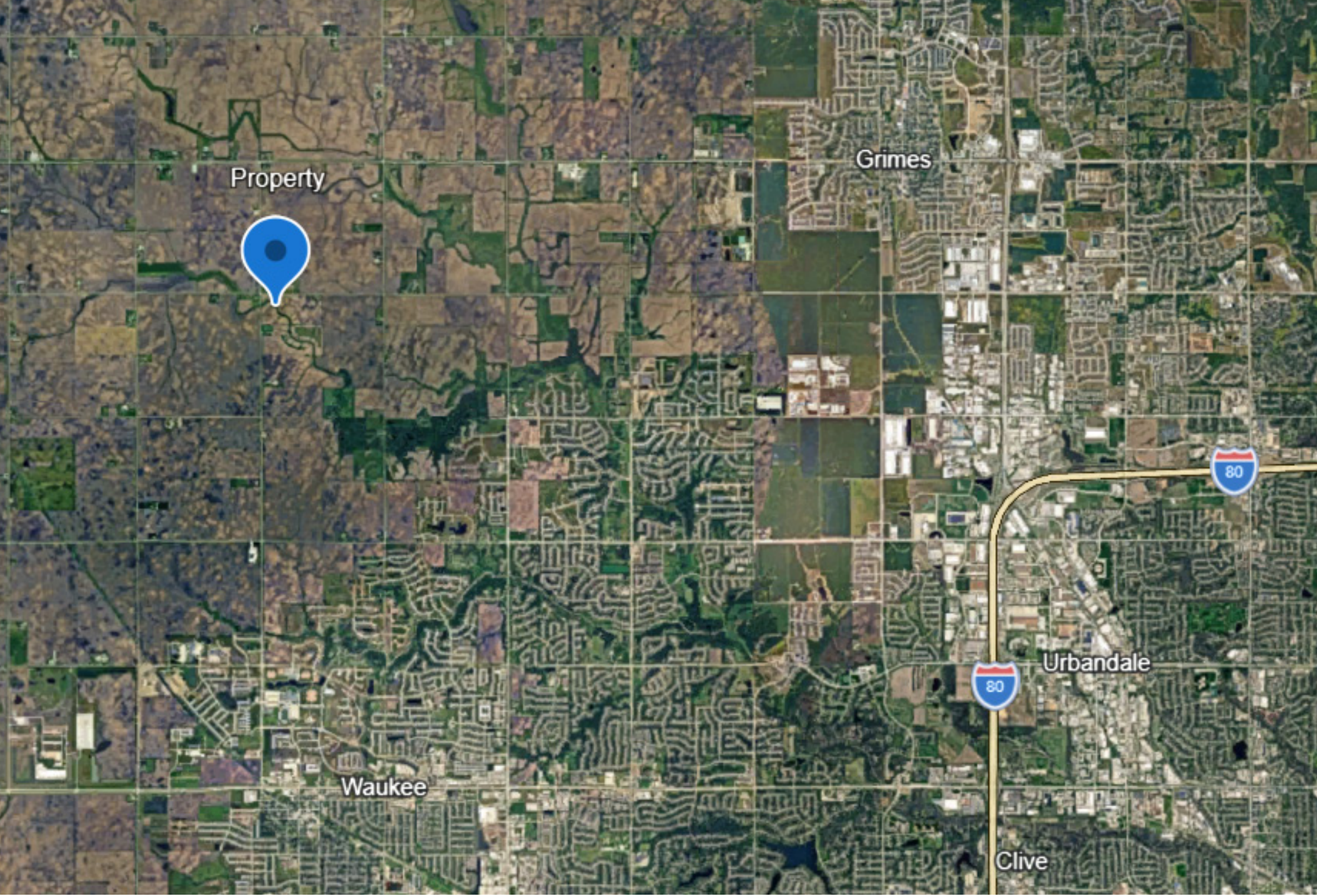

LOCATION



TEMPLE
CONSTRUCTION | DEVELOPMENT | BROKERAGE