

# ATTENTION BUSINESS OWNERS AND INVESTORS 2 COMMERCIAL BUILDINGS ON 1.13 AC

PEMBROKE MA 02359

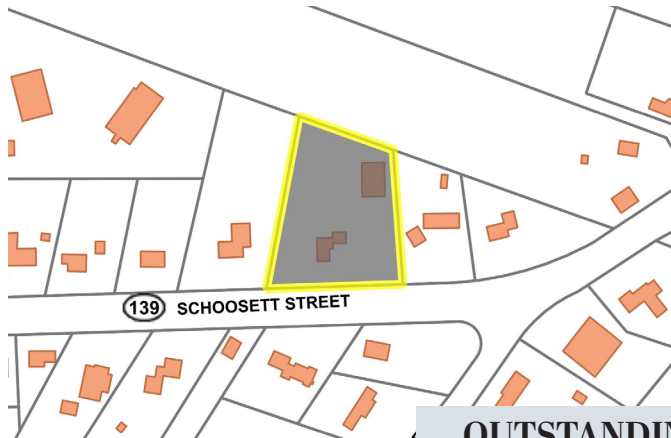

## OUTSTANDING LOCATION

### OVERVIEW:

Address: 218 Schoolett St. Pembroke MA 02359  
Lot Size: 1.13 AC  
Zoned: Business District B  
And Any Use allowed in Residential District A

- Excellent Visibility
- Frontage ~ 244 feet on Rte 139
- High Traffic Count
- Town Water & Private Septic

### LOCATION:

- Minutes to Rte 3 and 53
- Neighbors include Hanover Crossing Shopping Mall, Trader Joes, Macy's, McGee Toyota, Standard Sportsplex
- Easy Highway Access
- 28 Miles South of Boston
- One Hour to Providence RI
- 30 Miles to Boston International Logan Airport
- Conveniently Situated South of Boston with easy access to the Cape, Western MA and Rhode Island

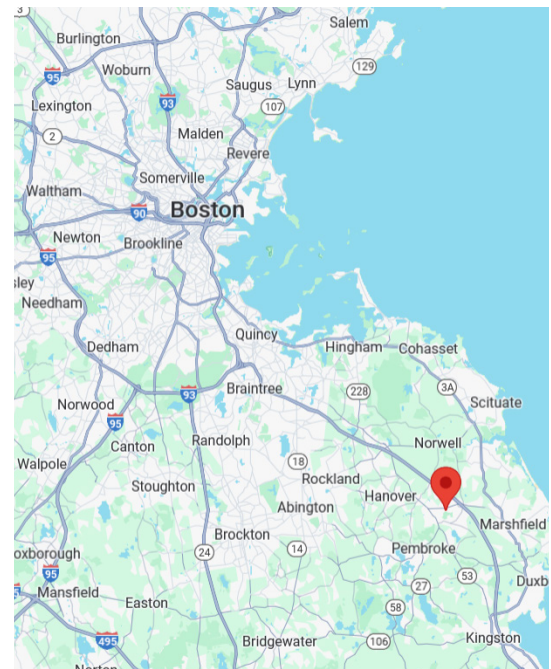

### OPPORTUNITY:

- Ideal for Retailers, Business Owners Seeking Visibility and High Traffic Count, Contractors, Builders, Professional and Business Offices, Insurance and Financial Institutions, Showrooms, Retail Stores, Light Industrial Users, Personal Services, Educational, Church or Civic Use, etc.



JACOB REALTY  
279 NEWBURY STREET  
BOSTON, MA 02116

FOR PRICING AND DETAILS CALL  
LINDA HOULLAHAN  
LHOULLAHAN@JACOBREALTY.COM  
617-852-7052