

# 564 W. JACKSON

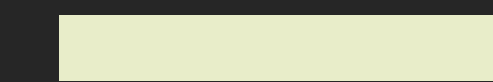

**Prime Retail  
Space in the  
Heart of the  
West Loop**



**CBRE** + BiancoProperties  
Strategic investors for over fifty years

# 564 W. JACKSON

- 6,039 SF of divisible Retail Space in the heart of Chicago's vibrant West Loop
- 140 feet of prime frontage along bustling Jackson Boulevard
- 14-foot ceiling heights offering spacious and flexible buildout options
- 14,300+ vehicles per day (VPD) on Jackson Blvd for maximum visibility
- Positioned at the base of a luxury condo building with 241 residential units—built-in customer base
- Directly across from iconic Lou Mitchell's Diner, a Chicago institution
- Just steps from Chicago's newly re-developed Union Station, a major transit hub



# Location



# The Plan

S - JEFFERSON ST. - 6,400 VPD

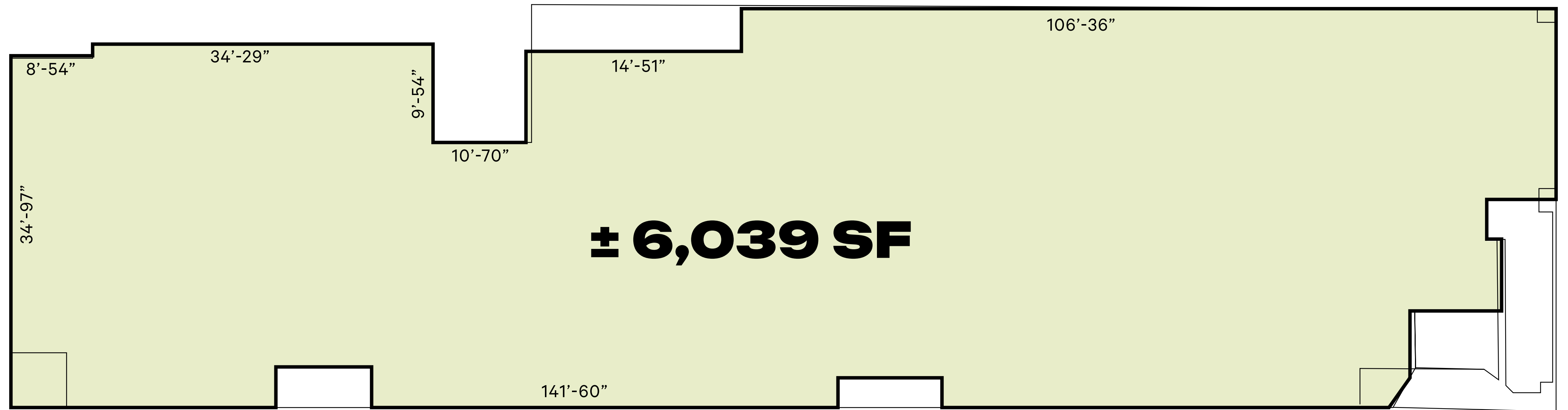

W. JACKSON BOULEVARD - 14,300 VPD

Located at the base of a luxury condominium with 241 residential units, this highly visible retail opportunity offers up to 6,039 SF of divisible space in one of Chicago's most dynamic neighborhoods. Positioned in the vibrant West Loop, the space benefits from strong foot traffic, affluent residents, and proximity to top dining, shopping, and cultural destinations.

# 564 W. JACKSON



**Prime Retail Space in the  
Heart of the West Loop**

**Cliffton Vann**

**+1 312 233 8683**

**CLIFFTON.VANN@CBRE.COM**

**Danny Jacobson**

**+1 312 935 1901**

**DANNY.JACOBSON@CBRE.COM**

**CBRE** + BiancoProperties  
Strategic investors for over fifty years

© 2025 CBRE, Inc. All rights reserved. This information has been obtained from sources believed reliable, but has not been verified for accuracy or completeness. You should conduct a careful, independent investigation of the property and verify all information. Any reliance on this information is solely at your own risk. CBRE and the CBRE logo are service marks of CBRE, Inc. All other marks displayed on this document are the property of their respective owners, and the use of such logos does not imply any affiliation with or endorsement of CBRE. Photos herein are the property of their respective owners. Use of these images without the express written consent of the owner is prohibited.