

Vicinity Map
N.T.S.

January 4, 2008

Wetland survey of a 112.99 acre tract out of Division 3 of the Hall and Jones Survey of Galveston Island, Galveston County, Texas.

I hereby certify that on the above date, the herein described property, together with improvements located thereon, was surveyed on the ground and under my direction, and that this map, together with dimensions as shown hereon, accurately represents the facts as found on the ground this date.

COASTAL SURVEYING OF TEXAS

Patrick A. Jordan
Registered Professional
Land Surveyor 5525

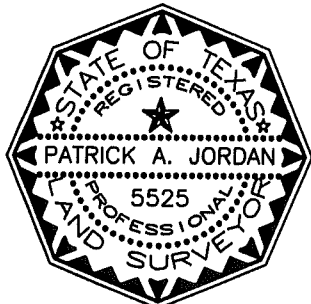

NOTES:

1. WETLAND AREA "F" HAS BEEN INCORPORATED INTO WETLAND AREA "A".
2. THE FOLLOWING AREAS HAVE BEEN ADDED AS THE RESULT OF USACOE FIELD VERIFICATION WITH DELINEATOR:
WETLAND AREA "LLL"
WETLAND AREA "MMM"
SAND FLAT AREA

AREAS	SQ. FT.	ACRE
OPEN WATER "A"	769,850.26	17.673
OPEN WATER "B"	1,737.71	0.040
SPARTINA ALT. "A"	114,099.02	2.619
SPARTINA ALT. "B"	250,326.31	5.746
WETLANDS "A"	83,090.91	1.906
WETLANDS "B"	9,229.49	0.211
WETLANDS "C"	4,478.56	0.102
WETLANDS "D"	2,186.73	0.050
WETLANDS "E"	702.84	0.016
WETLANDS "F"	SEE NOTE 1	N/A
WETLANDS "G"	22,542.76	0.517
WETLANDS "H"	1,554.70	0.035
WETLANDS "I"	2,625.08	0.060
WETLANDS "J"	986.22	0.022
WETLANDS "K"	310.93	0.007
WETLANDS "L"	440.13	0.010
WETLANDS "M"	2,765.85	0.063
WETLANDS "N"	58,946.71	1.353
WETLANDS "O"	2,015.35	0.046
WETLANDS "P"	3,117.51	0.071
WETLANDS "Q"	365.60	0.008
WETLANDS "R"	504.15	0.011
WETLANDS "S"	1,508.68	0.034
WETLANDS "T"	217.06	0.004
WETLANDS "U"	3,701.97	0.084
WETLANDS "V"	9,095.14	0.208
WETLANDS "W"	25,871.46	0.593
WETLANDS "X"	1,195.37	0.027
WETLANDS "Y"	320.25	0.007
WETLANDS "Z"	183.67	0.004
WETLANDS "AA"	357.07	0.008
WETLANDS "BB"	93.40	0.002
WETLANDS "CC"	9,285.29	0.213
WETLANDS "DD"	108,465.33	2.490
WETLANDS "EE"	2,191.99	0.050
WETLANDS "FF"	585.56	0.013
WETLANDS "GG"	505.61	0.011
WETLANDS "HH"	3,254.99	0.074
WETLANDS "II"	2,802.29	0.064
WETLANDS "JJ"	600.01	0.013
WETLANDS "KK"	605.08	0.013
WETLANDS "LL"	18,984.30	0.435
WETLANDS "MM"	3,739.82	0.085
WETLANDS "NN"	4,541.65	0.104
WETLANDS "OO"	4,057.02	0.093
WETLANDS "PP"	399.80	0.009
WETLANDS "QQ"	1,434.06	0.032
WETLANDS "RR"	1,016.18	0.023
WETLANDS "SS"	96.39	0.002
WETLANDS "TT"	2,869.53	0.065
WETLANDS "UU"	11,602.95	0.266
WETLANDS "VV"	425.67	0.009
WETLANDS "WW"	428.30	0.009
WETLANDS "XX"	30,742.33	0.705
WETLANDS "YY"	248.47	0.005
WETLANDS "ZZ"	310.84	0.007
WETLANDS "AAA"	1,124.81	0.025
WETLANDS "BBB"	115.37	0.002
WETLANDS "CCC"	12,072.76	0.277
WETLANDS "DDD"	1,078.85	0.024
WETLANDS "EEE"	475.36	0.010
WETLANDS "FFF"	14,181.65	0.325
WETLANDS "GGG"	1,531.84	0.035
WETLANDS "HHH"	1,181.15	0.027
WETLANDS "III"	591.88	0.013
WETLANDS "JJJ"	86,329.26	1.981
WETLANDS "LLL"	1,874.01	0.043
WETLANDS "MMM"	328.36	0.008

AREA SUMMARY	SQ. FT.	ACRE
UPLANDS	3,079,621.45	70.631
OPEN WATER	771,587.97	17.713
SPARTINA ALT. WETLAND	364,425.33	8.366
SAND FLATS	74,864.43	1.719
DELINEATED WETLANDS	568,486.35	13.050
TOTAL AREA OF TRACT	4,858,985.53	111.55

This property does lie within the 100 Year Flood Plain as established by the Federal Emergency Management Agency.

COASTAL SURVEYING OF TEXAS, INC.
8017 HARBORSIDE DRIVE PH (409) 740-1517
GALVESTON, TX. 77554 FAX (409) 740-0377
surveygalveston.com

This property is subject to Zoning Ordinances by the City of Galveston and to any restrictions of record.

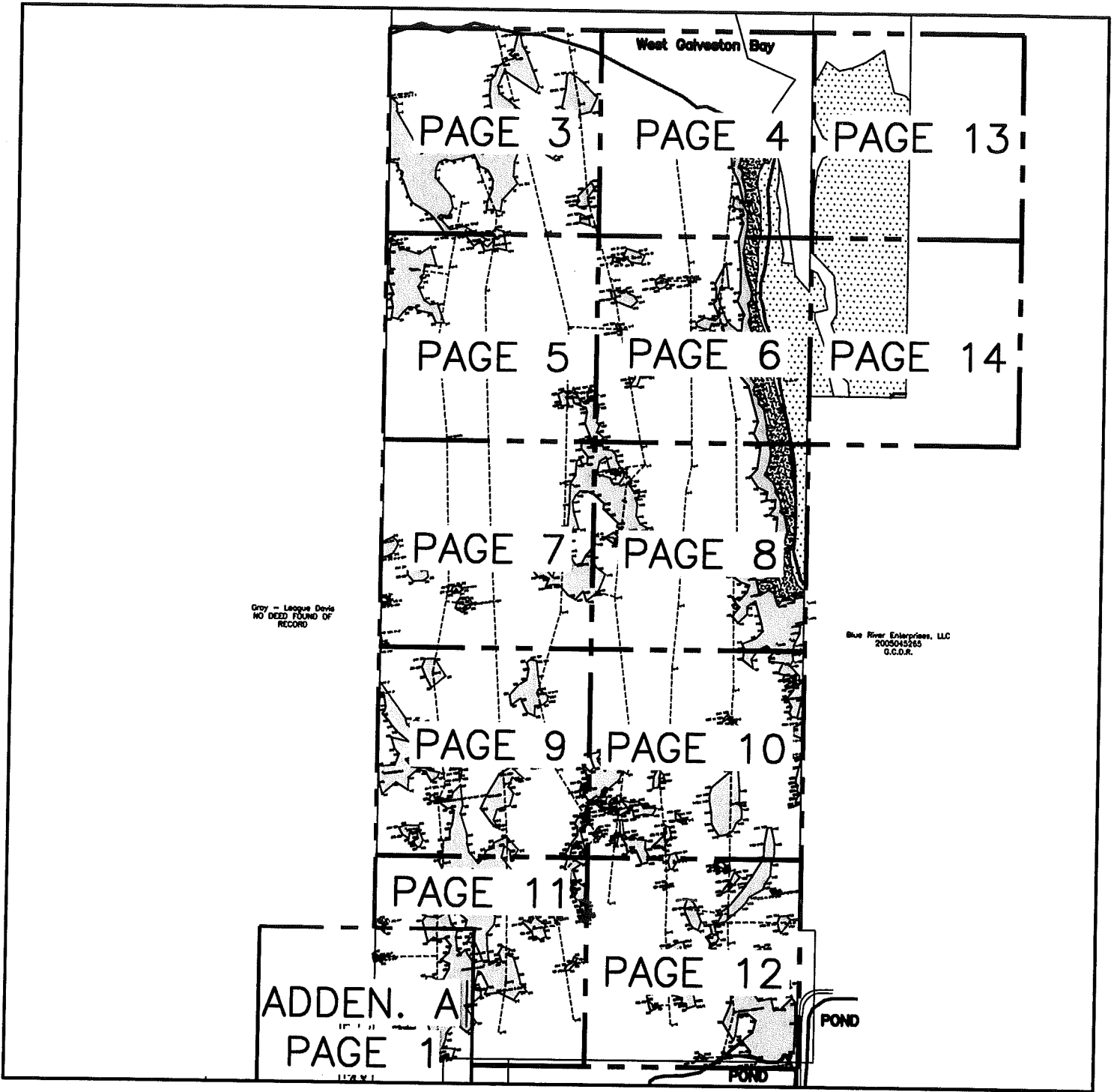

OVERALL VIEW

OVERALL VIEW

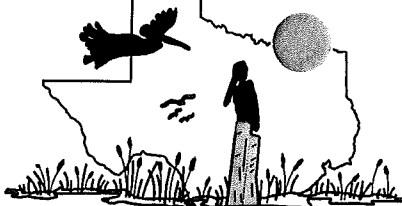

COASTAL SURVEYING OF TEXAS, INC.
 8017 HARBORSIDE DRIVE PH (409) 740-1517
 GALVESTON, TX. 77554 FAX (409) 740-0377
surveygalveston.com

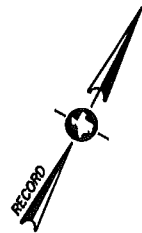

NTS

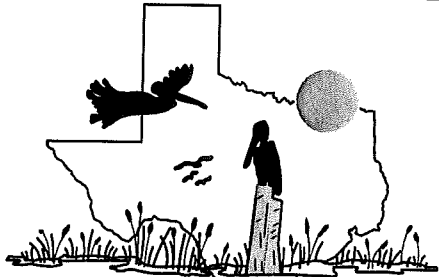
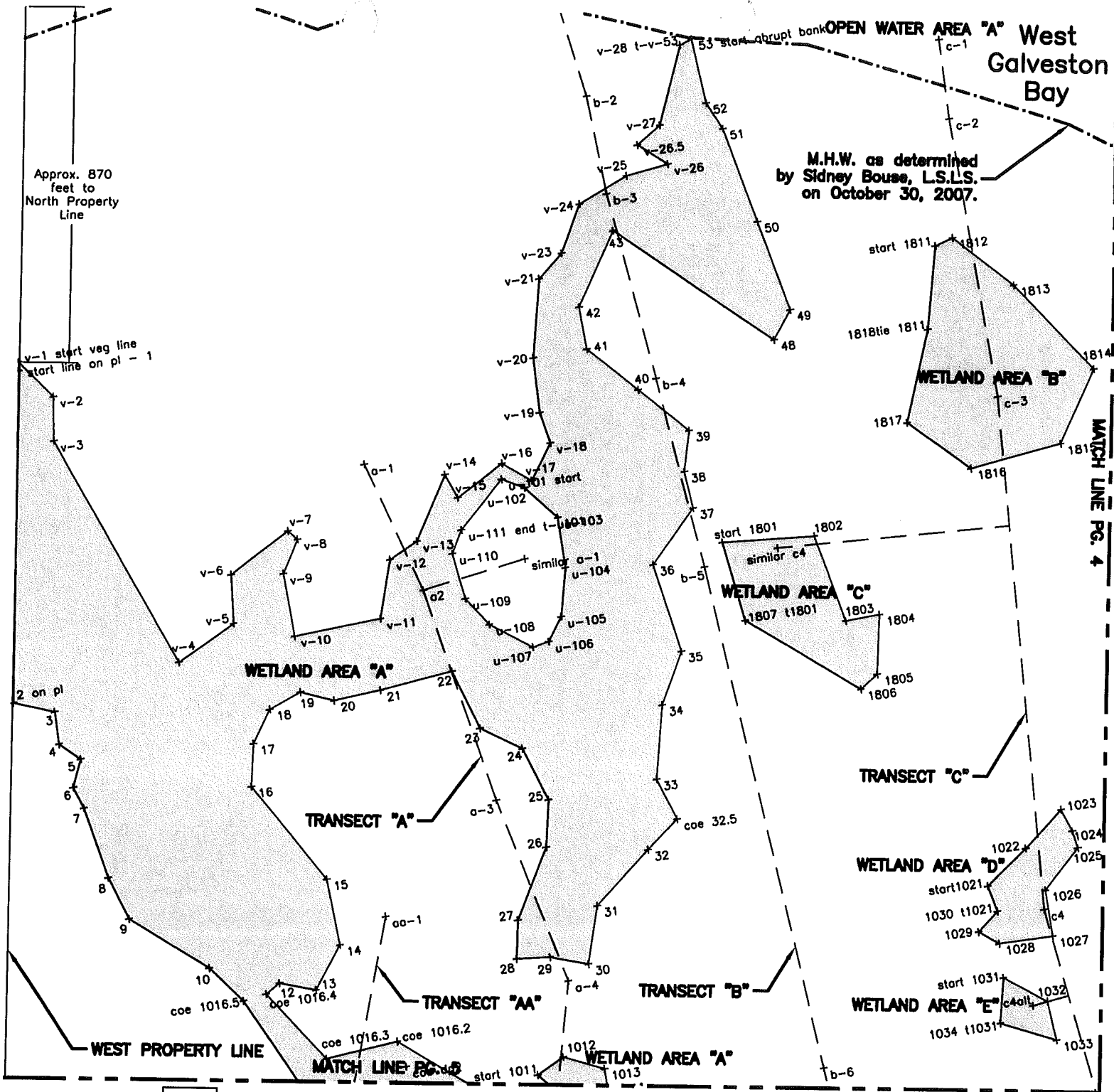

COASTAL SURVEYING OF TEXAS, INC.





8017 HARBORSIDE DRIVE
GALVESTON, TX. 77554

PH (409) 740-1517
FAX (409) 740-0377

surveygalveston.com

"SERVING GALVESTON COUNTY OVER 55 YEARS"

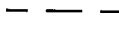
PG. 3 07-0218_WETLAND_REV

-  DELINEATED WETLANDS
-  MEAN HIGH WATER LINE
-  TRANSECT LINE
-  PROPERTY LINE

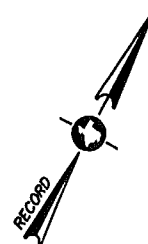

SCALE: 1" = 80'

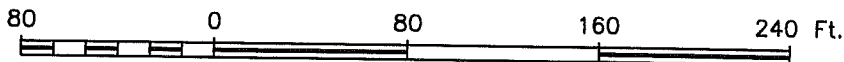

West Galveston Bay
OPEN WATER AREA "A"

M.H.W. as determined
by Sidney Bouse, L.S.L.S.
on October 30, 2007.

PROPERTY LINE

MATCH LINE PG. 3

MATCH LINE PG. 13

TRANSECT "D"



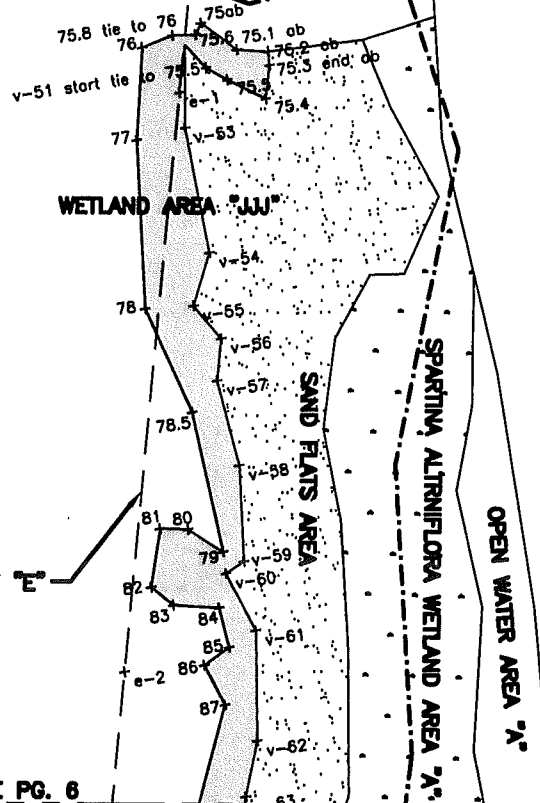

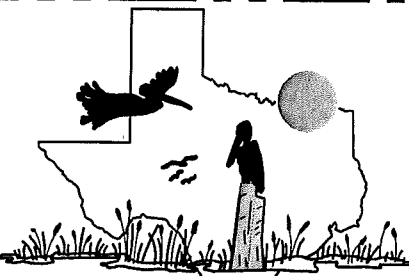

TRANSECT "E"



MATCH LINE PG. 6

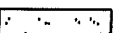

COASTAL SURVEYING OF TEXAS, INC.
8017 HARBORSIDE DRIVE PH (409) 740-1517
GALVESTON, TX. 77554 FAX (409) 740-0377
surveygalveston.com

-  DELINEATED WETLANDS
-  SPARTINA ALTERNIFLORA WETLAND
-  SAND FLATS
-  MEAN HIGH WATER LINE
-  TRANSECT LINE
-  PROPERTY LINE

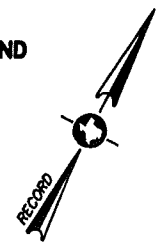

SCALE: 1" = 80'

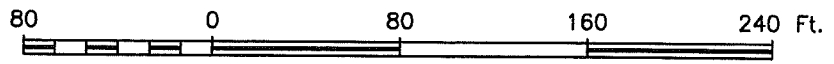

"SERVING GALVESTON COUNTY OVER 55 YEARS"

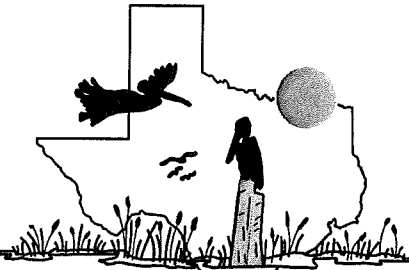
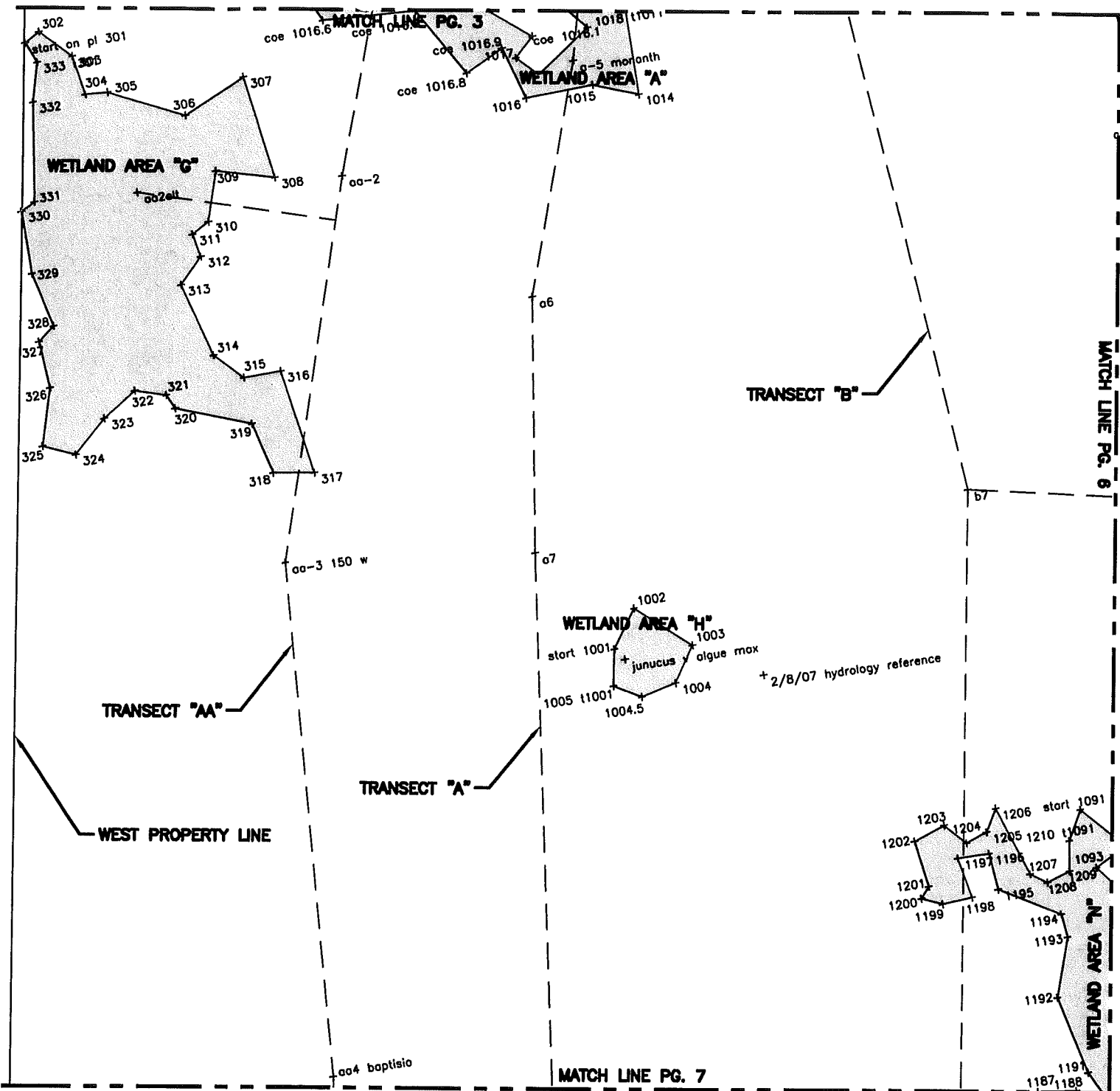



COASTAL SURVEYING OF TEXAS, INC.
 8017 HARBORSIDE DRIVE PH (409) 740-1517
 GALVESTON, TX. 77554 FAX (409) 740-0377
 surveygalveston.com

"SERVING GALVESTON COUNTY OVER 55 YEARS"
 PG. 5 07-0218_WETLAND_REV

-  DELINEATED WETLANDS
-  TRANSECT LINE
-  PROPERTY LINE

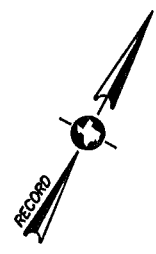

SCALE: 1" = 80'

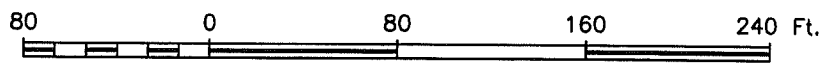

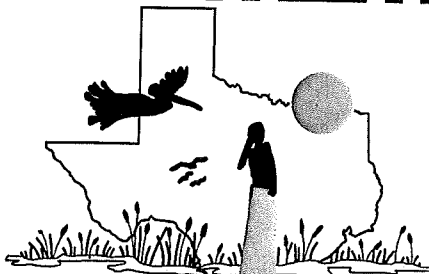
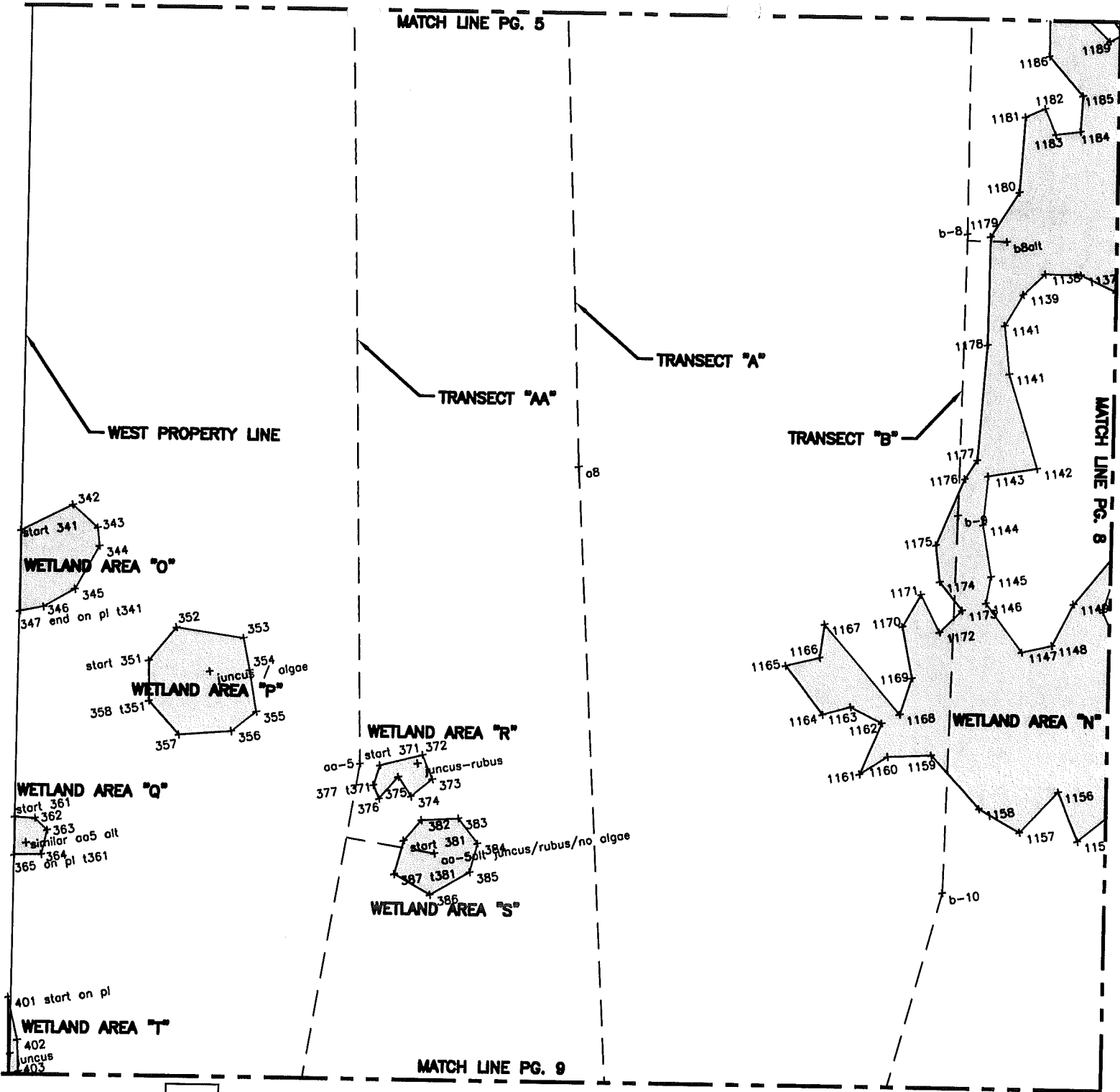

MATCH LINE PG. 5



COASTAL SURVEYING OF TEXAS, INC.
 8017 HARBORSIDE DRIVE PH (409) 740-1517
 GALVESTON, TX. 77554 FAX (409) 740-0377
surveygalveston.com

"SERVING GALVESTON COUNTY OVER 55 YEARS"



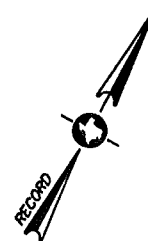

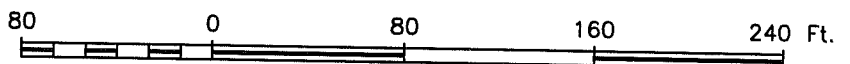

-  DELINEATED WETLANDS
-  TRANSECT LINE
-  PROPERTY LINE

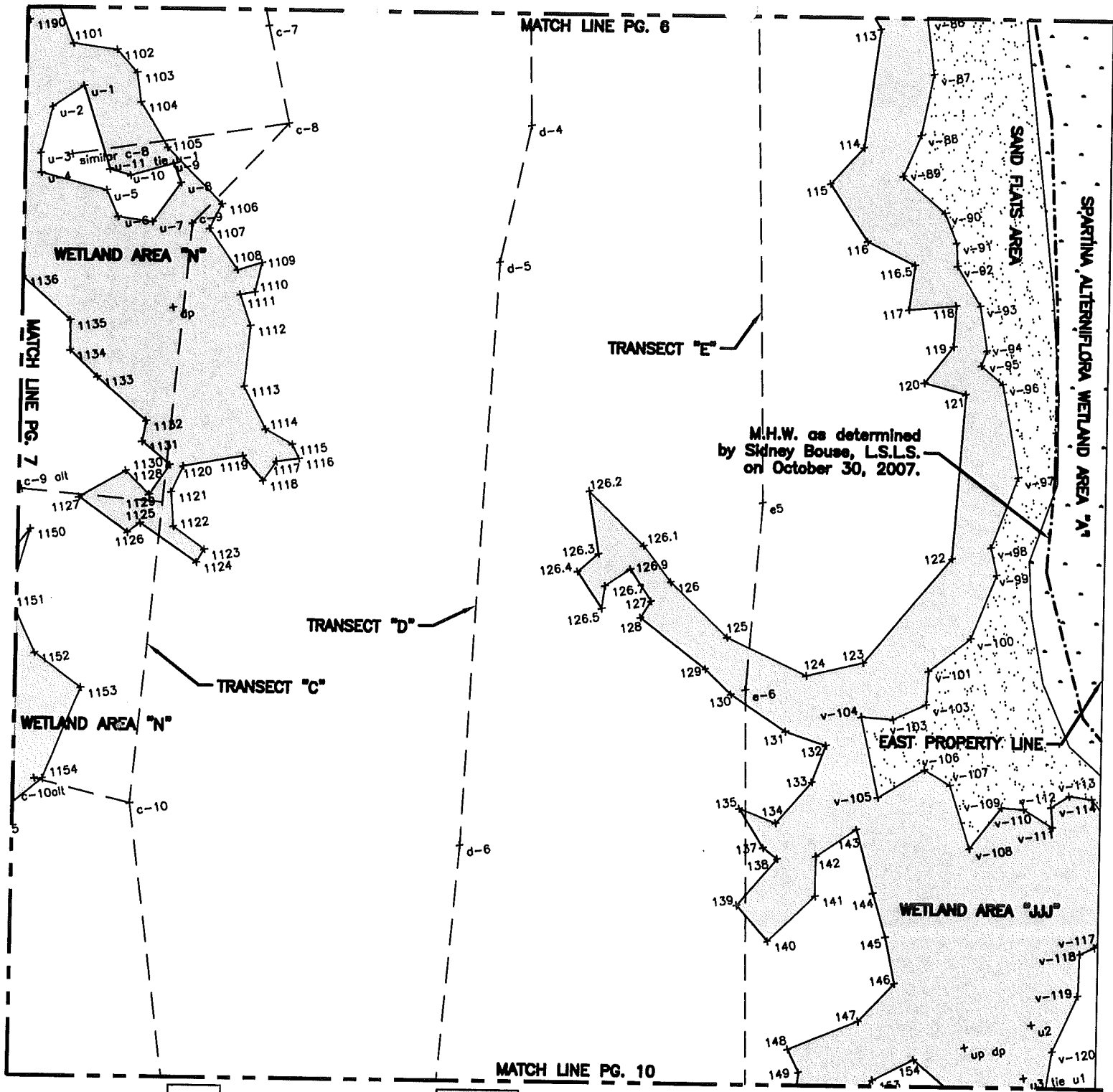

SCALE: 1" = 80'





-  DELINEATED WETLANDS
-  SPARTINA ALTERNIFLORA WETLAND
-  SAND FLATS
-  MEAN HIGH WATER LINE
-  TRANSECT LINE
-  PROPERTY LINE

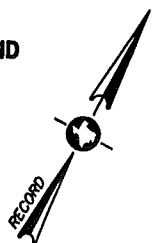

SCALE: 1" = 80'

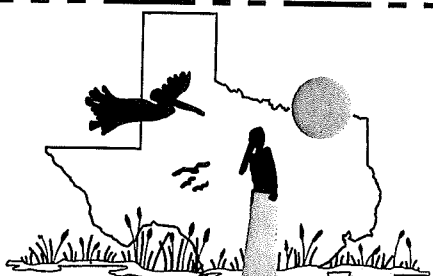
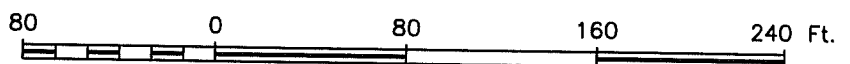

COASTAL SURVEYING OF TEXAS, INC.
 8017 HARBORSIDE DRIVE PH (409) 740-1517
 GALVESTON, TX. 77554 FAX (409) 740-0377
surveygalveston.com

"SERVING GALVESTON COUNTY OVER 55 YEARS"

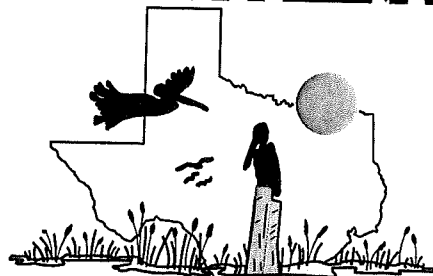
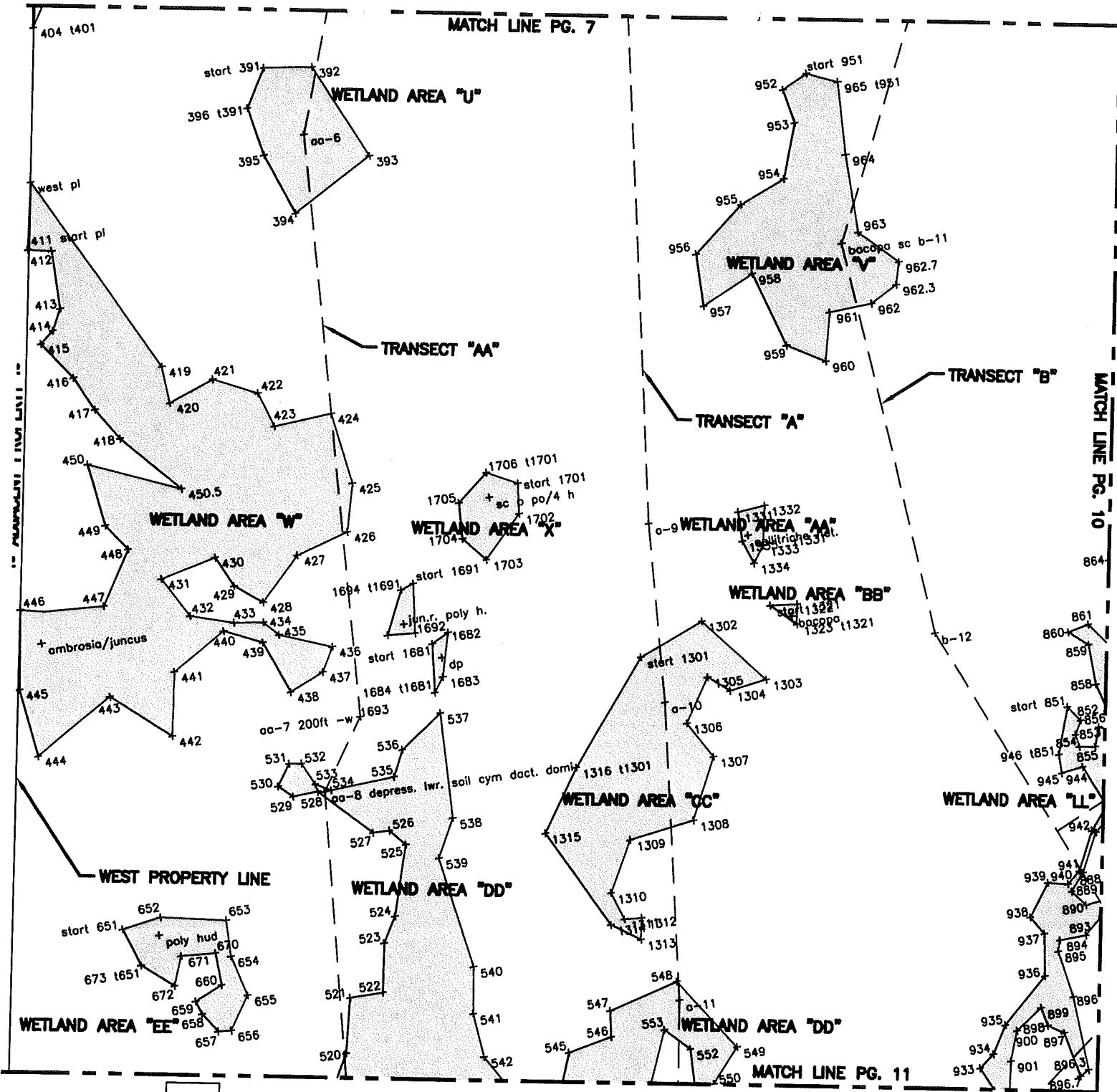

COASTAL SURVEYING OF TEXAS, INC.
 8017 HARBORSIDE DRIVE PH (409) 740-1517
 GALVESTON, TX. 77554 FAX (409) 740-0377
surveygalveston.com

"SERVING GALVESTON COUNTY OVER 55 YEARS"

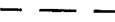
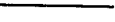

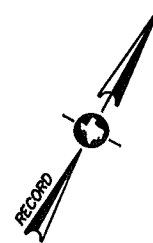
-  DELINEATED WETLANDS
-  TRANSECT LINE
-  PROPERTY LINE

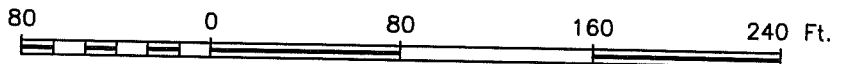

SCALE: 1" = 80'

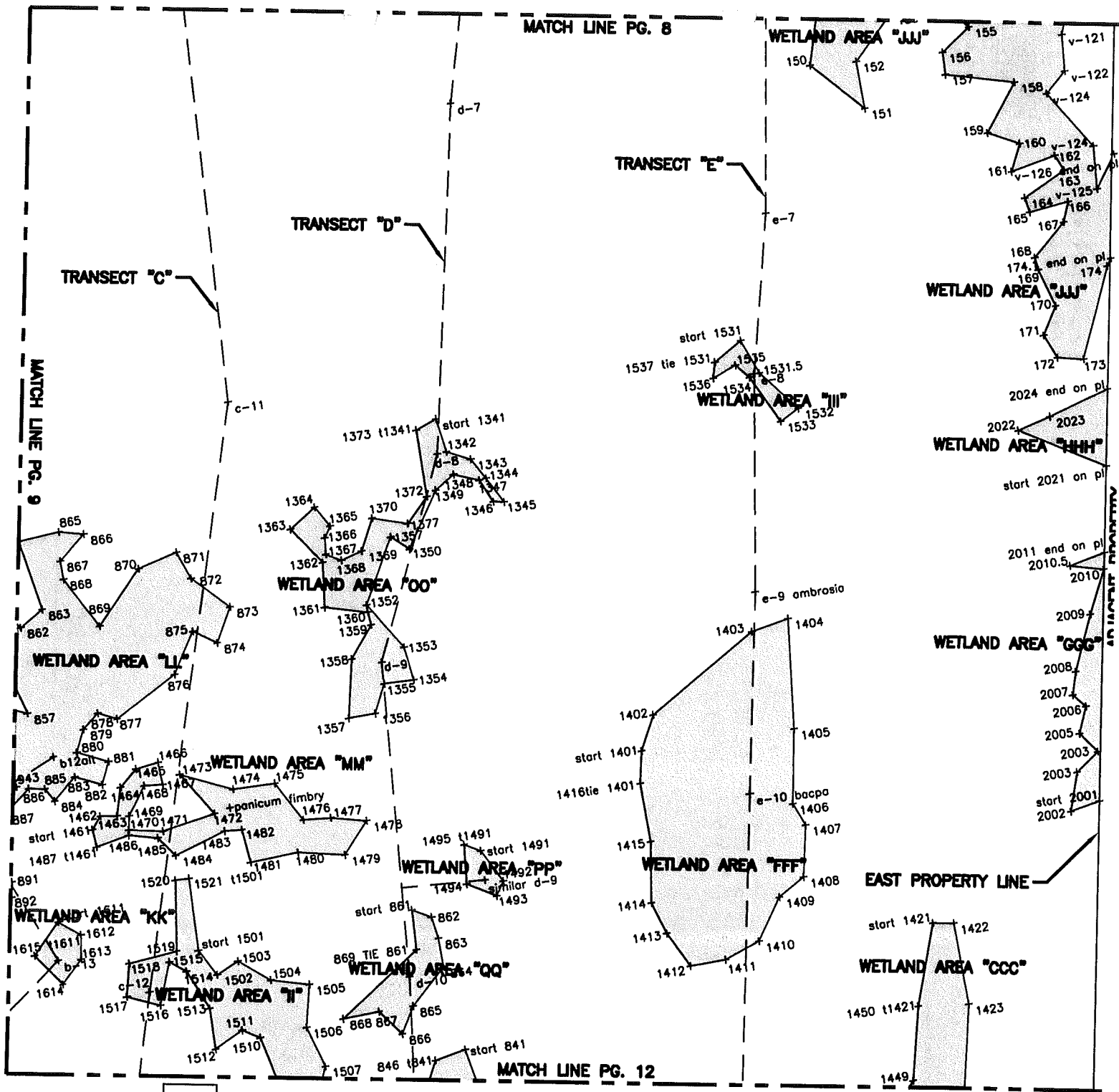



-  DELINEATED WETLANDS
-  TRANSECT LINE
-  PROPERTY LINE

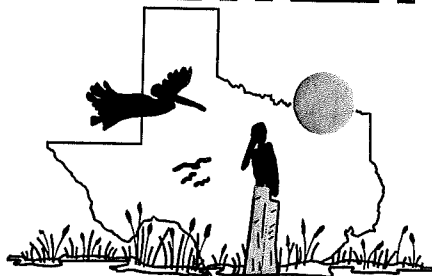

COASTAL SURVEYING OF TEXAS, INC.
 8017 HARBORSIDE DRIVE PH (409) 740-1517
 GALVESTON, TX. 77554 FAX (409) 740-0377
surveygalveston.com

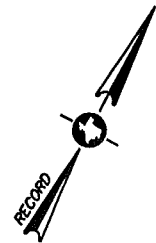

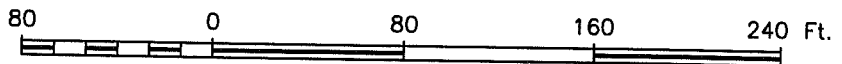

SCALE: 1" = 80'

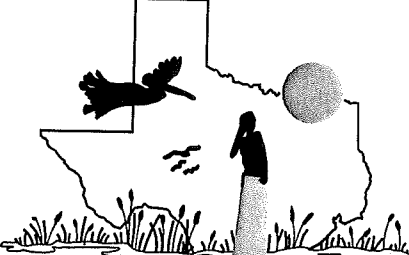
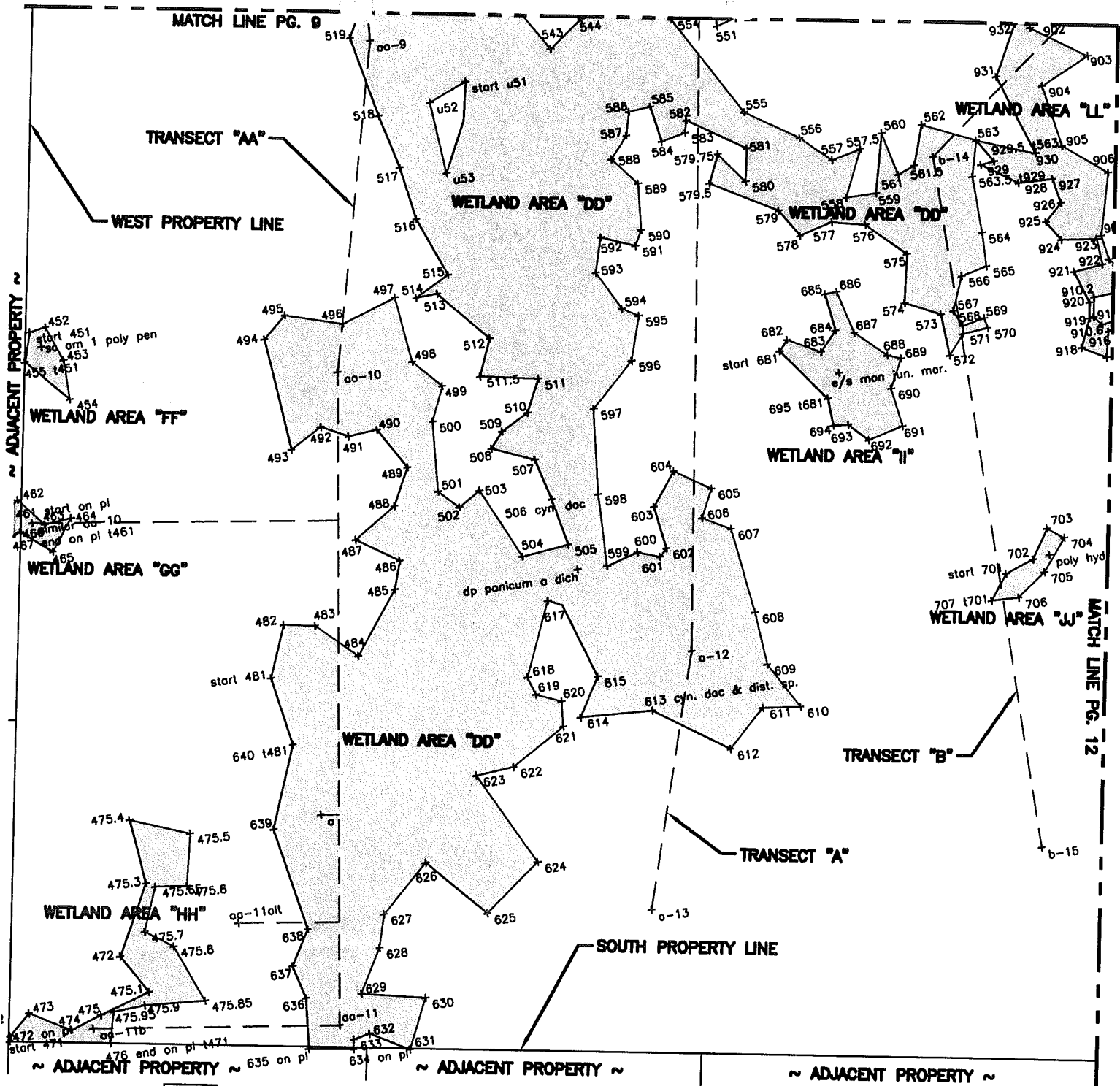



COASTAL SURVEYING OF TEXAS, INC.
 8017 HARBORSIDE DRIVE PH (409) 740-1517
 GALVESTON, TX. 77554 FAX (409) 740-0377
surveygalveston.com

"SERVING GALVESTON COUNTY OVER 55 YEARS"

-  DELINEATED WETLANDS
-  TRANSECT LINE
-  PROPERTY LINE

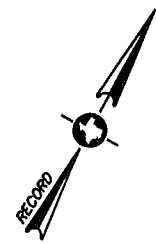

SCALE: 1" = 80'

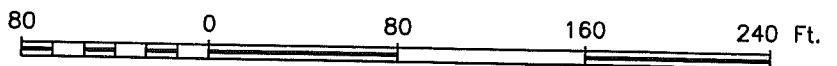

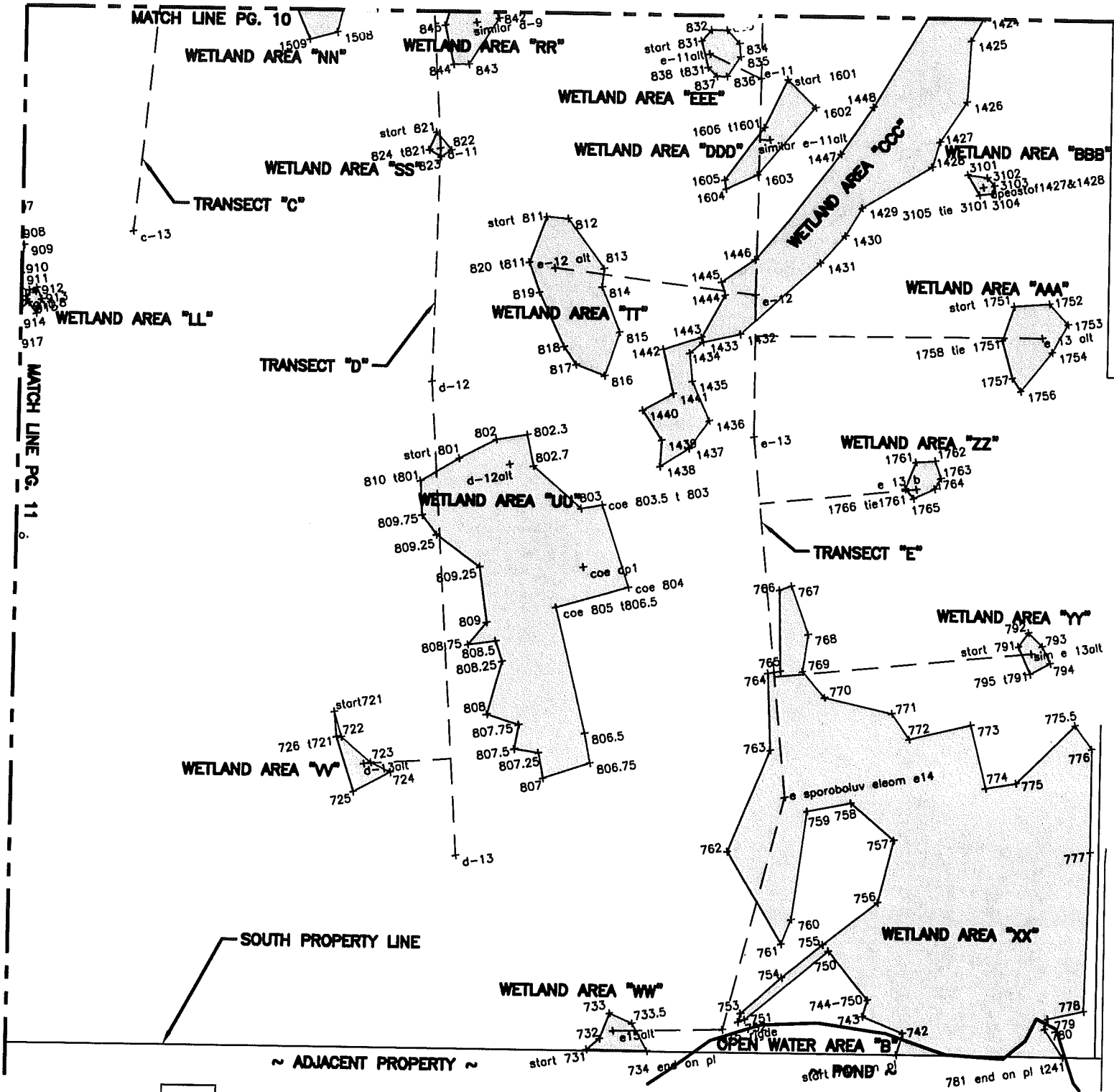

COASTAL SURVEYING OF TEXAS, INC.
 8017 HARBORSIDE DRIVE PH (409) 740-1517
 GALVESTON, TX. 77554 FAX (409) 740-0377
 surveygalveston.com

- DELINEATED WETLANDS
- TRANSECT LINE
- PROPERTY LINE

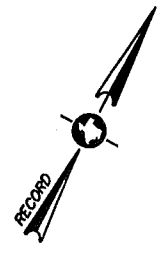

SCALE: 1" = 80'

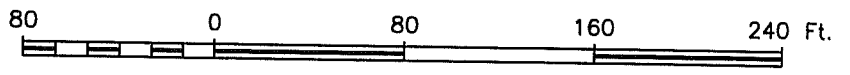

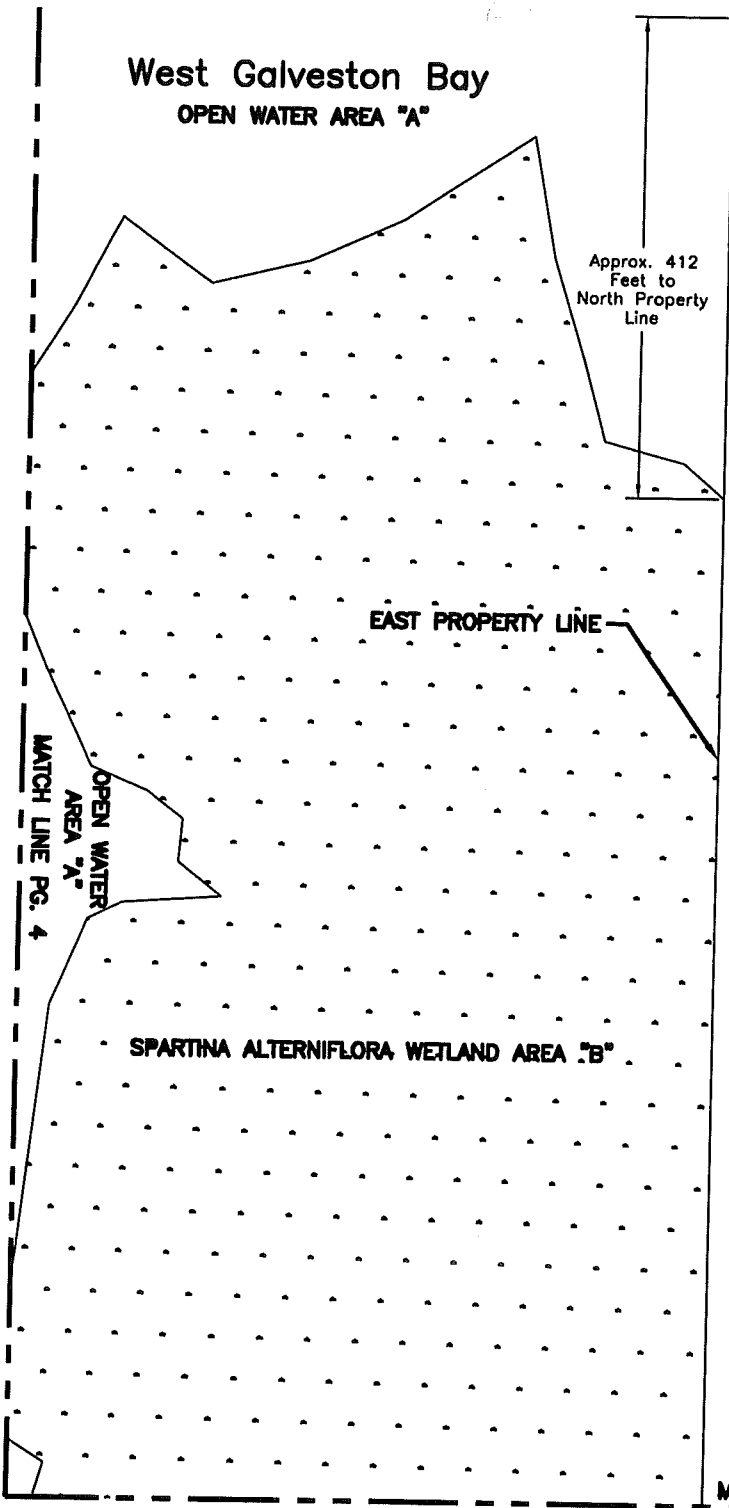

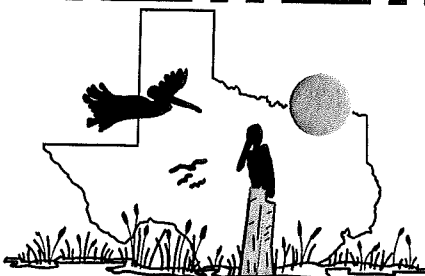

~ ADJACENT PROPERTY ~

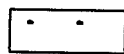

COASTAL SURVEYING OF TEXAS, INC.
 8017 HARBORSIDE DRIVE PH (409) 740-1517
 GALVESTON, TX. 77554 FAX (409) 740-0377
 surveygalveston.com

"SERVING GALVESTON COUNTY OVER 55 YEARS"

-  SPARTINA ALTERNIFLORA WETLAND
-  PROPERTY LINE

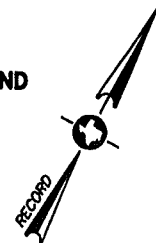

SCALE: 1" = 80'

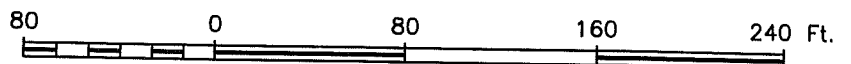

MATCH LINE PG. 13

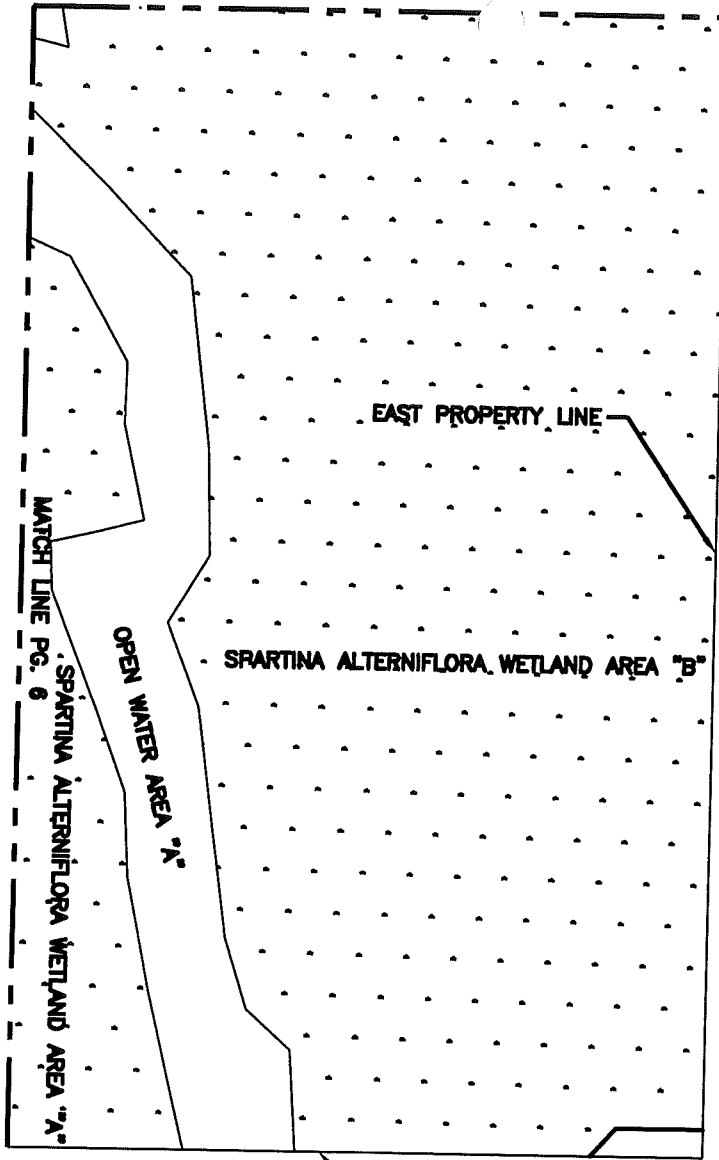

~ ADJACENT PROPERTY ~

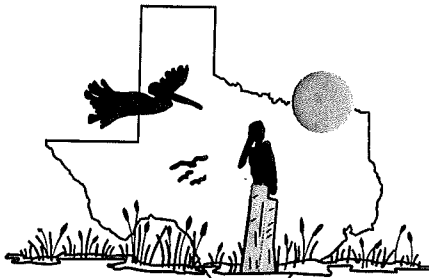

PROPERTY LINE

~ ADJACENT PROPERTY ~

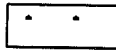

COASTAL SURVEYING OF TEXAS, INC.
 8017 HARBORSIDE DRIVE PH (409) 740-1517
 GALVESTON, TX. 77554 FAX (409) 740-0377
surveygalveston.com

"SERVING GALVESTON COUNTY OVER 55 YEARS"

-  SPARTINA MARSH
-  PROPERTY LINE

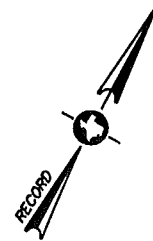

SCALE: 1" = 80'

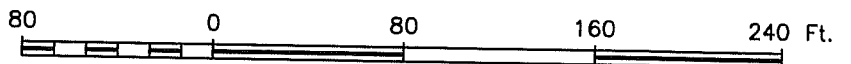

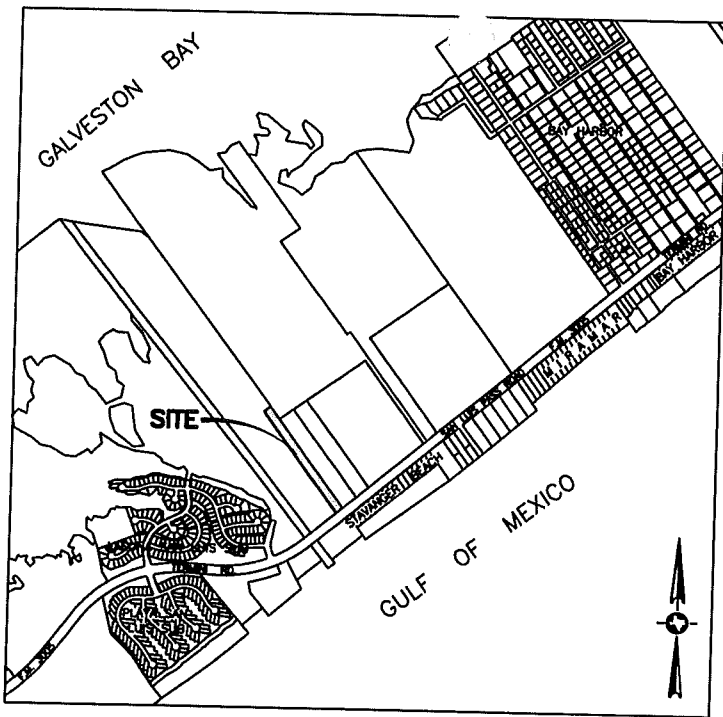

Vicinity Map
N.T.S.

January 4, 2008

Wetland survey of a 3.55 acre tract out of Division 3 of the Hall and Jones Survey of Galveston Island, Galveston County, Texas.

I hereby certify that on the above date, the herein described property, together with improvements located thereon, was surveyed on the ground and under my direction, and that this map, together with dimensions as shown hereon, accurately represents the facts as found on the ground this date.

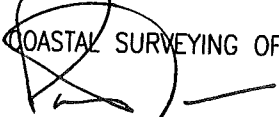
 COASTAL SURVEYING OF TEXAS

Patrick A. Jordan
Registered Professional
Land Surveyor 5525

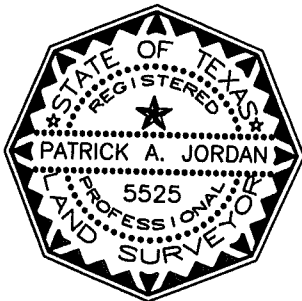

AREAS	SQ. FT.	ACRE
WETLAND AREA "NNN"	2,029.01	0.05
WETLAND AREA "OOO"	6,305.77	0.14

AREA SUMMARY	SQ. FT.	ACRE
UPLANDS	146,270.97	3.36
DELINEATED WETLANDS	8,334.78	0.19
TOTAL AREA OF TRACT	154,605.75	3.55

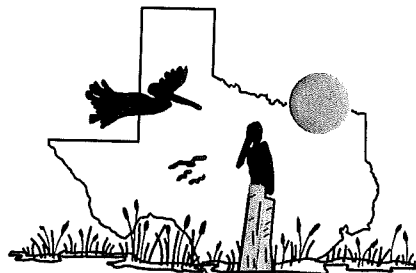

COASTAL SURVEYING OF TEXAS, INC.
8017 HARBORSIDE DRIVE PH (409) 740-1517
GALVESTON, TX. 77554 FAX (409) 740-0377
surveygalveston.com

"SERVING GALVESTON COUNTY OVER 55 YEARS"

This property does lie within the 100 Year Flood Plain as established by the Federal Emergency Management Agency.
ADDENDUM "A" REV - Page 1

This property is subject to Zoning Ordinances by the City of Galveston and to any restrictions of record.

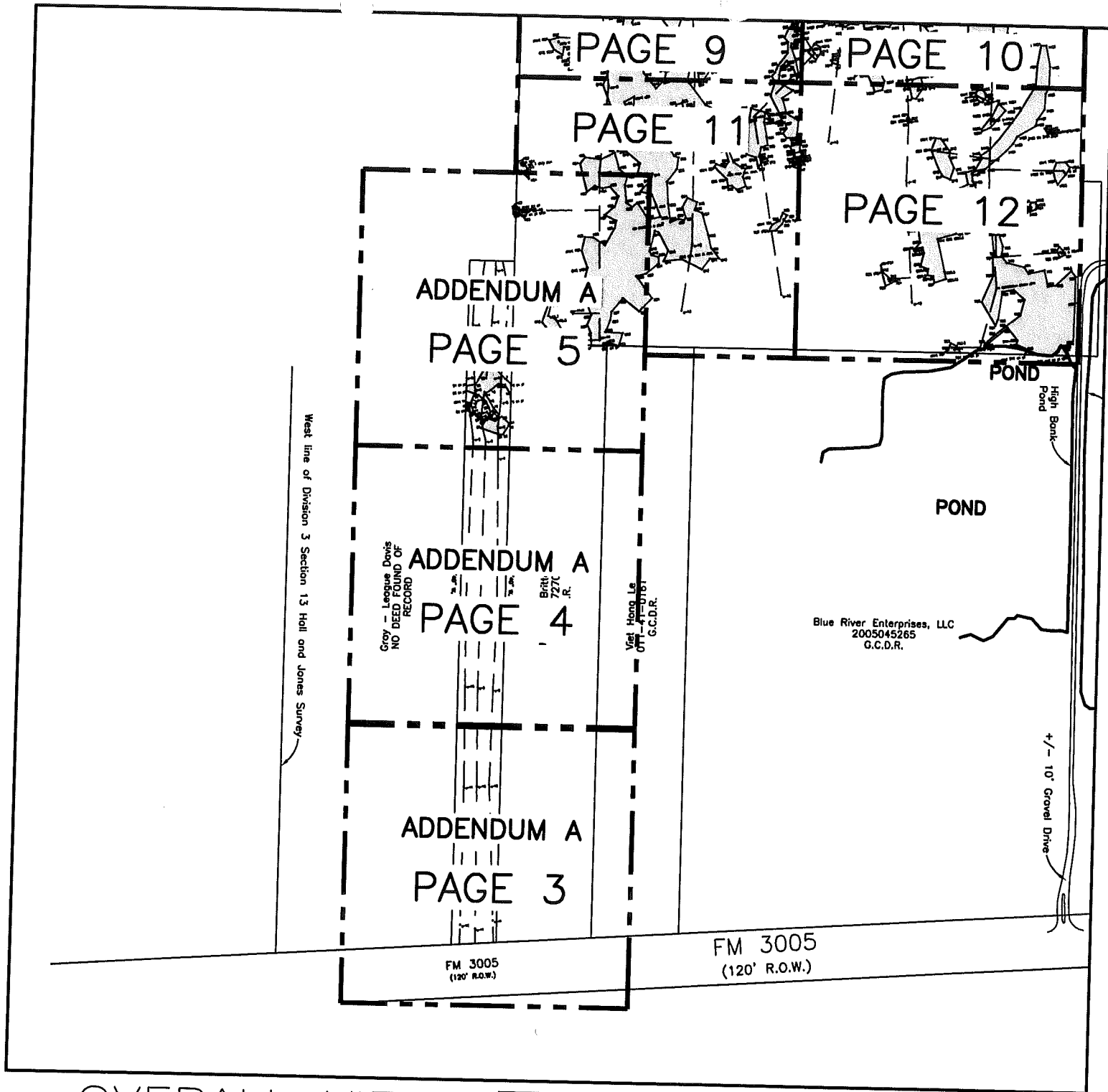

OVERALL VIEW

OVERALL VIEW

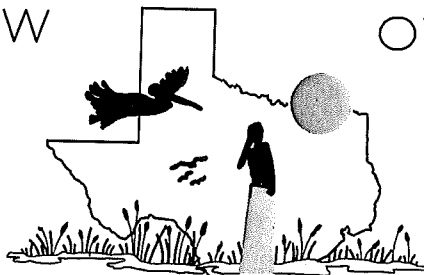

COASTAL SURVEYING OF TEXAS, INC.
 8017 HARBORSIDE DRIVE PH (409) 740-1517
 GALVESTON, TX. 77554 FAX (409) 740-0377
surveygalveston.com

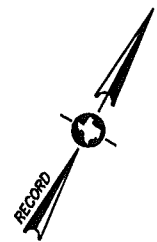

NTS

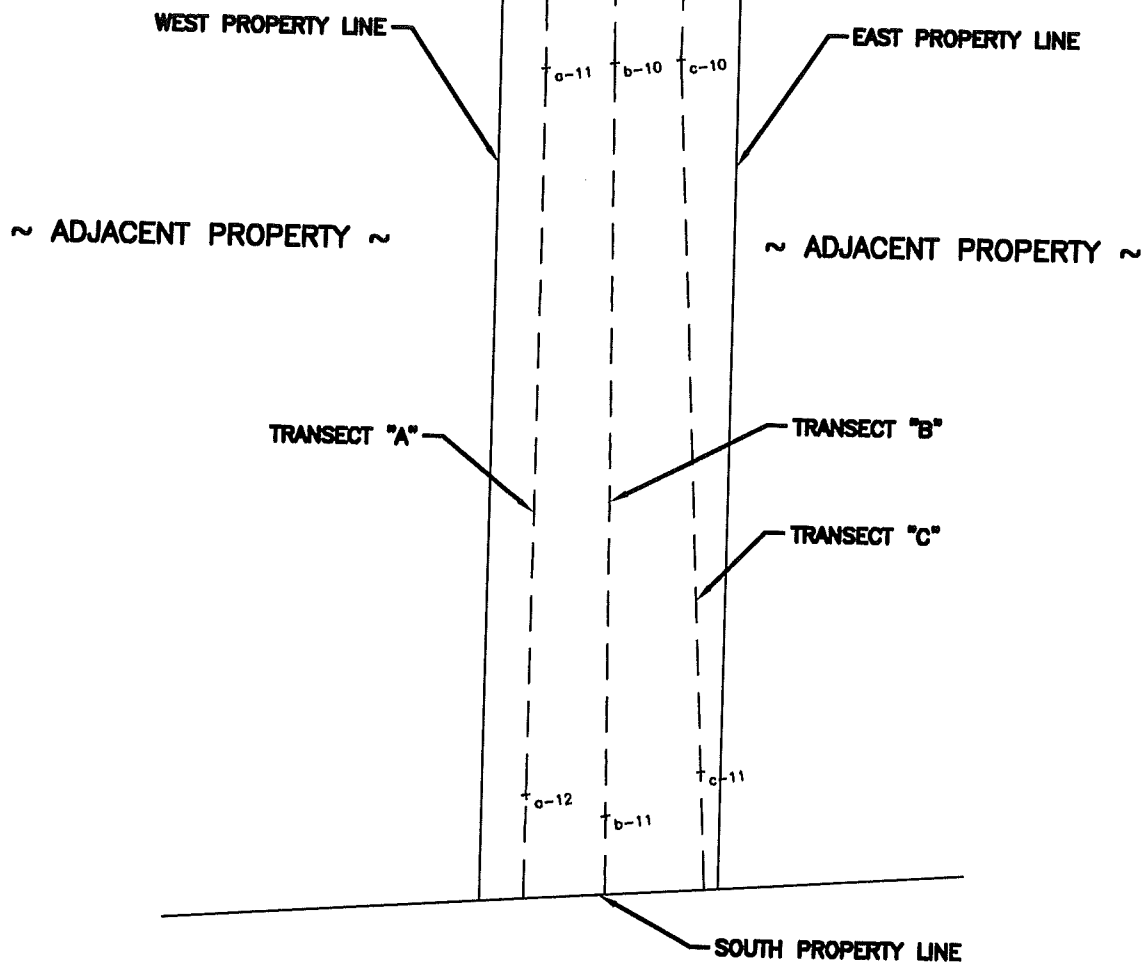

FM 3005
(120' R.O.W.)

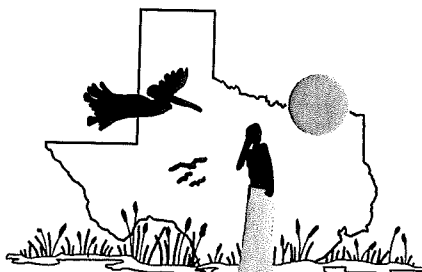

COASTAL SURVEYING OF TEXAS, INC.
 8017 HARBORSIDE DRIVE PH (409) 740-1517
 GALVESTON, TX. 77554 FAX (409) 740-0377
surveygalveston.com

"SERVING GALVESTON COUNTY OVER 55 YEARS"

--- TRANSECT LINE
 ——— PROPERTY LINE

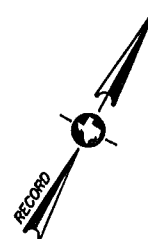

SCALE: 1" = 80'

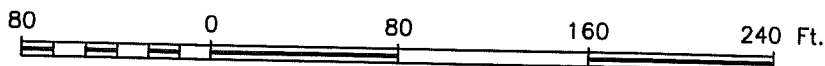

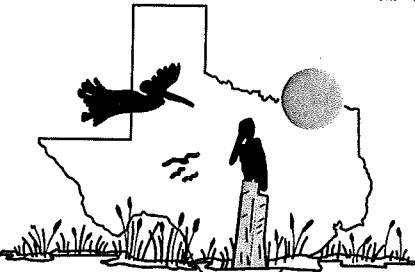
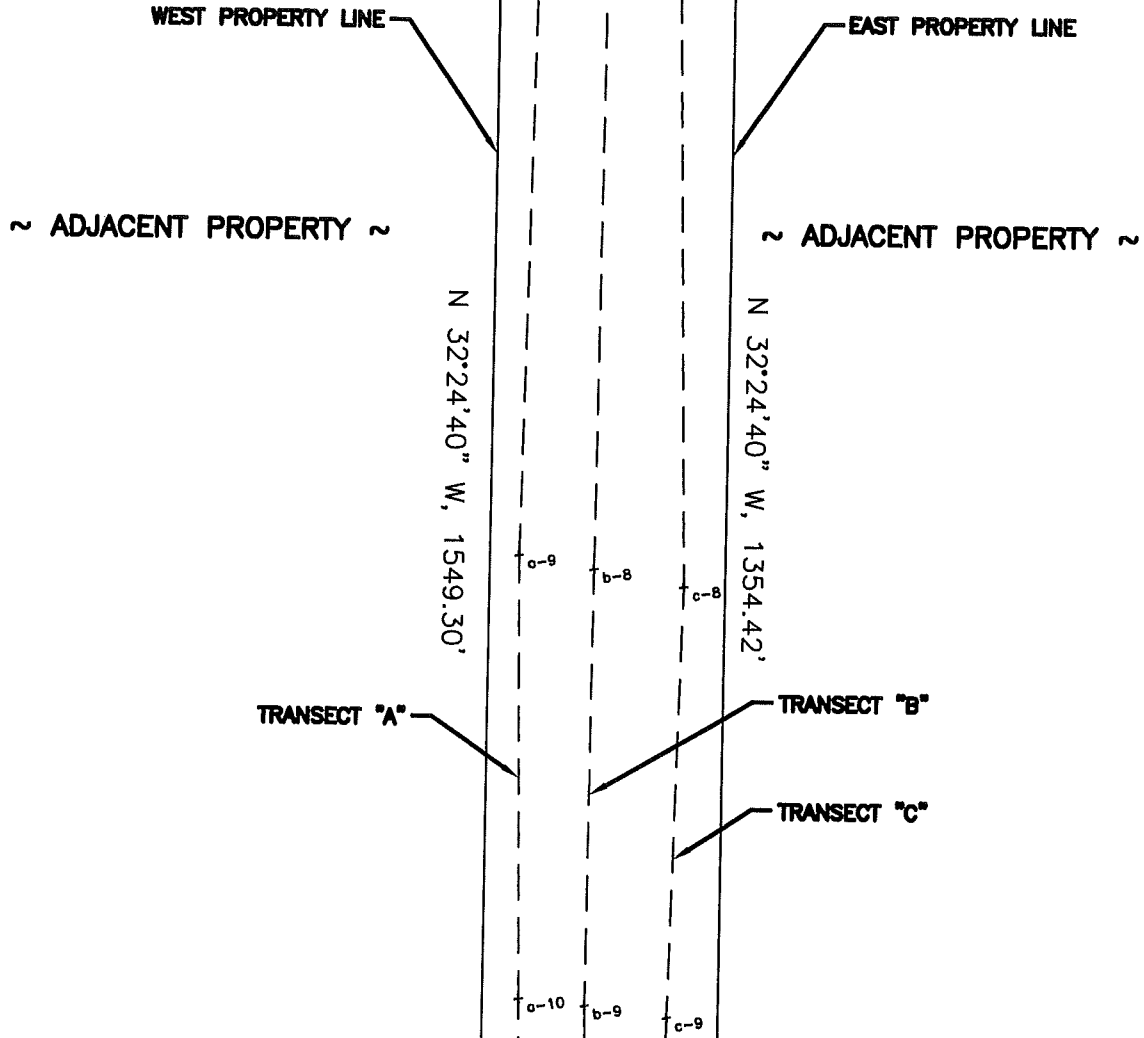

COASTAL SURVEYING OF TEXAS, INC.
 8017 HARBORSIDE DRIVE PH (409) 740-1517
 GALVESTON, TX. 77554 FAX (409) 740-0377
surveygalveston.com

"SERVING GALVESTON COUNTY OVER 55 YEARS"

--- TRANSECT LINE
 ——— PROPERTY LINE

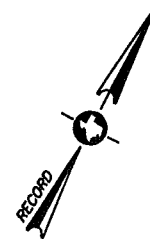

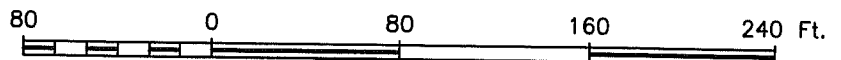

SCALE: 1" = 80'

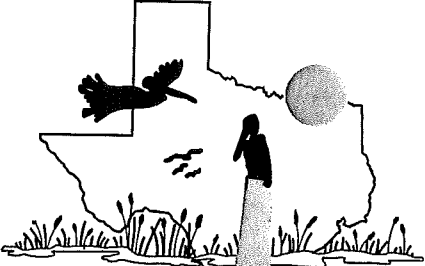
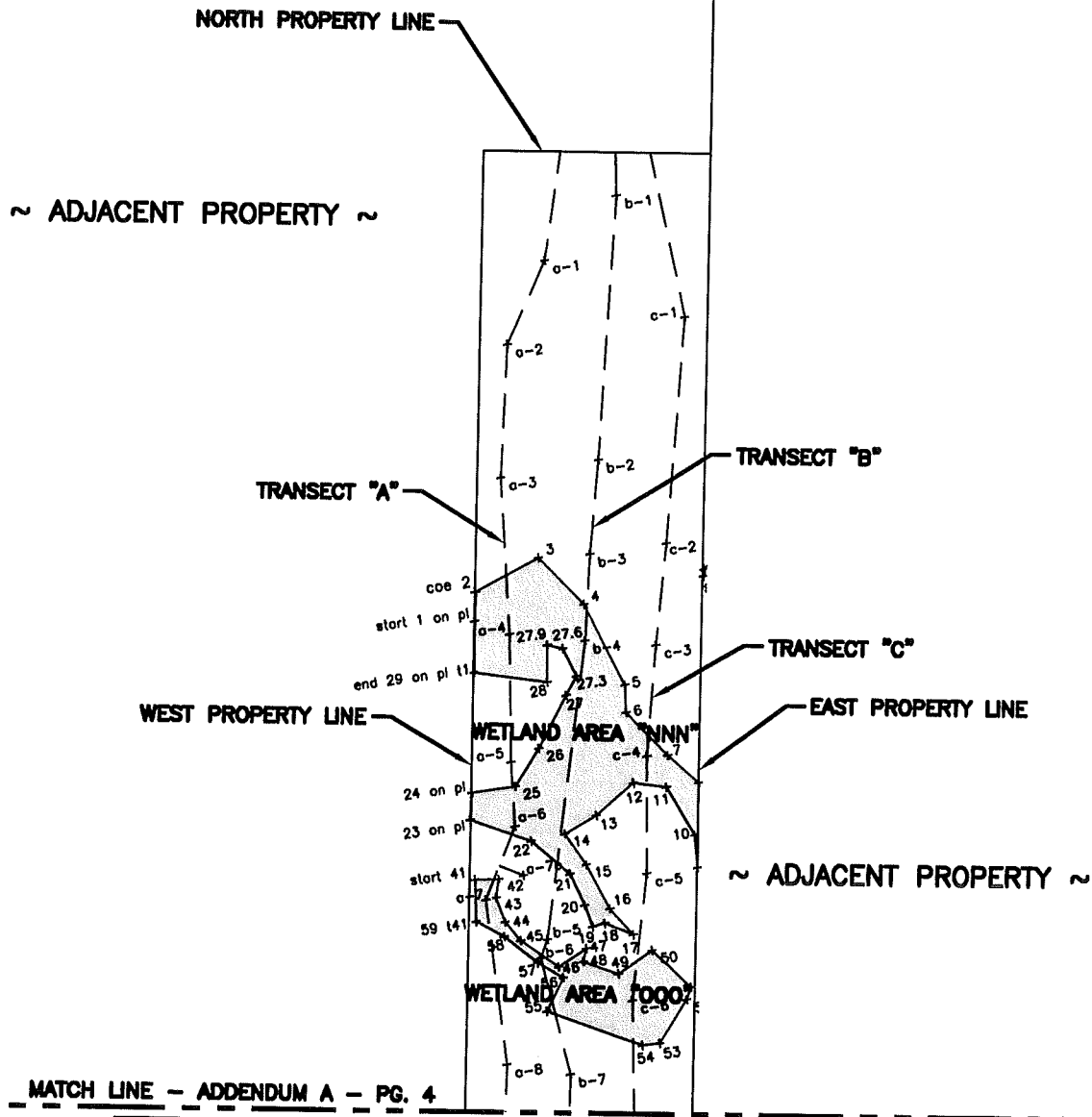

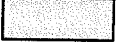

COASTAL SURVEYING OF TEXAS, INC.
 8017 HARBORSIDE DRIVE PH (409) 740-1517
 GALVESTON, TX. 77554 FAX (409) 740-0377
surveygalveston.com

"SERVING GALVESTON COUNTY OVER 55 YEARS"
 ADDENDUM "A" REV - Page 5

-  DELINEATED WETLANDS
-  TRANSECT LINE
-  PROPERTY LINE

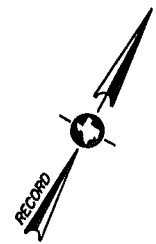

SCALE: 1" = 80'

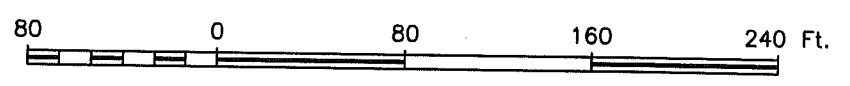

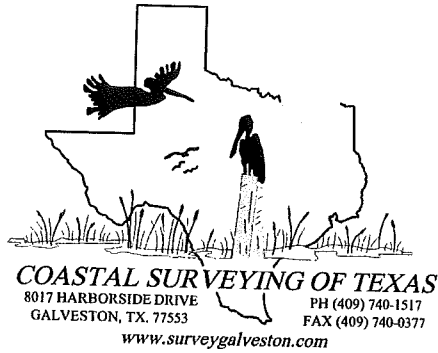

"SERVING GALVESTON COUNTY OVER 50 YEARS"

REVISED MASTER COORDINATE LIST FOR 07-0218-WETLAND

TRANSECT "AA" COORDINATES

Northing	Easting	Elevation	Description
13613626.9800	3217728.4000	3.15	aa-1
13613450.5000	3217817.3500	3.23	aa-2
13613249.5700	3217927.0900	3.89	aa-3
13613028.1100	3218129.1320	5.16	aa-4
13612671.9200	3218406.9600	4.12	aa-5
13612656.6500	3218473.6200	4.28	aa-5 alt
13612438.4900	3218525.8200	3.72	aa-6
13612186.4200	3218762.7600	6.03	aa-7
13612138.7800	3218773.0000	4.52	aa-8
13612001.1300	3218896.8300	4.13	aa-9
13611833.3000	3219001.3500	4.11	aa-10
13611530.1200	3219236.6000	4.14	aa-11
13611441.7800	3219123.8700	4.15	aa-11b
13611541.5100	3219152.7800	6.36	aa-11 alt

TRANSECT "A" COORDINATES

Northing	Easting	Elevation	Description
13613829.4600	3217557.7300	3.10	a-1
13613791.7600	3217630.3690	1.76	a-2
13613719.5800	3217738.4700	3.43	a-3
13613661.0200	3217835.8900	2.68	a-4
13613584.4100	3217883.4300	2.54	a-5
13613459.0600	3217947.8180	3.81	a-6
13613340.3200	3218039.2820	3.79	a-7
13612887.5300	3218402.6010	4.64	a-8
13612378.7400	3218827.6100	8.05	a-9
13612301.4800	3218899.6740	4.14	a-10
13612168.4100	3219013.1200	4.39	a-11
13611829.0500	3219267.4200	4.22	a-12

TRANSECT "B" COORDINATES

Northing	Easting	Elevation	Description
13614116.0600	3217479.5700	0.82	b-1
13614080.6100	3217529.0100	3.10	b-2
13614041.5300	3217573.3800	1.98	b-3
13613972.3000	3217662.7000	3.55	b-4
13613901.3800	3217752.8600	2.85	b-5
13613710.5500	3217985.8300	3.84	b-6
13613519.7200	3218218.8000	4.84	b-7
13613607.1600	3218347.0700	4.80	b-7 Sp. Vir.

13613134.3900	3218500.4400	4.93	b-8
13612998.8300	3218596.9100	3.60	b-9
13612817.6900	3218723.9600	5.26	b-10
13612579.0100	3218816.8900	4.04	b-11
13612429.3400	3219000.4400	5.98	b-12
13612345.9400	3219224.8800	4.46	b-13
13612146.5200	3219201.8000	4.45	b-14
13611862.2300	3219500.6200	4.43	b-15

TRANSECT "C" COORDINATES

Northing	Easting	Elevation	Description
13614232.1200	3217674.2500	0.82	c-1
13614198.4200	3217707.3200	-0.20	c-2
13614084.7400	3217829.5800	-0.40	c-3
13613862.4700	3218033.2600	3.77	c-4
13613813.7600	3218062.0700	3.08	c-4alt
13613935.7700	3217780.1400	2.45	c-4 similar
13613681.8800	3218273.4860	3.12	c-5
13613714.9800	3218236.7900	3.56	c-5 alt
13613556.2700	3218480.3500	3.26	c-5 similar
13613568.1400	3218395.2640	3.88	c-6
13613365.1300	3218615.0770	4.14	c-7
13613326.2300	3218659.8920	4.79	c-8
13613244.7700	3218650.4300	2.72	c-9
13613060.4900	3218666.7910	4.84	c-9alt
13612951.9000	3218829.4400	4.4	c-10
13612929.9400	3218775.9400	3.75	c-10alt
13612665.5400	3219103.0800	8.43	c-11
13612363.2600	3219278.4810	4.46	c-12
13612206.0100	3219372.2900	5.95	c-13
13613198.4800	3218671.9300	3.68	dp

TRANSECT "D" COORDINATES

Northing	Easting	Elevation	Description
13614205.4900	3218094.9800	3.57	d-1
13613899.0400	3218389.9900	3.35	d-2
13613855.8800	3218431.5400	3.07	d-3
13613801.5100	3218359.1300	3.33	d-3 similar
13613411.5500	3218774.7000	4.01	d-4
13613335.9700	3218809.2800	4.15	d-5
13613049.2100	3218999.1300	4.10	d-6
13612885.7100	3219099.7800	4.09	d-7
13612715.7600	3219220.1700	4.12	d-8
13612598.6100	3219269.0500	4.09	d-9
13612533.7400	3219394.6700	4.13	d-9 similar
13612462.2500	3219394.1200	4.16	d-10
13612353.2400	3219485.2800	4.27	d-11
13612240.5600	3219564.9400	4.25	d-12
13612228.9700	3219630.8100	4.17	d-12alt
13612027.9000	3219745.1200	4.43	d-13
13612038.1500	3219669.9500	4.13	d-13alt

TRANSECT "E" COORDINATES

Northing	Easting	Elevation	Description
13614288.8000	3218277.5000	1.77	e-1
13614076.4700	3218407.5700	1.98	e-2
13613832.0900	3218557.2800	2.82	e-3
13613604.9000	3218793.6400	3.13	e4
13613314.9600	3219017.5400	4.48	e5
13613221.4500	3219076.2600	2.59	e-6
13612945.3100	3219286.4900	3.35	e-7

13612865.5700	3219339.0500	3.47	e-8
13612763.6400	3219417.7800	4.03	e-9 ambrosia
13612667.6500	3219487.4100	4.00	e-10 bacpa
13612499.3800	3219609.8800	5.56	e-11
13612492.7000	3219576.5900	3.02	e-11 alt
13612473.5300	3219636.0500	3.06	similar e-11 alt
13612395.2600	3219684.8600	3.32	e-12
13612336.8100	3219581.0800	3.79	e-12 alt
13612328.0400	3219734.9000	5.09	e-13
13612360.8900	3219829.9300	3.99	e-13 b
13612325.2500	3219942.8600	3.61	sim e-13 alt
13612170.7000	3219877.7100	4.12	e sporoboluv eleom e-14
13612040.9500	3219930.9100	5.03	e-15 ridge
13612001.3900	3219879.8500	4.02	e-15 alt

UPLAND COORDINATES

Northing	Easting	Elevation	Description
13613259.9700	3218630.5900	3.69	u-8
13613231.6300	3218631.6100	3.78	u-7
13613222.1400	3218613.9200	3.48	u-6
13613246.0000	3218605.0000	3.79	u-10
13613241.7900	3218593.0700	3.63	u-11 tie u-1
13613230.8700	3218599.3000	3.54	u-5
13613225.1500	3218555.0200	3.91	u-3
13613216.1200	3218562.2300	3.72	u-4
13613266.4600	3218620.3700	3.89	u-9
13613251.4700	3218544.0600	3.50	u-2
13613272.2900	3218551.2300	3.51	u-1
13613798.8100	3217672.9400	2.47	u-108
13613803.4600	3217701.1900	2.40	u-107
13613811.4800	3217706.4200	2.43	u-106
13613827.5000	3217703.4000	2.24	u-105
13613851.7800	3217687.8900	2.02	u-104
13613872.3800	3217666.4800	2.08	u-103
13613874.6800	3217640.4500	2.01	u-102
13613870.7600	3217626.8400	2.10	u-101 start
13613833.1500	3217626.4900	2.02	u-111 end t-u101
13613818.9800	3217630.8100	2.20	u-110
13613802.5000	3217652.8300	2.11	u-109

VEGLINE COORDINATES

Northing	Easting	Elevation	Description
13613098.3300	3219429.2400	1.06	v-126 end on pl
13613075.7700	3219433.8500	1.22	v-125
13613094.8000	3219416.8600	0.87	v-124
13613102.8700	3219376.0500	0.80	v-124
13613120.1600	3219376.4200	0.59	v-122
13613136.3100	3219362.0000	1.05	v-121
13613161.8500	3219348.7700	1.51	v-120
13613196.9500	3219341.1400	1.55	v-119
13613217.1100	3219327.2600	1.67	v-118
13613225.3400	3219331.8600	1.59	v-117
13613225.3200	3219331.9000	1.59	v-117
13613249.9500	3219330.2400	1.38	v-116
13613287.3700	3219300.8800	1.52	v-115
13613293.5300	3219278.2000	1.60	v-114
13613286.9600	3219266.1500	1.64	v-113
13613275.0200	3219261.6200	1.56	v-112
13613266.1900	3219269.5400	1.63	v-111
13613264.3400	3219249.1800	1.53	v-110
13613256.9700	3219238.2200	1.46	v-109

13613226.4500	3219237.3300	1.70	v-108
13613248.8700	3219205.6700	1.45	v-107
13613247.2000	3219188.2100	1.36	v-106
13613217.7800	3219176.1100	1.49	v-105
13613249.6600	3219140.0500	1.06	v-104
13613259.4400	3219155.5190	1.09	v-103
13613278.1200	3219166.0200	1.11	v-103
13613278.1900	3219166.0160	1.02	v-102
13613259.5200	3219155.7900	1.05	v-103
13613294.6000	3219155.1800	1.08	v-101
13613324.8500	3219163.6600	0.82	v-100
13613363.8600	3219153.4000	0.94	v-99
13613374.7700	3219140.8700	0.98	v-98
13613417.5200	3219128.7800	0.96	v-97
13613455.7000	3219088.1300	1.09	v-96
13613456.7800	3219071.3900	1.31	v-95
13613465.8600	3219068.6600	1.17	v-94
13613484.6100	3219049.5400	1.10	v-93
13613495.1300	3219024.2300	1.20	v-92
13613505.7000	3219015.5700	1.23	v-91
13613515.6300	3218999.3900	1.23	v-90
13613518.5400	3218966.6500	1.51	v-89
13613544.2900	3218960.4000	1.46	v-88
13613577.7400	3218944.5400	1.45	v-87
13613601.5900	3218921.7900	1.41	v-86
13613621.2200	3218896.6900	1.36	v-85
13613638.5400	3218882.9400	1.47	v-84
13613760.7500	3218701.9600	1.78	v-74
13613739.2200	3218727.3300	1.71	v-75
13613732.3900	3218722.4100	1.56	v-76
13613735.0500	3218737.4400	1.51	v-77
13613720.3100	3218777.6900	1.33	v-78
13613704.0000	3218783.0500	1.27	v-79
13613695.0700	3218793.2700	1.13	v-80
13613694.5000	3218807.9200	1.46	v-81
13613680.1900	3218821.2500	1.28	v-82
13613675.5500	3218842.7100	1.34	v-83
13613818.9900	3218689.2300	1.48	v-72
13613836.0200	3218680.1700	1.22	v-71
13613861.4000	3218644.6600	1.11	v-70
13613877.2100	3218640.4100	1.12	v-69
13613903.3000	3218611.0600	1.32	v-68
13613914.8800	3218613.3500	1.02	v-67
13613938.1700	3218599.8800	1.21	v-66
13613971.8700	3218554.0700	1.32	v-65
13614018.7900	3218506.2900	1.35	v-64
13614064.6400	3218481.2500	1.51	v-63
13614086.7000	3218470.7700	1.38	v-62
13614124.0200	3218441.9400	1.44	v-61
13614304.3100	3218280.1100	1.86	v-52
13614304.0100	3218280.1400	1.75	v-51 start tie to 75.5
13614306.5100	3218267.0800	1.93	v-52
13614278.0500	3218288.5700	1.67	v-53
13614241.5100	3218329.1900	1.50	v-54
13614219.3000	3218337.4100	1.57	v-55
13614215.0900	3218355.2000	1.39	v-56
13614199.6400	3218364.6600	1.39	v-57
13614176.2200	3218393.9000	1.33	v-58
13614144.6400	3218420.1500	1.51	v-59
13614135.9100	3218417.0900	1.29	v-60
13613880.6600	3217641.1900	1.64	v-17
13613878.2400	3217621.3400	1.60	v-16

13613846.9600	3217613.2800	1.60	v-15
13613853.2100	3217599.1200	1.58	v-14
13613812.2300	3217609.8700	1.67	v-13
13613794.0800	3217603.7200	1.61	v-12
13613763.1800	3217620.3100	1.81	v-11
13613724.6600	3217586.5100	1.90	v-10
13613749.8400	3217558.9300	1.98	v-9
13613770.7400	3217553.3000	1.80	v-8
13613771.2800	3217545.7400	1.76	v-7
13613730.8700	3217534.8200	1.93	v-6
13613709.0400	3217553.4400	1.95	v-5
13613672.2000	3217542.2800	1.73	v-4
13613732.0100	3217405.8500	1.80	v-3
13613752.5200	3217389.7800	1.71	v-2
13613756.6600	3217361.2900	1.54	v-1 start veg line
13613904.6700	3217636.2700	1.59	v-18
13613915.1800	3217620.5200	1.57	v-19
13613938.5800	3217597.9500	1.50	v-20
13613977.6400	3217572.3900	1.58	v-21
13613997.6500	3217573.6100	1.72	v-23
13614027.1600	3217564.4100	1.71	v-24
13614057.0700	3217576.1800	1.84	v-25
13614077.2900	3217591.5400	1.75	v-26
13614075.4800	3217570.2700	1.85	v-26.5
13614092.7800	3217573.7000	1.83	v-27
13614137.7500	3217554.5400	2.03	v-28 t-v-53

SPARTINA ALT. DATA POINT COORDINATE

Northing	Easting	Elevation	Description
13613782.0440	3218836.5160	0.30	sp alt. dp

WETLAND AREA "A" COORDINATES

Northing	Easting	Elevation	Description
13613752.5300	3217364.4000	1.69	start line on pl - 1
13613595.8400	3217480.4400	2.73	2 on pl
13613606.0400	3217502.9000	2.57	3
13613592.6700	3217516.2300	2.54	4
13613593.2700	3217531.6800	2.51	5
13613577.6000	3217538.2600	2.32	6
13613571.6700	3217550.4100	2.46	7
13613547.8600	3217586.1400	2.58	8
13613536.0700	3217610.5700	2.73	9
13613540.3800	3217696.3400	2.67	11
13613540.8000	3217664.3600	2.86	10
13613558.4300	3217702.2800	2.69	12
13613568.2800	3217721.9900	2.65	13
13613597.6800	3217717.2600	2.79	14
13613623.4100	3217687.8600	2.87	15
13613639.7500	3217619.7800	2.33	16
13613660.3100	3217605.6500	2.56	17
13613681.9500	3217600.9200	2.65	18
13613700.8200	3217609.1800	2.67	19
13613708.7500	3217627.9100	2.65	20
13613729.9500	3217645.7700	2.57	21
13613763.9900	3217672.4100	2.52	22
13613747.2200	3217705.4600	2.63	23
13613752.5900	3217732.2600	2.66	24
13613737.9400	3217762.3800	2.61	25
13613715.1900	3217778.1300	2.71	26
13613671.4500	3217790.8600	3.11	27
13613653.1500	3217803.9900	2.86	28

13613665.5400	3217818.8200	2.54	29
13613675.9400	3217839.2700	2.56	30
13613706.0500	3217822.7100	2.75	31
13613749.9300	3217826.6700	2.70	32
13613785.7300	3217805.9000	2.52	33
13613822.2100	3217782.2400	2.57	34
13613853.9900	3217772.2600	2.72	35
13613884.1900	3217727.9800	2.55	36
13613924.8700	3217726.6700	2.65	37
13613938.8400	3217709.5600	2.54	38
13613959.6800	3217697.0900	2.78	39
13613960.6600	3217658.4500	0.00	40
13613961.6300	3217619.8200	2.37	41
13613978.5700	3217601.2400	2.38	42
13614026.4800	3217589.6800	2.46	43
13614144.8300	3217558.0700	1.54	53 start abrupt bank
13614119.8400	3217587.8400	2.56	52
13614113.6900	3217604.9000	2.62	51
13614081.8100	3217654.3000	2.75	50
13614051.7700	3217700.9500	2.79	49
13614031.9700	3217704.1900	2.84	48
13613633.0600	3217883.9100	2.77	1013
13613624.0300	3217860.4000	2.54	1012
13613606.6500	3217854.9200	2.79	start 1011
13613604.9500	3217878.3900	2.81	1018 t1011
13613579.7600	3217901.1200	2.85	1015
13613591.8300	3217926.4600	2.97	1014
13613550.4200	3217874.7400	3.01	1016
13613774.6000	3217829.5400	2.71	coe 32.5
13613565.5400	3217845.9600	3.13	coe 1016.9
13613581.7700	3217855.9500	2.67	coe 1016.1
13613541.7000	3217838.5900	2.96	coe 1016.8
13613553.4200	3217792.9100	3.01	coe 1016.7
13613564.6200	3217791.1500	2.96	coe dp2
13613573.2000	3217778.1300	2.84	coe 1016.2
13613517.0100	3217753.3200	3.00	coe 1016.6
13613540.2200	3217751.2800	2.96	coe 1016.3
13613537.5700	3217691.9200	3.06	coe 1016.5
13613548.7300	3217700.0500	2.85	coe 1016.4
13613565.9100	3217855.8800	2.94	1017

WETLAND AREA "B" COORDINATES

Northing	Easting	Elevation	Description
13614133.3400	3217746.3200	3.49	start 1811
13614143.2900	3217751.5300	3.26	1812
13614142.9600	3217797.4000	3.27	1813
13614131.8100	3217864.3200	3.27	1814
13614041.5100	3217842.5900	3.54	1816
13614085.0600	3217875.7400	3.41	1815
13614040.1900	3217796.1500	3.26	1817
13614091.3400	3217772.6300	3.31	1818tie 1811

WETLAND AREA "C" COORDINATES

Northing	Easting	Elevation	Description
13613954.4200	3217793.2200	2.75	1802
13613919.1000	3217752.5200	2.74	start 1801
13613890.6800	3217790.9300	2.52	1807 t1801
13613925.9900	3217838.1100	2.93	1803
13613940.8800	3217851.6800	2.91	1804
13613912.3200	3217871.9300	3.04	1805

13613899.4600 3217869.5000 3.02 1806

WETLAND AREA "D" COORDINATES

Northing	Easting	Elevation	Description
13613902.9500	3218027.1700	3.31	1025
13613908.8700	3218018.6400	3.22	1024
13613884.1100	3218003.0900	3.24	1022
13613853.0900	3217998.6200	3.65	start1021
13613844.8800	3218012.0900	3.52	1030 t1021
13613828.6000	3218010.4500	3.44	1029
13613830.4900	3218024.3400	3.58	1028
13613871.7000	3218027.0800	3.75	1026
13613853.1100	3218046.7400	3.87	1027
13613914.7800	3218005.9300	3.87	1023

WETLAND AREA "E" COORDINATES

Northing	Easting	Elevation	Description
13613816.2600	3218038.3900	3.74	start 1031
13613794.0100	3218053.0000	3.46	1034 t1031
13613806.3100	3218085.2300	3.45	1033
13613820.9600	3218067.3800	3.42	1032

WETLAND AREA "F" COORDINATES

Incorporated with Wetland Area "A"

WETLAND AREA "G" COORDINATES

Northing	Easting	Elevation	Description
13613219.9100	3217773.1200	3.52	325
13613249.8000	3217756.0100	3.44	326
13613267.3500	3217734.4900	3.55	327
13613279.8000	3217735.8500	3.34	328
13613296.7800	3217707.0900	3.37	329
13613322.4600	3217680.2100	3.21	330
13613331.3400	3217682.9000	3.26	331
13613377.7900	3217646.7800	3.11	332
13613398.1100	3217634.5900	2.95	333 t301
13613403.1600	3217622.1700	2.94	start on pl 301
13613413.1000	3217624.7300	2.92	302
13613413.4400	3217649.2700	2.87	303
13613399.9600	3217668.9700	2.87	304
13613408.4900	3217678.3700	2.84	305
13613424.3900	3217722.7700	2.98	306
13613408.7100	3217756.4600	3.03	309
13613382.1800	3217770.8900	3.08	310
13613370.7500	3217768.0800	3.24	311
13613363.2200	3217779.6700	3.09	312
13613343.1600	3217780.6300	3.21	313
13613321.3400	3217820.3600	3.24	314
13613321.4700	3217842.4200	3.27	315
13613337.3900	3217857.4500	3.27	316
13613301.7000	3217909.1400	3.28	317
13613287.1500	3217889.7400	3.34	318
13613302.5900	3217862.4000	3.32	319
13613283.3300	3217821.4000	3.45	320
13613286.3900	3217812.5400	3.31	321
13613277.5800	3217796.4000	3.37	322
13613254.2400	3217792.2600	3.37	323
13613227.6000	3217791.8100	3.51	324
13613462.5800	3217735.9800	2.92	307
13613426.1700	3217786.3000	3.08	308

WETLAND AREA "H" COORDINATES

Northing	Easting	Elevation	Description
13613305.6200	3218122.5400	3.63	1005 t1001
13613310.6400	3218139.8600	3.77	1004.5
13613328.8800	3218150.8900	3.65	1004
13613352.2900	3218145.6400	4.07	1003
13613349.0500	3218104.9800	3.74	1002
13613323.0500	3218109.9700	3.87	start 1001

WETLAND AREA "I" COORDINATES

Northing	Easting	Elevation	Description
13613669.1500	3218289.3700	3.36	1049
13613670.9700	3218269.9500	3.30	1050 t1041
13613681.7800	3218335.4100	3.27	1048
13613708.3500	3218339.9200	3.32	1047
13613715.1500	3218322.9500	3.36	1046
13613710.4200	3218300.2700	3.12	1045
13613716.5000	3218289.5800	3.19	1044
13613698.9300	3218277.2300	3.21	1043
13613694.6600	3218265.8400	3.39	1042
13613682.0900	3218257.1400	3.38	start 1041

WETLAND AREA "J" COORDINATES

Northing	Easting	Elevation	Description
13613792.5500	3218343.2300	3.30	start 1061
13613807.3900	3218349.7900	3.27	1062
13613815.2800	3218372.0100	3.36	1063
13613805.6600	3218381.9600	3.34	1064
13613791.5300	3218379.4500	3.24	1065
13613778.3400	3218370.3200	3.49	1066
13613777.7100	3218358.1900	3.27	1067 t1061

WETLAND AREA "K" COORDINATES

Northing	Easting	Elevation	Description
13613845.3600	3218431.8700	3.20	1354 t1351
13613864.8300	3218439.9100	3.21	1353
13613869.8600	3218425.9100	3.16	1352
13613854.8500	3218416.9700	3.24	start 1351

WETLAND AREA "L" COORDINATES

Northing	Easting	Elevation	Description
13613598.8500	3218396.6100	3.55	1056
13613610.1100	3218392.4700	3.37	1055
13613607.1600	3218380.1500	3.39	1054
13613605.9600	3218360.9000	3.38	1057
13613608.0600	3218354.3400	3.34	1053
13613599.4100	3218345.7600	3.44	1058 t1051
13613612.4300	3218328.8800	3.40	start 1051
13613618.4400	3218332.4300	3.45	1052

WETLAND AREA "M" COORDINATES

Northing	Easting	Elevation	Description
13613501.0900	3218495.4900	3.37	1080
13613488.2300	3218480.8300	3.73	1081
13613498.7000	3218475.8300	3.77	1082
13613514.5600	3218475.8300	3.74	1083 t1071
13613535.9500	3218485.3400	3.29	1079
13613542.1900	3218503.1200	3.39	1078
13613568.0500	3218519.6100	3.15	1077

13613613.4900	3218501.3600	3.36	1075
13613593.3000	3218481.8600	3.52	1074
13613576.1100	3218485.8300	3.20	1076
13613570.5200	3218478.8100	3.45	1072
13613552.7500	3218458.2900	3.79	start 1071
13613586.8000	3218466.2800	3.63	1073

WETLAND AREA "N" COORDINATES

Northing	Easting	Elevation	Description
13612900.8300	3218573.6000	4.01	1167
13612883.4200	3218583.1600	4.05	1166
13612867.6900	3218570.0500	3.94	1165
13612858.0300	3218604.8000	4.03	1164
13612871.3300	3218615.0200	4.15	1163
13612874.8200	3218635.4200	4.05	1162
13612843.2800	3218643.0400	3.94	1161
13612861.3000	3218650.0200	4.00	1160
13612877.5500	3218669.9500	3.78	1159
13612869.7500	3218711.3400	3.90	1158
13612873.2600	3218738.7100	3.93	1157
13612889.8800	3218769.0100	3.98	1155
13612905.9100	3218742.5100	3.78	1156
13612932.8000	3218779.9100	4.03	1154
13612988.6600	3218765.7300	4.02	1153
13612988.5000	3218731.3700	3.69	1152
13613005.7900	3218699.5000	3.73	1151
13612998.8400	3218682.8400	3.79	1149
13612971.6000	3218687.3200	3.75	1148
13612957.8400	3218675.6800	3.79	1147
13612967.9900	3218641.5600	3.92	1146
13612955.8900	3218632.6800	3.82	1173
13612937.7900	3218629.9800	3.77	1172
13612927.1200	3218610.4600	3.96	1170
13612948.7400	3218607.8200	3.96	1171
13612961.3800	3218611.9600	3.89	1174
13612977.0600	3218597.1300	3.84	1175
13613018.3300	3218586.9200	3.90	1176
13613031.6300	3218586.1800	3.89	1177
13613028.1400	3218597.1800	3.73	1143
13613049.0600	3218617.1900	3.94	1142
13613003.4200	3218612.1900	3.87	1144
13612982.2300	3218634.4100	3.92	1145
13612906.5400	3218633.3800	4.11	1169
13612885.3100	3218640.5500	3.98	1168
13613086.9400	3218773.9800	3.79	1124
13613095.7700	3218773.0200	3.57	1123
13613095.7700	3218750.5200	3.81	1122
13613085.9300	3218734.2000	3.81	1125
13613077.1700	3218731.7100	3.73	1126
13613076.9800	3218696.5700	4.04	1127
13613044.8300	3218685.1500	3.81	1150
13613105.5300	3218708.8700	4.14	1128
13613124.8000	3218705.7800	3.78	1131
13613135.8400	3218700.2600	3.43	1132
13613123.3400	3218726.7800	3.58	1130
13613127.5500	3218733.5500	3.64	1120
13613111.2400	3218737.2300	3.68	1121
13613102.3900	3218727.9600	3.75	1129
13613153.1600	3218757.6900	3.30	1119
13613186.2500	3218733.2900	3.57	1113
13613173.7100	3218758.6500	3.52	1114
13613176.3200	3218777.0100	3.45	1115

13613172.0300	3218785.1800	3.75	1116
13613162.4200	3218775.4200	3.74	1117
13613148.6300	3218775.8400	3.71	1118
13613216.9800	3218714.4800	3.58	1112
13613234.2400	3218704.4100	3.51	1110
13613227.9300	3218698.3500	3.38	1111
13613238.5500	3218688.1900	3.38	1108
13613250.7100	3218697.1400	3.47	1109
13613248.2500	3218660.2800	3.31	1107
13613264.2600	3218657.3800	3.44	1106
13613223.4100	3218516.6800	3.89	1184
13613213.0800	3218506.0700	3.76	1183
13613221.4100	3218491.7400	3.69	1182
13613210.4400	3218485.5000	3.89	1181
13613172.5800	3218509.7400	3.71	1180
13613141.4300	3218512.3800	4.04	1179
13613089.3700	3218549.7600	3.80	1178
13613083.4900	3218570.3300	3.64	1141
13613104.6400	3218550.9000	3.78	1141
13613125.8000	3218548.4200	3.57	1139
13613143.2300	3218551.1800	3.47	1138
13613155.6800	3218568.5100	3.36	1137
13613160.3800	3218590.9900	3.54	1136
13613156.8600	3218629.0900	3.46	1135
13613142.6600	3218639.7100	3.47	1134
13613139.5700	3218661.9600	3.85	1133
13613272.0200	3218611.8900	3.35	1105
13613284.3600	3218583.3000	3.57	1104
13613296.9500	3218571.0100	3.55	1103
13613300.9000	3218553.5100	3.85	1102
13613288.6700	3218530.9100	3.69	1101
13613303.3100	3218507.8900	3.48	1100
13613316.5600	3218509.0800	3.59	1099
13613316.1800	3218482.2700	3.75	1098
13613338.3900	3218476.9700	3.67	1097
13613340.6100	3218464.3500	3.48	1096
13613382.0200	3218441.7400	3.70	1095
13613387.8500	3218431.6200	3.64	1094
13613389.6100	3218411.4200	3.62	1093
13613410.1200	3218417.7800	3.69	1092
13613410.8300	3218383.6100	3.88	start 1091
13613392.2800	3218389.1900	3.59	1210 t1091
13613378.3700	3218399.8700	3.48	1209
13613365.3100	3218393.5000	3.56	1208
13613363.0600	3218382.4300	3.66	1207
13613381.2200	3218343.2300	3.66	1206
13613366.9300	3218347.1500	3.57	1205
13613357.7800	3218355.7900	3.69	1196
13613354.7200	3218341.4600	3.75	1204
13613344.6300	3218342.6900	3.48	1197
13613355.1700	3218324.7400	3.64	1203
13613337.4900	3218316.6400	3.57	1202
13613321.3900	3218338.8500	3.71	1201
13613313.2900	3218339.6100	3.67	1200
13613318.1200	3218351.5000	3.74	1199
13613331.5700	3218362.9100	3.68	1198
13613344.5800	3218372.5100	3.58	1195
13613355.4900	3218410.9100	3.57	11194
13613347.1200	3218421.7900	3.95	1193
13613315.3300	3218438.1700	3.82	1192
13613291.6400	3218478.6900	3.77	1191
13613279.1700	3218479.5700	3.66	1188

13613264.8800	3218462.0000	3.72	1187
13613247.6600	3218474.8500	3.80	1186
13613241.1500	3218505.0300	3.55	1185
13613276.5700	3218498.1900	3.71	1189
13613284.4800	3218501.8200	3.54	1190

WETLAND AREA "O" COORDINATES

Northing	Easting	Elevation	Description
13612623.3500	3218194.6500	3.77	347 end on pl t341
13612633.7900	3218204.2200	3.87	346
13612653.0800	3218212.6100	3.83	345
13612681.7500	3218208.4900	3.95	344
13612689.6200	3218201.0900	3.88	343
13612691.6500	3218181.4500	3.78	342
13612661.4100	3218166.2000	4.07	start 341

WETLAND AREA "P" COORDINATES

Northing	Easting	Elevation	Description
13612670.6500	3218273.2500	3.76	352
13612645.5700	3218272.2700	3.85	start 351
13612626.8800	3218286.6400	3.98	358 t351
13612621.5600	3218312.6200	3.85	357
13612641.5100	3218335.6500	4.08	356
13612659.1900	3218340.0600	4.01	355
13612676.2000	3218322.2500	4.16	354
13612689.0900	3218308.0900	4.15	353

WETLAND AREA "Q" COORDINATES

Northing	Easting	Elevation	Description
13612508.3200	3218278.9100	4.15	365 on pl t361
13612518.1000	3218291.4400	3.92	364
13612531.4700	3218285.6200	4.07	363
13612532.7500	3218275.7300	4.09	362
13612526.0800	3218265.5900	4.18	start 361

WETLAND AREA "R" COORDINATES

Northing	Easting	Elevation	Description
13612674.9000	3218442.4500	4.19	374
13612679.4200	3218429.5700	4.23	375
13612662.4800	3218428.3800	4.14	376
13612666.8400	3218420.7900	3.93	377 t371
13612678.3800	3218416.9600	4.11	start 371
13612692.5400	3218433.8700	4.01	juncus-rubus
13612698.2400	3218433.1000	4.15	372
13612690.3900	3218446.2300	4.04	373

WETLAND AREA "S" COORDINATES

Northing	Easting	Elevation	Description
13612681.5300	3218472.3900	4.12	383
13612676.5200	3218490.1500	4.28	384
13612660.4000	3218496.7300	4.43	385
13612635.9200	3218486.1600	4.29	386
13612632.8400	3218462.1500	4.23	387 t381
13612651.7500	3218454.6700	4.15	start 381
13612667.56	3218455.71	4.14	382

WETLAND AREA "T" COORDINATES

Northing	Easting	Elevation	Description
13612394.0000	3218362.3100	3.89	404 t401
13612409.5000	3218358.0200	3.90	403

13612423.6500	3218346.3400	3.75	402
13612440.2700	3218326.8100	3.77	401 start on pl

WETLAND AREA "U" COORDINATES

Northing	Easting	Elevation	Description
13612430.9500	3218489.9300	3.94	396 t391
13612414.6100	3218514.7800	4.01	395
13612398.2700	3218550.3900	4.13	394
13612452.1600	3218564.4300	3.93	393
13612473.3500	3218505.0500	3.88	392
13612455.8700	3218482.9300	3.84	start 391

WETLAND AREA "V" COORDINATES

Northing	Easting	Elevation	Description
13612590.4600	3218849.7300	4.64	962.7
13612578.7400	3218856.6900	4.51	962.3
13612561.0900	3218852.0600	4.51	962
13612542.5500	3218836.2400	4.53	961
13612518.1100	3218852.1400	4.45	960
13612511.7400	3218828.1600	4.62	959
13612533.2000	3218786.3700	4.45	958
13612500.5800	3218775.0600	4.25	957
13612522.4500	3218752.7000	4.33	956
13612561.9200	3218756.0200	4.15	955
13612589.3500	3218766.7200	4.35	954
13612619.5600	3218751.4100	4.32	953
13612631.0600	3218733.9500	4.39	952
13612647.1600	3218739.0300	4.50	start 951
13612654.1800	3218756.6600	4.52	965 t951
13612622.5500	3218786.6400	4.66	964
13612590.1600	3218820.3800	4.64	963

WETLAND AREA "W" COORDINATES

Northing	Easting	Elevation	Description
13612292.2900	3218675.0400	4.27	425
13612267.6900	3218690.2400	4.22	426
13612238.7500	3218675.0300	3.97	427
13612204.8200	3218676.2300	4.13	428
13612201.9800	3218656.7600	3.99	429
13612208.6900	3218637.7800	3.91	430
13612179.9500	3218621.0700	4.17	431
13612172.7600	3218647.3700	4.09	432
13612177.3900	3218668.2700	4.17	440
13612184.9500	3218670.0100	4.15	433
13612195.6700	3218683.6400	4.33	434
13612185.9200	3218690.5500	4.16	439
13612195.2500	3218695.2700	4.12	435
13612208.8900	3218724.6800	4.11	436
13612193.6000	3218729.1600	4.21	437
13612172.7400	3218721.1700	4.31	438
13612141.2600	3218660.3500	4.31	441
13612110.6400	3218682.5300	4.27	442
13612107.0600	3218639.4800	4.29	443
13612054.3400	3218627.9000	4.28	444
13612107.7900	3218589.0100	3.99	ambrosia/juncus
13612230.8600	3218551.2500	4.10	418
13612235.4600	3218528.9700	4.18	417
13612243.0500	3218507.7600	4.21	416
13612247.4000	3218480.3600	4.06	415
13612257.8800	3218481.0700	4.16	414
13612270.8500	3218476.4900	4.27	413

13612294.8300	3218451.7900	4.11	412
13612287.1800	3218440.2900	4.32	411 start pl
13612320.1200	3218417.0900	4.41	west pl
13612265.1300	3218561.3000	3.99	420
13612279.4200	3218544.6200	4.11	419
13612291.2300	3218572.3400	3.98	421
13612300.6600	3218598.3600	3.80	422
13612291.0000	3218617.8900	4.19	423
13612317.2800	3218639.8400	4.18	424
13612078.5800	3218595.3000	4.20	445
13612115.9900	3218566.9000	4.19	446
13612146.9000	3218603.9900	4.20	447
13612182.0100	3218594.8900	4.17	448
13612184.9700	3218575.6000	4.16	449
13612207.4100	3218545.5500	4.14	450
13612229.0700	3218597.6200	4.13	450.5

WETLAND AREA "X" COORDINATES

Northing	Easting	Elevation	Description
13612337.0500	3218763.1200	4.37	1702
13612304.0300	3218764.6800	4.59	1703
13612305.4300	3218745.9900	4.65	1704
13612320.9200	3218731.4700	4.42	1705
13612344.7900	3218733.1700	4.63	1706 t1701
13612350.8100	3218751.6200	4.53	start 1701

WETLAND AREA "Y" COORDINATES

Northing	Easting	Elevation	Description
13612267.2800	3218739.6700	4.74	start 1691
13612259.9400	3218736.2300	4.38	1694 t1691
13612233.9600	3218746.2700	4.70	1693
13612244.8600	3218758.4400	4.75	1692

WETLAND AREA "Z" COORDINATES

Northing	Easting	Elevation	Description
13612224.1700	3218788.9000	4.57	1684 t1681
13612234.2600	3218787.0400	4.34	1683
13612256.6900	3218773.3100	4.46	1682
13612245.8800	3218770.1700	4.57	start 1681

WETLAND AREA "AA" COORDINATES

Northing	Easting	Elevation	Description
13612404.2400	3218878.1900	4.40	1335 t1331
13612416.4500	3218865.7400	4.58	1331
13612428.9800	3218875.8100	4.64	1332
13612409.7300	3218889.4800	4.52	1333
13612398.1900	3218891.7200	4.45	1334

WETLAND AREA "BB" COORDINATES

Northing	Easting	Elevation	Description
13612384.2200	3218914.3300	4.54	start 1321
13612394.4000	3218926.4600	4.52	1322
13612384.8500	3218933.4300	4.55	1323 t1321

WETLAND AREA "CC" COORDINATES

Northing	Easting	Elevation	Description
13612348.2600	3218939.1900	4.44	1303
13612330.2400	3218926.4100	4.35	1304
13612328.5400	3218910.9500	4.55	1305
13612299.6600	3218917.7300	4.33	1306

13612293.7100	3218942.2400	4.47	1307
13612256.9600	3218955.5100	4.34	1308
13612224.9600	3218932.4600	4.23	1309
13612197.5600	3218890.0400	4.48	1315
13612239.2000	3218881.0400	4.34	1316 t1301
13612313.7400	3218872.0200	4.33	start 1301
13612352.5300	3218888.0900	4.37	1302
13612182.6100	3218973.1200	4.51	1313
13612192.9900	3218965.7100	4.43	1312
13612186.1900	3218958.0300	4.53	1311
13612193.5000	3218942.3800	4.42	1310
13612178.6500	3218953.5600	4.40	1314

WETLAND AREA "DD" COORDINATES

Northing	Easting	Elevation	Description
13612136.2300	3218769.4900	4.59	528
13612141.8200	3218775.5100	4.57	534
13612137.0900	3218810.3300	4.51	527
13612143.8100	3218817.1600	4.54	526
13612143.2600	3218829.8400	4.58	525
13612106.1200	3218850.3900	4.79	524
13612089.7800	3218854.9600	4.63	523
13612066.4500	3218872.0300	4.63	522
13612052.3300	3218858.5800	4.70	521
13612025.1100	3218876.6600	4.63	520
13611995.1400	3218886.1600	4.57	519
13611968.7600	3218928.0500	4.70	518
13611952.0100	3218956.8100	4.32	517
13612072.2500	3218941.8400	4.59	542
13612088.5200	3218921.3300	4.35	541
13612110.4200	3218904.7600	4.47	540
13612148.7400	3218850.0800	4.58	539
13612172.2500	3218841.9800	4.73	538
13612216.6100	3218798.7900	4.85	537
13612186.0000	3218794.2800	4.63	536
13612170.4400	3218800.0200	4.32	535
13612138.8400	3218765.7400	4.55	533
13612143.4100	3218751.8900	4.58	532
13612138.8500	3218746.1700	4.46	531
13612124.4500	3218749.1200	4.37	530
13612125.0400	3218759.7700	4.71	529
13611540.4900	3219193.2700	4.56	637
13611530.4600	3219210.8900	4.74	636
13611507.9600	3219230.3400	4.59	635 on pl
13611528.6900	3219248.3400	4.67	633
13611524.0900	3219251.8500	4.78	634 on pl
13611537.0800	3219253.8300	4.78	632
13611544.3800	3219278.7000	4.62	631
13611573.9200	3219267.5000	4.42	630
13611552.6900	3219235.7000	4.44	629
13611580.5500	3219228.0200	4.26	628
13611597.8000	3219218.1500	4.40	627
13611563.1400	3219187.0100	4.23	638
13611597.1400	3219135.4400	4.35	639
13611636.6100	3219219.3500	4.11	626
13611635.0000	3219266.1300	4.48	625
13611676.5500	3219271.1100	4.79	624
13611695.0500	3219211.8800	4.36	623
13611712.1700	3219226.0600	4.48	622
13611748.4700	3219234.7100	4.63	621
13611758.7700	3219239.4000	4.54	614
13611759.5900	3219224.9500	4.69	620

13611753.6700	3219210.4200	4.74	619
13611758.7000	3219200.5300	4.69	618
13611804.6000	3219190.4530	4.63	617
13611801.5300	3219182.1700	4.56	616
13611813.3700	3219154.7200	4.53	504
13611834.8800	3219171.6400	4.33	505
13611850.2000	3219147.4700	4.25	506 cyn. dac
13611862.8800	3219125.3700	4.50	507
13611864.4400	3219100.0400	4.55	509
13611882.3100	3219105.1900	4.49	510
13611902.0300	3219097.8100	4.59	511
13611882.5400	3219070.0000	4.29	511.5
13611903.7400	3219060.7500	4.49	512
13611906.0600	3219020.1800	4.45	513
13611918.9000	3219018.4100	4.72	515
13611933.6800	3218983.2900	4.25	516
13611896.5500	3219011.7800	4.63	514
13611889.0000	3219001.5500	4.55	497
13611865.3000	3219033.0100	4.53	498
13611864.7600	3219056.0400	4.57	499
13611844.6000	3219064.2600	4.64	500
13611852.6900	3219101.3400	4.41	508
13611828.9400	3219110.9500	4.21	503
13611813.9700	3219107.6300	4.39	502
13611767.6700	3219098.8700	4.44	486
13611752.4400	3219106.7700	4.43	485
13611643.4100	3219114.2400	4.40	640 t481
13611666.5100	3219080.2600	4.69	start 481
13611780.2800	3219007.5400	4.58	493
13611695.8300	3219067.0100	4.65	482
13611706.6700	3219082.0400	4.41	483
13611761.3400	3219070.3000	4.53	487
13611791.0700	3219076.6100	4.39	488
13611813.9400	3219092.1100	4.59	501
13611814.0300	3219068.9100	4.69	489
13611820.5300	3219040.8400	4.51	490
13611807.0600	3219029.7300	4.47	491
13611801.5100	3219013.0700	4.54	492
13611822.2700	3218954.9700	4.78	494
13611840.8500	3218955.7800	4.44	495
13611857.8800	3218986.3700	4.62	496
13611900.0200	3219241.9100	4.69	607
13611894.8000	3219224.4000	4.49	606
13611911.9200	3219218.1500	4.70	605
13611906.7400	3219194.1700	4.58	604
13611967.3100	3219121.9900	4.54	595
13611998.9500	3219095.1300	4.58	591
13612008.4500	3219092.2300	4.63	590
13612029.3700	3219073.8800	4.72	589
13612057.3800	3219069.5100	4.88	584
13612069.8400	3219077.4000	4.71	583
13612076.2700	3219073.4500	4.53	582
13612069.8300	3219051.5900	4.65	585
13612059.9900	3219043.6400	4.53	586
13612047.8100	3219051.1300	4.50	587
13612031.2800	3219052.6200	4.79	588
13611990.6200	3219075.9000	4.60	592
13611972.3000	3219086.4300	4.33	593
13611964.6700	3219111.4700	4.59	594
13611943.6900	3219134.8400	4.63	596
13611907.5700	3219134.5800	4.34	597
13611869.1400	3219167.5000	4.50	598

13611882.8700	3219197.8100	4.48	603
13611867.8800	3219218.5100	4.65	602
13611861.7600	3219218.6500	4.72	601
13611856.0100	3219206.6100	4.80	600
13611838.6500	3219197.3200	4.45	599
13611783.8300	3219232.7400	4.47	615
13611787.4300	3219270.3300	4.24	613 cyn. dac & dist. sp.
13611797.2900	3219320.5800	4.57	612
13611827.7000	3219320.8100	4.75	611
13611841.5700	3219337.8700	4.79	610
13611849.5400	3219307.2500	4.85	609
13611869.6100	3219283.0900	4.83	608
13612067.3200	3219241.0400	4.70	574
13612091.2200	3219224.5800	4.64	575
13612125.8000	3219191.9000	4.69	561
13612135.6500	3219195.9800	4.64	561.5
13612157.6400	3219184.7800	4.59	562
13612139.4500	3219169.2900	4.60	560
13612124.4900	3219165.2100	4.75	557.5
13612109.1400	3219188.3200	4.58	559
13612090.3300	3219194.6400	4.46	576
13612079.6300	3219178.2500	4.62	577
13612096.4400	3219176.1200	4.73	558
13612109.3000	3219156.0500	4.76	557
13612108.0400	3219132.7500	4.54	556
13612100.7100	3219097.5100	4.53	555
13612084.3800	3219111.7200	4.62	581
13612071.5500	3219100.3000	4.66	579.75
13612054.5500	3219107.0000	4.66	579.5
13612068.4300	3219123.2100	4.64	580
13612066.1300	3219149.0600	4.70	579
13612061.9400	3219168.1800	4.81	578
13612085.4600	3219289.4100	4.64	570
13612088.9600	3219284.0900	4.63	569
13612113.9800	3219266.5700	4.75	565
13612128.3900	3219252.3800	4.59	564
13612169.7300	3219216.2400	4.64	563
13612151.2300	3219227.5500	4.50	563.5 t929
13612100.4200	3219258.4100	4.49	566
13612081.1300	3219267.0100	4.52	567
13612074.9400	3219262.3200	4.53	573
13612077.4600	3219276.7600	4.49	568
13612073.7100	3219279.9100	4.51	571
13612058.7700	3219281.2800	4.54	572
13612167.3300	3219057.0100	4.55	549
13612176.2100	3219005.2300	4.73	548
13612138.5100	3218984.0700	4.26	547
13612126.6700	3218993.8100	4.36	546
13612104.2100	3218979.4800	4.49	545
13612087.0200	3218987.7400	4.49	544
13612061.8600	3218984.2800	4.52	543
13612118.6300	3219029.8000	4.41	554
13612149.2800	3219016.5700	4.47	553
13612149.6500	3219035.8300	4.52	552
13612131.5900	3219053.6200	4.41	551
13612142.0100	3219059.3900	4.48	550
13611708.2500	3219113.4600	4.48	484

WETLAND AREA "EE" COORDINATES

Northing	Easting	Elevation	Description
13611993.2700	3218749.9500	4.51	673 t651
13612003.5600	3218728.6300	4.55	start 651

13612013.5600	3218747.6300	3.91	poly hud
13612022.4600	3218741.8500	4.49	652
13612044.1500	3218773.0900	4.85	653
13612029.0500	3218788.1400	4.41	654
13612017.0500	3218809.9600	4.53	655
13611994.7200	3218814.8000	4.53	656
13611989.6400	3218809.0300	4.64	657
13611992.0400	3218795.2600	4.42	658
13611995.6300	3218787.8300	4.51	659
13612012.4100	3218794.0600	4.44	660
13612024.9800	3218779.7600	4.32	670
13612011.6400	3218765.1700	4.67	671
13611995.4700	3218772.8000	4.57	672

WETLAND AREA "FF" COORDINATES

Northing	Easting	Elevation	Description
13611726.0300	3218887.3600	4.70	454
13611742.2600	3218870.2600	4.77	453
13611751.0200	3218849.6100	4.93	452
13611742.9500	3218843.8900	4.84	start 451
13611727.2300	3218852.4700	4.85	455 t451

WETLAND AREA "GG" COORDINATES

Northing	Easting	Elevation	Description
13611660.1600	3218898.8300	4.81	462
13611658.4900	3218920.4500	4.60	463
13611671.0200	3218930.8400	4.81	464
13611648.8400	3218934.4400	4.62	465
13611645.9800	3218911.6000	4.84	466
13611640.8900	3218909.5800	4.67	467 end on pl t461
13611653.1600	3218897.7300	4.79	461 start on pl

WETLAND AREA "HH" COORDINATES

Northing	Easting	Elevation	Description
13611406.7700	3219088.5800	4.52	start 471
13611408.5800	3219087.5000	4.69	472 on pl
13611425.9700	3219088.0800	4.70	473
13611433.5900	3219114.3600	4.45	474
13611450.8000	3219122.5000	4.48	475
13611456.6200	3219127.1900	4.46	475.95
13611440.6000	3219137.2400	4.74	476 end on pl t471
13611470.3600	3219139.0600	4.48	475.9
13611477.9200	3219136.1200	4.36	475.1
13611507.9500	3219131.4500	4.41	475.8
13611540.5400	3219115.8900	4.51	475.6
13611566.0500	3219098.6400	4.69	475.5
13611551.0600	3219065.8200	4.55	475.4
13611527.3400	3219095.9500	4.41	475.3
13611529.0600	3219101.4800	4.32	475.65
13611504.5400	3219112.7000	4.39	475.7
13611484.3800	3219110.3600	4.54	472
13611493.7500	3219165.2000	4.51	475.85

WETLAND AREA "II" COORDINATES

Northing	Easting	Elevation	Description
13611984.6300	3219252.2500	4.66	694
13611990.3500	3219258.9400	4.67	693
13612036.8000	3219252.1400	4.58	688
13612040.1300	3219259.4500	4.72	689
13612048.6700	3219205.6100	4.66	686
13612035.6700	3219228.5800	4.70	687

13612022.4600	3219265.8100	4.67	690
13612008.8900	3219284.5400	4.59	691
13611990.3000	3219273.9100	4.65	692
13611995.3300	3219240.0100	4.53	695 t681
13612014.9700	3219220.0800	4.66	683
13612029.9600	3219218.9400	4.66	684
13612043.4400	3219201.0600	4.70	685
13612008.2900	3219199.5700	4.76	682
13612000.2800	3219200.2700	4.74	start 681

WETLAND AREA "JJ" COORDINATES

Northing	Easting	Elevation	Description
13611976.7600	3219386.0900	4.64	start 701
13611958.9900	3219389.1200	4.65	707 t701
13611970.2200	3219400.7300	4.64	706
13611991.2900	3219403.5100	4.57	705
13612014.5700	3219400.5300	4.40	704
13612012.5500	3219389.0300	4.68	703
13611993.1400	3219393.6200	4.66	702

WETLAND AREA "KK" COORDINATES

Northing	Easting	Elevation	Description
13612339.5400	3219211.9100	4.50	1615 t1611
13612336.5200	3219235.7800	4.48	1614
13612354.7400	3219235.4600	4.49	1613
13612365.9400	3219226.6200	4.45	1612
13612363.7500	3219211.0700	4.67	start 1611

WETLAND AREA "LL" COORDINATES

Northing	Easting	Elevation	Description
13612109.6700	3219340.1600	4.84	918
13612114.2600	3219355.4200	4.82	917
13612127.0300	3219346.9600	4.65	916
13612133.1500	3219356.7300	4.76	914
13612135.8800	3219347.1700	4.62	910.8
13612141.7800	3219345.1500	4.62	911
13612141.7800	3219354.0800	4.79	913
13612145.4000	3219347.7200	4.77	912
13612146.7200	3219335.3200	4.61	910
13612161.1700	3219326.4200	4.60	909
13612156.4700	3219319.8300	4.46	922
13612161.4200	3219321.1200	4.48	908
13612166.4100	3219308.0400	4.43	923
13612169.6700	3219309.1000	4.53	907
13612202.0900	3219289.5200	4.59	906
13612197.9200	3219258.3300	4.57	905
13612184.9400	3219248.6300	4.65	930
13612178.8300	3219265.7100	4.52	927
13612170.5000	3219278.2200	4.45	926
13612156.0000	3219278.1000	4.66	925
13612153.2700	3219291.7700	4.38	924
13612142.7500	3219309.2600	4.59	921
13612138.0300	3219327.9000	4.47	910.2
13612133.8200	3219327.5300	4.58	920
13612126.4500	3219333.2300	4.65	919
13612128.6100	3219334.8400	4.55	910.4
13612164.7800	3219251.4800	4.36	928
13612166.2600	3219232.1300	4.23	929.5 t563
13612159.9100	3219227.3200	4.47	929
13612272.7900	3219173.8200	4.27	935
13612254.8800	3219178.5900	4.52	934

13612243.6500	3219177.3900	4.59	933
13612238.5200	3219192.2700	4.56	932
13612242.2200	3219200.8200	4.51	902
13612354.1400	3219142.8800	4.52	939
13612360.9800	3219152.9700	4.70	940
13612371.2000	3219153.6800	4.59	941
13612394.6100	3219145.2100	4.54	942
13612411.5700	3219143.3500	4.47	943
13612420.7600	3219118.1700	4.23	944
13612410.1700	3219110.3500	4.35	945
13612417.8200	3219102.4600	4.35	851
13612428.9900	3219109.3700	4.53	854
13612433.1700	3219103.3000	4.61	853
13612441.7400	3219100.6200	4.52	852
13612443.0900	3219089.4200	4.51	start 851
13612463.9900	3219094.8600	4.37	858
13612487.1400	3219088.2400	4.40	862
13612479.7400	3219077.2500	4.34	859
13612478.1700	3219062.9600	4.40	860
13612489.1900	3219069.7300	4.39	861
13612526.5900	3219056.2400	4.35	864
13612545.5100	3219071.8700	4.51	865
13612553.3900	3219084.4600	4.50	866
13612532.4400	3219083.0900	4.43	867
13612525.0900	3219091.1700	4.39	868
13612503.2100	3219091.7400	4.40	863
13612449.5800	3219122.1500	4.29	857
13612445.3000	3219111.4400	4.43	856
13612434.7700	3219116.8600	4.29	855
13612395.3300	3219147.8000	4.57	887
13612371.8000	3219156.1500	4.70	888
13612358.9400	3219157.5000	4.58	889
13612357.9500	3219169.1500	4.55	890
13612365.9400	3219175.1700	4.45	891
13612358.7200	3219180.5000	4.53	892
13612343.7000	3219179.9100	4.76	893
13612310.6000	3219196.0000	4.55	896
13612290.4700	3219204.3900	4.54	897
13612287.8400	3219193.8800	4.53	898
13612282.4100	3219229.3000	4.32	896.3
13612276.3700	3219227.6800	4.47	896.7
13612249.7500	3219237.7900	4.76	903
13612219.1200	3219227.4000	4.46	904
13612206.9800	3219202.7000	4.56	931
13612258.1000	3219189.4700	4.61	901
13612274.4500	3219181.4900	4.51	900
13612293.6900	3219184.4400	4.52	899
13612309.6500	3219174.8200	4.49	936
13612326.1900	3219172.4300	4.82	895
13612331.9800	3219169.2300	4.61	894
13612329.1700	3219159.4900	4.58	937
13612331.8400	3219146.9200	4.63	938
13612418.7100	3219166.3500	4.49	884
13612420.7200	3219157.3800	4.40	885
13612415.1500	3219149.6100	4.52	886
13612437.1400	3219167.3900	4.43	883
13612456.0700	3219177.3800	4.36	881
13612443.0900	3219182.7300	4.42	882
13612449.3100	3219159.5200	4.37	880
13612462.2900	3219154.4200	4.42	879
13612516.0600	3219124.8300	4.28	869
13612556.3700	3219122.0300	4.25	870

13612577.2900	3219133.5900	4.37	871
13612570.2200	3219149.6800	4.37	872
13612570.4400	3219177.8300	4.26	873
13612549.1900	3219184.7800	4.23	874
13612546.0300	3219169.4600	4.28	875
13612519.7000	3219176.6900	4.32	876
13612474.7800	3219155.1800	4.27	878
13612478.8700	3219166.1000	4.27	877

WETLAND AREA "MM" COORDINATES

Northing	Easting	Elevation	Description
13612412.1600	3219202.4000	4.47	1487 t1461
13612428.7800	3219212.9700	4.41	1486
13612437.7000	3219227.2400	4.40	1485
13612442.7900	3219227.2400	4.40	1471
13612431.4500	3219211.2000	4.45	1470
13612438.1100	3219206.3100	4.43	1469
13612433.7800	3219200.6100	4.43	1463
13612427.8200	3219192.9900	4.45	1462
13612418.7900	3219194.3200	4.38	start 1461
13612462.1600	3219192.6300	4.55	1465
13612473.0400	3219200.4800	4.50	1466
13612474.9200	3219214.7900	4.52	1473
13612486.7100	3219244.4900	4.38	1474
13612470.8300	3219262.9800	4.46	1482
13612464.1200	3219255.3600	4.52	1483
13612468.7700	3219244.4900	4.40	1472
13612464.3500	3219210.4800	4.41	1467
13612457.3300	3219202.4600	4.44	1468
13612448.1800	3219192.0700	4.47	1464
13612504.2900	3219262.1400	4.35	1475
13612458.8500	3219278.8500	4.26	1481
13612435.8200	3219241.7900	4.35	1484
13612480.4400	3219297.6700	4.37	1480
13612495.9200	3219320.4700	4.37	1479
13612519.5600	3219318.4100	4.33	1478
13612508.2800	3219300.7900	4.49	1477
13612497.6000	3219288.6300	4.34	1476

WETLAND AREA "NN" COORDINATES

Northing	Easting	Elevation	Description
13612353.1600	3219269.7200	4.56	1517
13612360.9300	3219288.2600	4.55	1516
13612376.5600	3219311.7200	4.56	1513
13612394.8500	3219303.2200	4.34	1502
13612408.4700	3219307.9800	4.53	1503
13612399.5800	3219285.9300	4.37	start 1501
13612385.7400	3219287.9800	4.55	1514
13612384.1400	3219276.8200	4.57	1515
13612391.6700	3219276.3500	4.44	1519
13612369.5100	3219258.9000	4.50	1518
13612429.8000	3219256.0600	4.35	1521 t1501
13612424.2600	3219250.3900	4.35	1520
13612358.1200	3219384.7600	4.47	1509
13612380.9400	3219345.9300	4.47	1510
13612377.8800	3219334.6500	4.52	1511
13612359.7900	3219329.0500	4.35	1512
13612411.4600	3219330.3400	4.47	1504
13612423.2200	3219350.1000	4.48	1505
13612402.2900	3219364.0700	4.53	1506
13612371.4600	3219395.2000	4.60	1508

13612390.9200 3219386.9200 4.42 1507

WETLAND AREA "OO" COORDINATES

Northing	Easting	Elevation	Description
13612572.3900	3219284.2600	4.35	1356
13612589.5700	3219277.9800	4.20	1355
13612601.7300	3219290.2800	4.36	1354
13612613.6000	3219274.0600	4.14	1353
13612612.2000	3219250.5600	4.28	1359
13612589.4300	3219253.8100	4.36	1358
13612560.8400	3219273.5800	4.42	1357
13612617.0000	3219244.5100	4.53	1360
13612620.0900	3219241.3600	4.42	1352
13612643.4100	3219219.6700	4.31	1369
13612660.3600	3219228.2100	4.37	1357
13612661.2800	3219241.3700	4.34	1350
13612672.6200	3219231.3500	4.28	1377
13612691.9800	3219230.5600	4.20	1372
13612698.1700	3219232.5100	4.07	1349
13612711.8800	3219235.0700	4.14	1348
13612718.2100	3219248.9800	4.05	1347
13612721.6200	3219251.5400	4.17	1344
13612713.1400	3219263.3000	4.07	1346
13612716.9000	3219268.4400	4.09	1345
13612725.1500	3219237.6400	4.24	1343
13612720.0100	3219223.6300	4.16	1342
13612731.7500	3219206.8700	4.17	start 1341
13612719.3800	3219201.6500	4.32	1373 t1341
13612662.4400	3219212.7200	4.41	1370
13612644.0400	3219196.0900	4.38	1365
13612647.2500	3219181.9100	4.37	1364
13612628.2500	3219178.5000	4.27	1363
13612636.5700	3219197.8300	4.43	1366
13612629.2500	3219204.2200	4.37	1367
13612624.2700	3219205.5800	4.25	1362
13612631.9000	3219213.5900	4.42	1368
13612604.0500	3219222.6000	4.60	1361

WETLAND AREA "PP" COORDINATES

Northing	Easting	Elevation	Description
13612525.4700	3219387.6400	4.35	1494
13612542.8700	3219372.4300	4.32	1495 t1491
13612545.8700	3219382.3200	4.18	start 1491
13612539.8700	3219403.6000	4.36	1492
13612530.6100	3219405.8000	4.42	1493

WETLAND AREA "QQ" COORDINATES

Northing	Easting	Elevation	Description
13612419.1900	3219378.1000	4.63	868
13612435.1300	3219392.2500	4.34	867
13612477.1300	3219387.6300	4.32	869 TIE 861
13612494.0800	3219371.3000	4.59	start 861
13612497.7600	3219383.2100	4.43	862
13612490.3400	3219393.9300	4.41	863
13612478.8900	3219406.5200	4.44	864
13612449.9000	3219406.2600	4.48	865
13612433.1300	3219411.1600	4.48	866

WETLAND AREA "RR" COORDINATES

Northing	Easting	Elevation	Description
13612432.4700	3219436.0500	4.26	846 t841

13612448.0800	3219446.0700	4.44	start 841
13612435.2600	3219465.8300	4.40	842
13612412.9600	3219443.1900	4.32	845
13612397.4300	3219461.1900	4.51	844
13612402.8300	3219468.2400	4.49	843

WETLAND AREA "SS" COORDINATES

Northing	Easting	Elevation	Description
13612359.5800	3219477.6500	4.51	start 821
13612356.2500	3219491.1100	4.32	822
13612349.3500	3219488.5900	4.50	823
13612348.5300	3219480.5200	4.64	824 t821

WETLAND AREA "TT" COORDINATES

Northing	Easting	Elevation	Description
13612330.5500	3219567.3000	4.06	820 t811
13612319.9200	3219582.7900	4.08	819
13612302.8500	3219613.3000	4.28	818
13612298.5900	3219625.3000	4.02	817
13612303.3900	3219642.5400	4.26	816
13612329.2300	3219634.0800	3.98	815
13612344.2600	3219609.5200	4.21	814
13612353.6800	3219603.9100	4.19	813
13612364.7100	3219569.4700	4.04	812
13612358.1100	3219559.0900	4.23	start 811

WETLAND AREA "UU" COORDINATES

Northing	Easting	Elevation	Description
13612117.4100	3219774.0200	4.10	806.75
13612129.5600	3219761.0900	4.09	806.5
13612110.4200	3219727.8300	4.28	807.75
13612097.6800	3219734.3300	4.29	807.5
13612104.2600	3219746.8700	4.15	807.25
13612094.0400	3219757.8900	4.26	807
13612104.2700	3219709.4300	4.24	808
13612134.1400	3219697.6100	4.11	808.25
13612145.7600	3219702.9500	4.01	805.5
13612141.4200	3219687.4600	4.13	808.5
13612130.0700	3219675.9300	4.09	808.75
13612146.9800	3219676.6200	4.06	809
13612170.3700	3219653.7300	4.09	809.25
13612170.2700	3219622.0800	4.28	809.25
13612174.3800	3219608.3700	4.27	809.75
13612189.9800	3219595.3400	4.28	810 t801
13612214.0800	3219605.2800	4.17	start 801
13612235.8600	3219615.7900	4.18	802
13612248.9700	3219628.2400	4.18	802.3
13612236.4300	3219642.3500	4.16	802.7
13612232.9500	3219679.3100	4.06	803
13612220.1600	3219695.2600	4.04	804
13612178.2200	3219703.1500	4.12	coe 805 t806.5
13612212.9500	3219729.5500	4.10	coe 804
13612206.3000	3219701.1500	4.28	coe dp1
13612242.0900	3219687.8200	4.10	coe 803.5 t 803

WETLAND AREA "VV" COORDINATES

Northing	Easting	Elevation	Description
13612021.2600	3219674.8500	4.29	725
13612043.5500	3219685.4100	4.35	724
13612041.1100	3219672.7500	4.18	723

13612042.4200	3219649.8300	4.17	722
13612040.7000	3219647.2500	4.32	726 t721
13612051.6500	3219637.4000	4.27	start721

WETLAND AREA "WW" COORDINATES

Northing	Easting	Elevation	Description
13612004.1500	3219902.9500	4.22	734 end on pl
13612011.7300	3219886.1200	4.21	733.5
13612008.2900	3219871.9000	4.23	733
13611992.8800	3219876.2000	4.13	732
13611983.3400	3219873.9900	4.32	start 731

WETLAND AREA "XX" COORDINATES

Northing	Easting	Elevation	Description
13612149.0500	3220100.9500	4.21	781 end on pl t241
13612155.6900	3220082.2000	4.27	780
13612161.5700	3220080.1500	4.17	779
13612178.1100	3220094.5800	4.25	778
13612254.3000	3220041.4200	4.17	777
13612302.9100	3220005.6400	4.27	776
13612307.8200	3219989.3100	4.17	775.5
13612259.4600	3219981.5700	3.87	775
13612246.1300	3219968.8300	3.97	774
13612270.2500	3219939.5400	4.16	773
13612241.8000	3219915.4600	4.03	772
13612247.5500	3219898.3100	4.12	771
13612231.2400	3219861.0600	4.06	770
13612235.5300	3219841.5500	4.34	769
13612254.9600	3219831.0200	4.08	768
13612271.6000	3219805.8400	4.08	767
13612265.4000	3219801.6500	4.08	766
13612227.8100	3219830.9500	4.15	765
13612222.4000	3219825.8400	4.12	764
13612187.4100	3219854.2400	4.11	763
13612172.1600	3219893.2500	4.19	759
13612191.4000	3219910.8700	3.96	758
13612189.1600	3219944.0500	3.82	757
13612154.6500	3219958.4200	3.85	756
13612102.7500	3220016.5000	4.04	742
13612090.4400	3220021.0900	4.58	start 741 on pl
13612096.3400	3219991.5900	4.17	743
13612105.6800	3219988.1200	4.21	744-750
13612114.6800	3219952.7900	4.05	750
13612115.6900	3219947.7400	3.80	755
13612116.2800	3219924.0600	4.01	760
13612101.3000	3219928.0000	4.23	761
13612085.9300	3219940.1600	4.09	754
13612054.9500	3219933.7000	4.34	753
13612053.3100	3219937.7600	4.07	751
13612050.0300	3219935.6400	4.46	752
13612125.2100	3219870.0000	4.34	762

WETLAND AREA "YY" COORDINATES

Northing	Easting	Elevation	Description
13612327.6900	3219955.2100	4.26	794
13612332.7200	3219945.3600	3.93	793
13612334.1900	3219934.0100	3.90	792
13612323.9900	3219934.1300	4.07	start 791
13612315.3600	3219949.4400	3.99	795 t791

WETLAND AREA "ZZ" COORDINATES

Northing	Easting	Elevation	Description
13612373.4600	3219819.9200	4.00	1761
13612380.9200	3219828.6500	3.90	1762
13612374.8000	3219837.5000	4.03	1763
13612367.6200	3219838.3600	4.20	1764
13612355.5900	3219831.7700	4.16	1765
13612357.1000	3219824.3600	4.19	1766 tie1761

WETLAND AREA "AAA" COORDINATES

Northing	Easting	Elevation	Description
13612481.9800	3219810.6200	4.06	start 1751
13612495.7600	3219826.4500	4.19	1752
13612492.8600	3219842.7800	3.98	1753
13612473.9000	3219845.1100	3.76	1754
13612444.4000	3219844.0800	4.05	1756
13612447.3200	3219835.2700	4.01	1757
13612461.3400	3219817.1000	4.20	1758 tie 1751

WETLAND AREA "BBB" COORDINATES

Northing	Easting	Elevation	Description
13612527.3660	3219741.4540	0.00	3101
13612532.9690	3219751.7760	0.00	3102
13612531.7300	3219758.0210	0.00	3103
13612527.3060	3219760.0510	0.00	3104
13612521.9040	3219754.3170	0.00	3105
13612526.9610	3219753.4520	0.00	dp east of 1427&1428

WETLAND AREA "CCC" COORDINATES

Northing	Easting	Elevation	Description
13612280.6400	3219701.0900	4.27	1438
13612293.5400	3219692.4700	4.16	1439
13612300.8000	3219672.7800	4.33	1440
13612319.3800	3219681.3000	3.98	1441
13612332.1100	3219685.9000	4.00	1435
13612319.6400	3219708.0600	4.24	1436
13612299.2900	3219708.3800	4.16	1437
13612344.4800	3219674.5400	3.78	1434
13612336.9100	3219660.6700	4.16	1442
13612354.2300	3219676.9600	4.23	1433
13612356.0500	3219674.4500	4.21	1443
13612371.3000	3219691.8200	3.97	1432
13612384.2400	3219670.5400	4.15	1444
13612389.2200	3219664.0800	3.93	1445
13612411.7000	3219671.9700	3.51	1446
13612433.3700	3219704.0100	3.85	1431
13612455.0700	3219706.0100	3.89	1430
13612474.1600	3219703.8300	3.66	1429
13612518.2600	3219722.0200	3.72	1428
13612532.8400	3219716.6000	3.61	1427
13612561.5500	3219715.0600	3.81	1426
13612592.0100	3219695.1700	3.65	1425
13612607.2400	3219693.1000	3.69	1424
13612647.6600	3219665.2400	3.78	1423
13612679.9300	3219629.3200	3.78	1422
13612672.5000	3219619.2600	3.86	start 1421
13612628.4900	3219641.9000	3.60	1450 t1421
13612592.0600	3219666.0300	3.42	1449
13612525.8400	3219672.8200	3.75	1448
13612492.0800	3219674.5400	3.82	1447

WETLAND AREA "DDD" COORDINATES

Northing	Easting	Elevation	Description
13612508.5600	3219622.9200	4.07	start 1601
13612505.2200	3219646.1000	4.13	1602
13612452.6000	3219642.7100	4.16	1603
13612434.6800	3219632.8200	4.04	1604
13612438.4500	3219628.9500	3.95	1605
13612477.3800	3219628.8900	3.82	1606 t1601

WETLAND AREA "EEE" COORDINATES

Northing	Easting	Elevation	Description
13612484.6500	3219588.0600	4.23	837
13612485.6200	3219580.5500	4.20	838 t831
13612495.9200	3219568.0900	4.27	start 831
13612504.6300	3219568.7800	4.38	832
13612510.2700	3219576.4600	3.97	833
13612508.3800	3219587.1200	4.02	834
13612502.5100	3219592.3400	3.95	835
13612488.2600	3219592.9600	4.26	836

WETLAND AREA "FFF" COORDINATES

Northing	Easting	Elevation	Description
13613945.9420	3218913.3990	-0.55	start 1401
13613982.6120	3218877.7990	-0.53	1402
13614003.1910	3218845.8200	-0.46	1403
13614036.0450	3218842.4340	-0.50	1404
13614072.2720	3218814.1380	-0.17	1405
13614125.3180	3218763.9740	-0.40	1406
13614134.6060	3218714.1130	-0.57	1407
13612602.2100	3219544.0500	-0.41	1410
13612581.8800	3219535.1500	-0.29	1411
13614171.9500	3218663.4560	-0.64	1412
13614185.5260	3218649.3690	-0.65	1413
13614198.3350	3218644.5920	-0.48	1414
13612610.0700	3219457.8900	-0.60	1415
13612633.5700	3219432.2600	-0.67	1416 tie 1401
13614352.2910	3218529.5690	-0.52	1409
13612647.9600	3219542.2100	-0.52	1408

WETLAND AREA "GGG" COORDINATES

Northing	Easting	Elevation	Description
13612789.4700	3219654.7000	2.63	start 2001
13612774.3400	3219645.1200	3.00	2002
13612794.9200	3219634.0500	2.84	2003
13612811.8900	3219636.3600	2.36	2003
13612813.7400	3219621.4800	2.76	2005
13612828.7200	3219614.7100	2.65	2006
13612829.2200	3219604.5500	2.55	2007
13612841.2100	3219597.5300	2.52	2008
13612873.2200	3219583.7600	2.05	2009
13612888.6600	3219556.9300	1.65	2010.5
13612899.0000	3219573.7600	1.52	2010
13612907.2000	3219568.2000	1.71	2011 end on pl

WETLAND AREA "HHH" COORDINATES

Northing	Easting	Elevation	Description
13612948.3700	3219538.0300	2.02	start 2021 on pl
13612933.4900	3219484.0600	2.58	2022
13612951.3500	3219493.7900	2.69	2023
13612985.0300	3219510.8700	2.05	2024 end on pl

WETLAND AREA "III" COORDINATES

Northing	Easting	Elevation	Description
13612876.3100	3219320.6400	3.57	start 1531
13612865.0400	3219372.2000	3.45	1532
13612852.5600	3219368.5300	3.48	1533
13612862.8200	3219327.0100	3.55	1535
13612848.8800	3219321.3700	3.59	1536
13612856.9800	3219316.2600	3.58	1537 tie 1531
13612867.7900	3219341.0200	3.46	1531.5
13612862.1400	3219338.0400	3.52	1534

WETLAND AREA "JJJ" COORDINATES

Northing	Easting	Elevation	Description
13613769.0000	3218633.8700	2.80	107
13613765.3900	3218666.1800	2.92	108
13613714.4200	3218717.0200	2.89	109
13613704.4500	3218763.4300	2.76	110
13613634.8900	3218852.4800	2.59	111
13613598.2700	3218864.8400	2.84	112
13613518.1100	3218937.9600	2.91	114
13613489.2600	3218935.1800	3.02	115
13613474.9500	3218973.1300	2.91	116
13613480.4800	3219004.0000	2.63	116.5
13613457.2600	3219017.0200	2.64	117
13613475.8600	3219037.8500	2.18	118
13613455.6100	3219051.0900	2.52	119
13613428.2900	3219050.3700	2.76	120
13613437.5800	3219074.2200	2.32	121
13613355.3900	3219126.0600	2.41	122
13613275.4200	3219121.5400	2.60	123
13613249.5000	3219099.7800	2.54	124
13613239.4800	3219048.9900	2.90	125
13613245.4200	3219002.8800	2.96	126
13613252.6900	3218977.1600	3.23	126.1
13613259.3000	3218932.3500	3.23	126.2
13613233.0400	3218958.9900	3.10	126.3
13613217.4500	3218955.6200	3.17	126.4
13613208.5800	3218979.9400	3.19	126.5
13613220.3500	3218973.4500	3.13	126.7
13613237.0300	3218979.3600	2.93	126.9
13613229.3600	3219000.2900	3.04	127
13613217.9100	3219001.2700	3.24	128
13613216.8900	3219049.9600	2.74	129
13613214.0900	3219070.9000	2.67	130
13613215.9900	3219109.6300	2.88	131
13613223.8100	3219133.5800	2.53	132
13613201.8500	3219140.0200	2.45	133
13613163.9700	3219115.3100	2.89	135
13613153.9700	3219140.3400	2.99	137
13613153.7600	3219150.9400	2.64	138
13613118.0400	3219148.4000	2.84	139
13613112.0700	3219175.5200	2.77	140
13613150.0400	3219181.9400	2.88	141
13613168.8000	3219168.3100	2.95	142
13613195.4700	3219177.6000	2.52	143
13613171.4400	3219207.6300	2.60	144
13613155.4300	3219228.9800	2.82	145
13613137.0000	3219249.7100	2.65	146
13613106.7100	3219246.0900	2.82	147
13613068.9000	3219223.1600	3.00	148
13613061.9800	3219236.4200	3.15	149
13613031.3100	3219254.3500	3.06	150

13613030.3900	3219295.6000	2.96	151
13613049.6000	3219274.7500	2.97	152
13613084.3100	3219273.7500	2.88	153
13613108.3800	3219285.8600	2.65	154
13613106.2100	3219315.2600	2.44	155
13613084.8700	3219312.1400	2.53	156
13613075.3500	3219321.4600	2.52	157
13613096.6800	3219356.9700	2.19	158
13613062.8500	3219362.2400	2.60	159
13613069.4800	3219381.4800	2.44	160
13613053.2000	3219387.7800	2.44	161
13613076.3800	3219402.1700	2.02	162
13613072.8900	3219411.8600	2.18	163
13613045.5600	3219403.4100	2.47	164
13613040.5400	3219410.8800	2.57	165
13613059.3600	3219425.0500	2.19	166
13613048.0300	3219430.3500	2.32	167
13613020.8800	3219429.5500	2.79	168
13613016.3400	3219435.5600	2.80	169
13613005.5400	3219456.7400	2.78	170
13612987.3100	3219461.6400	2.82	171
13612981.8400	3219476.2300	2.86	172
13612990.5400	3219489.1400	2.93	173
13613042.8700	3219466.5300	2.44	174
13613785.1300	3218613.5000	2.98	106
13613808.3200	3218587.6200	3.15	105
13613819.6900	3218566.3400	2.94	104.1
13613804.0100	3218562.4600	3.22	104.2
13613788.8400	3218561.8000	3.09	104.85
13613772.9400	3218566.7900	3.34	104.7
13613764.8500	3218557.5400	3.44	104.6
13613756.4800	3218530.7300	3.47	104.5
13613764.0500	3218521.8500	3.40	104.4
13613791.5600	3218534.0000	3.48	104.3
13613841.5300	3218528.0300	3.07	104
13613852.6400	3218529.9300	2.96	103
13613891.9200	3218495.8600	2.98	101
13613884.2500	3218506.8500	2.87	102
13613908.2300	3218536.6000	2.82	99
13613891.9000	3218516.2300	2.76	98
13613864.4900	3218528.5800	2.58	97
13613844.0000	3218558.7000	2.73	96
13613823.2600	3218595.7600	2.77	95
13613818.0300	3218649.7800	2.56	94
13613854.5100	3218626.5300	2.36	93
13613869.7400	3218622.5300	2.46	92.5
13613889.9600	3218580.6000	2.58	92
13613917.4100	3218571.9300	2.66	91.5
13613974.4900	3218530.0500	2.61	91
13614090.6900	3218450.3700	2.23	87
13614099.0200	3218433.2300	2.44	86
13614111.3900	3218437.0100	2.53	85
13614122.3800	3218423.5000	2.27	84
13614111.7500	3218407.1900	2.51	83
13614112.2300	3218394.9400	2.58	82
13614134.5700	3218383.0400	2.54	81
13614141.3700	3218392.8200	2.37	80
13614142.5800	3218410.5600	2.53	79
13614182.4100	3218364.1500	2.48	78.5
13614261.5200	3218275.0300	2.79	77
13614205.9100	3218321.5000	2.63	78
13614294.7800	3218252.9200	2.80	76

13614318.2700	3218266.9200	1.26	75ab
13613047.8400	3219465.3500	2.45	174.1 end on pl
13613169.9500	3219137.5000	2.70	134
13614312.7600	3218267.9100	2.12	75.6
13614306.7000	3218260.2700	1.97	75.8 tie to 76
13613963.4300	3218484.1000	2.59	100
13614037.6200	3218472.2500	2.47	89
13613580.2200	3218903.3800	2.60	113

WETLAND AREA "LLL" COORDINATES

Northing	Easting	Elevation	Description
13613793.7600	3218221.8700	3.27	coe 26 t21
13613790.4900	3218251.1900	3.32	coe 25
13613806.5600	3218279.5100	3.37	coe 24
13613832.3600	3218272.7200	3.32	coe 23
13613830.1900	3218252.7700	3.33	coe 22
13613817.0200	3218215.5000	3.25	coe 21 start
13613808.1100	3218244.7800	3.33	coe dp3

WETLAND AREA "MMM" COORDINATES

Northing	Easting	Elevation	Description
13613772.2500	3218212.6600	3.23	coe dp4
13613770.2000	3218197.5200	3.29	coe 31 start
13613759.5400	3218204.5600	3.33	coe 34 t31
13613769.9500	3218227.3800	3.29	coe 33
13613781.4300	3218216.7000	3.15	coe 32

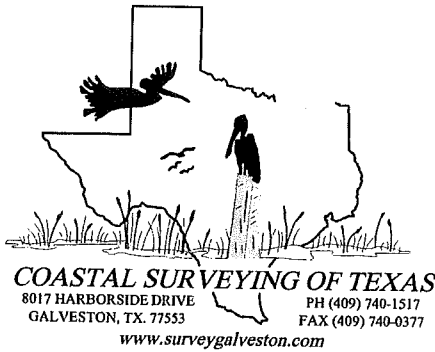

"SERVING GALVESTON COUNTY OVER 50 YEARS"

REVISED MASTER COORDINATE LIST FOR 07-0218-WETLAND ADDENDUM "A"

TRANSECT "A" COORDINATES

Northing	Easting	Elevation	Description
13611475.31		3218948.2	5.62 a-1
13611435.74		3218957.76	5.27 a-2
13611386.95		3218991.43	6.71 a-3
13611334.02		3219036.83	4.35 a-4
13611289.45		3219071.56	5.58 a-5
13611267.92		3219090.35	4.86 a-6
13611234.32		3219099.65	4.85 a-7
13611252.98		3219106.49	6.24 a-7b
13611182.21		3219151.39	5.37 a-8
13610879.65		3219366.42	5.79 a-9
13610729.26		3219480.7	5.84 a-10
13610547.93		3219618.11	5.74 a-11
13610296.78		3219802.09	7.29 a-12

TRANSECT "B" COORDINATES

Northing	Easting	Elevation	Description
13611517.58		3218955.75	4.76 b-1
13611419.15		3219021.07	5.04 b-2
13611383.63		3219043.58	6.32 b-3
13611351.82		3219065.18	4.49 b-4
13611236.9		3219132.1	5.54 b-5
13611228.46		3219134.76	5.09 b-6
13611195.62		3219176.39	6.32 b-7
13610893.91		3219395.55	5.63 b-8
13610743.7		3219504.87	5.57 b-9
13610567.02		3219639.65	5.53 b-10
13610309.94		3219834	6.88 b-11

TRANSECT "C" COORDINATES

Northing	Easting	Elevation	Description
13611492.34		3219012.34	5.91 c-1
13611407.43		3219067.05	6.32 c-2
13611368.91		3219090.89	4.59 c-3
13611327.52		3219117.63	4.49 c-4
13611286.28		3219149.05	6.91 c-5
13611237.9		3219178.16	4.57 c-6
13611182		3219222.14	7.34 c-7
13610910.7		3219430.47	5.56 c-8
13610760.51		3219535.59	5.47 c-9
13610584.9		3219660.77	5.61 c-10
13610349.02		3219854.11	7.98 c-11

WETLAND AREA "NNN" COORDINATES

Northing	Easting	Elevation	Description
13611329.21	3219020.8	4.48	start 1 on pl
13611339.69	3219013.28	4.54	coe 2
13611368.67	3219026.48	4.68	3
13611364.44	3219054.98	4.65	4
13611346.97	3219090.93	4.54	5
13611337.52	3219098.71	4.51	6
13611333.18	3219124.51	4.56	7
13611331.98	3219142.87	4.46	8 on pl
13611301.7	3219165.21	4.72	9 on pl
13611312.31	3219155.43	4.66	10
13611321.6	3219132.53	4.9	11
13611314.61	3219120.11	4.89	12
13611293.4	3219116.05	4.7	13
13611278.54	3219109.96	4.81	14
13611273.48	3219125.64	4.76	15
13611264.34	3219145.8	4.96	16
13611257.76	3219147.87	4.92	17
13611261.3	3219160.76	4.95	18
13611253.37	3219144.53	4.93	19
13611258.69	3219135.95	4.9	20
13611265.81	3219122.41	4.81	21
13611266.99	3219099.87	4.68	22
13611258.09	3219072.54	4.83	23 on pl
13611268.07	3219065.83	4.84	24 on pl
13611282	3219079.62	4.9	25
13611301.58	3219077.7	4.79	26
13611327.58	3219073.09	4.69	27
13611337	3219071.5	4.78	27.3
13611343.11	3219059.44	4.62	27.6
13611340.33	3219053.04	4.66	27.9
13611327.25	3219062.98	4.85	28
13611310.97	3219034.37	4.56	end 29 on pl t1

WETLAND AREA "OOO" COORDINATES

Northing	Easting	Elevation	Description
13611238.47	3219090.37	4.87	start 41
13611245.14	3219098.69	4.83	42
13611237.98	3219102.82	4.82	43
13611231.82	3219112.49	4.86	44
13611229.39	3219122.98	5	45
13611230.16	3219143.34	4.85	46
13611243.95	3219148.2	4.71	47
13611238.55	3219150.65	4.72	48
13611243.67	3219166.23	4.71	49
13611260.62	3219171.46	4.67	50
13611258.03	3219194.98	4.71	51
13611252.51	3219196.83	4.6	52
13611229.96	3219198.97	4.62	53
13611224.78	3219193.58	4.74	54
13611211.44	3219151.1	4.91	55
13611227.51	3219147.86	4.83	56
13611225.97	3219134.81	5.09	57
13611226.26	3219116.08	4.91	58
13611224.06	3219101.97	4.87	59 t41