

FOR SUBLEASE | APPROX ±1,500 SF RETAIL / BAR / CAFE
3037 N WILLIAMS AVE, PORTLAND, OR 97227



PROPERTY DESCRIPTION

Available now - approximately 1,500 SF turnkey bar/restaurant in the Williams district of North Portland. Located in mixed-use building and next door to 215 unit apartment building.

PROPERTY HIGHLIGHTS

- Ideal uses: Cafe, wine bar, general retail
- Exposed brick, wood floors, and tall ceilings
- Built-in bar & built-in coolers
- Prep kitchen area with hoodless electric stovetop
- 35-gal grease receptacle
- Bike room access
- Additional 1,500 SF basement storage w/office available
- Common area restrooms
- Term ends 2/28/2030

OFFERING SUMMARY

Main Floor Lease Rate:	\$27.00 SF/yr (NNN)
Main Floor SF:	+/- 1,500 SF
Building Size:	10,485 SF

DEMOGRAPHICS	0.3 MILES	0.5 MILES	1 MILE
Total Households	1,355	3,529	12,226
Total Population	2,719	7,182	25,656
Average HH Income	\$135,663	\$131,783	\$135,226

MARISSA LEE

Commercial Broker
Marissa@CommercialRENW.com
971.280.2222

Commercial Real Estate NW
7320 SW Hunziker Rd, Ste 203
Tigard, OR 97223
CommercialRENW.com

FOR SUBLEASE | APPROX ±1,500 SF RETAIL / BAR / CAFE
3037 N WILLIAMS AVE, PORTLAND, OR 97227



MARISSA LEE
Commercial Broker
Marissa@CommercialRENW.com
971.280.2222

Commercial Real Estate NW
7320 SW Hunziker Rd, Ste 203
Tigard, OR 97223
CommercialRENW.com

ADDITIONAL PHOTOS

FOR SUBLEASE | APPROX ±1,500 SF RETAIL / BAR / CAFE
3037 N WILLIAMS AVE, PORTLAND, OR 97227



MARISSA LEE
Commercial Broker
Marissa@CommercialRENW.com
971.280.2222

Commercial Real Estate NW
7320 SW Hunziker Rd, Ste 203
Tigard, OR 97223
CommercialRENW.com



FLOOR PLAN

FOR SUBLEASE | APPROX ±1,500 SF RETAIL / BAR / CAFE
3037-3041 N WILLIAMS AVE & 18-20 N MONROE ST, PORTLAND, OR 97227

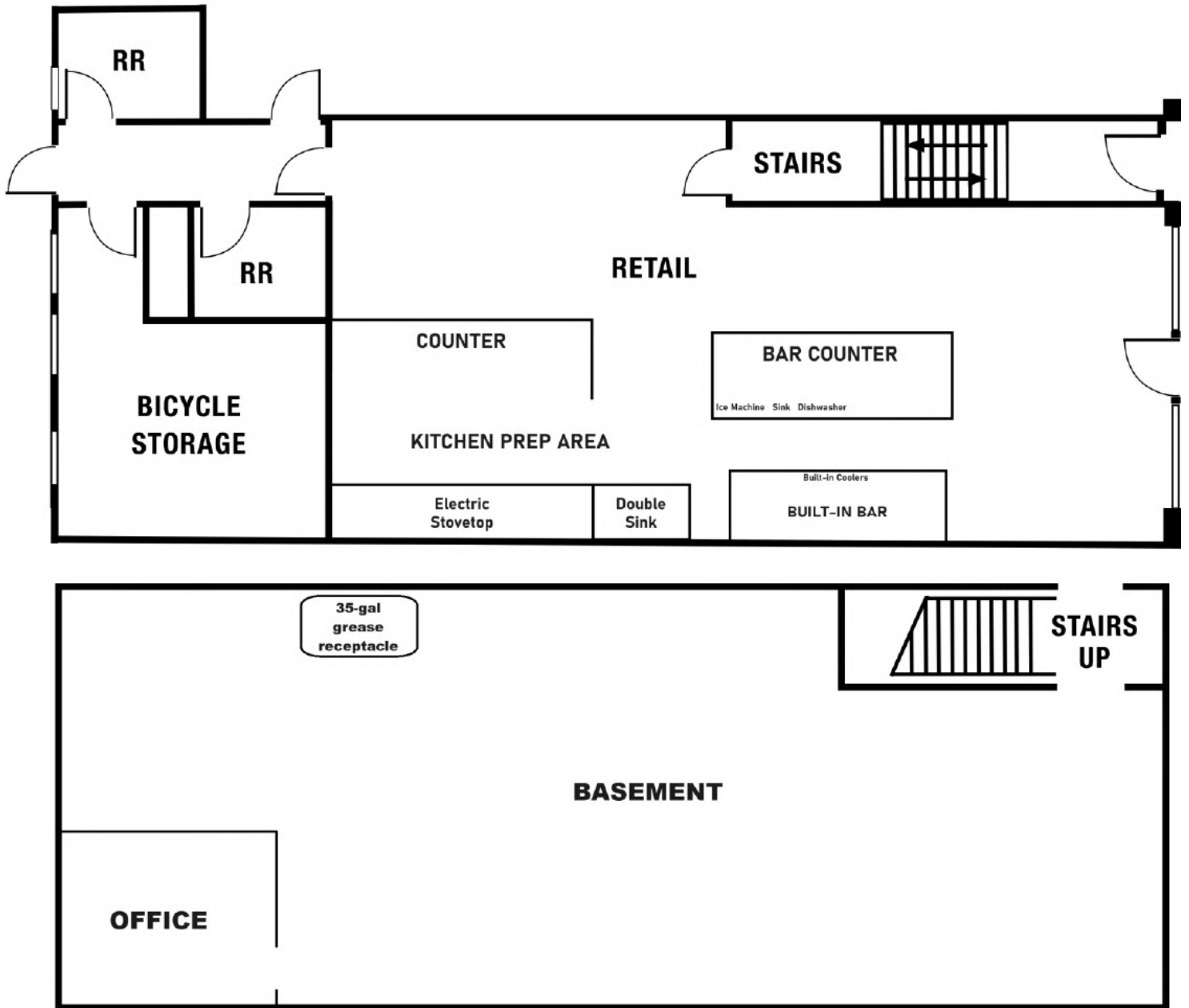

MARISSA LEE
Commercial Broker
Marissa@CommercialRENW.com
971.280.2222

Commercial Real Estate NW
7320 SW Hunziker Rd, Ste 203
Tigard, OR 97223
CommercialRENW.com

FOR SUBLEASE | APPROX ±1,500 SF RETAIL / BAR / CAFE
3037 N WILLIAMS AVE, PORTLAND, OR 97227



Map data ©2025 Google Imagery ©2025 Airbus, CNES / Airbus, Maxar Technologies, Metro, Portland Oregon, USDA/FPAC/GEO

MARISSA LEE
Commercial Broker
Marissa@CommercialRENW.com
971.280.2222

Commercial Real Estate NW
7320 SW Hunziker Rd, Ste 203
Tigard, OR 97223
CommercialRENW.com



LOCATION MAP

FOR SUBLEASE | APPROX ±1,500 SF RETAIL / BAR / CAFE
3037 N WILLIAMS AVE, PORTLAND, OR 97227

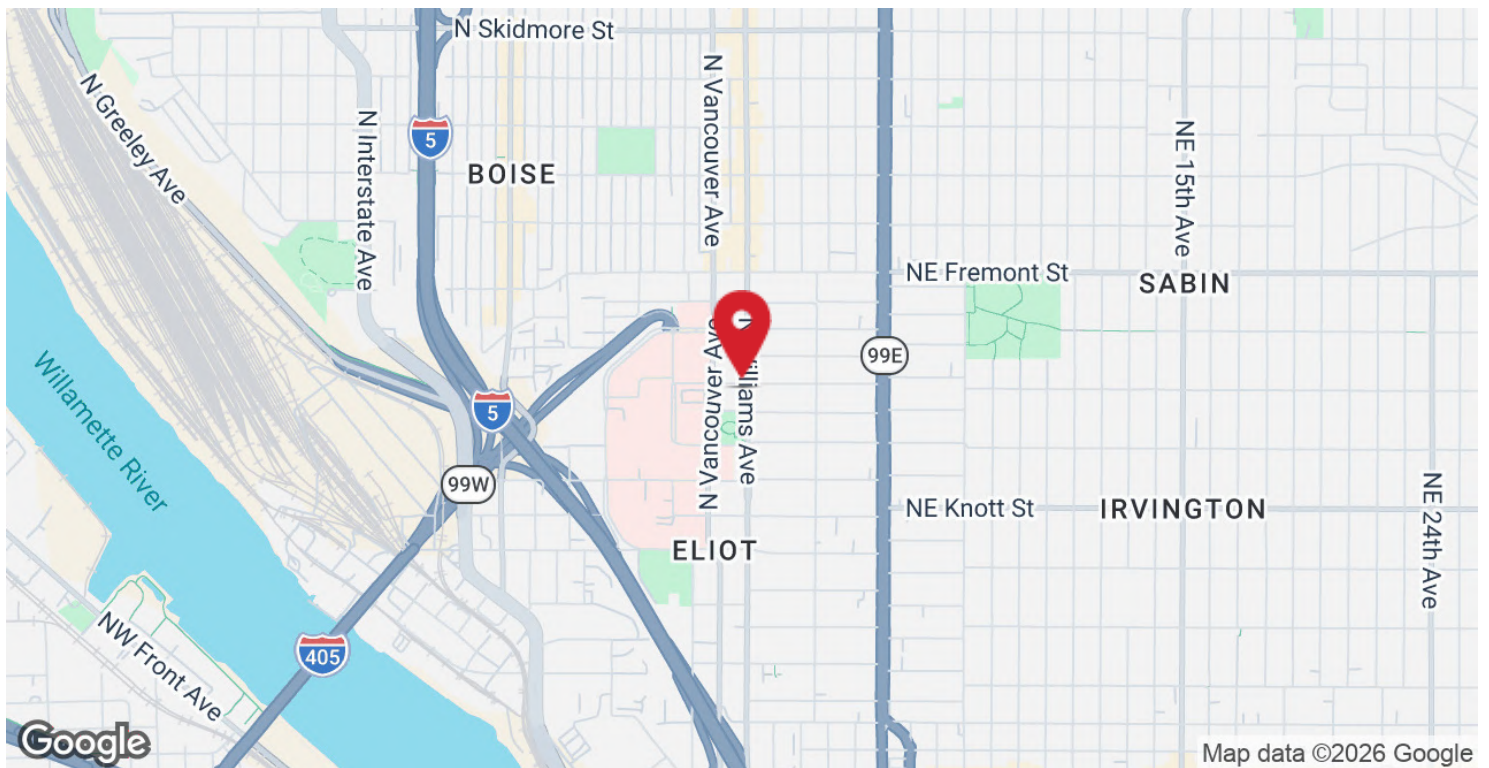
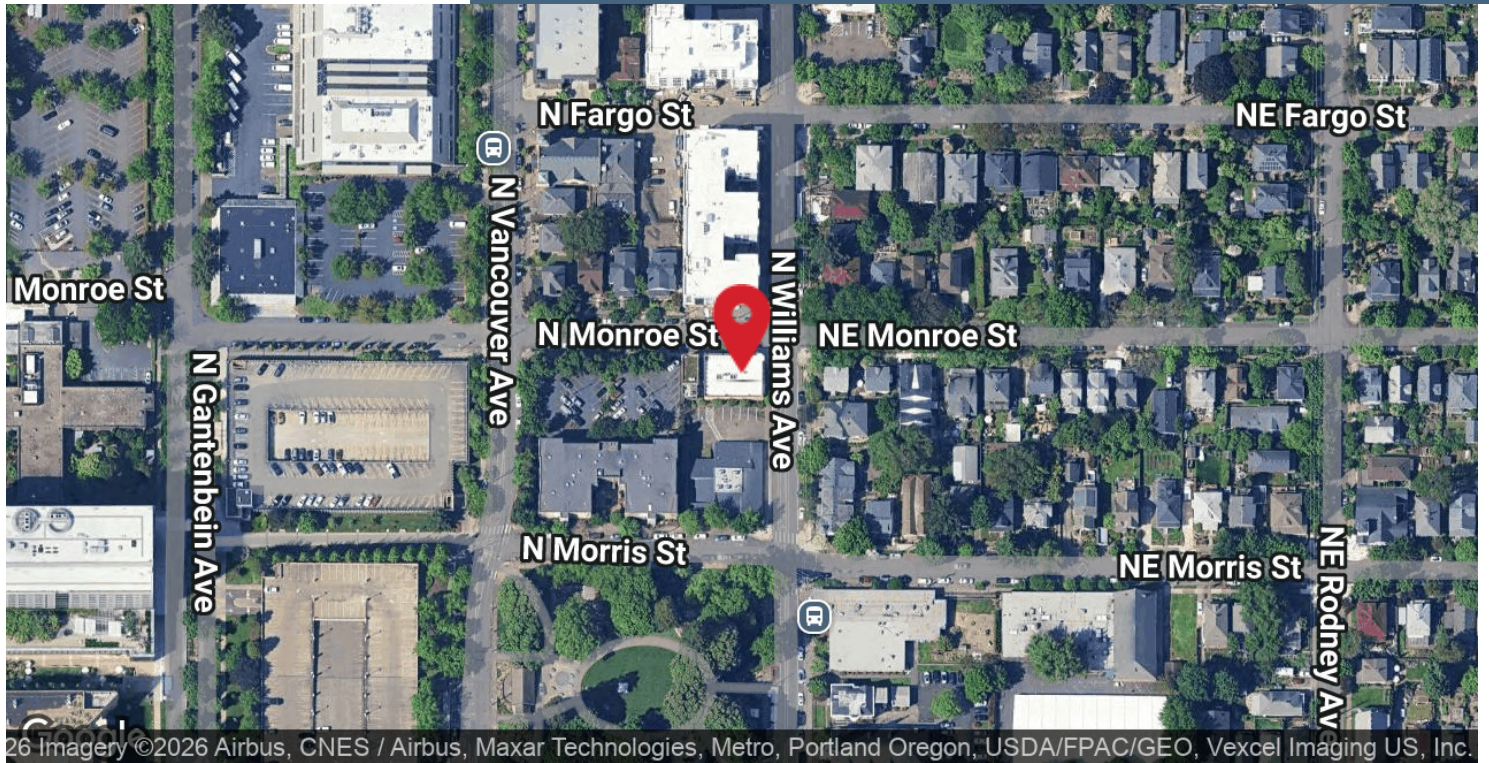

MARISSA LEE
Commercial Broker
Marissa@CommercialRENW.com
971.280.2222

Commercial Real Estate NW
7320 SW Hunziker Rd, Ste 203
Tigard, OR 97223
CommercialRENW.com

FOR SUBLEASE | APPROX ±1,500 SF RETAIL / BAR / CAFE
3037 N WILLIAMS AVE, PORTLAND, OR 97227

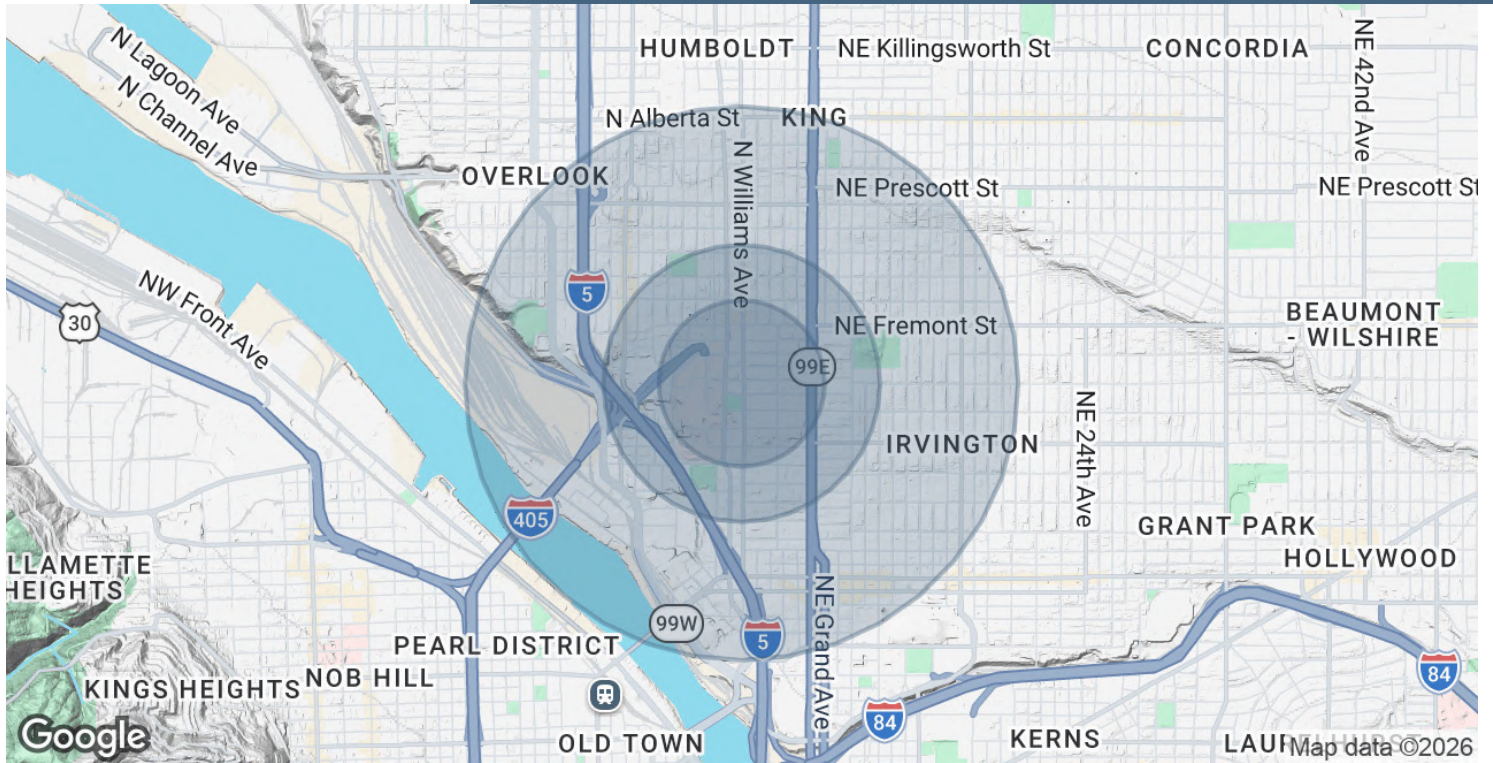

POPULATION	0.3 MILES	0.5 MILES	1 MILE
Total Population	2,719	7,182	25,656
Average Age	37	38	39
Average Age (Male)	37	38	39
Average Age (Female)	37	38	39

HOUSEHOLDS & INCOME	0.3 MILES	0.5 MILES	1 MILE
Total Households	1,355	3,529	12,226
# of Persons per HH	2	2	2.1
Average HH Income	\$135,663	\$131,783	\$135,226
Average House Value	\$719,576	\$708,570	\$763,719

Demographics data derived from AlphaMap

MARISSA LEE
Commercial Broker
Marissa@CommercialRENW.com
971.280.2222

Commercial Real Estate NW
7320 SW Hunziker Rd, Ste 203
Tigard, OR 97223
CommercialRENW.com