

State Properties Commission (SPC) Georgia Department of Juvenile Justice (DJJJ)

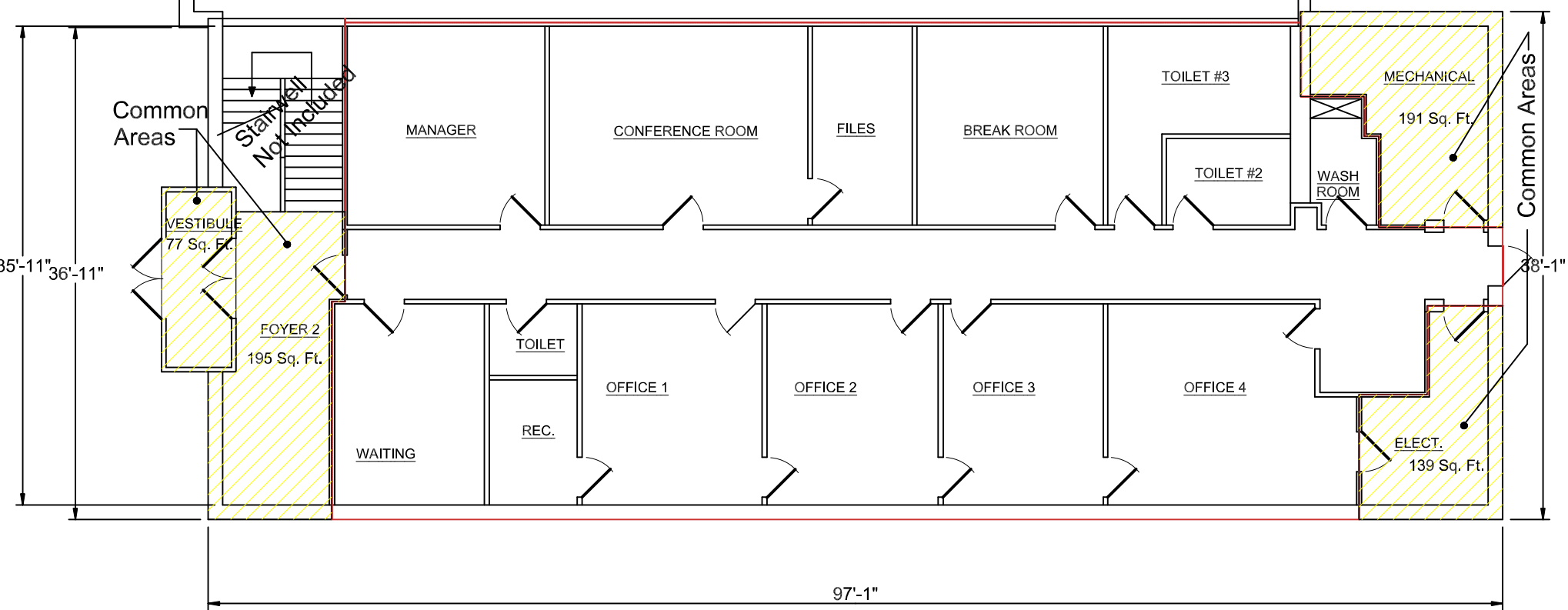

SUITE 201-TENANT LEASE PLAN

(Scale: 1/8" = 1'-0")



GRAPHIC SCALE

USEABLE AREA = 2,936 S.F.

COMMON AREA IS 1,244 S.F. TO BE DIVIDED BETWEEN ALL TENANT SPACES AS NOTED ON EXCEL SPREADSHEET.

DRAWING PREPARED
& CONFIRMED
ON JUNE 13th, 2024
BASED ON ORIGINAL
BUILDING PLANS DATED
2008. **EXHIBIT "A"**

richard landau
ARCHITECTS & PLANNERS
2266 Gainesville Highway
(706) 897-5824
Blairsville, Georgia 30512
mountainarchitect @ msn.com

this drawing is the property of the architect and is not to be reproduced, changed or altered in any way without written permission of the architect.

**FEDERAL PLAZA
35 WEST CHURCH ST.
JASPER, GEORGIA**

PROJECT NAME
24-17
PROJECT #

SHEET TITLE
**SUITE 201
TENANT LEASE PLAN**
DRAWN BY: DMR CHECKED BY: RL APPROVED BY: RL

SHEET:
LP-2