

market

REAL ESTATE

Historic Building for Lease in the Heart of Pearl Street

1136 PEARL STREET | BOULDER, CO 80302
SUITE 200A, 200B

Size: 300 - 4,746

Price: \$25 - \$33 NNN (\$20.83)

Available: Now

GO DOWN IN HISTORY

Or... maybe go UP in history? Because this whole-floor office space is on the second story of the historic "1882 Building" which has been host to a whole society of successful artists, restaurants and even Mike's Camera. Of course, historic doesn't mean austere! It has access to two kitchens, a conference room -and- huge windows and a patio which overlooks the Flatirons. If that's not enough, you can hit the bricks on Pearl Street to find shopping and great food. And you needn't go far: Japango Sushi is directly below! Are you ready to become part of the 1882 Building's historic society?

PROPERTY HIGHLIGHTS

- Historic building in the heart of the Pearl Street Mall
- South-facing deck with direct Flatiron views
- High ceilings and historic features
- Directly above Japango Sushi Restaurant
- 3 on-site parking spaces included
- Local ownership



Shared kitchen



South-facing offices



Flatiron views

[CLICK HERE](#)
for virtual tour



LEARN MORE ABOUT THIS PROPERTY
MarketBoulder.com

POTENTIAL DEMISING PLAN

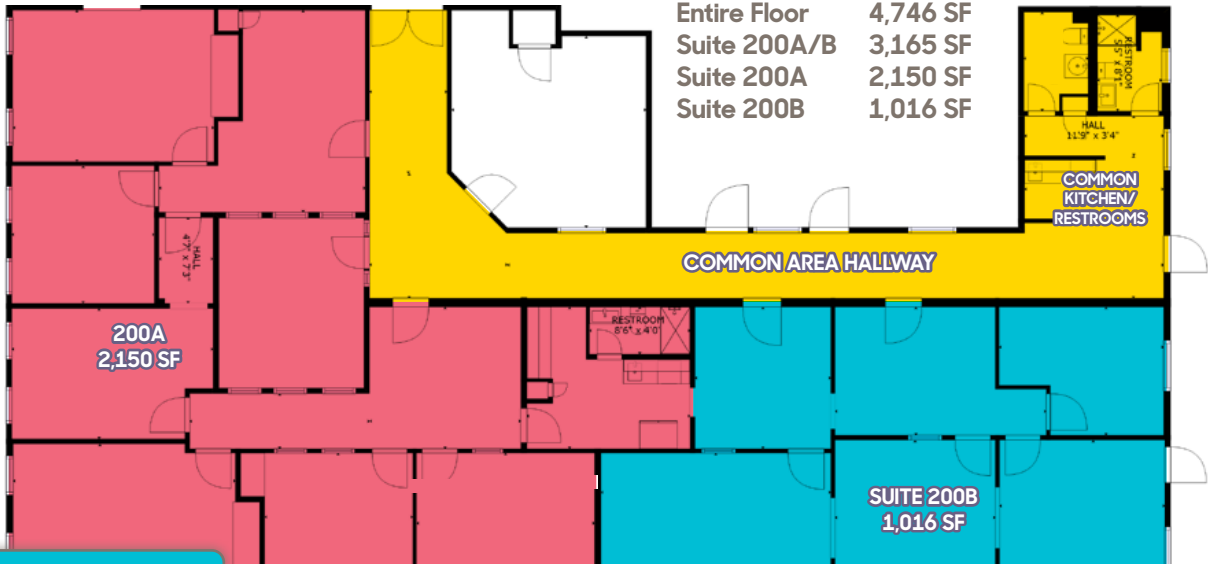

[CLICK HERE](#)
for virtual tour

1136 Pearl in the 1960s. Mike's Camera, Tri State Finance Corp., and Magdalena's Holland Restaurant.

Photo courtesy of Boulder Historical Society/Museum of Boulder



DISCLAIMER: The information contained herein has been obtained from sources believed reliable. While we do not doubt its accuracy, we have not verified it and make no guarantee, warranty or representation about it. It is your responsibility to independently confirm its accuracy and completeness.



LEARN MORE ABOUT THIS PROPERTY
MarketBoulder.com

NATE LITSEY
303 444 4024 Nate@MarketBoulder.com

ANNIE LARNER
303 444 1344 Annie@MarketBoulder.com

