



FOR SUBLEASE

Walgreens - Karsch Blvd

120 E Karsch Blvd | Farmington, MO



Walgreens - Karsch Blvd

120 E Karsch Blvd | Farmington, MO 63640

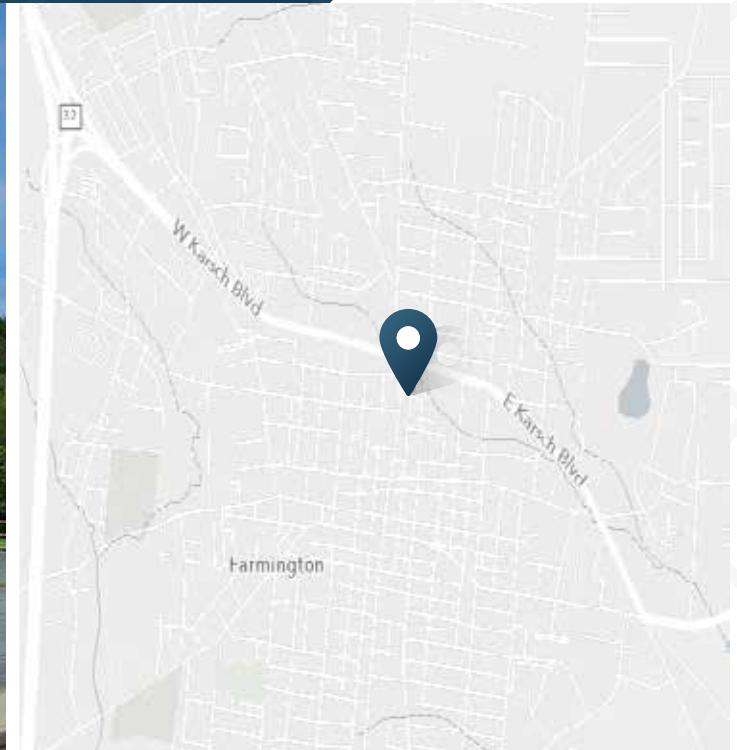

5,000 SF
Available

9/30/2037
Lease Expiration

\$8.00 PSF
Asking Rent

ABOUT THE PROPERTY

- Located along the main stretch of the retail and restaurant epicenter in Farmington, Missouri
- Property sits next door to brand new Dollar Tree with easy access and ample parking.
- County seat of St. Francis County, Missouri
- 48,000+ People living within a 10 mile radius of the property
- All offers are subject to approval by Walgreens Real Estate Committee.

JOIN THESE RETAILERS



TRAFFIC COUNTS

W Karsch Blvd	16,498 VPD
N Washington Street	10,666 VPD
E Karsch Blvd	19,640 VPD
Year: 2024 Source: MoDOT	

Walgreens - Karsch Blvd

120 E Karsch Blvd | Farmington, MO 63640

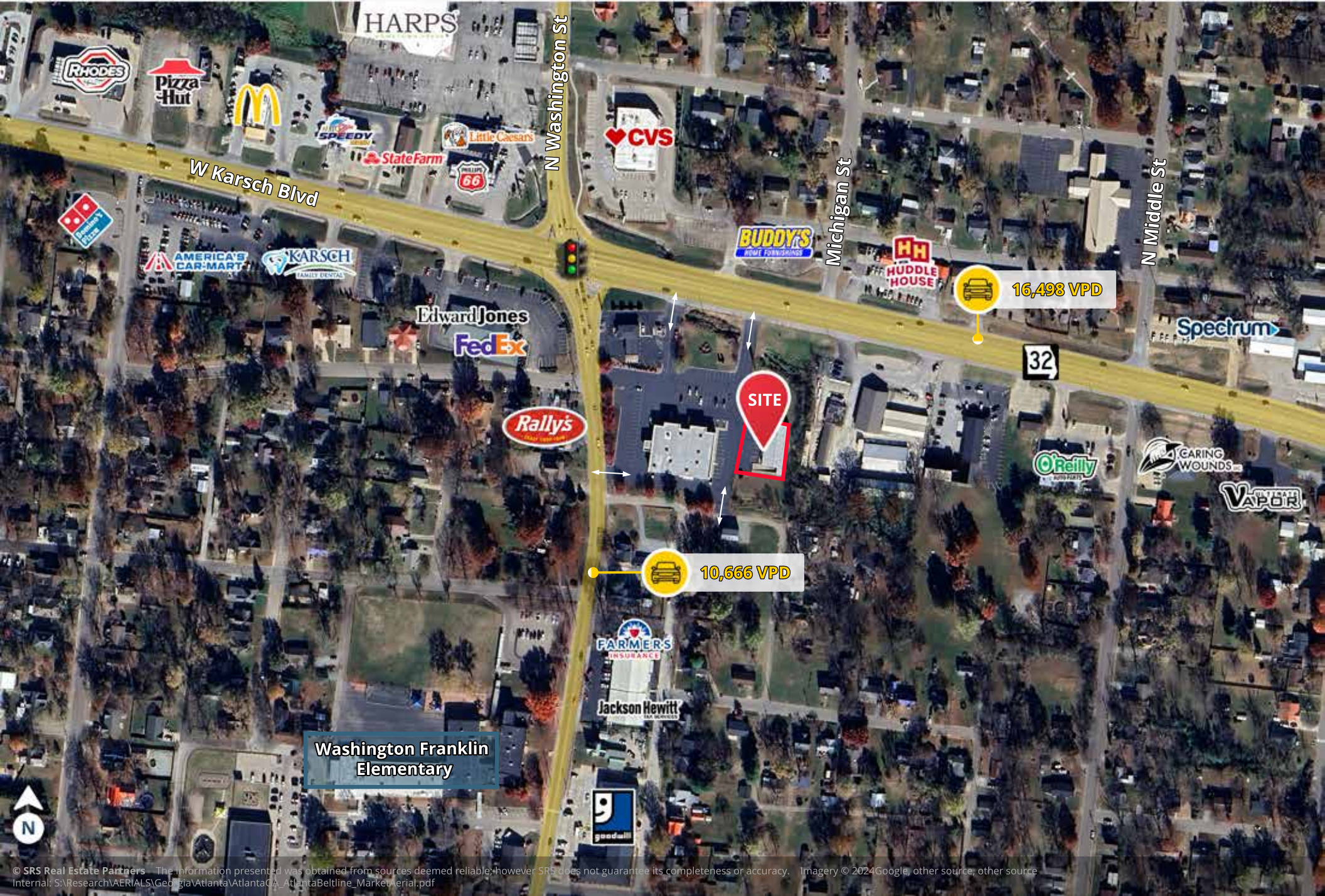

Washington Franklin Elementary

SITE

16,498 VPD

10,666 VPD

Walgreens - Karsch Blvd

120 E Karsch Blvd | Farmington, MO 63640

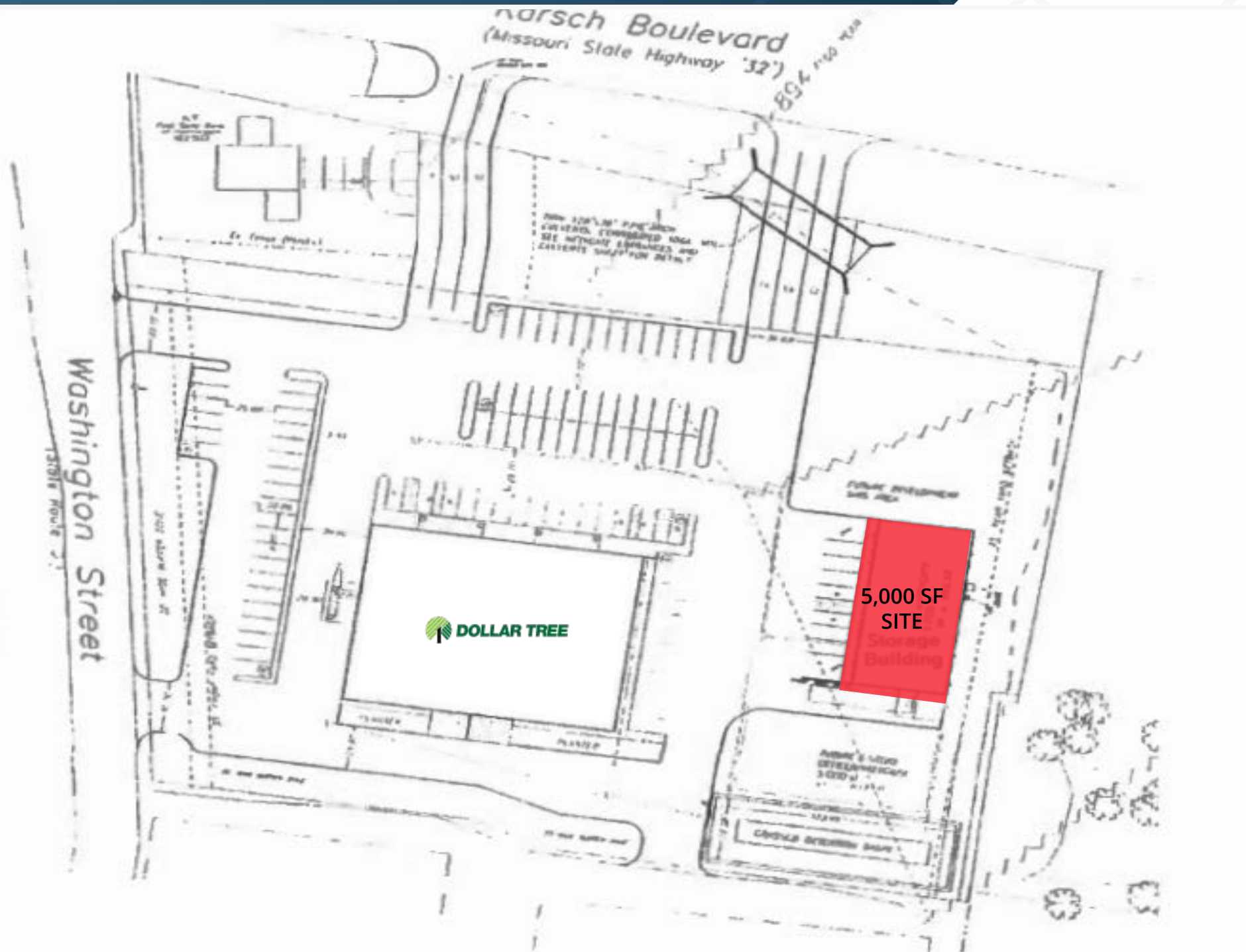

DEMOGRAPHIC HIGHLIGHTS

1 MILE

7,992 Population	10,374 Total Daytime Population	\$61,903 Average Household Income	3,402 Total Households
---------------------	---------------------------------------	---	------------------------------

3 MILES

21,065 Population	25,091 Total Daytime Population	\$68,364 Average Household Income	7,671 Total Households
----------------------	---------------------------------------	---	------------------------------

5 MILES

25,910 Population	28,834 Total Daytime Population	\$69,669 Average Household Income	9,509 Total Households
----------------------	---------------------------------------	---	------------------------------

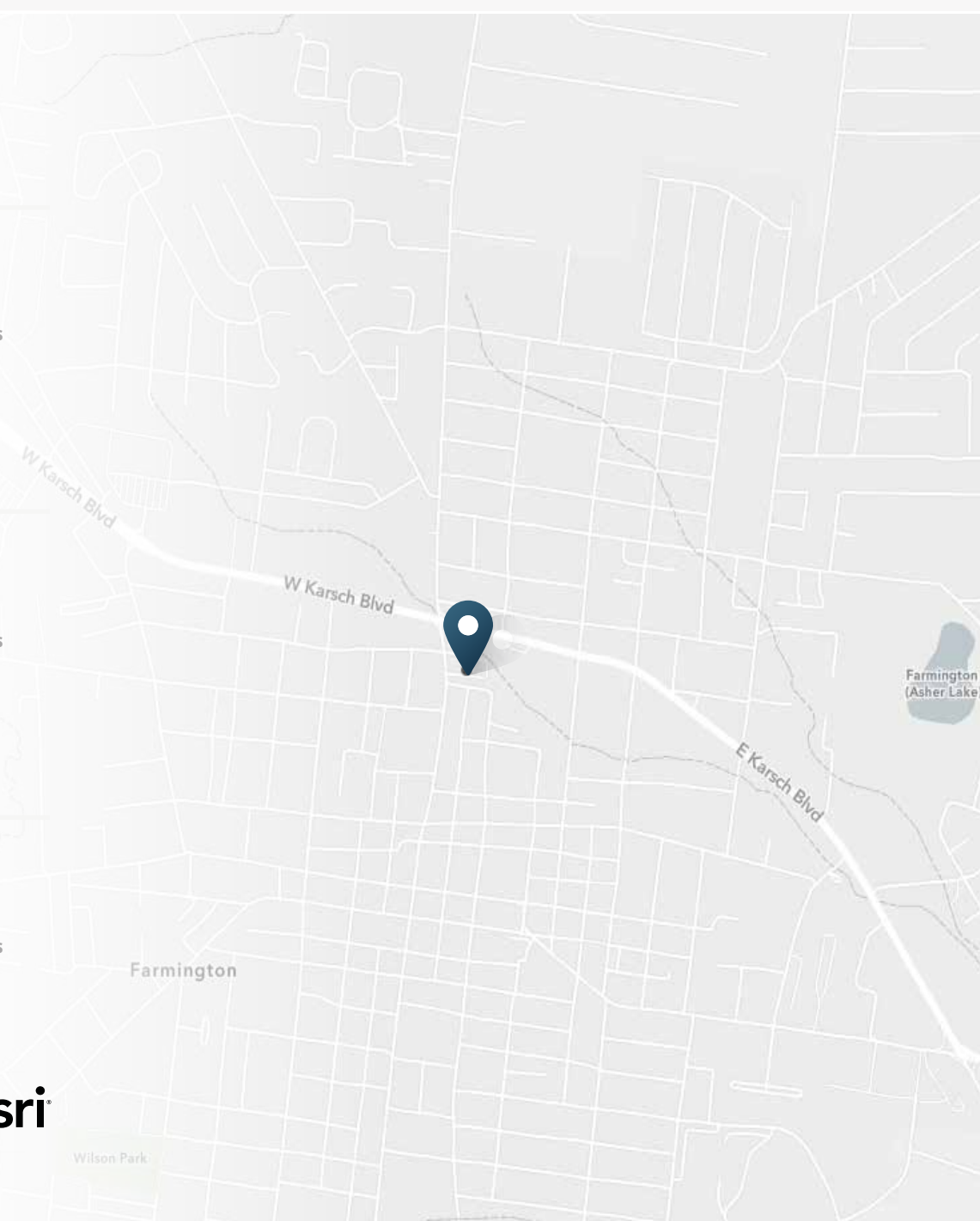

> **Want more?** Contact us for a complete demographic, foot-traffic, and mobile data insights report.

SOURCE 

Southwest
Missouri
Mental Health

Wilson Park



SRS Real Estate Partners
125 S Wacker Drive | Suite 1910
Chicago, IL 60606
312.279.5320

Todd Frank
847.722.8253
todd.frank@srsre.com

John Notter
314.282.9825
john@l3corp.net

SRSRE.COM

© SRS Real Estate Partners

The information presented was obtained from sources deemed reliable;
however SRS Real Estate Partners does not guarantee its completeness or accuracy.