

savills

SUBLEASE

Santa Monica Sublease

Santa Monica Business Park

3000 Ocean Park Blvd. Santa Monica, CA 90405

SPACE PROFILE

21,453

Total SF (Divisible)

Immediate

Availability

~~**\$4.50 FSG**~~

Previous Rate
Reduced

**Price
Reduction**

4.5/1,000 SF

Parking

Thru 2/29/28

Term

\$2.85 FSG

Reduced Rate
for entire 21,453 RSF

Spacious Plug N Play Office Sublease

KEY HIGHLIGHTS

- Space divisible to 16,000 RSF and 5,000 RSF
- Large open areas with private offices
- Fully furnished and move-in ready
- Wrap-around atrium views
- Natural light throughout
- Building offers amenities including on-site management, health club and daycare

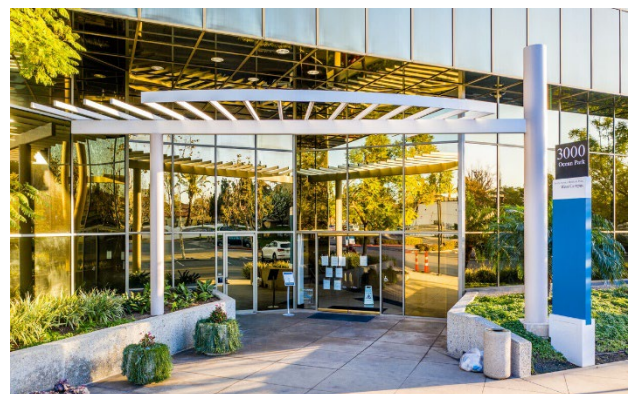
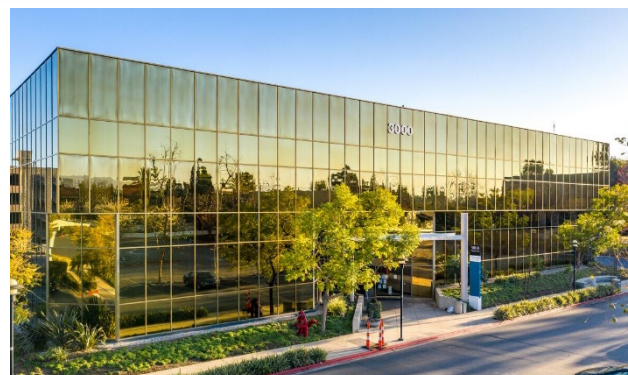

Floor Plan | SUITE 1000

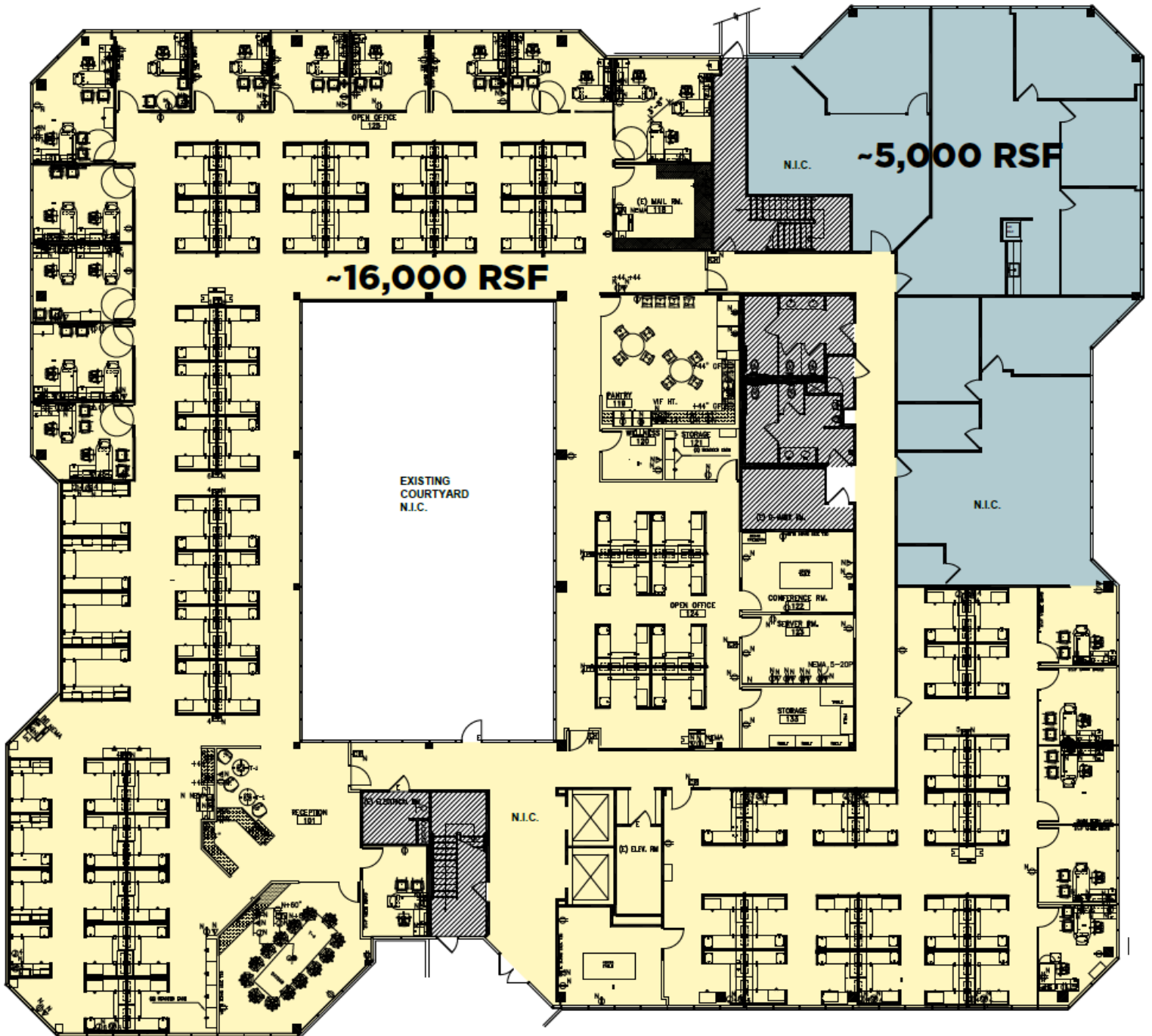

SPACE FEATURES

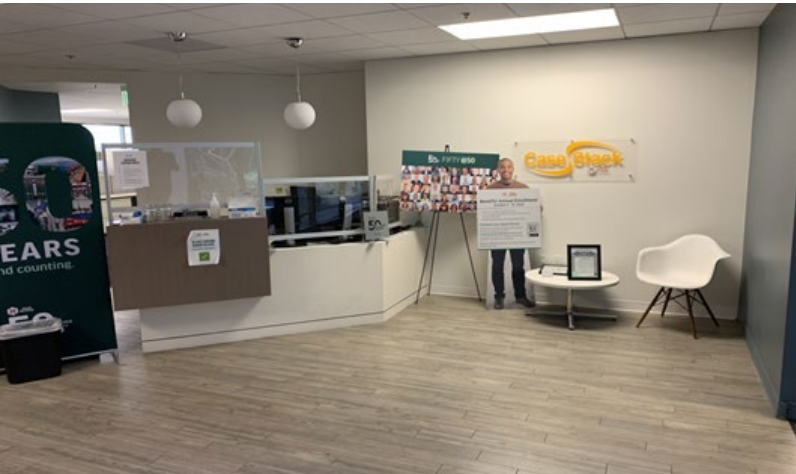

Matt Brainard
+1 310 444 1026
mbrainard@savills.us
License 01267600

Ivan Chavez
+1 562 335 5638
ichavez@savills.us
License 01974498

The information contained in this communication has been obtained from a variety of sources believed to be reliable but has not been verified. NO WARRANTY OR REPRESENTATION, EXPRESS OR IMPLIED, IS MADE AS TO THE CONDITION OF THE PROPERTY OR ACCURACY OR COMPLETENESS OF THE INFORMATION CONTAINED HEREIN AND SAME IS SUBMITTED SUBJECT TO ERRORS, OMISSIONS, CHANGE OF PRICE, RENTAL OR OTHER CONDITIONS, WITHDRAWAL WITHOUT NOTICE AND TO ANY SPECIFIC CONDITIONS IMPOSED BY THE PROPERTY OWNER OR LESSOR.