

350 MADILL BOULEVARD, UNIT 20



HIGHWAY 401 FRONTAGE

Discover the exceptional opportunity at 350 Madill Boulevard, Unit 20, a premier multi-tenant industrial facility strategically located in Mississauga, Ontario.

This property offers direct frontage along Highway 401, providing outstanding visibility and seamless access for logistics and distribution operations.

The 36-foot clear height allows for maximum storage efficiency and racking solutions. The building is equipped with 17 shipping doors and a secured shipping area, ensuring streamlined loading and unloading for high-volume tenants.

Ample parking for 90 cars supports workforce needs, while the ESFR sprinkler system and robust 600 Amp electrical service deliver safety and operational reliability.

Visit OrlandoCorp.com for more details or call (905) 677-5480.

350



**ORLANDO
CORPORATION**

Canada's Premier Landlord of Industrial and Commercial Properties

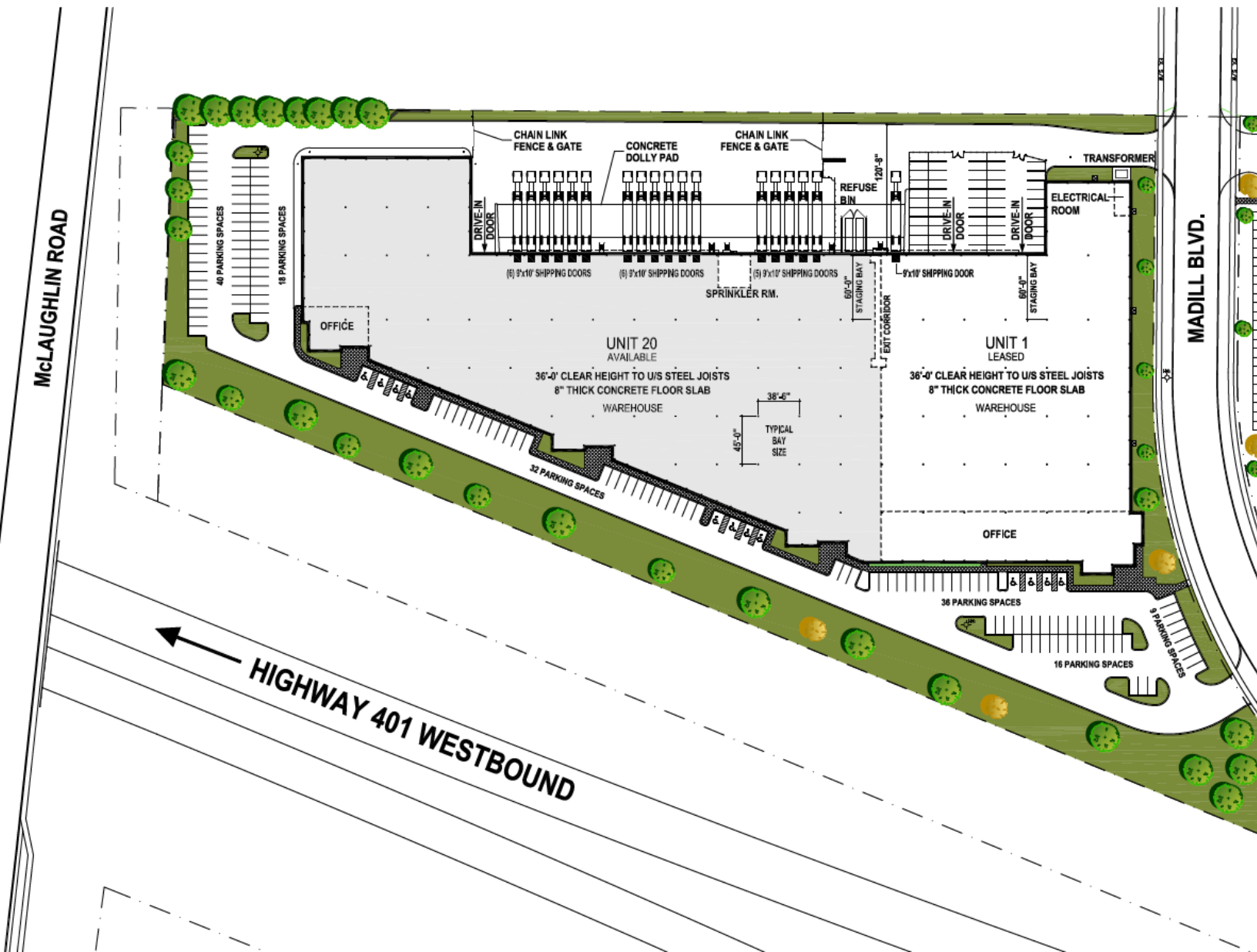

Images



Property Features

Area:	113,388 SF
Office:	2,387 SF
Warehouse:	109,657 SF
Utility/Other:	1,344 SF
Clear Height:	36'
Shipping Doors:	17
Drive-in Doors:	1
Parking:	90 cars
Sprinklers:	ESFR
Electrical:	600 Amps
Asking Rate:	\$15.95/SF/YR
Additional Rent:	\$4.75/SF/YR
Available:	Immediate

- **Highway Access:** Only 1.3 KM to the Highway 401 & Hurontario Street interchange.
- **Clear Height:** 36' clear warehouse provides maximum storage efficiency and racking solutions
- **Location:** The property benefits from a strong local labour pool within a 5 KM radius, making it ideal for businesses seeking access to skilled workers and efficient transportation routes.

No warranty or representation, expressed or implied, is made as to the accuracy of the information contained herein, and same is submitted to error or omissions. (April 18, 2026)