



7932  
1,322 SF

7938 - 7942  
4,783 SF

7944  
3,183 SF

7962  
2,468 SF

# 7902-7988 TANNERS GATE LANE

FLORENCE, KY 41042

AVAILABLE FOR LEASE

© 2026 SqFt Commercial LLC. All rights reserved. No warranty or representation, express or implied, is made to the accuracy or completeness of the information contained herein, and same is submitted subject to errors, omissions, change of price, rental or other conditions, withdrawal without notice, and to any special listing conditions imposed by the property owner(s). As applicable, we make no representation as to the condition of the property (or properties) in question. This information has been obtained from sources believed reliable, but has not been verified for accuracy or completeness. You should conduct a careful, independent investigation of the property and verify all information. Any reliance on this information is solely at your own risk. SqFt Commercial and the SqFt Commercial logo are service marks of SqFt Commercial, Inc. All other marks displayed on this document are the property of their respective owners. Photos herein are the property of their respective owners. Use of these images without the express written consent of the owner is prohibited.

**Rod MacEachen**  
(513) 675-5764  
Rod@SqFtCommercial.com

**Roddy MacEachen, SIOR**  
(513) 739-3985  
Roddy@SqFtCommercial.com

**Jared Wagoner, SIOR**  
(812) 890-1768  
Jared@SqFtCommercial.com

**Matt Schutte**  
(859) 414-9169  
Matt@SqFtCommercial.com

**Sarah Kern**  
(513) 426-4864  
Sarah@SqFtCommercial.com

**Amy Castaneda**  
(503) 310-9768  
Amy@SqFtCommercial.com

# 7902-7988 TANNERS GATE LANE

FLORENCE, KY 41042

INFO@SQFTCOMMERCIAL.COM

(513) 843-1600

[SQFTCOMMERCIAL.COM](http://SQFTCOMMERCIAL.COM)



## PROPERTY HIGHLIGHTS



**1,322-11,756 SqFt**

- Under New Ownership
- Drive-in Door
- I-75 Visibility
- Immediate access to I-75 via Burlington Pike & 1829/42
- Signage Available
- Exterior building just repainted in 2024
- Lease rate: \$8.95/SF NNN-\$10.95/SF NNN + \$2.97/SF OpEx
- Flexible open floorplans

 [CLICK HERE FOR AERIAL VIDEO](#)

## PROPERTY DETAILS

Type Construction:	Block/Masonry
Roof:	Metal: under warranty through 2041
Electrical Service:	120/208V 3phase
Sprinkler:	Yes-wet
Parking Spaces:	Ample: multi-tenant park, first come first served
Signage:	On-suite signage available with visibility on I-75 as well as signage on monument sign at park entry
County:	Boone
Zoning:	Florence: C-2/PD/PO

# 7902-7988 TANNERS GATE LANE

FLORENCE, KY 41042

INFO@SQFTCOMMERCIAL.COM

(513) 843-1600

[SQFTCOMMERCIAL.COM](http://SQFTCOMMERCIAL.COM)



## Suite 7932

Suite Total SqFt:	1,322
Warehouse SqFt:	661
Office SqFt:	661
Clear Height:	10'-12'
Lighting:	Fluorescent
Dock doors:	None
Drive-in door:	One (1) 8'x8'
HVAC:	100% HVAC
Sprinkler:	Yes-wet
Parking Spaces:	Ample: multi-tenant park, first come first served
Restrooms:	One (1)

## Suite 7938 - 7942

Suite Total SqFt:	4,783
Warehouse SqFt:	2,100
Office SqFt:	2,683
Clear Height:	10'-12'
Flooring:	Carpet in office, concrete in warehouse
Lighting:	Fluorescent
Dock doors:	One (1) city high dock 8'x8'
Drive-in door:	One (1) 8'x8'
HVAC:	100% HVAC
Parking Spaces:	Ample: multi-tenant park, first come first served
Restrooms:	Two (2)

## Suite 7944

Suite Total SqFt:	3,183
Warehouse SqFt:	3,183
Office SqFt:	0
Clear Height:	10'-12'
Lighting:	Fluorescent
Dock doors:	One (1): 8'x8'
Drive-in door:	None
HVAC:	100% HVAC
Parking Spaces:	Ample: multi-tenant park, first come first served
Restrooms:	One (1)

## Suite 7962

Suite Total SqFt:	2,468
Warehouse SqFt:	480
Office SqFt:	1,988
Clear Height:	10'-12'
Lighting:	Fluorescent
Dock doors:	None
Drive-in door:	One (1) 10'x10'
HVAC:	100% HVAC
Sprinkler:	Yes-wet
Parking Spaces:	Ample: multi-tenant park, first come first served
Restrooms:	One (1)

# 7902-7988 TANNERS GATE LANE

FLORENCE, KY 41042

INFO@SQFTCOMMERCIAL.COM  
(513) 843-1600  
SQFTCOMMERCIAL.COM



## DISTANCE MAP

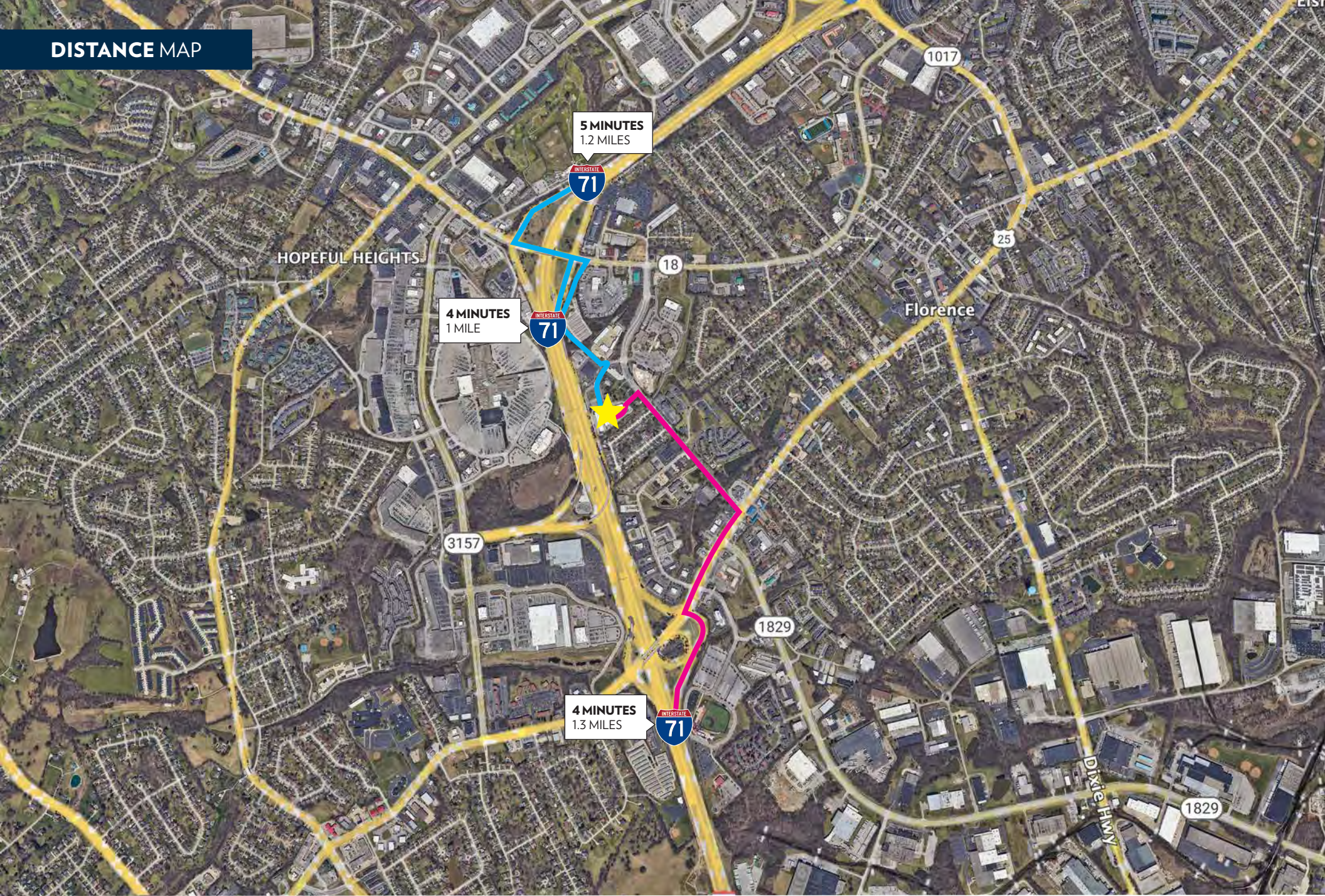

# 7902-7988 TANNERS GATE LANE

FLORENCE, KY 41042

INFO@SQFTCOMMERCIAL.COM

(513) 843-1600

[SQFTCOMMERCIAL.COM](http://SQFTCOMMERCIAL.COM)



## REGIONAL MAP



19 MINUTES  
12.4 MILES



19 MINUTES  
8 MILES

# 7902-7988 TANNERS GATE LANE

FLORENCE, KY 41042

INFO@SQFTCOMMERCIAL.COM  
(513) 843-1600  
[SQFTCOMMERCIAL.COM](http://SQFTCOMMERCIAL.COM)



AERIAL VIEW



# 7902-7988 TANNERS GATE LANE

FLORENCE, KY 41042

INFO@SQFTCOMMERCIAL.COM  
(513) 843-1600  
SQFTCOMMERCIAL.COM



## FLOOR PLANS

Building Total SqFt: 18,799

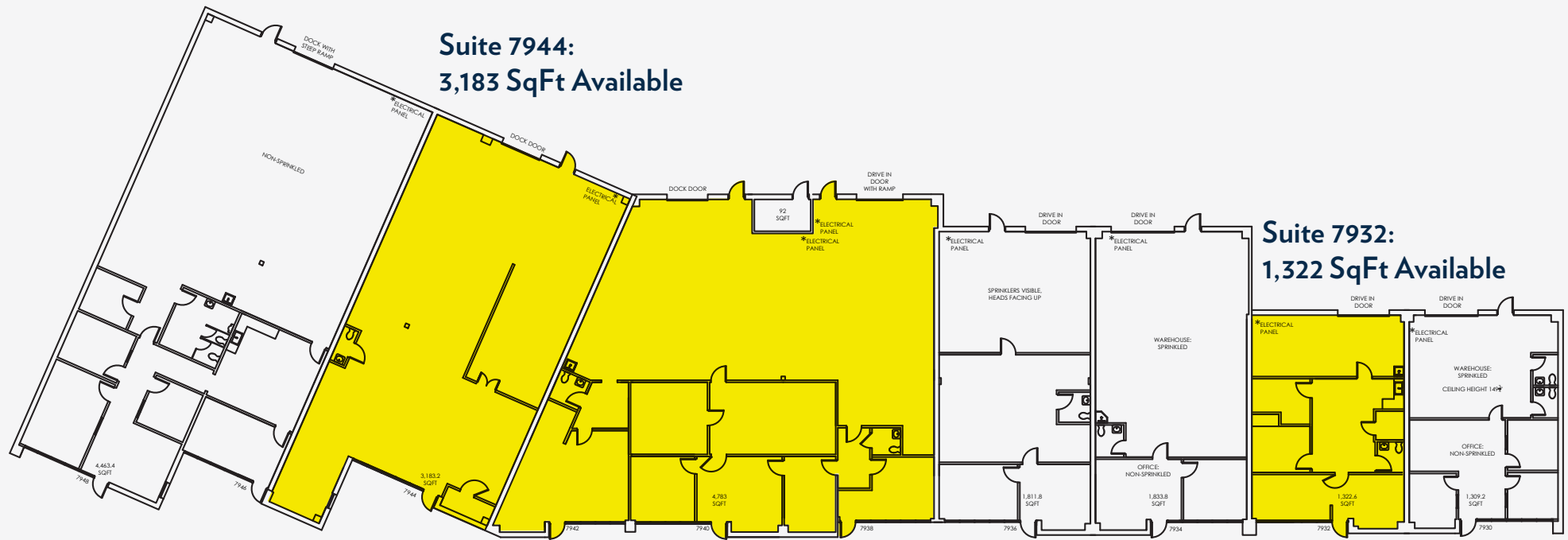

Suite 7944:  
3,183 SqFt Available

Suite 7932:  
1,322 SqFt Available

Suites 7938-7942:  
4,783 SqFt Available

# 7902-7988 TANNERS GATE LANE

FLORENCE, KY 41042

INFO@SQFTCOMMERCIAL.COM  
(513) 843-1600  
SQFTCOMMERCIAL.COM



## FLOOR PLANS

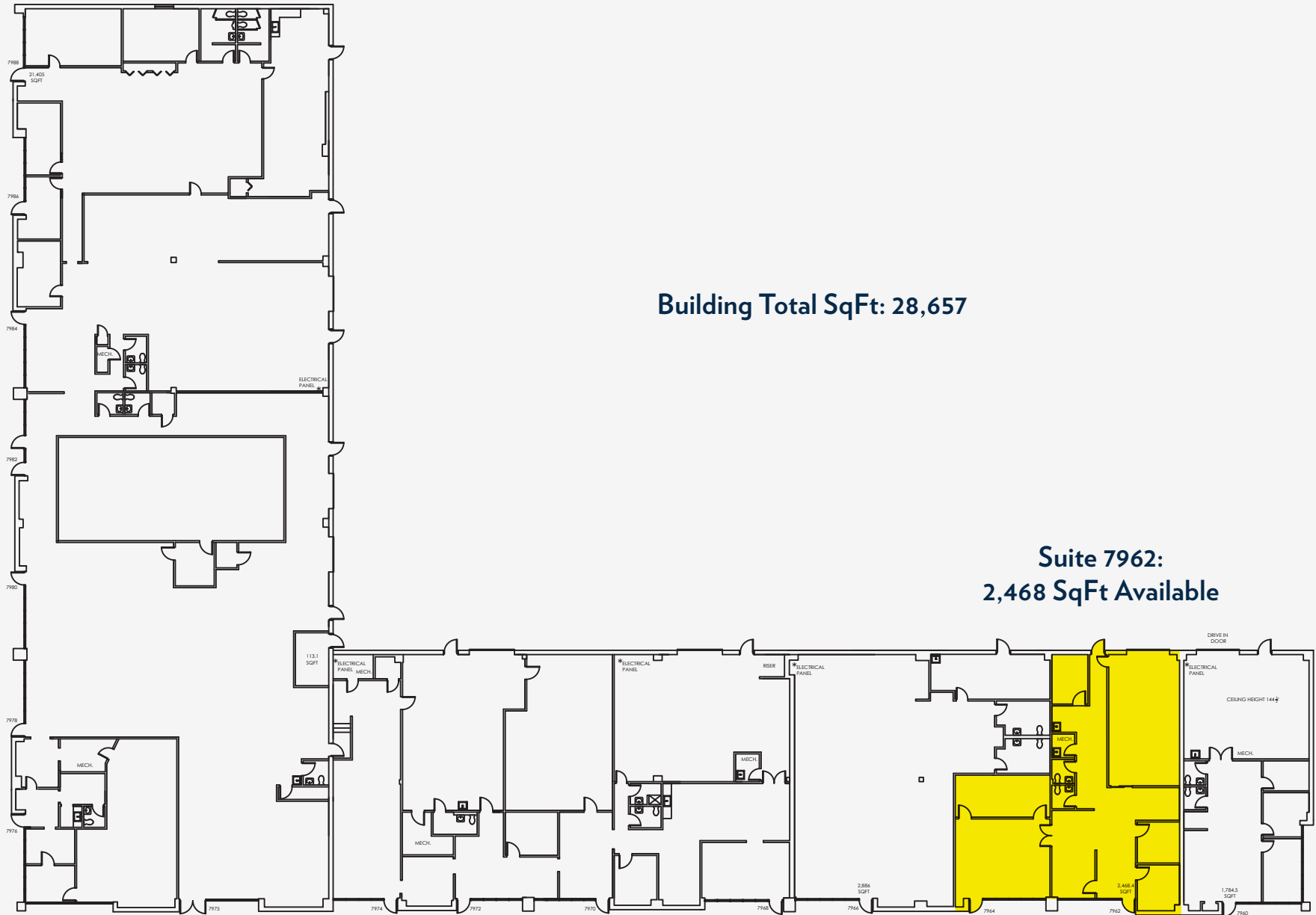

Building Total SqFt: 28,657

Suite 7962:  
2,468 SqFt Available

# 7902-7988 TANNERS GATE LANE

FLORENCE, KY 41042

INFO@SQFTCOMMERCIAL.COM  
(513) 843-1600  
SQFTCOMMERCIAL.COM

