





# STRATEGIC LOCATION

## LOCAL LOCATIONS

- Newburgh
- New Windsor
- Montgomery
- Maybrook
- Washingtonville
- Walden

## MAJOR ROADWAYS

- Interstate 84 0.4 mi.
- I-87 3 mi.
- US Rt. 9W 7 mi.
- Palisades Interstate 25 mi.
- Interstate 287 35 mi.
- NJ Turnpike 60 mi.

## PORTS / AIRPORTS

- New York Stewart Int'l Airport 5 mi.
- Port Newark 75 mi.
- Newark Liberty Int'l Airport 75 mi.

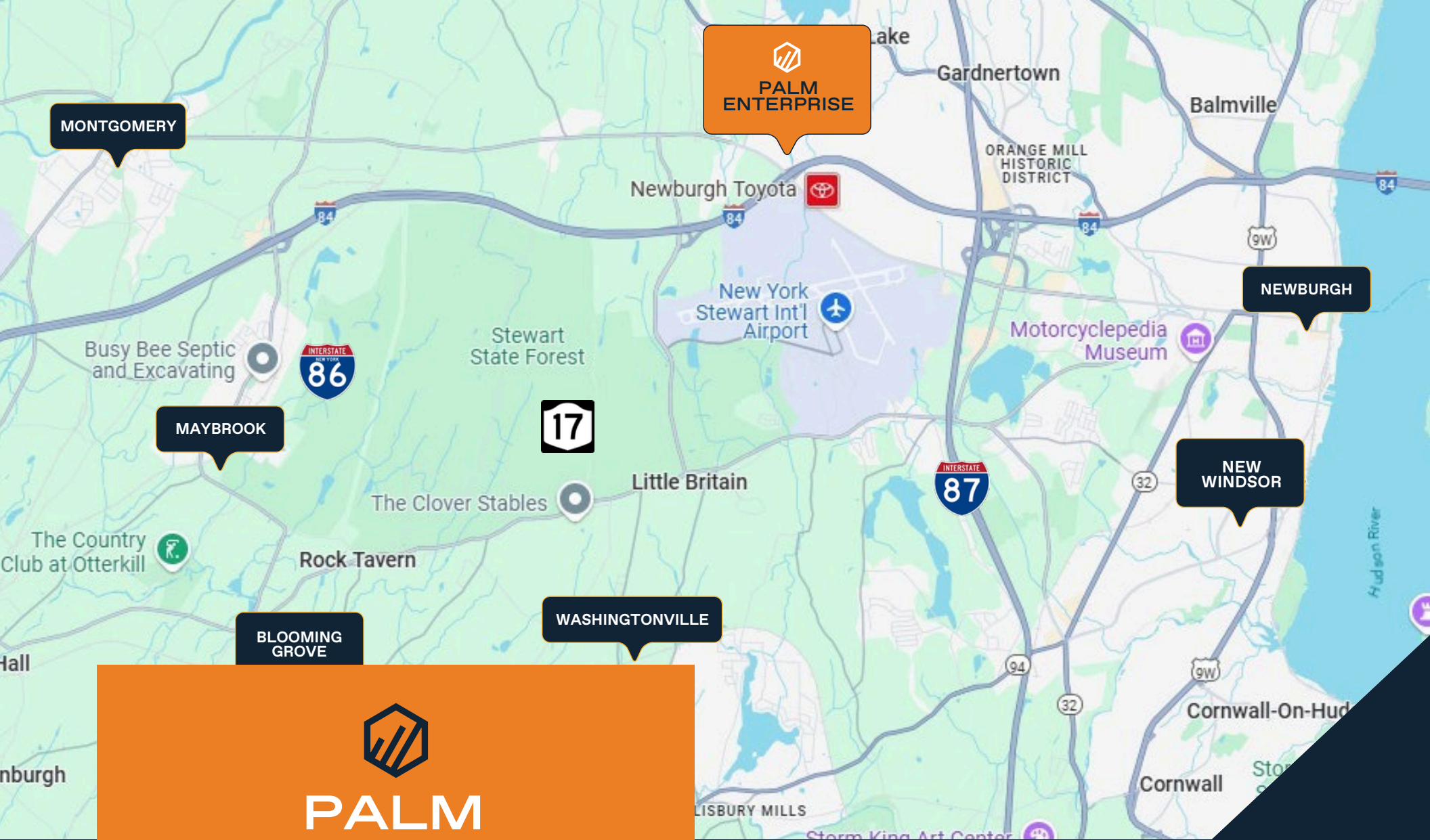

MONTGOMERY

MAYBROOK

BLOOMING GROVE

WASHINGTONVILLE

NEWBURGH

NEW WINDSOR

**PALM  
ENTERPRISE**

ORANGE COUNTY, NEW YORK

**STRATEGIC  
LOCATION**

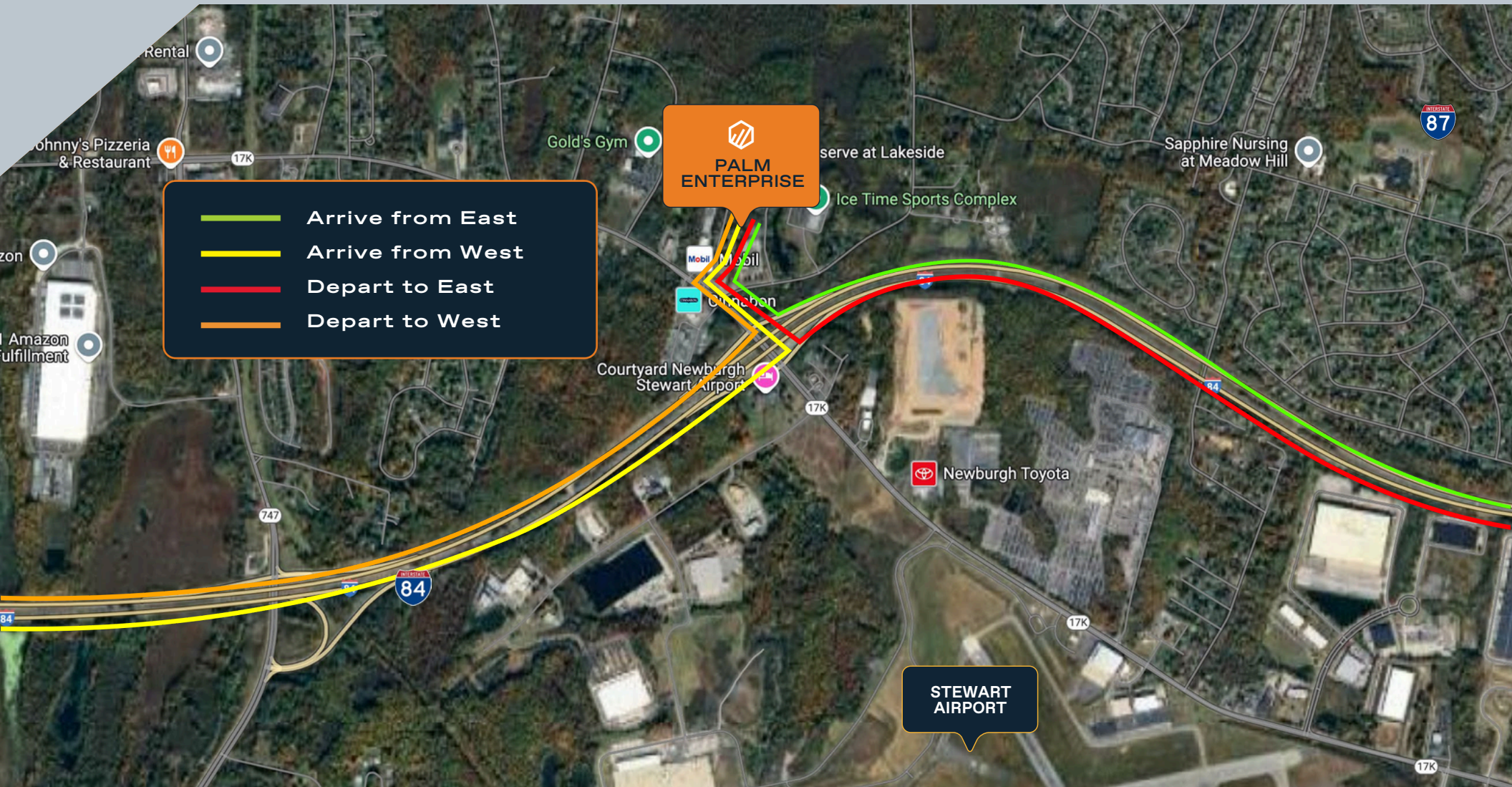

# TRUCK ROUTING EXHIBIT

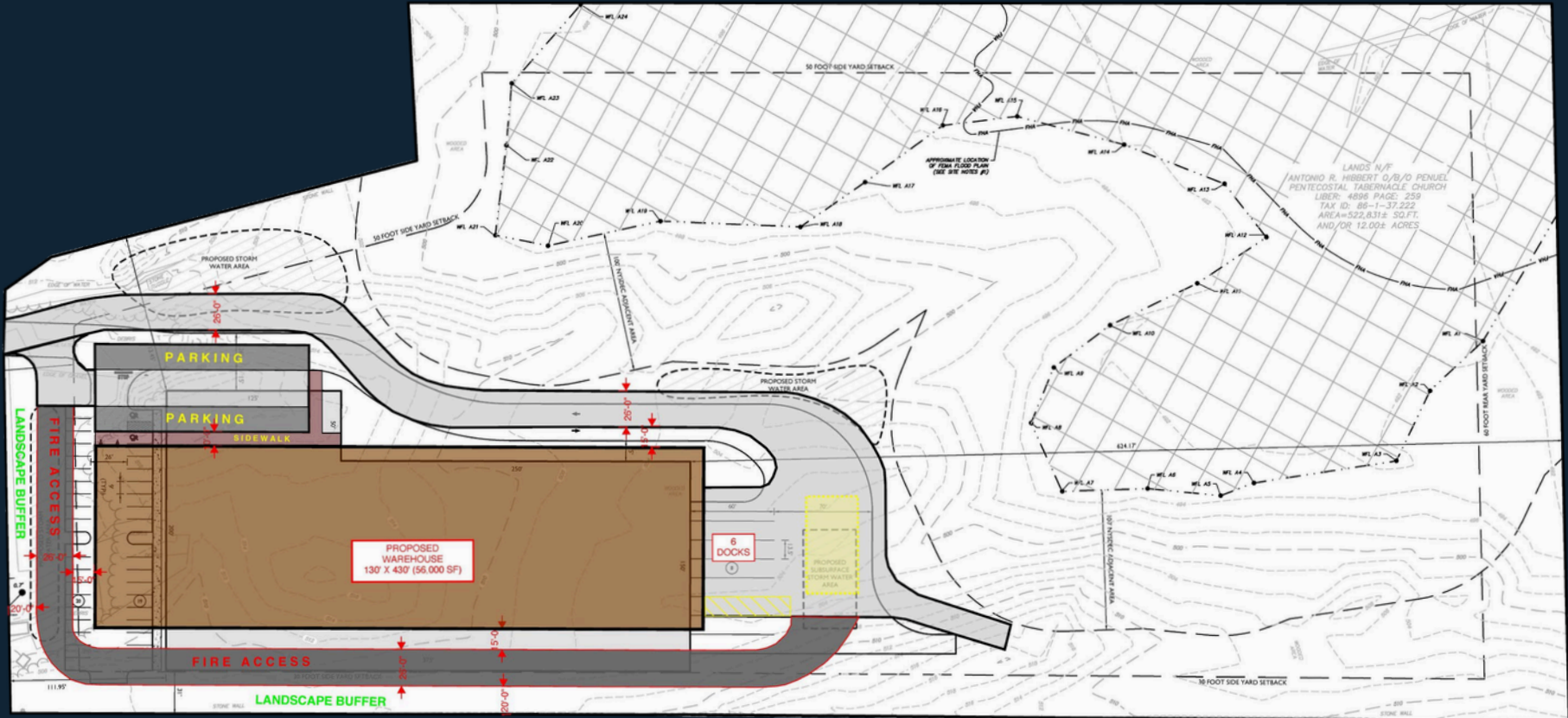

# PROPERTY LAND SPECS

12 ACRES PROPERTY

- **Building** 56,000 SQ FT
- **Ceiling Height** 38' - 40' clear
- **Office Space** 3000 Sq Ft

- **Loading** 6 Docks
- **Car Parking** 39
- **Warehouse space** 53,000 SF

# STRATEGIC LOCATION

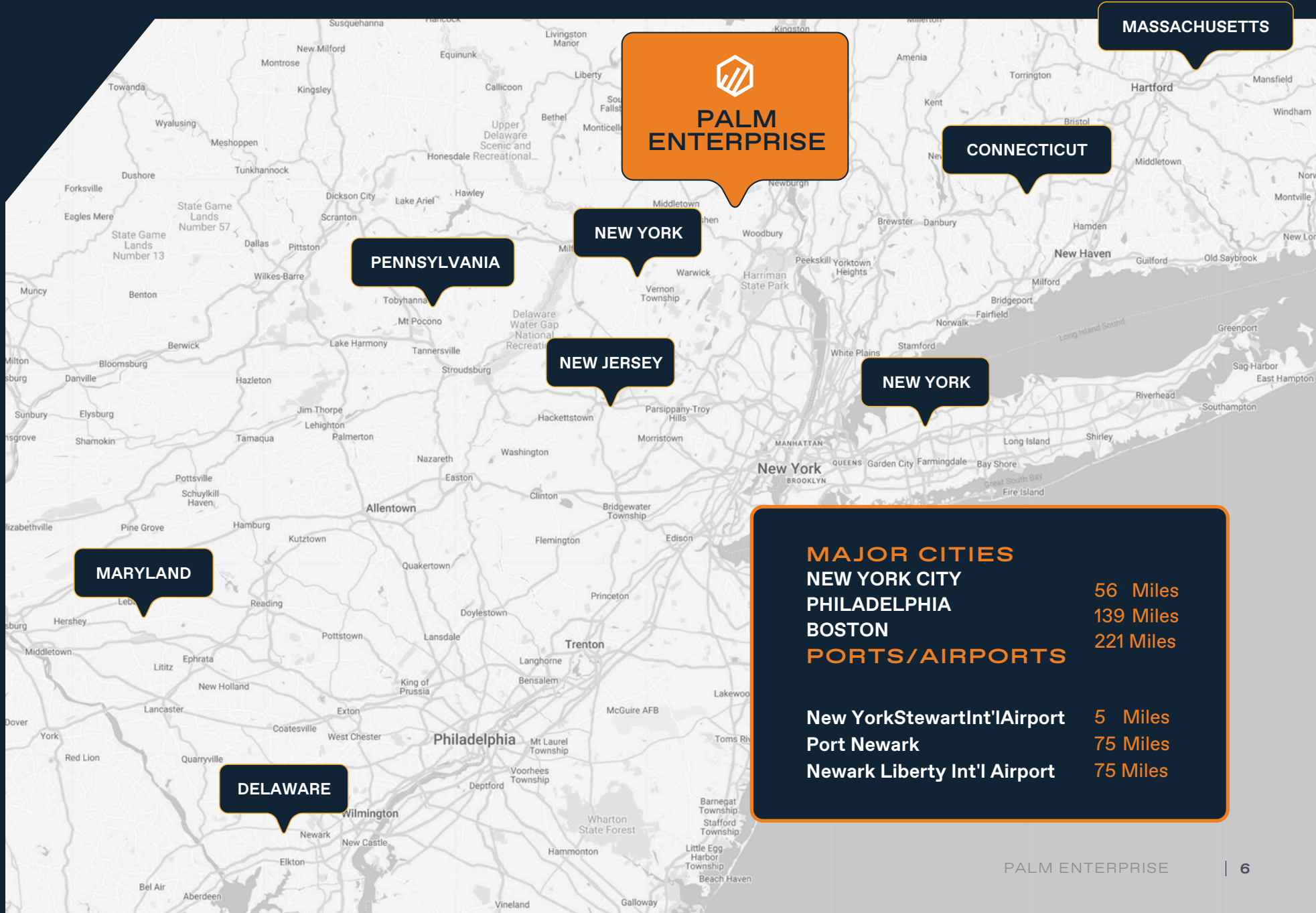

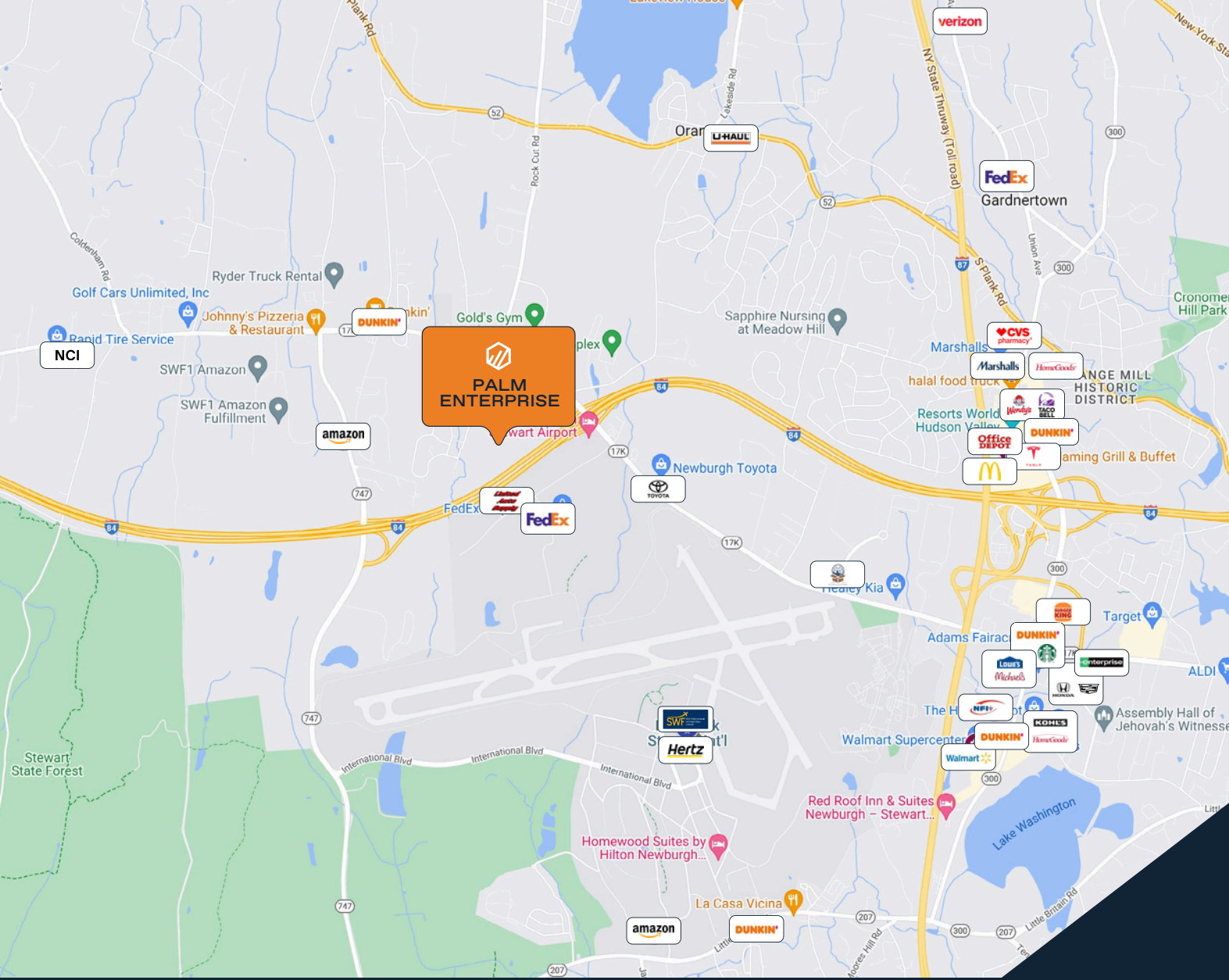

# REGIONAL DISTRIBUTION CENTERS

LOOKING  
FORWARD TO  
OUR MUTUAL  
SUCCESS!

AVION 



**AVI SAMET**

NTDSpecialist, Real Estate Broker

P: 845.388.1216  
info@avionventures.com

491 New York 208, Suite 112  
Monore, NY 10950

Real Expertise. Real Knowledge™

[avionventures.com](http://avionventures.com)