



515 Noble Ave - Suite A | Farmersville, CA

Property For Sale

1005 N Demaree Street
Visalia, California 93291
O | 559.754.3020
F | 559.429.4016
www.mdgre.com

GRAHAM | **& ASSOCIATES**

Matt Graham
Lic# 01804235
Michelle Felsted
Lic# 01197216

to learn more, visit: www.mdgre.com

PROPERTY DETAILS

Address: 515 Noble Ave - Suite A | Farmersville, CA

Square Feet Available: 9,622 +/- Sq. Ft. Total
1st Floor: 7,772 +/- Sq. Ft.
2nd Floor 1,852 +/- Sq. Ft.

Zoning: CS

Lease Type: NNN

Rental Rate: \$1.50 Per Sq. Ft. - Office
\$0.85 Per Sq. Ft. - Warehouse



Additional Comments:

Retail/Warehouse space available for lease on Noble Ave. with great visibility from Highway 198. The space offers 14 parking stalls in the front of the building, retail showroom, warehouse portion, break room, boardroom, server room, kitchenette, two sets of restrooms, eight private offices, one parking bay/warehouse storage. The warehouse portion is HVAC controlled. Please call for further details.



Contact Broker:
Matt Graham
Lic# 01804235

to learn more, visit: www.mdgre.com

1005 N Demaree Street
Visalia, California 93291
O | 559.754.3020

PLEASE NOTE: ALL INFORMATION AND REPRESENTATION MADE HEREIN, WHILE NOT GUARANTEED, HAVE BEEN SECURED FROM SOURCES WE BELIEVE TO BE RELIABLE, HOWEVER, THEY ARE NOT WARRANTED BY MATT GRAHAM & ASSOCIATES AND ARE SUBJECT TO CHANGE WITHOUT NOTICE.

SITE PLAN

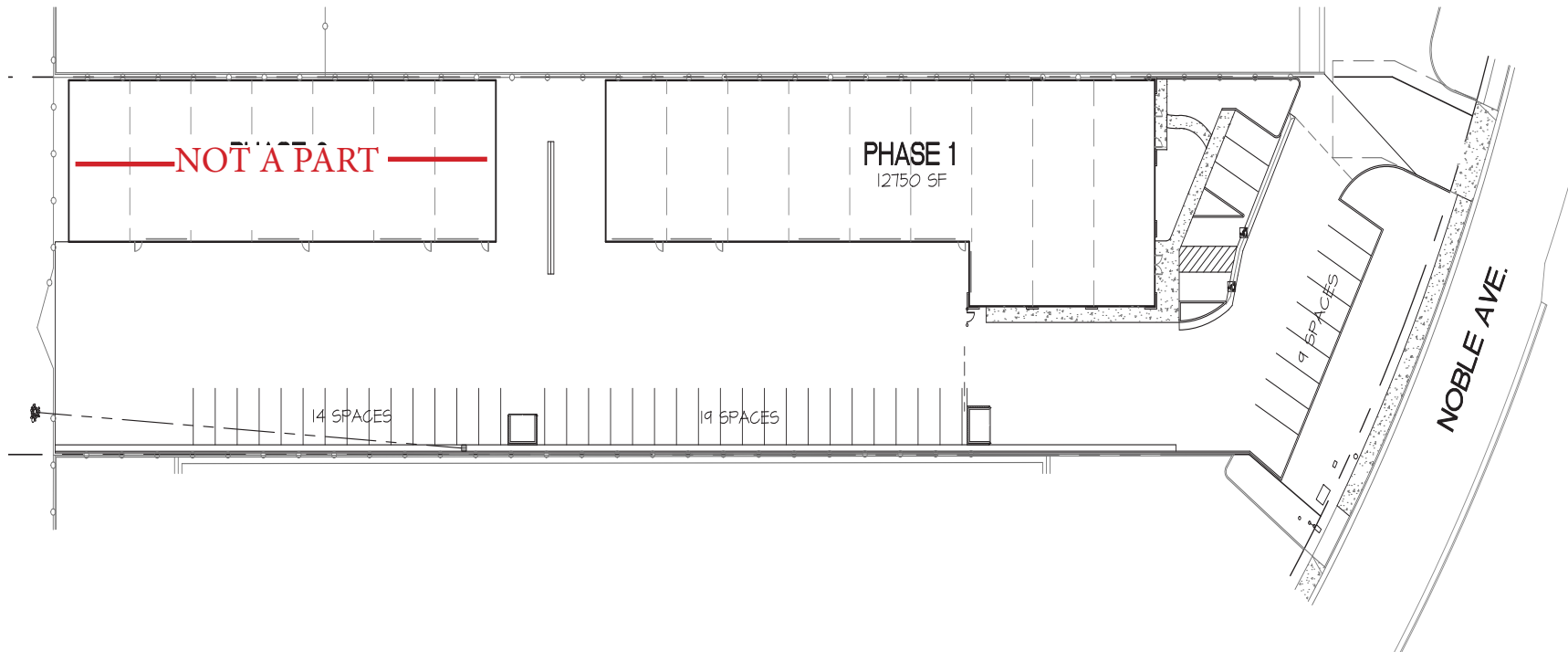

PLEASE NOTE: ALL INFORMATION AND REPRESENTATION MADE HEREIN, WHILE NOT GUARANTEED, HAVE BEEN SECURED FROM SOURCES WE BELIEVE TO BE RELIABLE, HOWEVER, THEY ARE NOT WARRANTED BY MATT GRAHAM & ASSOCIATES AND ARE SUBJECT TO CHANGE WITHOUT NOTICE.

SITE PLAN

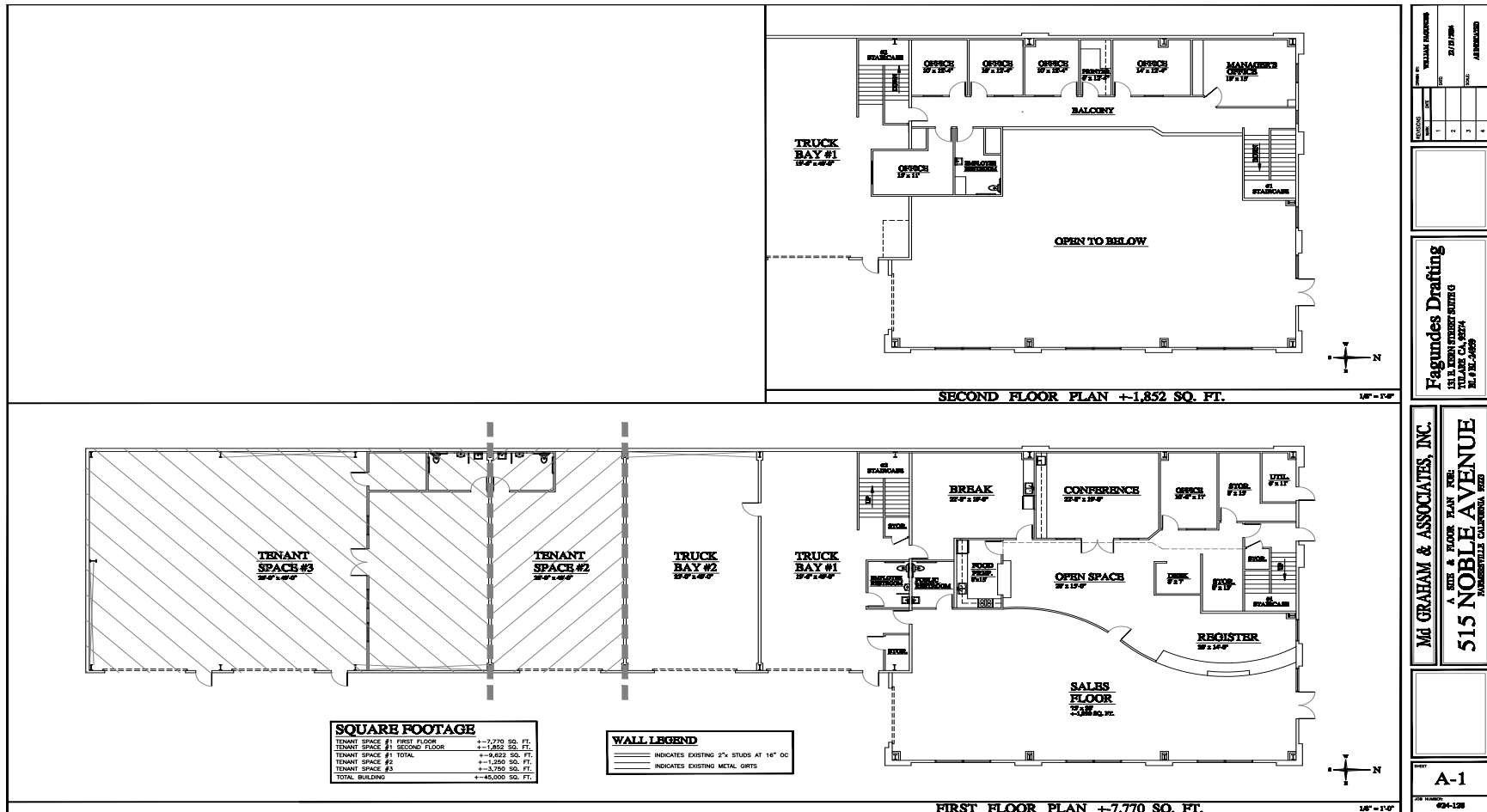

REVISION	DATE	BY	APPROVED
1	01/17/2018		
2			
3			
4			

Fagundes Drafting
 ARCHITECTURAL DRAFTING
 1111 MAIN ST. SUITE 201
 FARMERSVILLE, CA 95924
 TEL: 916.762.4600

Md GRAHAM & ASSOCIATES, INC.
 A SITE & FOUND PLAN PER
515 NOBLE AVENUE
 FARMERSVILLE CALIFORNIA 95924

A-1

DATE PLOTTED: 01-17-2018

PLEASE NOTE: ALL INFORMATION AND REPRESENTATION MADE HEREIN, WHILE NOT GUARANTEED, HAVE BEEN SECURED FROM SOURCES WE BELIEVE TO BE RELIABLE, HOWEVER, THEY ARE NOT WARRANTED BY MATT GRAHAM & ASSOCIATES AND ARE SUBJECT TO CHANGE WITHOUT NOTICE.

LOCATION MAP

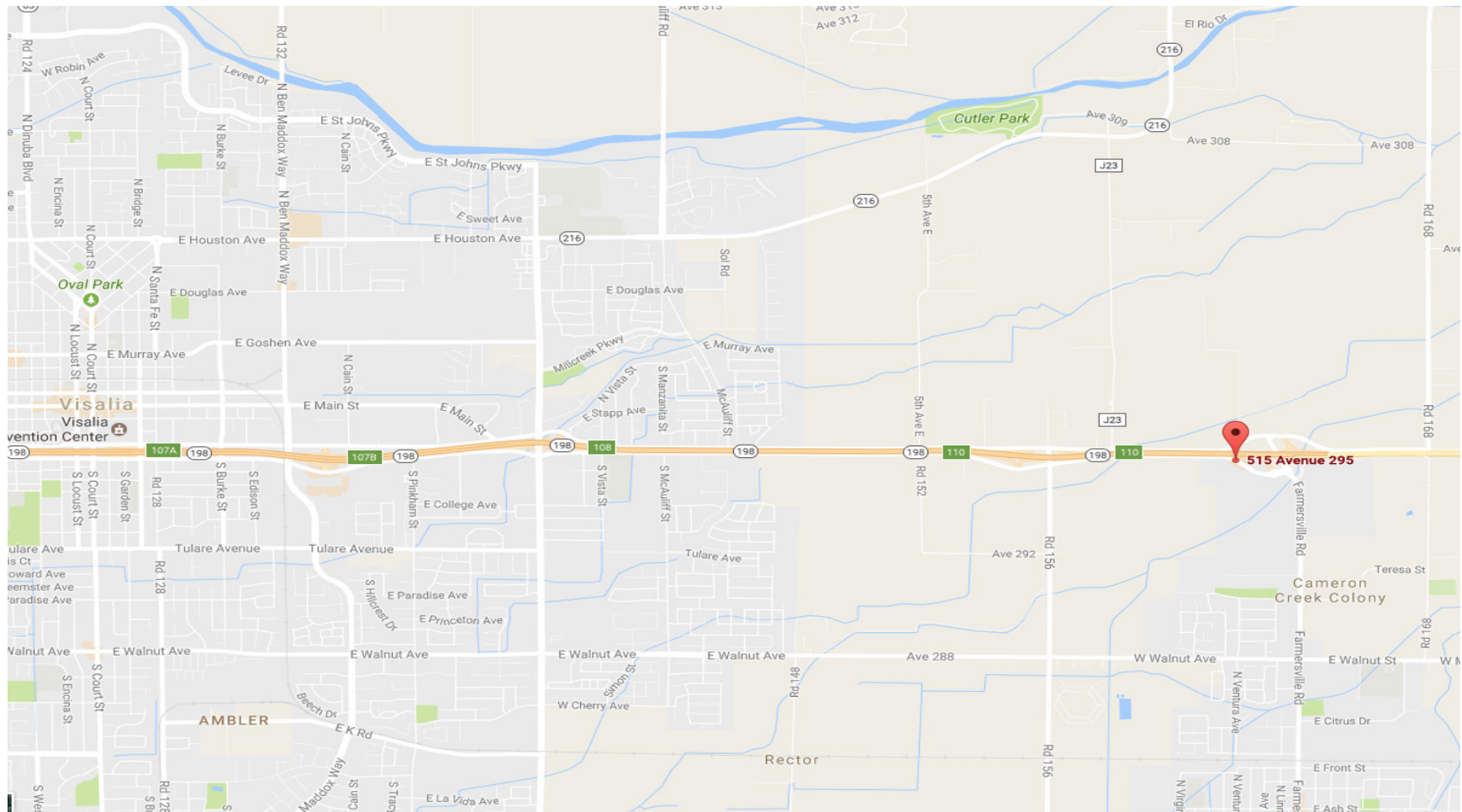

PLEASE NOTE: ALL INFORMATION AND REPRESENTATION MADE HEREIN, WHILE NOT GUARANTEED, HAVE BEEN SECURED FROM SOURCES WE BELIEVE TO BE RELIABLE, HOWEVER, THEY ARE NOT WARRANTED BY MATT GRAHAM & ASSOCIATES AND ARE SUBJECT TO CHANGE WITHOUT NOTICE.

PROPERTY LAYOUT



PLEASE NOTE: ALL INFORMATION AND REPRESENTATION MADE HEREIN, WHILE NOT GUARANTEED, HAVE BEEN SECURED FROM SOURCES WE BELIEVE TO BE RELIABLE, HOWEVER, THEY ARE NOT WARRANTED BY MATT GRAHAM & ASSOCIATES AND ARE SUBJECT TO CHANGE WITHOUT NOTICE.

PROPERTY PHOTOS

