

# FOR SALE

3512 LAKE CENTER DRIVE, SUITE B, SANTA ANA

±4,923 SF INDUSTRIAL BUILDING



## PROPERTY FEATURES

- ±4,923 SF Industrial Building
- ±1,500 SF of Single-Story Office
- 400 amps – 277/480v (*Buyer to Verify*)
- 18' Warehouse Ceilings
- 1 GL Door (12' x 12')
- Sprinklers - 0.12 GPM/1,500 SF
- 2.7:1,000 Parking Ratio
- Built in 1989
- Association Dues: \$727/Month
- **Asking Price: \$2,195,000**

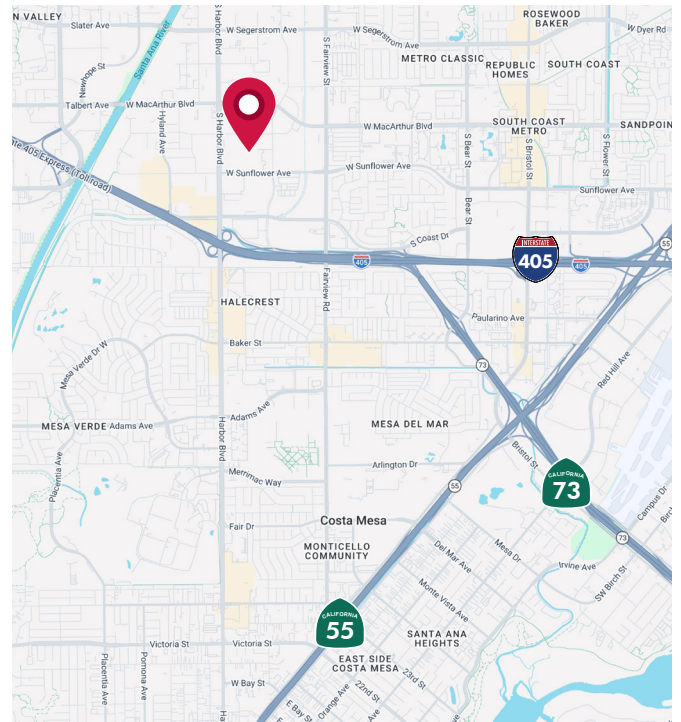

DALE CAMERA  
Senior Vice President  
License ID# 01313921  
949.790.3132  
dcamera@leeirvine.com

JASON HELMICK  
Senior Vice President  
License ID# 01786729  
949.790.3119  
jhelmick@leeirvine.com

ZACH SCHWANER  
Senior Vice President  
License ID# 02009623  
949.790.3159  
zschwaner@leeirvine.com

DYLAN DAVEY  
Associate  
License ID# 02219560  
949.790.3162  
ddavey@leeirvine.com

 **LEE & ASSOCIATES**  
COMMERCIAL REAL ESTATE SERVICES

**ORANGE COUNTY INDUSTRIAL**

# FOR SALE

3512 W LAKE CENTER DR, SUITE B, SANTA ANA

±4,923 SF INDUSTRIAL BUILDING

## SITE PLAN

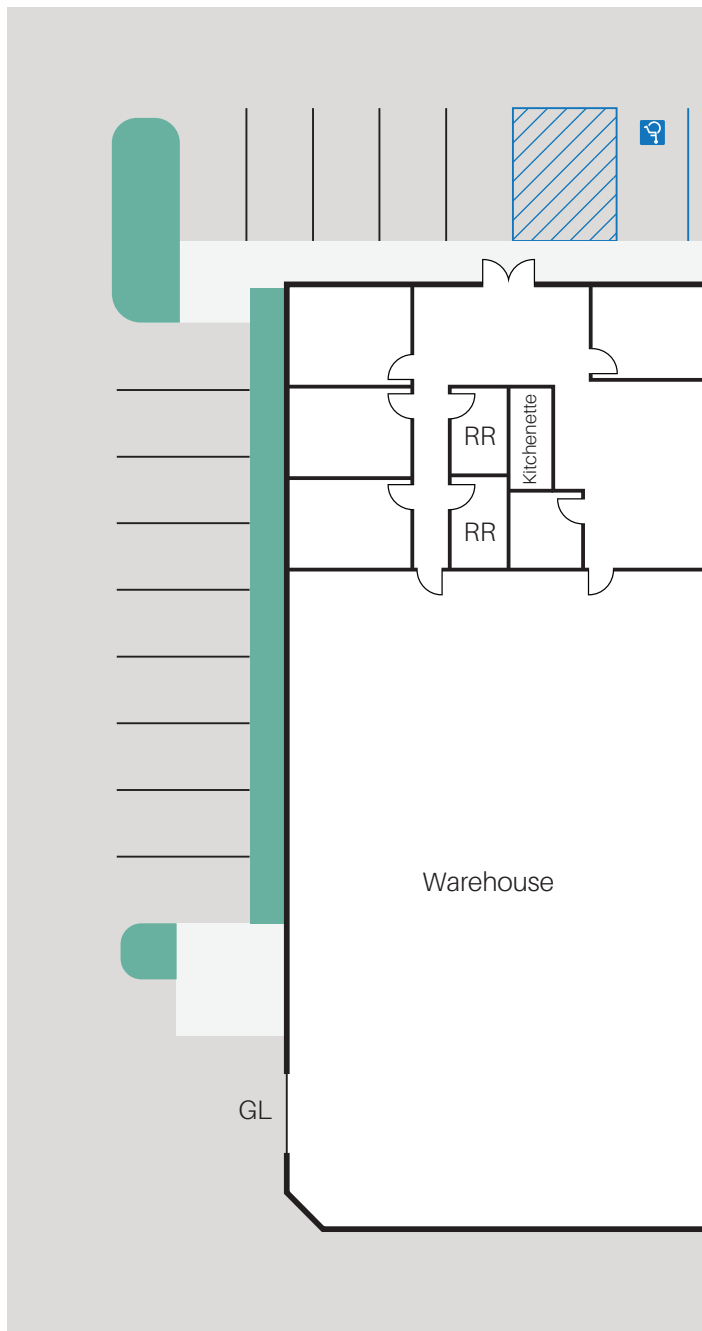

**DALE CAMERA**  
Senior Vice President  
License ID# 01313921  
949.790.3132  
dcamera@leeirvine.com

**JASON HELMICK**  
Senior Vice President  
License ID# 01786729  
949.790.3119  
jhelmick@leeirvine.com

**ZACH SCHWANER**  
Senior Vice President  
License ID# 02009623  
949.790.3159  
zschwaner@leeirvine.com

**DYLAN DAVEY**  
Associate  
License ID# 02219560  
949.790.3162  
ddavey@leeirvine.com

 **LEE & ASSOCIATES**  
COMMERCIAL REAL ESTATE SERVICES

**ORANGE COUNTY INDUSTRIAL**