



# THE SHOPS AT CHANDLER BUSINESS CENTER

6140 WEST CHANDLER BLVD, CHANDLER, AZ  
SEC of Kyrene Road & Chandler Boulevard

**SEAN M. BISHOP, CCIM**  
PRINCIPAL  
sbishop@leearizona.com  
602.954.3774

 **LEE &  
ASSOCIATES**  
COMMERCIAL REAL ESTATE SERVICES

Sean M. Bishop, CCIM is a licensed real estate broker in the State of Arizona and is a principal in the ownership entity of the subject property. All information furnished regarding property for sale, rental or financing is from sources deemed reliable, but no warranty or representation is made to the accuracy thereof and same is submitted to errors, omissions, change of price, rental or other conditions prior to sale, lease or financing or withdrawal without notice. No liability of any kind is to be imposed on the broker herein.



## PROPERTY HIGHLIGHTS

- Prominent end cap retail opportunity with exceptional visibility
- Located at the signalized intersection of Chandler Blvd. & Kyrene Rd.
- Strong frontage and signage opportunities along Chandler Blvd.
- Modern neighborhood shopping center with attractive architectural design
- Dense and affluent West Chandler trade area
- Excellent access and circulation with abundant parking
- Surrounded by major employment drivers including Intel, Wells Fargo, PayPal, and Chandler's Price Corridor tech hub
- Positioned near dense residential neighborhoods with strong daytime and evening population
- Outdoor patio available
- Join established co-tenants including Subway, Ocean Blue Caribbean Restaurant, Chino-Mex, Lucy's Nail Spa, and Beauty Craft Hair Salon.

# SITE PLAN

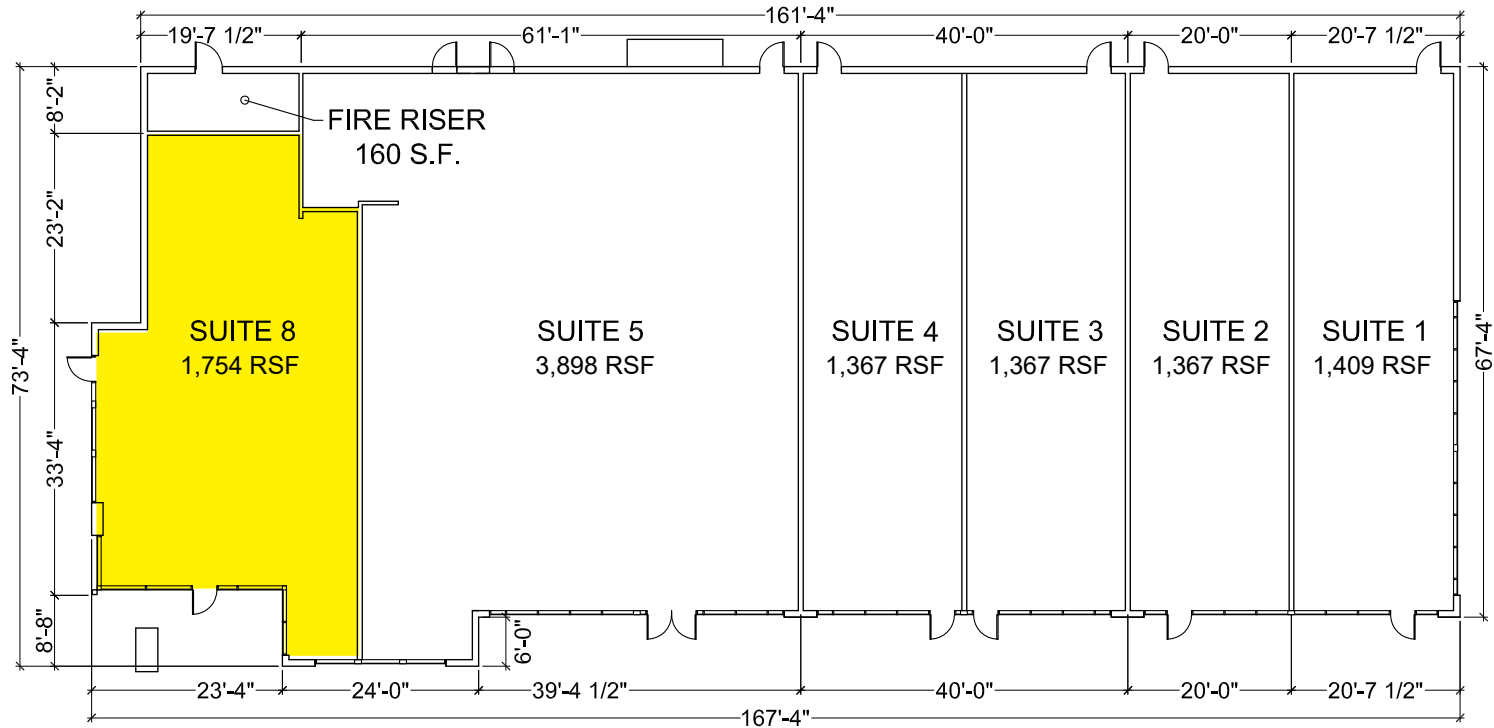

SUITE	TENANT	SF
1	Subway	1,409 SF
2	Chino Mex	1,367 SF
3	Ocean Blue Carribean	1,367 SF
4	Lucy's Nails & Spa	1,367 SF
5	Beauty Craft Co	3,898 SF
8	AVAILABLE	1,754 SF

# AERIAL



RAY RD

INTERSTATE 10

**LOWE'S** **INN-OUT** **BevMo!**  
**Portillo's** **CARRABBA'S**  
**Jason's Deli** **OUTBACK STEAKHOUSE**

**WILLIAMS SONOMA** **ULTA BEAUTY**  
**FLOWER CHILD**  
**Fleming's** **JARED** **ARAO GOLF**  
**LONGHORN STEAKHOUSE** **neKter**

**Fry's Marketplace** **Joey's** **EoS FITNESS**  
**BAJA FRESH** **FirstWatch** **Jack**  
**Qvo Harvest BBQ** **rubio's**

**TARGET** **Burlington**  
**SPROUTS** **Michaels** **ROSS**  
**AMC THEATRES** **PETSMART** **SAJAD**  
**Chick-fil-A** **usbank** **NOODLES** **HOBBY LOBBY**  
**WELLS FARGO** **IHOP** **Succe**

**SUBJECT**

56TH ST

KYRENE RD

20,829 VPD

MCCLEINTOCK DR

CHANDLER BLVD

25,051 VPD

**Cane's** **Denny's**



**AVNET**

**AVNET**

**Basha's**

**isola**

**NORTHROP GRUMMAN**

**Starbucks** **Falabella's** **Bowlero**  
**SAJAD** **GO** **WINE & SPIRITS**

**KOHL'S** **CVS** **Wendy's**  
**Shell** **POPEYES** **ZOYO**  
**ARRIBA** **SportClips** **DISCOUNT TIRE**

202



202

**PHOENIX PREMIUM OUTLETS**  
A SIMON CENTER  
**Calvin Klein** **OLD NAVY**  
**Columbia** **AMERICAN EAGLE**

**LONE BUTTE CASINO**

Gila River Indian Reservation

# DEMOGRAPHICS

	 POPULATION	 AVERAGE HOUSEHOLD INCOME	 NUMBER OF HOUSEHOLDS
<b>1 MILE</b>	16,470	\$152,369	6,164
<b>3 MILES</b>	127,822	\$146,620	46,771
<b>5 MILES</b>	359,756	\$136,904	129,430

