

SIGN @ ACCESS. PARKING SPACE 3/8" = 1'-0" 02

NOTES:
REFER TO CIVIL DRAWINGS "4" FOR SITE DIMENSIONS.

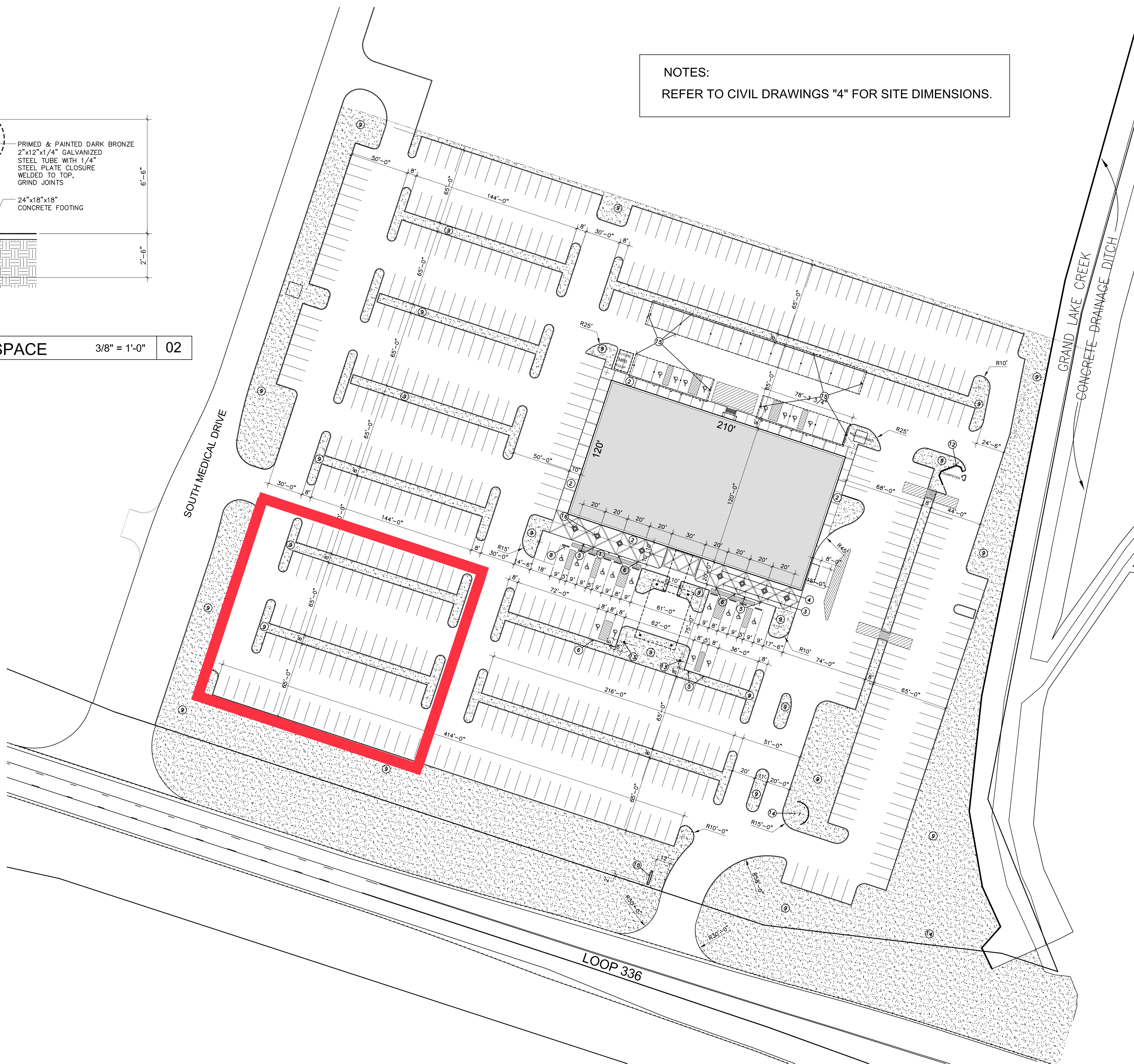

PLAN NOTES

- 1 ACCESSIBLE ROUTE: RUNNING SLOPES SHALL NOT EXCEED 1:20. (CROSS SLOPE SHALL NOT EXCEED 1:50).
- 2 BROOM FINISH CONCRETE, TYPICAL
- 3 SAW CUT CONTROL JOINTS, TYPICAL
- 4 EXPANSION JOINTS (PROVIDE EXPANSION JOINTS @ 20' MAX., TYPICAL)
- 5 ACCESSIBLE PARKING SIGN, TYPICAL. RE: 02/A0.1
- 6 VAN ACCESSIBLE PARKING SIGN, TYPICAL. RE: 02/A0.1
- 7 WHITE TRAFFIC PAINT: PITTSBURGH 11 LINE TRAFFIC AND ZONE MARKING PAINT.
- 8 6" WIDE, 4" HIGH & 6" LONG CONCRETE CURB WHEEL STOP (PRECAST & SECURED TO PARKING SLAB).
- 9 PLANTING AREA. RE: LANDSCAPE DRAWINGS
- 10 LOCATION FOR BUILDING MONUMENT SIGN N.I.C. (PROVIDE POWER RE: ELECTRICAL DRAWINGS)
- 11 CONCRETE CURB, RE: CIVIL DRAWINGS
- 12 WASTE CONTAINER & SCREEN WALL RE: STRUCTURAL DRAWINGS
- 13 30' HIGH FLAG POLE, PROVIDE POWER RE: ELECTRICAL DRAWINGS
- 14 PROVIDE POWER FOR BUILDING ARTWORK RE: ELECTRICAL DRAWINGS
- 15 PRE-ENGINEERED METAL PARKING COVER, PROVIDE 98" MINIMUM VERTICAL CLEARANCE FOR VAN ACCESSIBLE PARKING.
- 16 48" x 48" TREE GRATE WITH LIGHT OPENINGS CUSTOMIZED TO THE LIGHT FIXTURE. PROVIDE POWER @ EACH TREE GRATE. TYPICAL

NOTES:

1. ACCESSIBLE PARKING & ACCESS AISLES SURFACES TO BE LEVEL WITH MAXIMUM OF 2% SLOPE IN ALL DIRECTIONS.
2. PROVIDE 60" DEEP & 60" WIDE (18" MIN. @ FULL SIDE) LEVEL LANDING @ ALL EXTERIOR DOORS WITH MAX. 2% SLOPE IN ALL DIRECTIONS.
3. ALL TRAFFIC PAINTS AND ACCESSIBLE ROUTE CROSS HATCH & SIGNS TO BE SLIP-RESISTANT PAINT.

STATISTICAL DATA:

SITE AREA 8.574 ACRES

BUILDING "A" GROSS AREA:

FIRST LEVEL	25,000 GSF
SECOND LEVEL	25,000 GSF
THIRD LEVEL	25,000 GSF
FOURTH LEVEL	25,000 GSF
TOTAL:	100,000 GSF

PARKING SPACE:

616 CARS 6.16 PER 1000 GSF
34 COVERED PARKING SPACES
10 VAN ACCESSIBLE PARKING SPACES
12 ACCESSIBLE PARKING SPACES

ARCHITECTURAL SITE PLAN

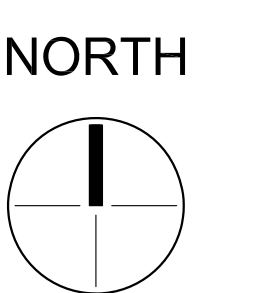

1" = 40'

01

ISSUE NO.	DATE	DESCRIPTION
	DEC. 10, 2010	ISSUED FOR PRICING
	JAN. 11, 11	ISSUED FOR PERMIT
	FEB. 11, 11	REVISED PER CITY COMMENTS

SADLER CLINIC

ARCHITECTURAL SITE PLAN

CONROE, TEXAS

PROJECT NO. 1007

A0.1