



NICK SCHUITEMAKER, CCIM

208.947.0802

nick@tokcommercial.com

MIKE GREENE, SIOR, CCIM

208.947.0835

mikeg@tokcommercial.com

PETER OLIVER, SIOR, CCIM

208.947.0816

peter@tokcommercial.com

Strong medical co-tenancies.

Close to a variety of amenities, including public transportation.

Adjacent and connected to St. Alphonsus Regional Medical Center.

Excellent location - one block from I-184 Connector and Curtis off-ramp.

SPACE	SIZE	RATE
Suite 401	3,241 SF	\$25.00/SF
Suite 402*	2,085 SF	\$25.00/SF
Combined Suites*	5,326 SF	\$25.00/SF

*Available with 30 days notice

SUBMARKET	Central	ZONING	MX-H
BLDG TYPE	Medical/Office	LEASE TERM	3+ Years
# OF FLOORS	4	LEASE TYPE	FSEJ
PARKING	Ample	AVAILABLE	Immediately

CONTACT AGENTS FOR SHOWING INSTRUCTIONS

CONTACT

HIGHLIGHTS

DETAILS

FLOOR PLAN

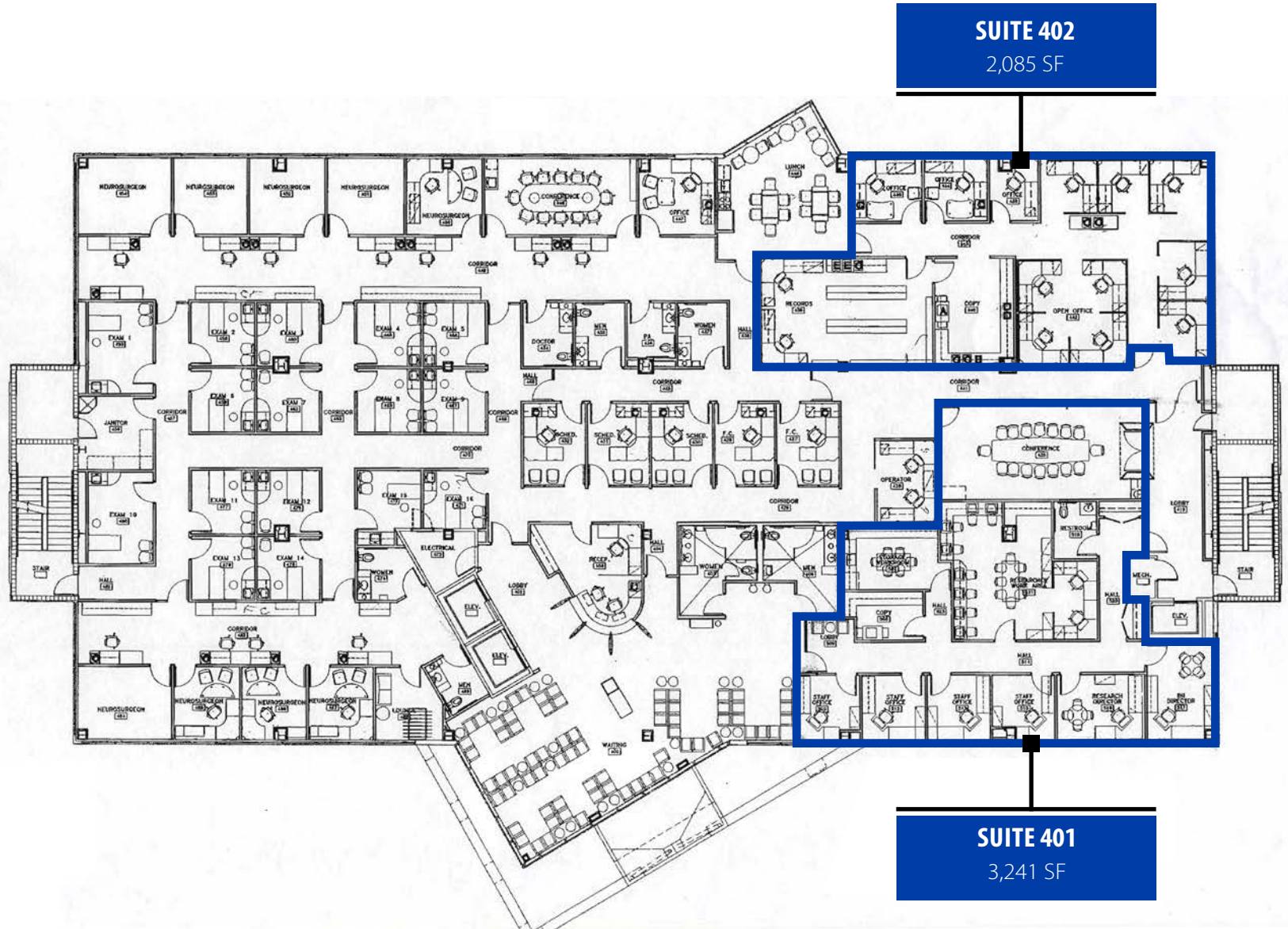





CAMPUS MAP

Saint Alphonsus Regional Medical Center Campus Map

HOSPITAL ENTRANCE

Main Entrance	(M)
South Tower, Endoscopy, Radiology & Lab	(S2)
Emergency Department	(S1)
Wound Healing & Hyperbaric Medicine	(S6)
North Tower, Cancer Care Center	(N1)
Family Maternity Center	(N4)
Day Surgery	(N7)
Breast Care Center	(W5)

MEDICAL OFFICE BUILDINGS ENTRANCE

Emerald Clinic (6051 W. Emerald St.)	
Joint Preservation Clinic (6165 W. Emerald St.)	
Moreau (6140 W. Curtisian)	(N3)
Hartman (1075 N. Curtis Rd.)	(N6)
Medical Arts (999 N. Curtis Rd.)	(S3)
Medical Building (901 N. Curtis Rd.)	(S4)
Mulvaney (1072 N. Liberty)	(W3)
Liberty Building (900 N. Liberty)	(W4) (W5)



All visitors who want to access patient rooms, please enter at the (M) Main Entrance located in the Central Tower.

DESTINATION	ENTRANCE
Breast Care	W5
Cancer Care	N1
Diabetes Care & Education	1000
Day Surgery	N7
EKG	Main
Emergency	S1
Endoscopy/GI	S2
Family Center	W4

DESTINATION	ENTRANCE
Family Maternity Center/NICU (Labor & Delivery)	N4
Financial Services	S2
Lab	S3
MedNow Pharmacy	S2
Medical Records	Main
MRI	S2
Neonatal Intensive Care Unit (NICU)	N4

DESTINATION	ENTRANCE
Pre-Surgical Screening	Main
Radiology Clinic	S2
Registration	Main
Sleep Disorders Center (Basement)	N3
Surgery	Main
Wound Healing & Hyperbaric Medicine	S6
X-Ray (Medical Imaging)	S2

AERIAL MAP

EASY ACCESS TO ALL SERVICES



6140 CURTISIAN

TOXCOMMERCIAL.COM