

Lebanon Warehouse I



1019 COWAN DR, LEBANON, MO 65536

For Lease



For more information please contact:

David Havens

Senior Broker

417.877.7900 x101

dhavens@jaredcommercial.com

Curtis Jared

President & CEO

417.877.7900 x111

cjared@jaredcommercial.com

2870 S Ingram Mill Rd | Springfield, MO 65804 | 417.877.7900 | JaredCommercial.com





For Lease

PROPERTY DESCRIPTION

Introducing a prime leasing opportunity at 1019 Cowan Dr, Lebanon, MO, 65536. This exceptional property boasts 14' overhead drive-in bays and a convenient, easy-access drive-through warehouse, ideal for streamlined operations. Situated on a corner lot with close proximity to I-44, this space offers maximum visibility and accessibility. The level lot provides a perfect foundation for a variety of business needs, ensuring ease of use for tenants. Don't miss the chance to secure this versatile and strategically positioned property for your commercial endeavors.

PROPERTY HIGHLIGHTS

- 14' Overhead Drive in Bays.
- Close Proximity to I-44.
- Corner Lot.
- Level Lot
- Easy- Access Drive-Through Warehouse.

OFFERING SUMMARY

Lease Rate:	\$5.50 SF/yr (NNN)
Number of Units:	4
Available SF:	2,244 - 4,488 SF
Lot Size:	33,629 SF
Building Size:	8,976 SF

DEMOGRAPHICS

	5 MILES	10 MILES	15 MILES
Total Households	8,507	11,689	14,907
Total Population	21,191	29,399	37,494
Average HH Income	\$68,813	\$70,765	\$71,355

Lebanon Warehouse I



1019 COWAN DR, LEBANON, MO 65536

LEASE SPACES

For Lease



LEASE INFORMATION

Lease Type: NNN Lease Term: Negotiable
Total Space: 2,244 - 4,488 SF Lease Rate: \$5.50 SF/yr

AVAILABLE SPACES

SUITE	TENANT	SIZE (SF)	LEASE TYPE	LEASE RATE	DESCRIPTION
Unit C	Available	2,244 - 4,488 SF	NNN	\$5.50 SF/yr	In-Line.
Unit D	Available	2,244 - 4,488 SF	NNN	\$5.50 SF/yr	End-Cap.

2870 S Ingram Mill Rd | Springfield, MO 65804 | 417.877.7900 | JaredCommercial.com



The statements, terms and conditions set forth in this advertisement are deemed reliable but not guaranteed and remain, at all times, subject to change by the property owner(s) without notice. The property owner(s) reserves the right, at its sole and absolute discretion to adjust the price and remove the property from the market at any time without notice. The property owner(s) reserves the right to reject any and all offers and transactions are subject to the execution of the definitive agreements. Jared Commercial makes no guarantees, representations or warranties regarding its accuracy. The property owner's obligations for the purchase or sale of any property shall be expressly subject to the execution of a definitive purchase agreement between the owner and buyer.

Lebanon Warehouse I



1019 COWAN DR, LEBANON, MO 65536

SITE PLAN

For Lease



2870 S Ingram Mill Rd | Springfield, MO 65804 | 417.877.7900 | JaredCommercial.com



The statements, terms and conditions set forth in this advertisement are deemed reliable but not guaranteed and remain, at all times, subject to change by the property owner(s) without notice. The property owner(s) reserves the right, at its sole and absolute discretion to adjust the price and remove the property from the market at any time without notice. The property owner(s) reserves the right to reject any and all offers and transactions are subject to the execution of the definitive agreements. Jared Commercial makes no guarantees, representations or warranties regarding its accuracy. The property owner's obligations for the purchase or sale of any property shall be expressly subject to the execution of a definitive purchase agreement between the owner and buyer.

Lebanon Warehouse I



1019 COWAN DR, LEBANON, MO 65536

FLOOR PLAN

For Lease

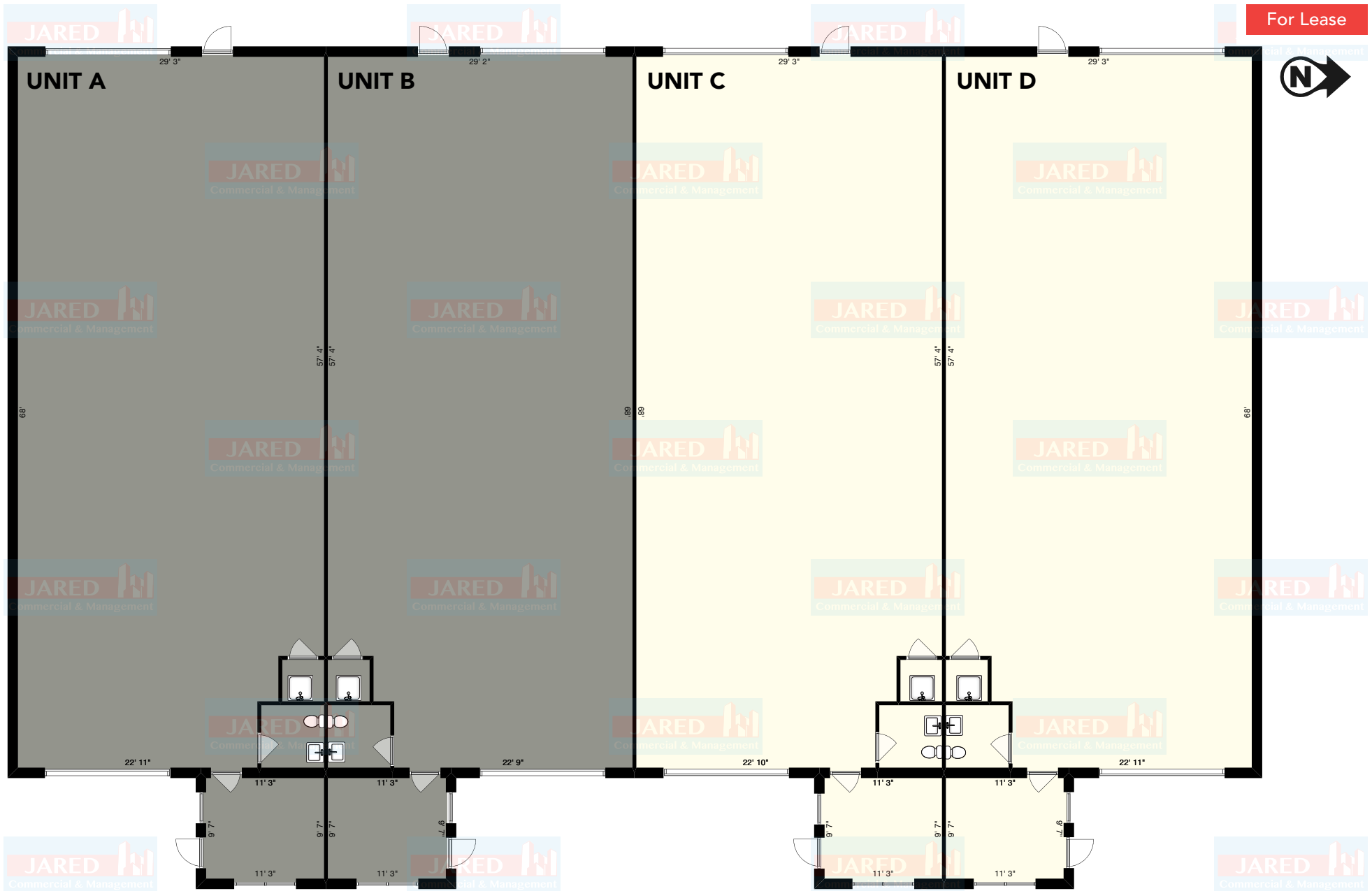

2870 S Ingram Mill Rd | Springfield, MO 65804 | 417.877.7900 | JaredCommercial.com



The statements, terms and conditions set forth in this advertisement are deemed reliable but not guaranteed and remain, at all times, subject to change by the property owner(s) without notice. The property owner(s) reserves the right, at its sole and absolute discretion to adjust the price and remove the property from the market at any time without notice. The property owner(s) reserves the right to reject any and all offers and transactions are subject to the execution of the definitive agreements. Jared Commercial makes no guarantees, representations or warranties regarding its accuracy. The property owner's obligations for the purchase or sale of any property shall be expressly subject to the execution of a definitive purchase agreement between the owner and buyer.

Lebanon Warehouse I



1019 COWAN DR, LEBANON, MO 65536

RETAILER MAP

For Lease



Google

Map data ©2025 Imagery ©2025 Airbus, Maxar Technologies

2870 S Ingram Mill Rd | Springfield, MO 65804 | 417.877.7900 | JaredCommercial.com



The statements, terms and conditions set forth in this advertisement are deemed reliable but not guaranteed and remain, at all times, subject to change by the property owner(s) without notice. The property owner(s) reserves the right, at its sole and absolute discretion to adjust the price and remove the property from the market at any time without notice. The property owner(s) reserves the right to reject any and all offers and transactions are subject to the execution of the definitive agreements. Jared Commercial makes no guarantees, representations or warranties regarding its accuracy. The property owner's obligations for the purchase or sale of any property shall be expressly subject to the execution of a definitive purchase agreement between the owner and buyer.

Lebanon Warehouse I



1019 COWAN DR, LEBANON, MO 65536

DEMOGRAPHICS MAP & REPORT

For Lease

POPULATION

	5 MILES	10 MILES	15 MILES
Total Population	21,191	29,399	37,494
Average Age	40	41	41
Average Age (Male)	38	39	40
Average Age (Female)	41	42	42

HOUSEHOLDS & INCOME

	5 MILES	10 MILES	15 MILES
Total Households	8,507	11,689	14,907
# of Persons per HH	2.5	2.5	2.5
Average HH Income	\$68,813	\$70,765	\$71,355
Average House Value	\$173,085	\$184,641	\$190,336

Demographics data derived from AlphaMap

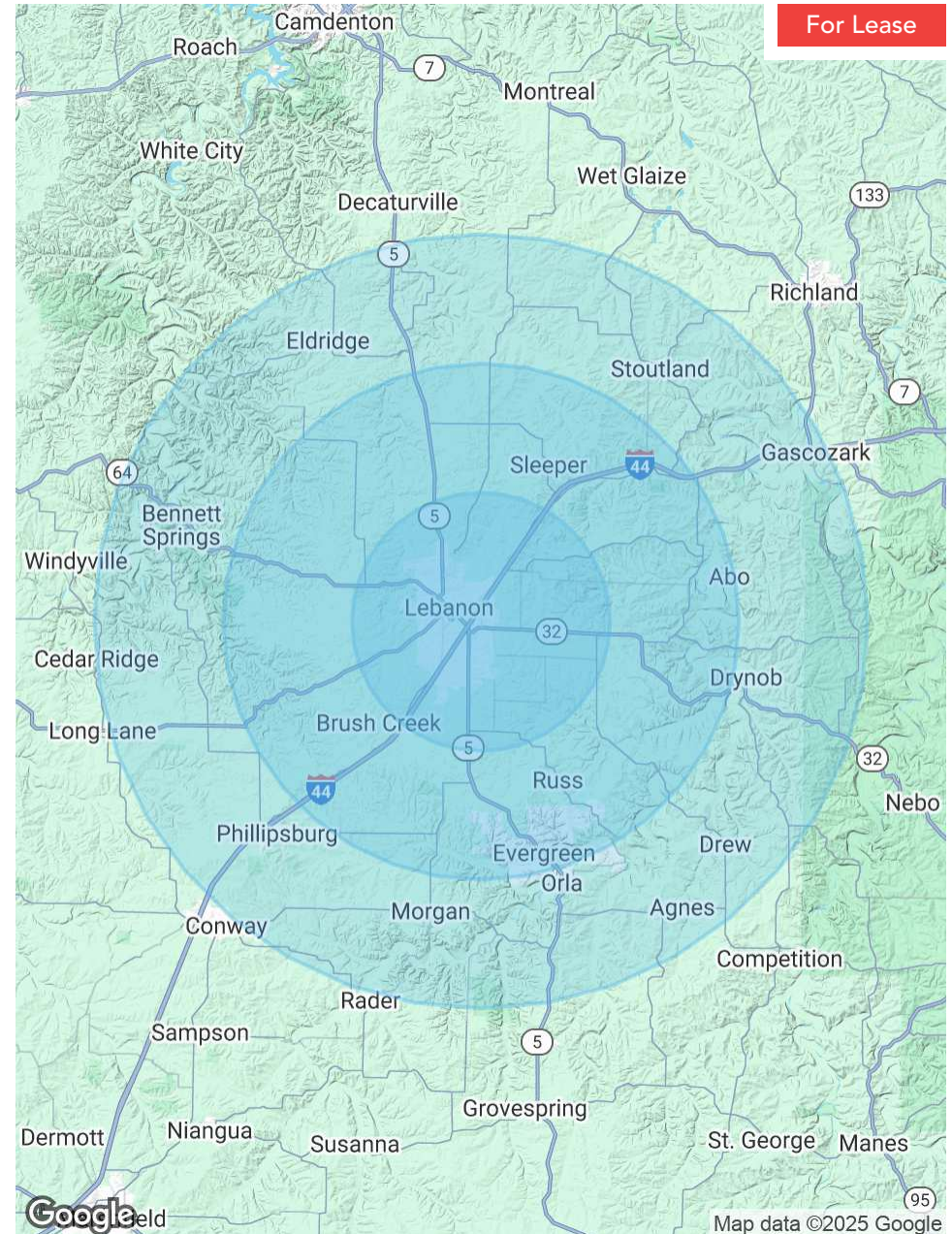

2870 S Ingram Mill Rd | Springfield, MO 65804 | 417.877.7900 | JaredCommercial.com



The statements, terms and conditions set forth in this advertisement are deemed reliable but not guaranteed and remain, at all times, subject to change by the property owner(s) without notice. The property owner(s) reserves the right, at its sole and absolute discretion to adjust the price and remove the property from the market at any time without notice. The property owner(s) reserves the right to reject any and all offers and transactions are subject to the execution of the definitive agreements. Jared Commercial makes no guarantees, representations or warranties regarding its accuracy. The property owner's obligations for the purchase or sale of any property shall be expressly subject to the execution of a definitive purchase agreement between the owner and buyer.



For Lease



DAVID HAVENS

Senior Broker

dhavens@jaredcommercial.com

Direct: 417.877.7900 x101 | Cell: 417.350.4771

MO #2015037234

EDUCATION

Bachelors Degree in Business Administration from University of Northern Colorado.
Entrepreneurship Certificate from University of Northern Colorado
CCIM Candidate
Missouri and Colorado Real Estate License
Business Brokerage Certificate- VR

MEMBERSHIPS

CCIM, ICSC, NAR, MAR.

Jared Commercial
2870 S Ingram Mill Rd Ste A
Springfield, MO 65804
417.877.7900

2870 S Ingram Mill Rd | Springfield, MO 65804 | 417.877.7900 | JaredCommercial.com



The statements, terms and conditions set forth in this advertisement are deemed reliable but not guaranteed and remain, at all times, subject to change by the property owner(s) without notice. The property owner(s) reserves the right, at its sole and absolute discretion to adjust the price and remove the property from the market at any time without notice. The property owner(s) reserves the right to reject any and all offers and transactions are subject to the execution of the definitive agreements. Jared Commercial makes no guarantees, representations or warranties regarding its accuracy. The property owner's obligations for the purchase or sale of any property shall be expressly subject to the execution of a definitive purchase agreement between the owner and buyer.

Lebanon Warehouse I



1019 COWAN DR, LEBANON, MO 65536

ADVISOR BIO

For Lease



CURTIS JARED

President & CEO

cjared@jaredcommercial.com

Direct: 417.877.7900 x111 | Cell: 417.840.9001

MO #2012016985

EDUCATION

BA - Drury University
Real Estate License

MEMBERSHIPS

BOMA International
ICSC
Missouri Realtors
National Association of Realtors

Jared Commercial
2870 S Ingram Mill Rd Ste A
Springfield, MO 65804
417.877.7900

2870 S Ingram Mill Rd | Springfield, MO 65804 | 417.877.7900 | JaredCommercial.com



The statements, terms and conditions set forth in this advertisement are deemed reliable but not guaranteed and remain, at all times, subject to change by the property owner(s) without notice. The property owner(s) reserves the right, at its sole and absolute discretion to adjust the price and remove the property from the market at any time without notice. The property owner(s) reserves the right to reject any and all offers and transactions are subject to the execution of the definitive agreements. Jared Commercial makes no guarantees, representations or warranties regarding its accuracy. The property owner's obligations for the purchase or sale of any property shall be expressly subject to the execution of a definitive purchase agreement between the owner and buyer.